

REV.	ECN NO.	DESCRIPTION	DESIGN	DATE
A		INITIAL	Kai	2018.03.29

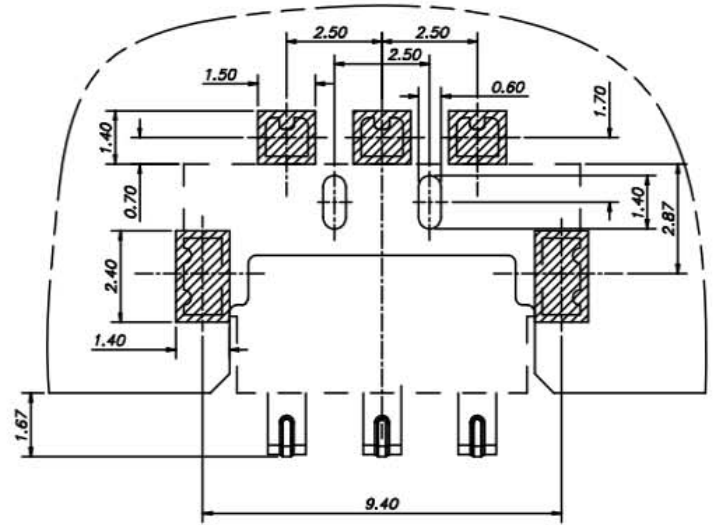

PCB布线图
未注尺寸公差: ±0.05

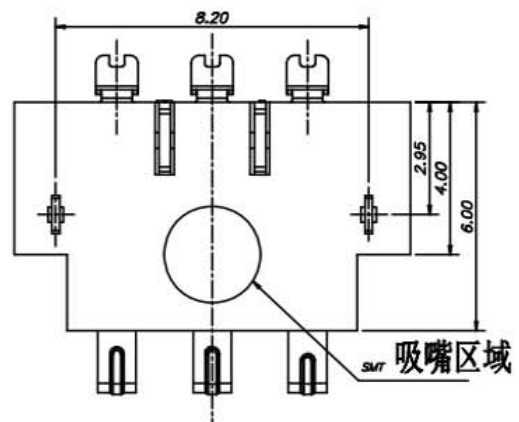
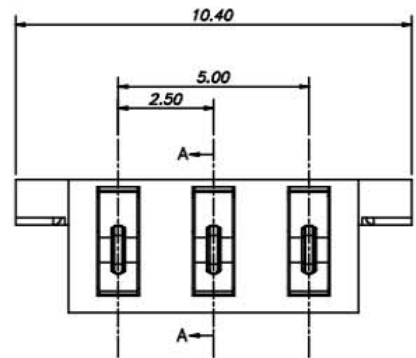
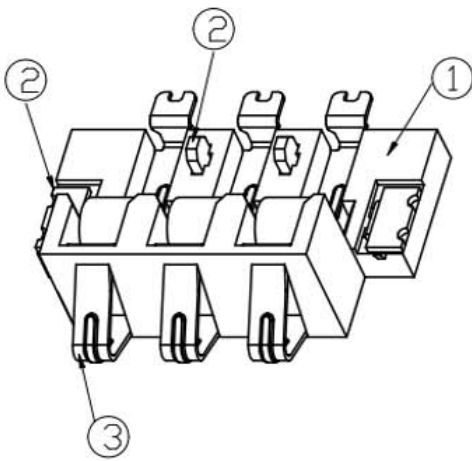
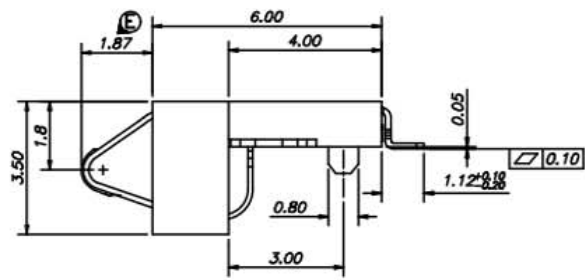
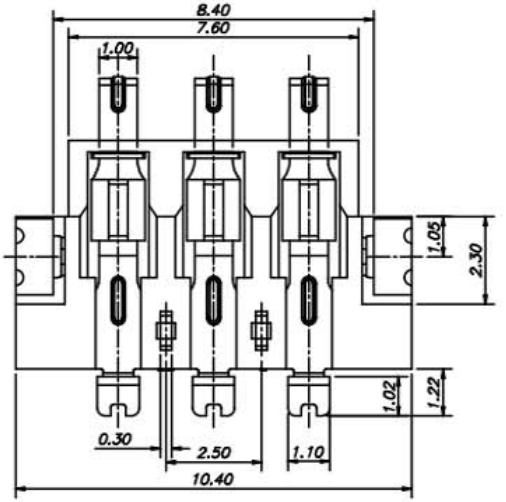

性能:
 额定电流: 2.0A
 额定电压: 12V
 耐电压: 500V
 接触电阻: 30mΩ
 绝缘电阻: 500MΩ
 工作温度: -40℃~+85℃
 塑件(材质): LCP
 接触点(材质): 磷铜, 镀金

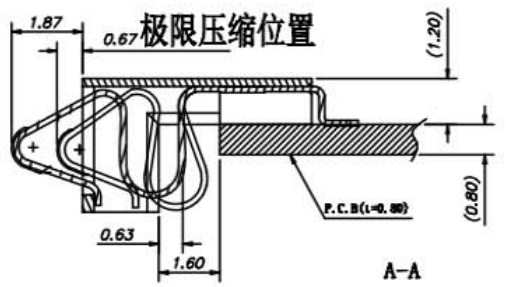

剖视图

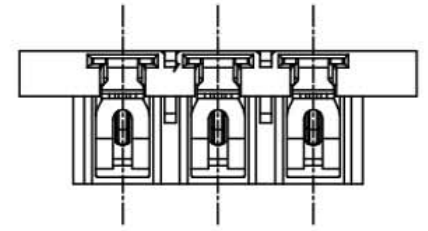

UNLESS OTHERWISE SPECIFIED TOLERANCES						广东科斯达电器开关厂			
DECIMALS:		ANGLES:		DWG NO.	PART NAME:				
DIM	TOL	DIM	TOL	DESIGN:	PART NO.				
X.	±0.50	X.	±2°	CHECK:	REV. UNIT: SHEET:				
X.X	±0.30	X.X	±1°	APPROVED	A	mm	1/1		
X.XX	±0.20	X.XX	---						
X.XXX	±0.10	X.XXX	---						

②	HOUSING	1	LCP		BLACK
①	CONTACT A	2	PHOSPHOR BRONZE 0.20T	Au PLATED	
ITEM	PART NAME	Q'TY	MATERIAL	DESCRIPTION	REMARK