

F

E

D

C

B

A

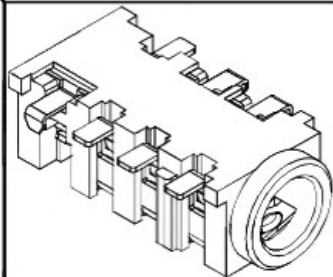

RoHS  
Compliant

ZONE	SYMBOL	REVISION	APPROVAL	DATE

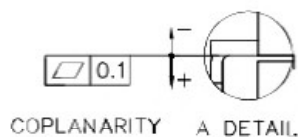
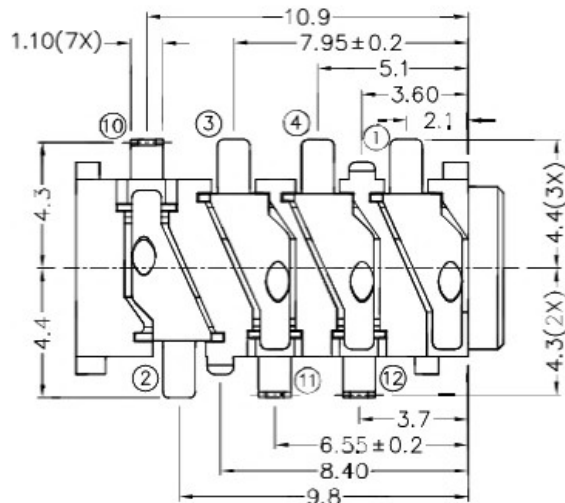
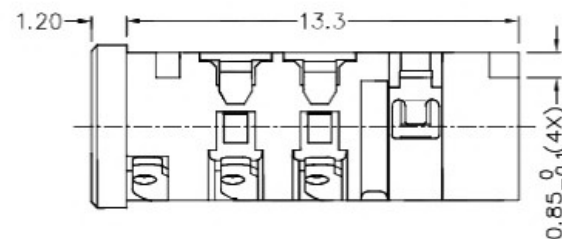
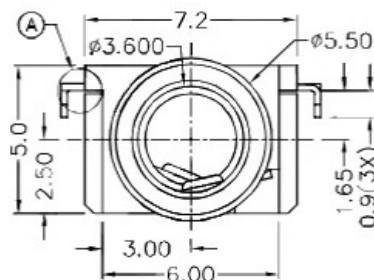

\* MATERIAL

TERMINAL 1 : COPPER ALLOY  
 TERMINAL 2 : COPPER ALLOY  
 TERMINAL 3 : COPPER ALLOY  
 TERMINAL 4 : COPPER ALLOY  
 TERMINAL 10 : BRASS  
 TERMINAL 11 : BRASS  
 TERMINAL 12 : BRASS  
 HOUSING : HIGH TEMP. PLASTIC

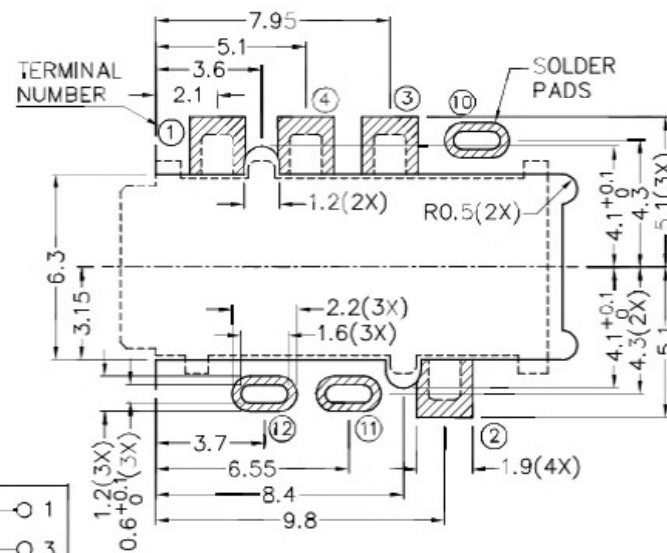

RECOMMENDED PCB LAYOUT  
 TOLERANCE: ±0.05  
 (TOP VIEW)

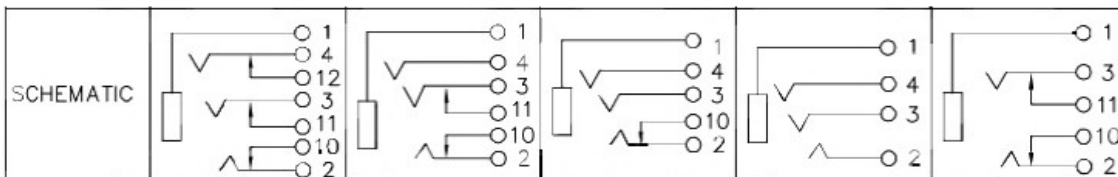
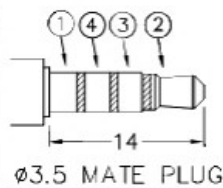

广东科斯达开关厂

PART NAME 3.5mm SMD STEREO JACK

TOLERANCE UNLESS 0.0±0.2  
 OTHERWISE SPECIFIED: 0.00±0.1  
 0.000±0.05

UNIT: mm



DESIGN	T.Y.LI	DATE	26-6-2007	SCALE	4:1
DRAWING	J.H.ZHOU	DATE	6-10-2016	MATERIAL	*
CHECK	H.L.TAN	DATE	6-10-2016	DWG. NO.	TZ\SH398D-A/1.0
APPROVAL		DATE	6-10-2016	SHEET	

F

E

D

C

B

A