

F

E

D

C

B

A

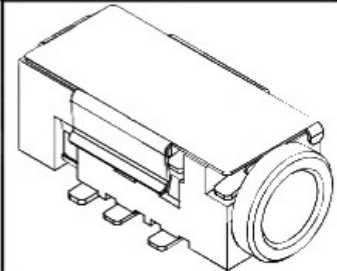

RoHS  
Compliant

ZONE	SYMBOL	REVISION	APPROVAL	DATE

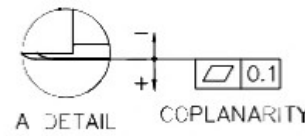
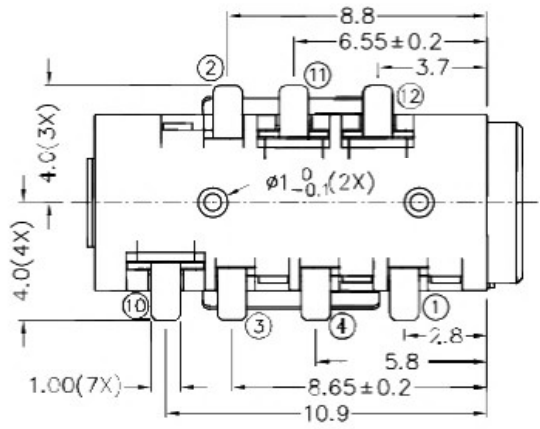
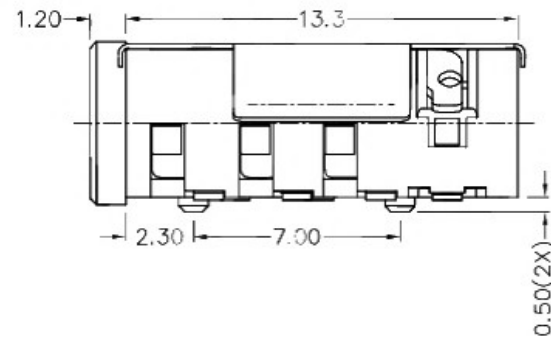
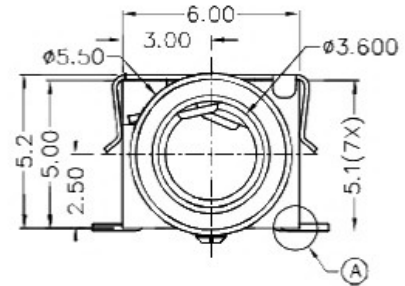
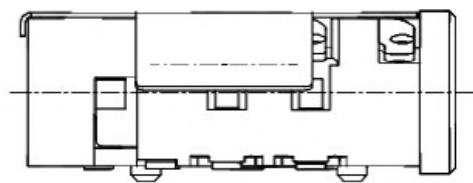

- \* MATERIAL
- TERMINAL 1 : COPPER ALLOY
  - TERMINAL 2 : COPPER ALLOY
  - TERMINAL 3 : COPPER ALLOY
  - TERMINAL 4 : COPPER ALLOY
  - TERMINAL 10 : BRASS
  - TERMINAL 11 : BRASS
  - TERMINAL 12 : BRASS
  - SHIELD : STAINLESS STEEL
  - HOUSING : HIGH TEMP. PLASTIC

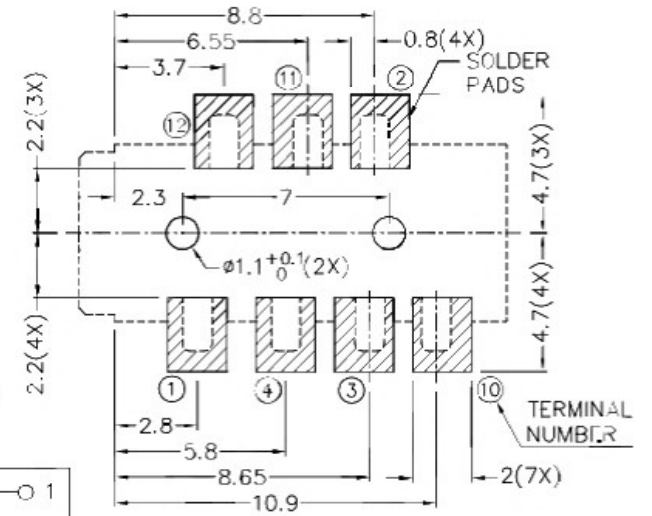
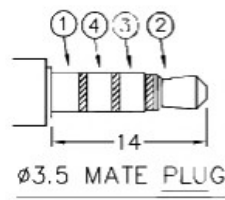

RECOMMENDED PCB LAYOUT  
TOLERANCE: ±0.05  
(TOP VIEW)

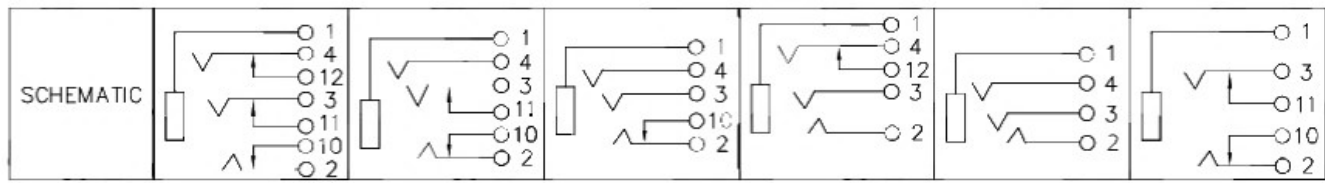

广东科斯达开关厂

DESIGN	T.Y.LI	DATE	23-3-2006	SCALE	4:1
DRAWING	J.CH.OU	DATE	28-9-2016	MATERIAL	*
CHECK	H.L.TAN	DATE	28-9-2016	DWG. NO.	TZ\SH3910S1-A/1.0
APPROVAL		DATE	28-9-2016	SHEET	

PART NAME	3.5mm SMI STEREO JACK W/HANDING SHIELD	TOLERANCE UNLESS	0.0±0.2	UNIT:	
PART NO.		OTHERWISE SPECIFIED:	0.00±0.1 0.000±0.05	mm	

F

E

D

C

B

A