

1. FUNCTION: OFF-ON  
OFF-ON

2. RATING: UI: 12(6)A 125/250VAC 26T125 5E4  
ENEC VDE/CQC: 6/10A 250V~ μ T105 12(4)A 250V~ μ T105  
TUV/CE: 6/10A 250V~ T105  
KC: 12(4)A 250V~ T105

3. OPERATION FORCE: 700±300g.f

4. CONTACT RESISTANCE: ≤ 50 mΩ

5. INSULATION RESISTANCE ≥ 100 MΩ

6. DIELECTRIC WITHSTAND: TERMINAL TO BUTTON 3000VAC/5mA/1MINUTE  
TERMINAL TO TERMINAL 1500VAC/5mA/1MINUTE

7. CIRCUIT DIAGRAM:

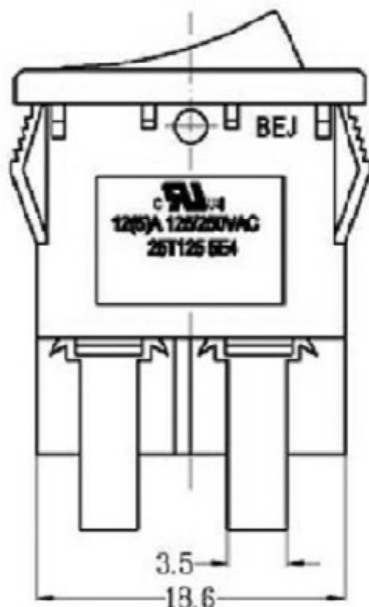
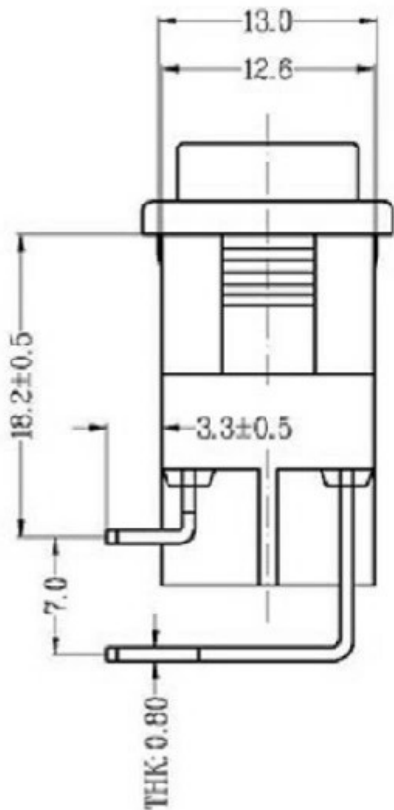
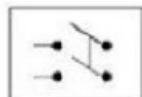

8. SUGGESTED PANEL HOLE SIZE:

PANEL THICKNESS	DIM.X
0.75-1.25	19.2/19.1
1.25-2.0	19.4/19.3
2.0-3.0	19.6/19.7

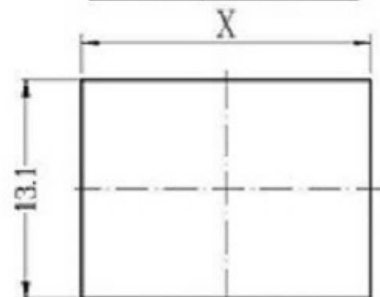

PANEL CUT-OUT

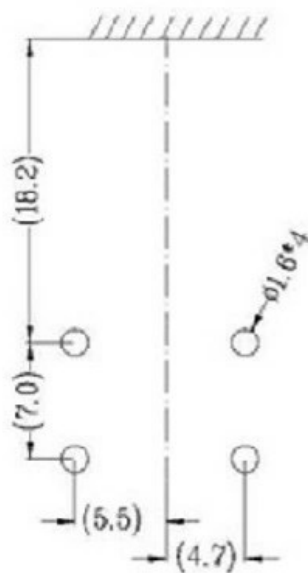

A4				普通公差:	 <b>广东科斯达电子科技有限公司</b> Guang dong Keside Electronic Technology Co., Ltd.							
A3				COMMON TOLERANCE:								
A2				UP TO 5	±0.20	单位	mm	投影	品名	跳板开关	比例	Free
A1				ABOVE 5 TO 30	±0.30	UNIT		PROJECTED	PRODUCT NAME		SCALE	
REV.	DATE	REVISION DESCRIPTION	ISSUE	ANGULAR	±5°	绘图	周金勇	核对	梁金勇	型号	KSD-AC SWITCH	
						DRAWN BY		CHECKED BY		MODEL NO.		
						日期	2015.8.17	核准	周培雷	图号		
						DATE		APPROVAL BY		DWG NO.		