

DATE	DR.BY	ECN.NO.	DESCRIPTION	MARK	VER.
18/12'06			NEW DWG		A0

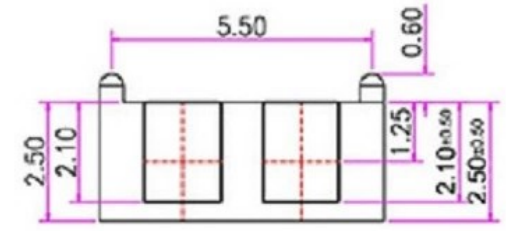
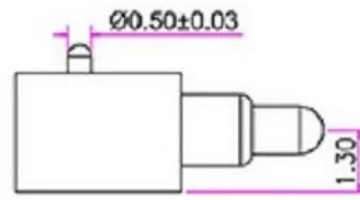
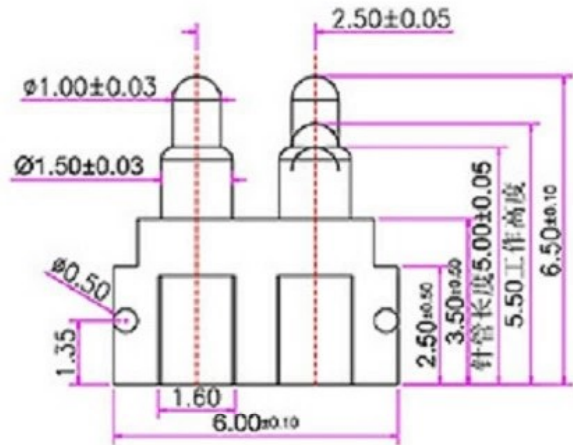

1. 材料和电镀

接触头为(斜头)黄铜合金(C3604), 镀镍50-70 μ"镀金1 μ"  
 导管为黄铜合金(C3604), 镀镍50-70 μ"镀金1 μ"

2. 塑胶材质

PA46+30%玻纤

3. 弹力: 120g±10%

4. 持续工作电流: 1A

5. 工作电压: 12V AC/DC

接触电阻: 30mOhm Max

6. 使用寿命: 20000次

7. 工作温度计: -40℃ - 80℃ 90% R. H. Max

8. 中性盐雾测试24小时无锈蚀

-TOLERANCES- UNLESS OTHERWISE SPECIFIED 公差参考表			<b>TITLE:</b> 产品品名: POGO PIN <b>PRODUCT NO:</b> 产品料号:										
X. ±0.10	X'. ±2.00'												
XX ±0.05	XX' ±1.00'	<b>APPD:</b> 核准:	<table border="1"> <tr> <td>DATE</td> <td>SCALE</td> <td>UNIT</td> <td>TYPE</td> <td>PAGE</td> </tr> <tr> <td>2016.11.21</td> <td>1:1</td> <td>mm</td> <td>CD</td> <td>1/1</td> </tr> </table>	DATE	SCALE	UNIT	TYPE	PAGE	2016.11.21	1:1	mm	CD	1/1
DATE	SCALE	UNIT		TYPE	PAGE								
2016.11.21	1:1	mm		CD	1/1								
XXX ±0.02		<b>CHECK:</b> 校对:											
X.XXX		<b>DRAW:</b> 绘图: 王芬利											



**TITLE:**  
产品品名: POGO PIN  
**PRODUCT NO:**  
产品料号:

DATE	SCALE	UNIT	TYPE	PAGE
2016.11.21	1:1	mm	CD	1/1