

|          |       |         |             |      |      |
|----------|-------|---------|-------------|------|------|
| DATE     | DR.BY | ECN.NO. | DESCRIPTION | MARK | VER. |
| 18/12'06 |       |         | NEW DWG     |      | AO   |

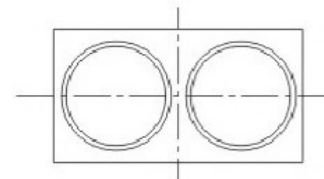
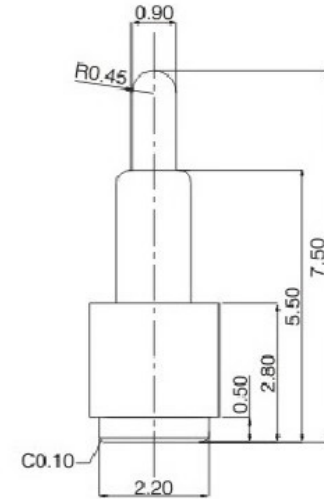
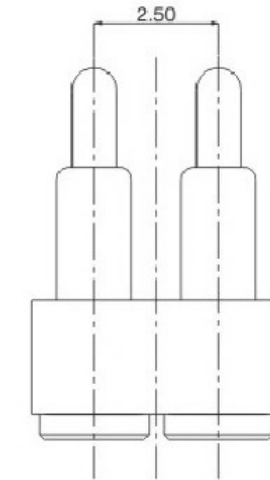
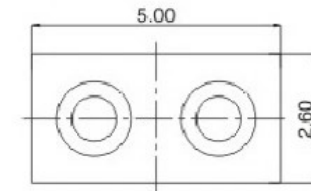

**NOTE:**

PRODUCT TO BE MET ROHS

**1.MATERIAL**

HOUSING: PA46+30%GF,UL94V-0,COLOR: BLACK

PLUNGER: BRASS,3u" GOLD PLATING

50u" MIN.NICKEL UNDERPLATEE.

BARREL:BRASS,3u" GOLD PLATING OVER

50u"MIN.NICKEL UNDER PLATED

SPRING:SUS304

**2.SPECIFICATION**

ELECTRICAL

CURRENT RATNG: 12VDC,1A

INSULATION RESISTANCE:100m Min

ENVIRONMENTAL

TEMPERATURE RANGE: -40°C ~85°C

**3.MECHANICAL FUNCTION**

SPRING PROBE FORCE

WORKING STROKE:100g±20gf AT 1.00mm RECOMMEND STROE

MAX.STROKE:1.30MM FULL STROKE

DURABILITY:10,000 CYCLES/1.00mm STROKE

**1. 材料和电镀**

接触头为(斜头)黄铜合金(C3604), 镀镍50-70 μ"镀金1 μ"

导管为黄铜合金(C3604), 镀镍50-70 μ"镀金1 μ"

**2. 塑胶材质**

PA46+30%玻纤

**3. 弹力: 120g±10%**

**4. 持续工作电流: 1A**

**5. 工作电压: 12V AC/DC**

接触电阻: 30mOhm Max

**6. 使用寿命: 20000次**

**7. 工作温度计: -40°C - 80°C 90% R. H. Max**

**8. 中性盐雾测试24小时无锈蚀**

**-TOLERANCES-  
UNLESS OTHERWISE SPECIFIED  
公差参考表**

|       |       |      |        |
|-------|-------|------|--------|
| X.    | ±0.10 | X'   | ±2.00' |
| XX    | ±0.05 |      |        |
| XXX   | ±0.02 | X.X' | ±1.00' |
| X.XXX | ——    |      |        |



**广东科斯达开关厂**

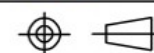

**TITLE:**  
产品品名: POGO PIN

**PRODUCT NO:**  
产品料号:

|               |     |            |       |      |      |      |
|---------------|-----|------------|-------|------|------|------|
| APPD:<br>核准:  | 王芬利 | DATE       | SCALE | UNIT | TYPE | PAGE |
| CHECK:<br>校对: |     | 2016.11.21 | 1:1   | mm   | CD   | 1/1  |
| DRAW:<br>绘图:  |     |            |       |      |      |      |
|               |     |            |       |      |      |      |