

**SPECIFICATIONS.**

**1. ELECTRICAL CHARACTERISTICS.**

- 1-1. RATING: 18.5V, 2A Min.
- 1-2. CONTACT RESISTANCE: 50 MILLIOHMS Max. FOR INITIAL, 80 MILLIOHMS Max. AFTER 5000 CYCLES
- 1-3. INSULATION RESISTANCE: 100 MEGAOHMS Min. BY 500V DC AFTER 1 MINUTE.
- 1-4. DIELECTRIC WITHSTANDING VOLTAGE: 500V RMS AFTER 1 MINUTE.

**2. MECHANICAL CHARACTERISTICS.**

- 2-1. INSERTION FORCE: 0.3~3.0 KGF (2.94~29.4N)
- 2-2. WITHDRAWAL FORCE: 0.3~3.0 KGF (2.94~29.4N)
- 3. LIFE TEST: 5,000 CYCLES MIN.

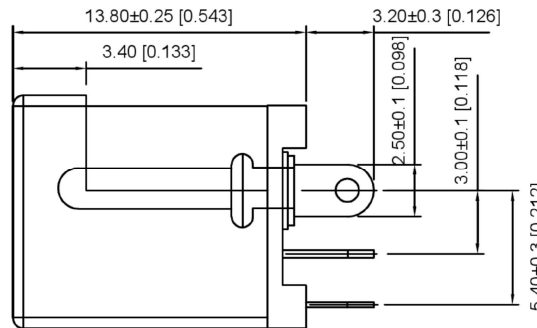
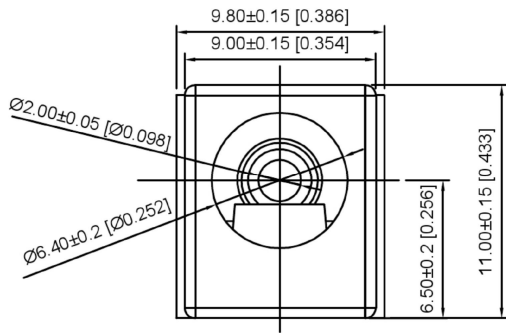

SCHEMATIC	
Model	DC-012A-5A
Center Pin	Ø2.5 mm
	Ø2.0 mm

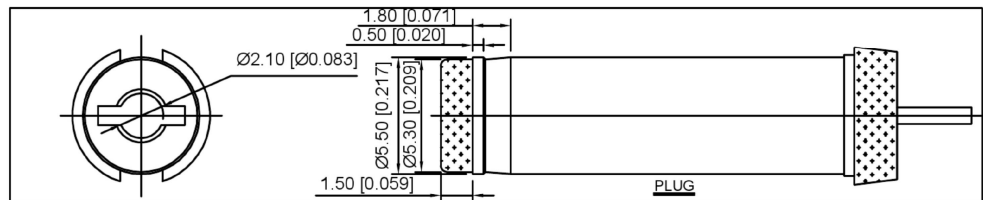

PART NAME	QTY	MATERIAL (THICK)	PLATING (COLOR)
HOUSING	1	SEE TABLE	BLACK
COVER	1	PA66	BLACK
PIN	1	H59	Ni-Plated
TERMINAL	1	C2680-EH T=0.35	Ag-Plated
TERMINAL	1	C5210-EH T=0.25	Ag-Plated
TERMINAL	1	C2680-EH T=0.25	Ag-Plated

REVISIONS				DATE	REVISED	APPROVED	UNSPECIFIED TOLERANCES	DSND	SCALE: N/A	MODEL TYPE: DC POWER JACK	WEIGHT	SHEET	REVISION
<p style="text-align: center;">WWW.BODONGKAIGUAN.NET    WWW.CKJACK.COM    WWW.KSDKG.COM</p>													