

### SPECIFICATION

Contact Rating: 50mA 12V DC  
 Contact Resistance: 100mΩ max  
 Insulation Resistance: 100MΩ min.500V DC  
 Dielectric Strength: 250V AC/1 minute  
 Travel: 0.15mm  
 Operating Temp: -25 °C +70 °C  
 Storage Temp: -30 °C +80 °C

PAPT NO	TS-1010GS-X
Operating Force	A:100gf B:160gf C:260gf
Height	H:3.05

### CIRCUIT

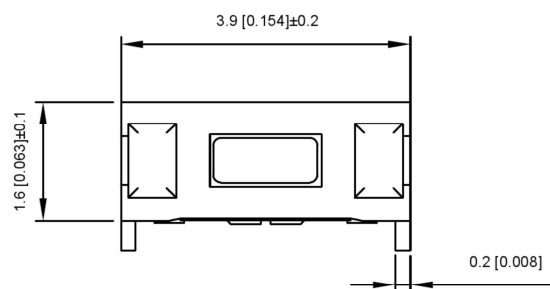
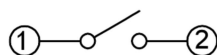

### P.C.B LATOUT

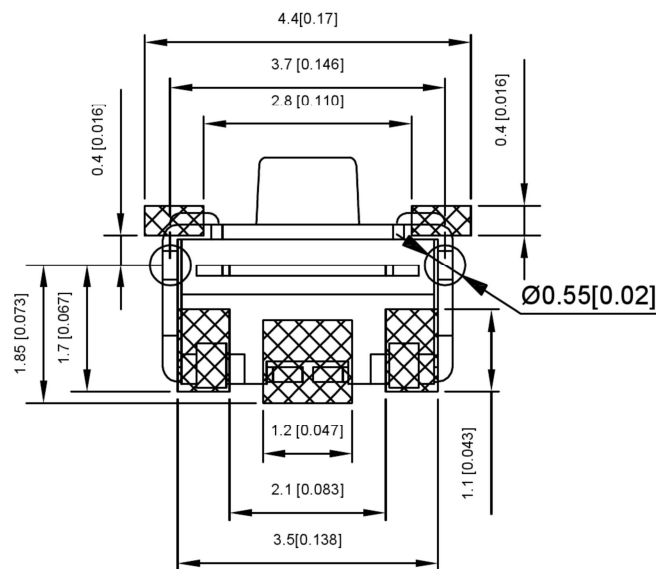

ITEM	PAPT NAMF	TER,NO	QTY	MATERIAL	FINISHING	REMARK
⑤	Terminal	—	2	Brass (0.30t)	ag Plated	—
④	Contact	—	2	F.ag/SUS	—	—
③	Base	—	1	LCP	Natural	—
②	Cover	—	1	Brass	Tin plated	—
①	Keystake	—	1	LCP	—	—

DSND		SCALE: N/A	MODEL TYPE: TACT SWITCH
DWN		VIEW:	PART NO.: TS-1010GS-X
CHKD		UNIT: mm/in	DWG NO.:
APPD		SIZE: A4	
		WEIGHT	SHEET
			1/1
		REVISIC	A0

**KSD**  
SWITCH CONNECTOR

KE SI DA ELECTRONIC TECHNOLOGY CO., LTD

ANGLAR ±5°  
 L ≤ 4 ±0.2  
 4 < L ≤ 16 ±0.3  
 16 < L ≤ 63 ±0.4  
 L > 63 ±0.5

UNSPECIFIED TOLERANCES

DATE REVISED APPROVED