

Rated range:50mA DC12V
 Insulation resistance:≥100MΩmin (DC100V)
 Contact resistance:≤300mΩ
 Compressive strength:AC100V(50/60Hzfof1minute)
 Mechanical life:50000 cycles
 Operating temperature:-10°C~+60°C
 Operation strength:50±30gf

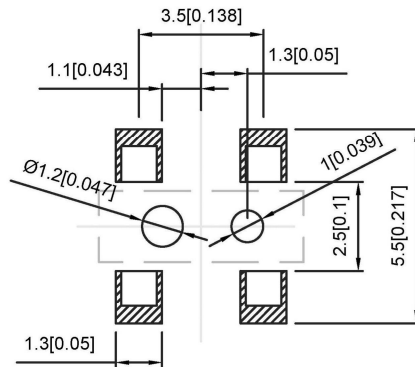

PCB

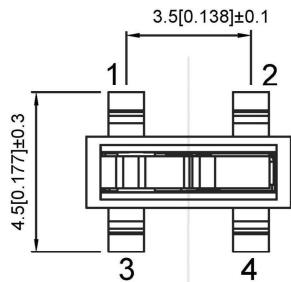
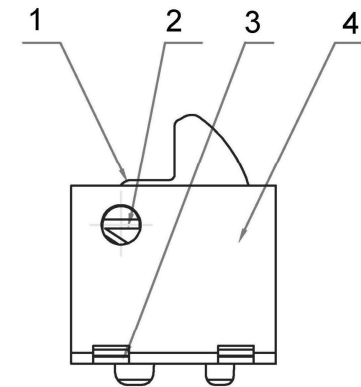
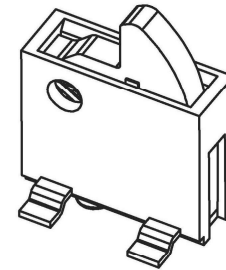
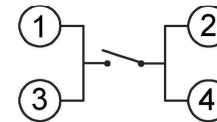

4	Button	1	PPA	black
3	Spring	1	Phosphorous copper	plate with silver
2	Welding foot	1	correrH62-0.2	silvery
1	Pedestal	1	PPA	black
ITEM	PAPT NAMF	QTY	Material	colour

				ANGLAR	±5°	 SWITCH CONNECTOR	DSND		SCALE: N/A	MODEL TYPE: DETECT SWITCH			
				L ≤ 4	±0.2		DWN		VIEW:	PART NO.: TM-1627S			
				4 < L ≤ 16	±0.3		CHKD		UNIT: mm/in	DWG NO.:			
				16 < L ≤ 63	±0.4		APPD		SIZE: A4				
				L > 63	±0.5	UNSPECIFIED TOLERANCES				WEIGHT	SHEET	REVISION	
REVISIONS				DATE	REVISED	APPROVED	KE SI DA ELECTRONIC TECHNOLOGY CO., LTD				1/1	A0	
WWW.BODONGKAIGUAN.NET				WWW.CKJACK.COM		WWW.KSDKG.COM							