

REV	DESCRIPTION	DESIGN	DATE
A	NEW RELEASE	蒋建银	2020/12/16

PIN.	DIM A	DIM B
2pin	1.50	4.10
3pin	3.00	5.60
4pin	4.50	7.10
5pin	6.00	8.60
6pin	7.50	10.10
7pin	9.00	11.60
8pin	10.50	13.10
9pin	12.00	14.60
10pin	13.50	16.10
11pin	15.00	17.60
12pin	16.50	19.10
13pin	18.00	20.60
14pin	19.50	22.10
15pin	21.00	23.60

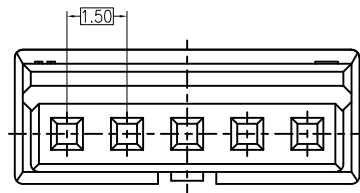
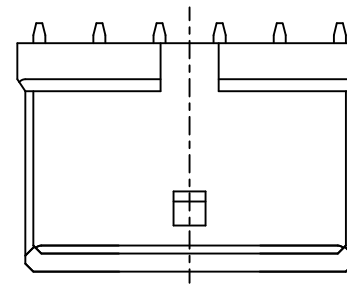
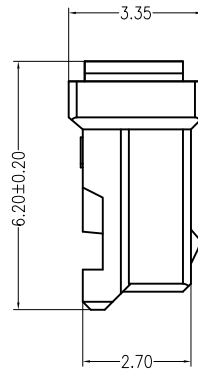
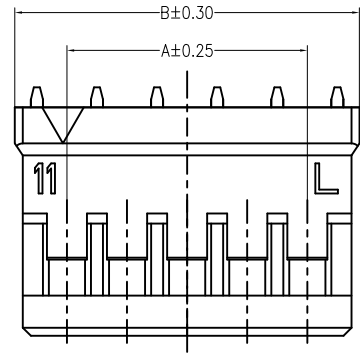
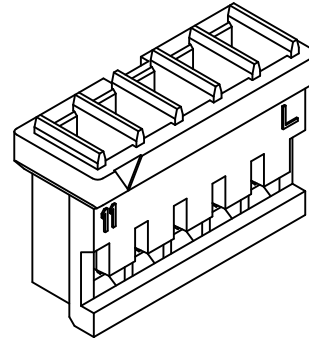
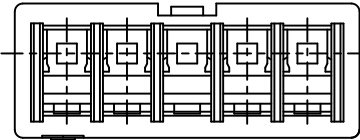

Specifications:

Contact resistance: $\leq 20m\Omega$
 Insulation resistance: $\geq 500M\Omega$
 Rated voltage: 250V AC DC
 Rated current: 3.0A AC DC
 Withstand Voltage: 1000V AC/minute
 Temperature Range: $-25^{\circ}C \sim +85^{\circ}C$
 Housing: PA66 UL94V-0, White

ORDER INFORMATION:

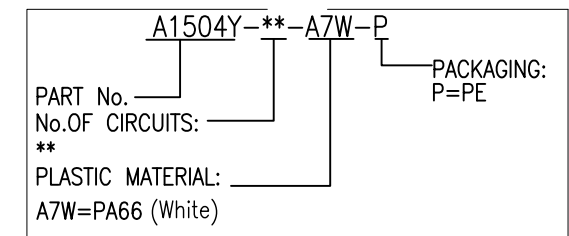

广东科斯达电子科技有限公司 GUANG DONG KE SI DA ELECTRONIC TECHNOLOGY CO., LTD.		TITLE: 1.5mm housing	
		PART NO.: A1504Y-**-A7W-P	
GENERAL TOLERANCE		USE: CUSTOMER	
X. ±0.50	X. ±5°	APPD: 王锋	
X.X ±0.30	X.X ±2°	CHKD: 曾令青	
X.XX ±0.20	X.XX ±1°	DR: 蒋建银	
UNITS: mm		SCALE 1 : 1	SHEET 1 / 1

REV	DESCRIPTION	DESIGN	DATE
A	NEW RELEASE	蒋建银	2020/12/16

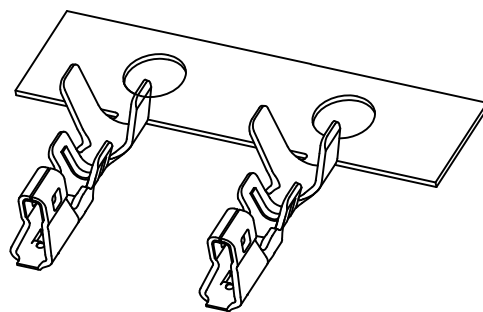
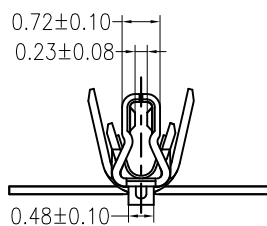
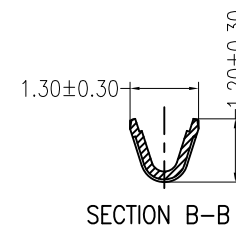
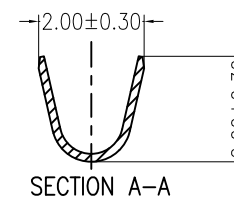
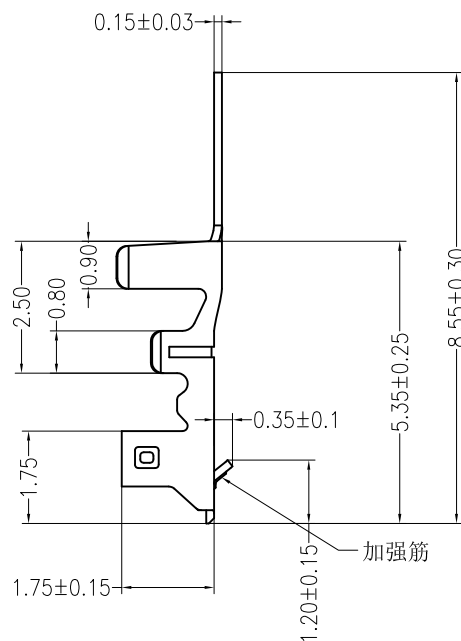
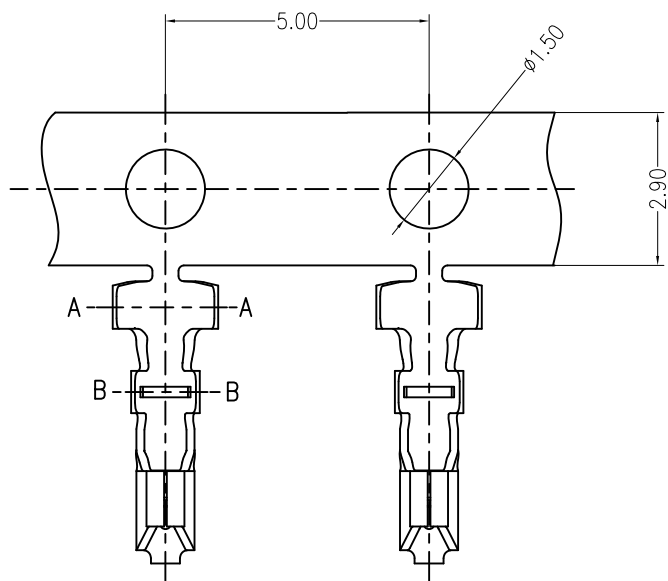

Ordering Information & Specification:

Part No	Wire Range	Insulation O.D.	Material	Finish	Qty/Reel
A1504T	AWG #24~#26	0.95~1.20mm	Phosphor bronze	Sn-plated	

广东科斯达电子科技有限公司 GUANG DONG KE SI DA ELECTRONIC TECHNOLOGY CO., LTD.		TITLE: 1.5mm Terminal	
		PART NO.: A1504T端子	
GENERAL TOLERANCE		USE: CUSTOMER	
X. ±0.50	X. ±5°	APPD: 王锋	
X.X ±0.30	X.X ±2°	CHKD: 曾令青	
X.XX ±0.20	X.XX ±1°	DR: 蒋建银	
UNITS: mm		SCALE 1 : 1	SHEET 1 / 1

A | B | C | D | E | F

REV	DESCRIPTION	DESIGN	DATE
A0	NEW RELEASE	Jiangjianyin	2018/01/20

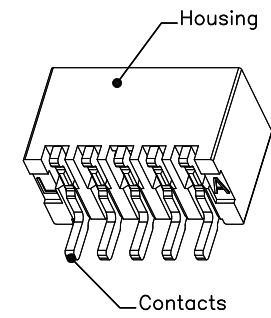
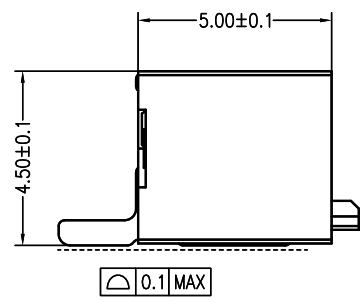
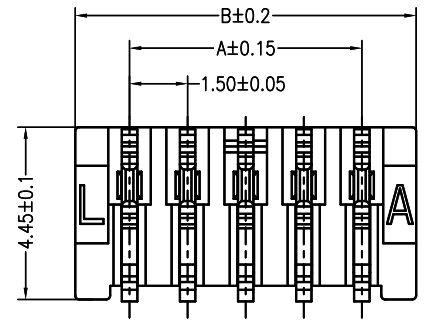

3D VIEWS

PIN.	DIM A	DIM B	DIM C
2pin	1.50	4.30	3.70
3pin	3.00	5.80	5.20
4pin	4.50	7.30	6.70
5pin	6.00	8.80	8.20
6pin	7.50	10.30	9.70
7pin	9.00	11.80	11.20
8pin	10.50	13.30	12.70
9pin	12.00	14.80	14.20
10pin	13.50	16.30	15.70
11pin	15.00	17.80	17.20
12pin	16.50	19.30	18.70
13pin	18.00	20.80	20.20
14pin	19.50	22.30	21.70
15pin	21.00	23.80	23.20

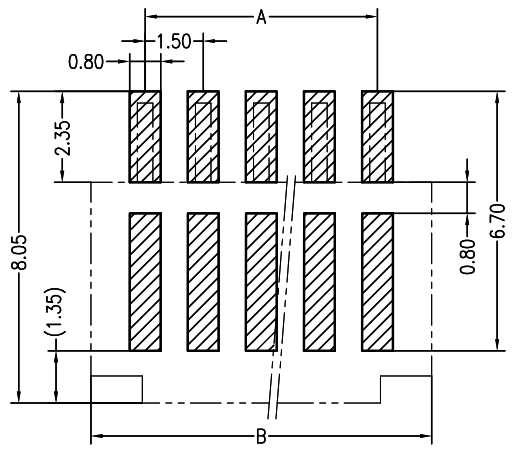
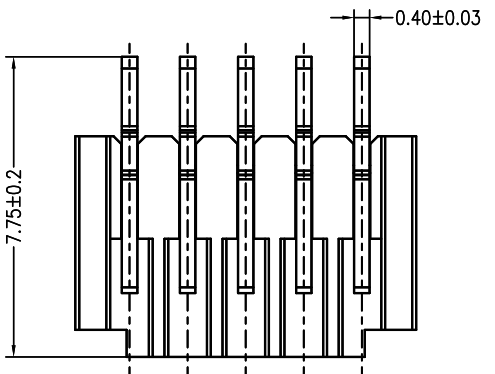

SUGGESTED PCB LAYOUT

Specifications:

- Contact resistance: ≤20mΩ
- Insulation resistance: ≥1000MΩ
- Rated voltage: 350V AC DC
- Rated current: 3.0A AC DC
- Withstand voltage: 500V AC/minute
- Temperature range: -25°C ~ +85°C
- Housing: LCP UL94V-0, BLACK
- Contacts: Phosphor bronze/MATTE Sn

ORDER INFORMATION:

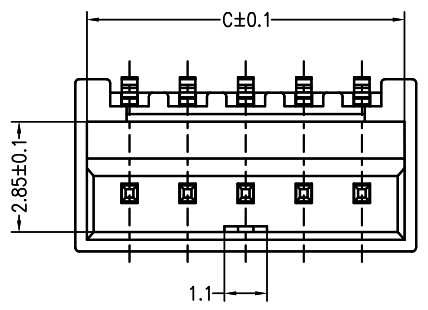
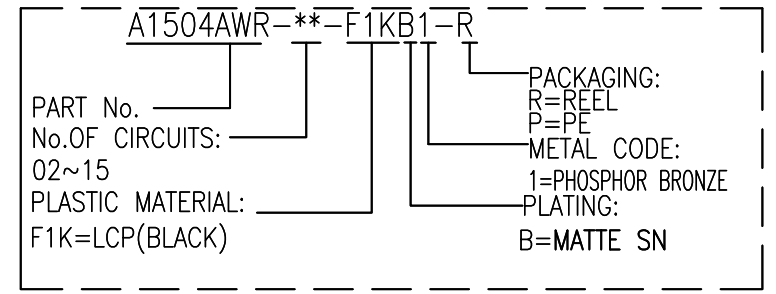

广东科斯达电子科技有限公司 GUANG DONG KE SI DA ELECTRONIC TECHNOLOGY CO., LTD.		TITLE: 1.50mmPITCH 90°WAFER SMT TYPE	
GENERAL TOLERANCE X. ±0.50 X. ±5° X.X ±0.30 X.X ±2° X.XX ±0.20 X.XX ±1°		PART NO.: A1504AWR-**-F1KB1-R	
UNITS: mm		DWG NO.: GCKH-0746	
USE: CUSTOMER APPD: Shaojinghe CHKD: Zenglingqing DR: Jiangjianyin		SCALE 1 : 1	
		SHEET 1 / 1	

A | B | C | D | E | F

A

B

C

D

E

F

REV	DESCRIPTION	DESIGN	DATE
AO	NEW RELEASE	Jiangjianyin	2018/01/20

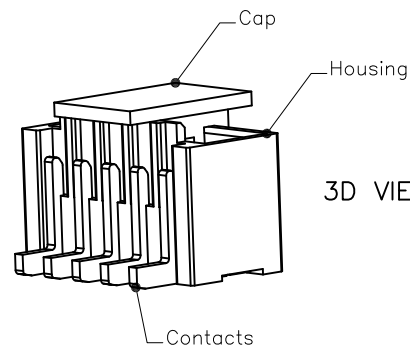
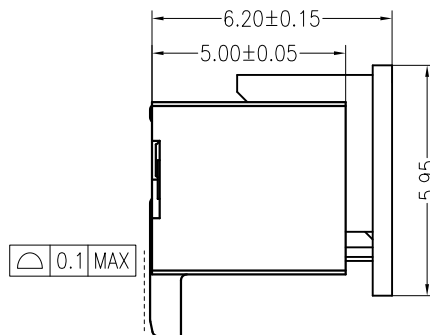
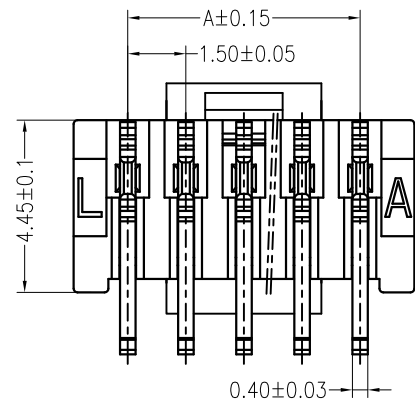

3D VIEWS

PIN.	DIM A	DIM B	DIM C
2pin	1.50	4.30	3.70
3pin	3.00	5.80	5.20
4pin	4.50	7.30	6.70
5pin	6.00	8.80	8.20
6pin	7.50	10.30	9.70
7pin	9.00	11.80	11.20
8pin	10.50	13.30	12.70
9pin	12.00	14.80	14.20
10pin	13.50	16.30	15.70
11pin	15.00	17.80	17.20
12pin	16.50	19.30	18.70
13pin	18.00	20.80	20.20
14pin	19.50	22.30	21.70
15pin	21.00	23.80	23.20

Specifications:

Contact resistance: $\leq 20m\Omega$
 Insulation resistance: $\geq 1000M\Omega$
 Rated voltage: 350V AC DC
 Rated current: 3.0A AC DC
 Withstand voltage: 500V AC/minute
 Temperature range: $-25^{\circ}C \sim +85^{\circ}C$
 Housing: LCP UL94V-0, Natural
 Cap: LCP UL94V-0, Natural
 Contacts: Phosphor bronze/MATTE Sn

ORDER INFORMATION:

A1504AWV-**-F4MB1-R-X	
PART No.	X:CAP
No.OF CIRCUITS:	PACKAGING:
02~15	R=REEL
PLASTIC MATERIAL:	P=PE
F4M=LCP(NATURAL)	METAL CODE:
	1=PHOSPHOR BRONZE
	PLATING:
	B=MATTE SN

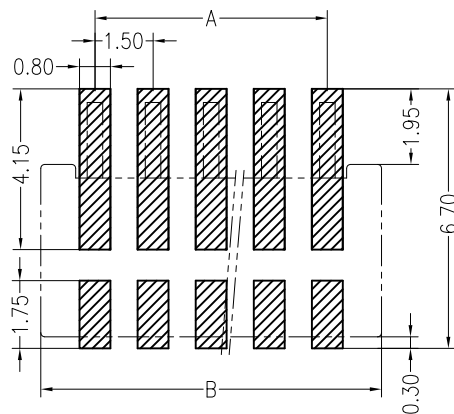
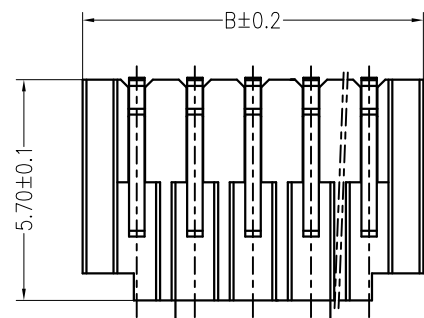

SUGGESTED PCB LAYOUT

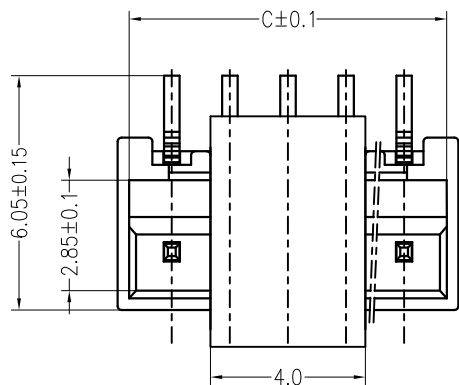

广东科斯达电子科技有限公司 GUANG DONG KE SI DA ELECTRONIC TECHNOLOGY CO., LTD.		TITLE: 1.50mmPITCH 180°WAFER SMT TYPE	
GENERAL TOLERANCE X. ±0.50 X. ±5° X.X ±0.30 X.X ±2° X.XX ±0.20 X.XX ±1°		PART NO.: A1504AWV-**-F4MB1-R-X	
UNITS: mm		DWG NO.: GCKH-0747	
USE: CUSTOMER APPD: Shaojinghe CHKD: Zenglingqing DR: Jiangjianyin		SCALE 1 : 1	
		SHEET 1 / 1	

REV	ECN No.	DESCRIPTION	DESIGN	DATE
A		Release	蒋建银	2017.10.22

产品引出方向

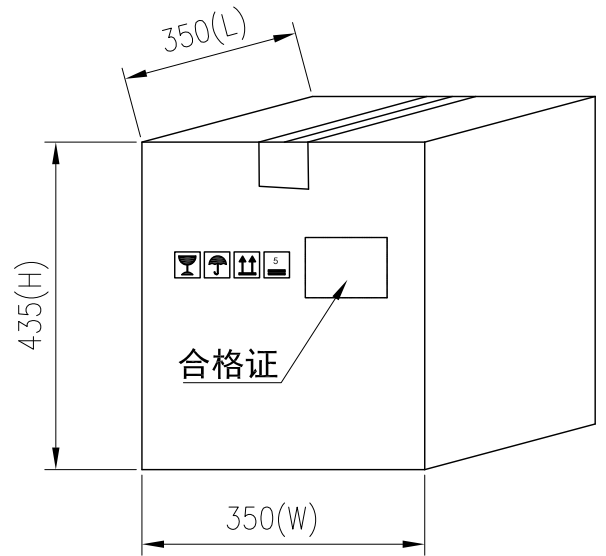
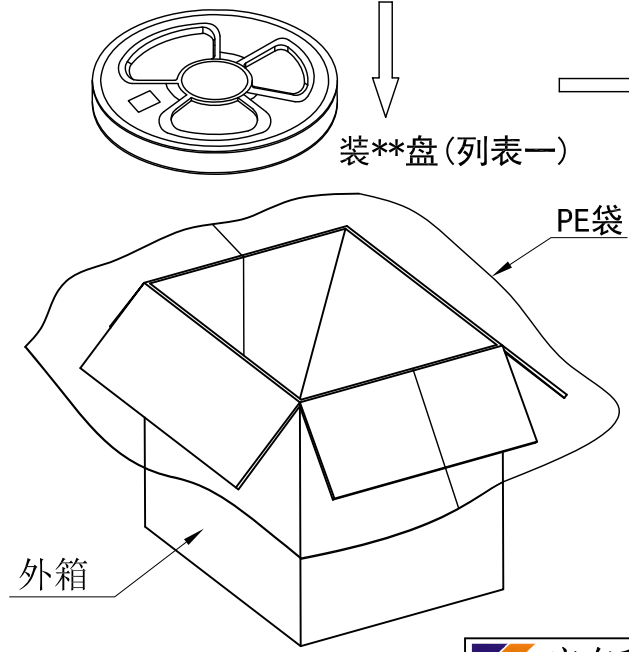
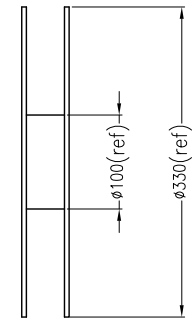
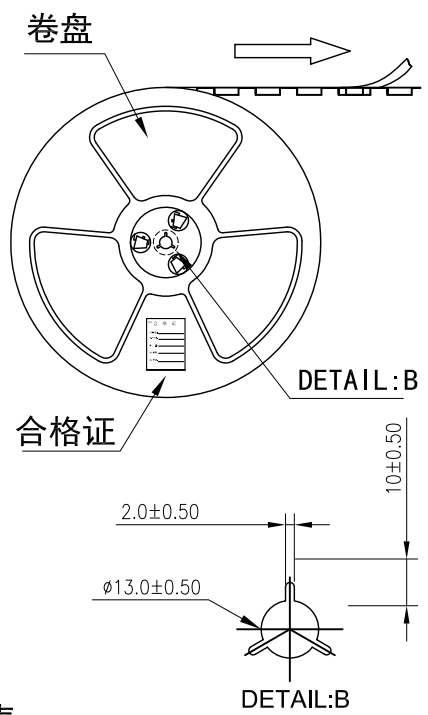
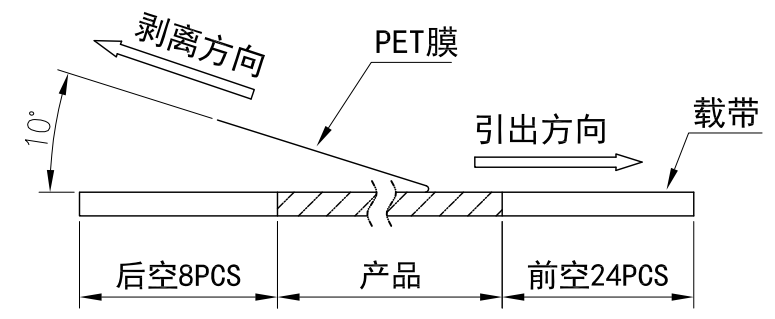
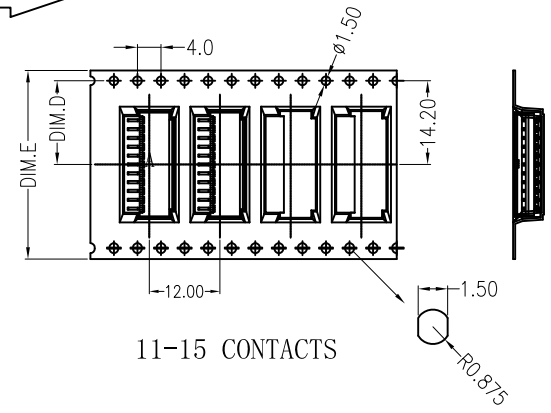
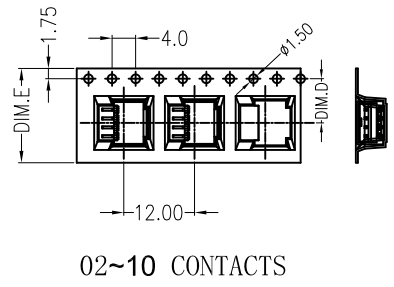

列表一

Circuits	DIM. D	DIM. E	Q'ty/Reel	Packing (Reel/Caton)
02~04PIN	7.5	16	1000PCS	20/Reel
05~10PIN	11.50	24	1000PCS	15/Reel
11~13PIN	14.20	32	1000PCS	11/Reel
14~15PIN	20.20	44	1000PCS	8/Reel

- 包装说明:
- 把成品包入卷盘中, 每盘装1000PCS, 卷盘上贴上合格证, 将装好产品的卷盘放进外箱中, 外箱内先套一个大PE袋, 外箱上贴贴上合格证.
 - 所有材料有害物控制需符合RoHS标准.

广东科斯达电子科技有限公司
GUANG DONG KE SI DA ELECTRONIC TECHNOLOGY CO., LTD.

X.± 0.5	X.±'	USE: CUSTOMER
.X± 0.3	.X±'	APPD: 邵敬和
.XX±0.25	.XX±'	CHKD: 田峰
--	--	DR: 蒋建银
UNITS: mm		

TITLE:
PART NO.: A1504AWR 卷装
DWG NO.: GCBZ-0746
SCALE: 1 : 1
SHEET: 1 / 1

REV	ECN No.	DESCRIPTION	DESIGN	DATE
A		Release	蒋建银	2018.08.22

产品引出方向

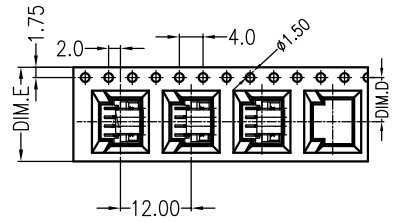
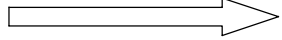

02~09 CONTACTS

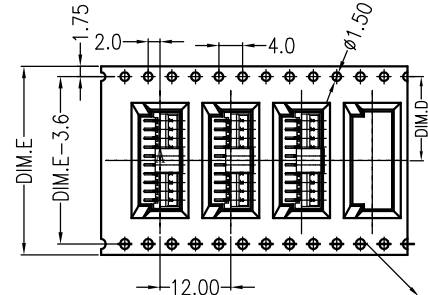

10~15 CONTACTS

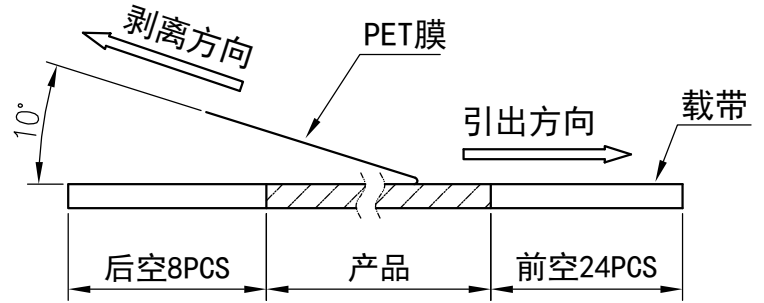

(PET膜剥离示意图)

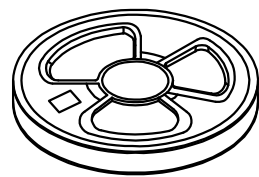
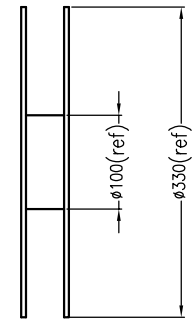
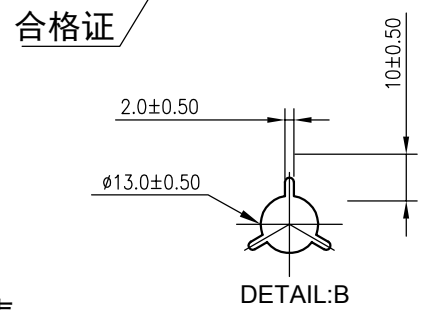
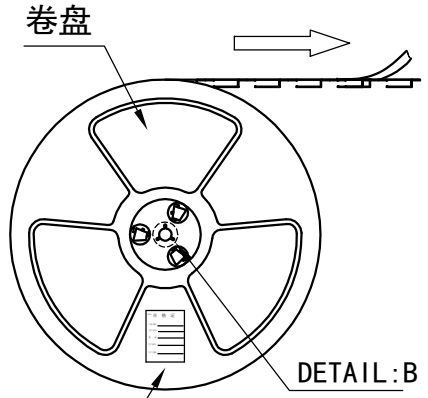

装**盘 (列表一)

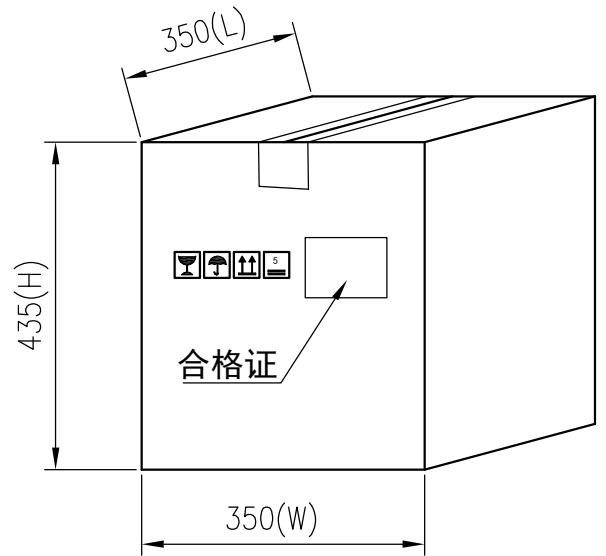
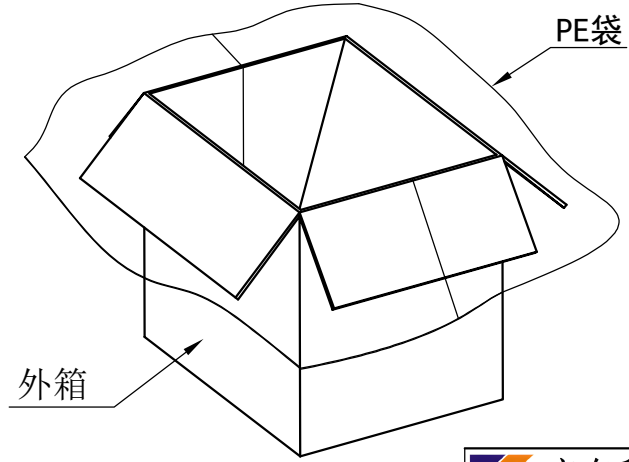

列表一

Circuits	DIM. D	DIM. E	Q'ty/Reel	Packing (Reel/Caton)
02~04PIN	7.5	16	800PCS	20/Reel
05~09PIN	11.50	24	800PCS	15/Reel
10~13PIN	14.20	32	800PCS	11/Reel
14~15PIN	20.20	44	800PCS	8/Reel

- 包装说明:
- 把成品包入卷盘中, 每盘装800PCS, 卷盘上贴上合格证, 将装好产品的卷盘放进外箱中, 外箱内先套一个大PE袋, 外箱上贴贴上合格证.
 - 所有材料有害物控制需符合 RoHS标准.

广东科斯达电子科技有限公司
GUANG DONG KE SI DA ELECTRONIC TECHNOLOGY CO., LTD.

X.± 0.5	X.±*	USE: CUSTOMER
.X± 0.3	.X±*	APPD: 邵敬和
.XX±0.25	.XX±*	CHKD: 田峰
--	--	DR: 蒋建银

UNITS: mm

TITLE:	
PART NO.:	A1504AWW 卷装
DWG NO.:	GCBZ-0747
SCALE	SHEET
1 : 1	1 / 1

REV	DESCRIPTION	DESIGN	DATE
A0	NEW RELEASE	Tianfeng	2018/06/28

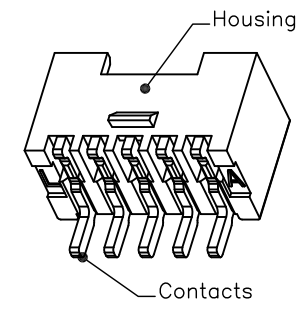
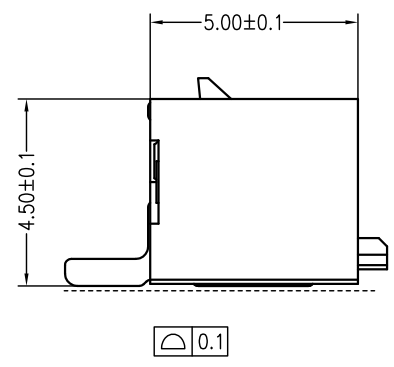
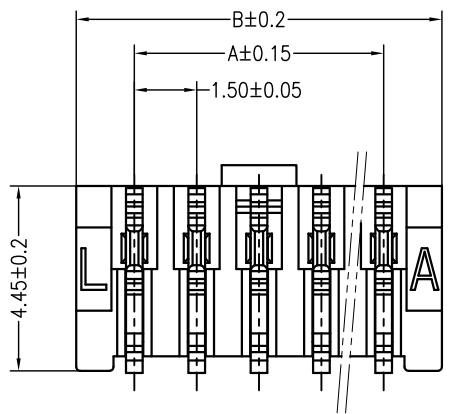

3D VIEWS

PIN.	DIM A	DIM B	DIM C
2pin	1.50	4.30	3.70
3pin	3.00	5.80	5.20
4pin	4.50	7.30	6.70
5pin	6.00	8.80	8.20
6pin	7.50	10.30	9.70
7pin	9.00	11.80	11.20
8pin	10.50	13.30	12.70
9pin	12.00	14.80	14.20
10pin	13.50	16.30	15.70
11pin	15.00	17.80	17.20
12pin	16.50	19.30	18.70
13pin	18.00	20.80	20.20
14pin	19.50	22.30	21.70
15pin	21.00	23.80	23.20

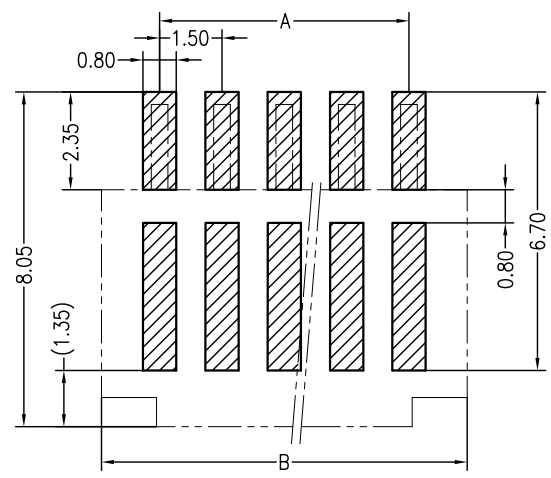
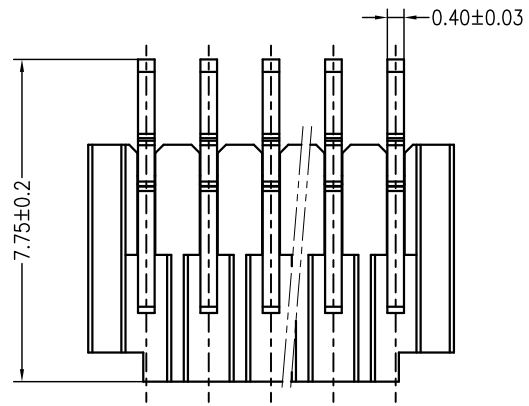

SUGGESTED PCB LAYOUT

Specifications:

- Poles: 02 to 15
- Contact resistance: $\leq 20m\Omega$
- Insulation resistance: $\geq 1000M\Omega$
- Rated voltage: 350V AC DC
- Rated current: 3.0A AC DC
- Withstand Voltage: 500V AC/minute
- Temperature Range: $-25^{\circ}C \sim +85^{\circ}C$
- Housing: LCP UL94V-0, Natural(Beige)
- Contacts: Phosphor Bronze/MATTE Sn

ORDER INFORMATION:

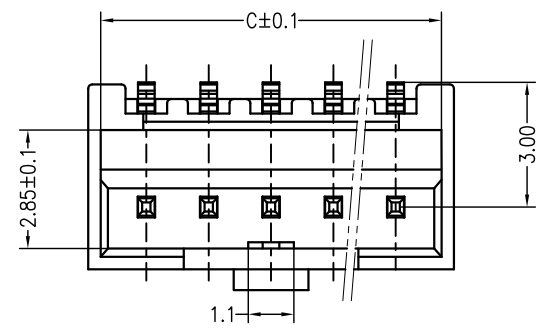
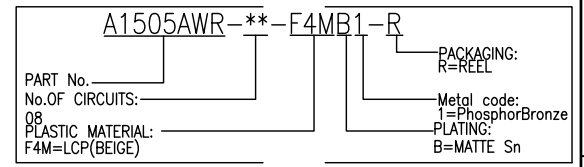

广东科斯达电子科技有限公司 GUANG DONG KE SI DA ELECTRONIC TECHNOLOGY CO., LTD.		TITLE: 1.5mmPITCH 90°WAFER SMT TYPE	
GENERAL TOLERANCE X. ± 0.50 X.X ± 0.30 X.XX ± 0.20		PART NO.: A1505AWR-**-F4MB1-R	
X. $\pm 5^{\circ}$ X.X $\pm 2^{\circ}$ X.XX $\pm 1^{\circ}$		DWG NO.: GCCP-0786	
UNITS: mm		SCALE 1 : 1	
USE: CUSTOMER		SHEET 1 / 1	
APPD: Shaojinghe			
CHKD: Tianfeng			
DR: Jiangjianyin			

REV	DESCRIPTION	DESIGN	DATE
A0	NEW RELEASE	Tianfeng	2018/06/28

PCB LAYOUT

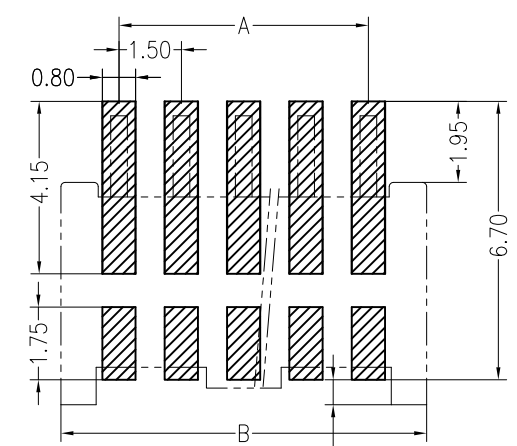

Specifications:

- Poles: 02 to 15
- Contact resistance: $\leq 20m\Omega$
- Insulation resistance: $\geq 1000M\Omega$
- Rated voltage: 350V AC DC
- Rated current: 3.0A AC DC
- Withstand Voltage: 500V AC/minute
- Temperature Range: $-25^{\circ}C \sim +85^{\circ}C$
- Housing: LCP UL94V-0, Natural (Beige)
- Contacts: Phosphor Bronze/MATTE Sn
- Cap: LCP UL94V-0, Natural (Beige)

ORDER INFORMATION:

A1505AWV--F4MB1-R-X**

PART No. _____	X: CAP
No. OF CIRCUITS: _____	PACKAGING:
QB _____	R=REL
PLASTIC MATERIAL: _____	B=BE
F4M=LCP(BEIGE)	Metal code:
	1=PhosphorBronze
	PLATING:
	B=MATTE Sn

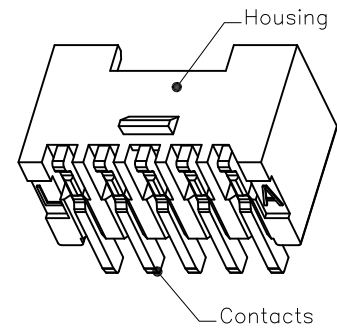
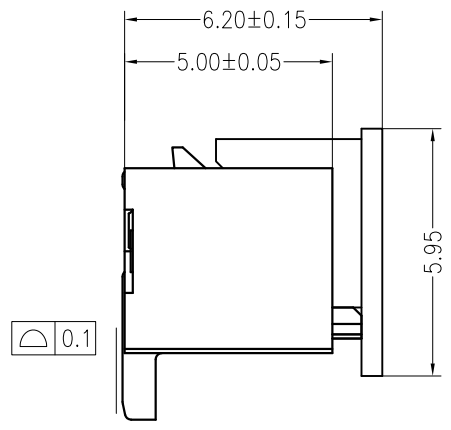
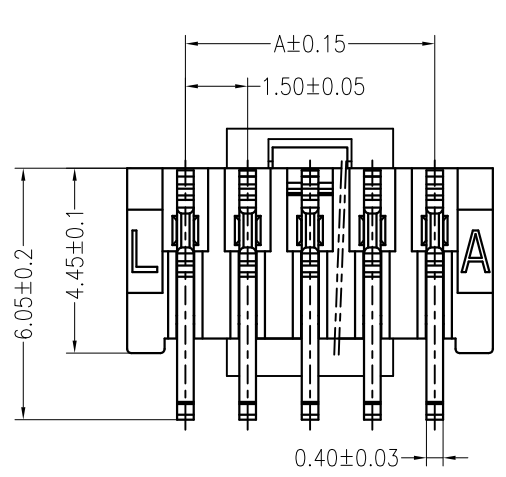

3D VIEWS

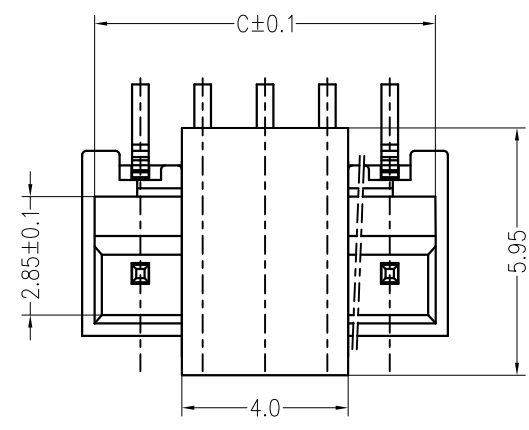
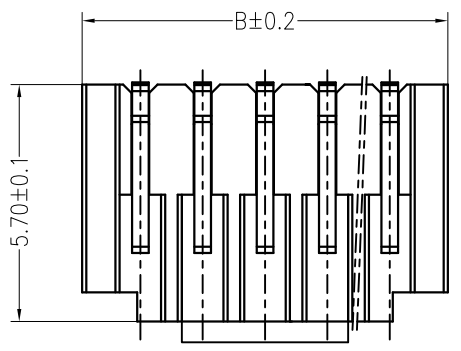

PIN.	DIM A	DIM B	DIM C
2pin	1.50	4.30	3.70
3pin	3.00	5.80	5.20
4pin	4.50	7.30	6.70
5pin	6.00	8.80	8.20
6pin	7.50	10.30	9.70
7pin	9.00	11.80	11.20
8pin	10.50	13.30	12.70
9pin	12.00	14.80	14.20
10pin	13.50	16.30	15.70
11pin	15.00	17.80	17.20
12pin	16.50	19.30	18.70
13pin	18.00	20.80	20.20
14pin	19.50	22.30	21.70
15pin	21.00	23.80	23.20

广东科斯达电子科技有限公司 GUANG DONG KE SI DA ELECTRONIC TECHNOLOGY CO., LTD.		TITLE: 1.5mmPITCH 180°WAFER SMT TYPE	
		PART NO.: A1505AWV-**-F4MB1-R-X	
GENERAL TOLERANCE		USE: CUSTOMER	
X. ±0.50	X. ±5°	APPD: Liuzhenling	
X.X ±0.30	X.X ±2°	CHKD: Wangliang	
X.XX ±0.20	X.XX ±1°	DR: Jiangjanyin	
UNITS: mm		SCALE 1 : 1	SHEET 1 / 1

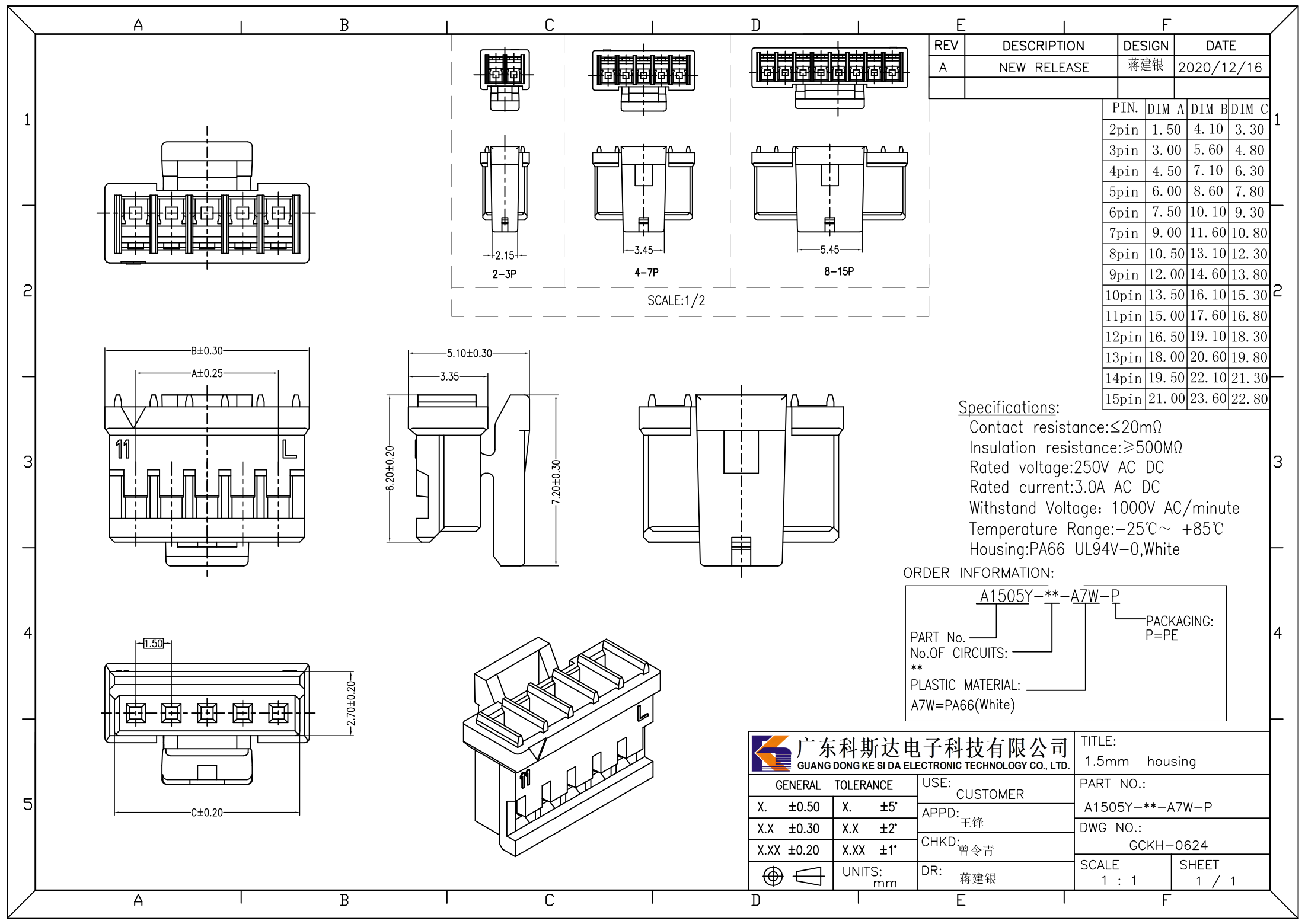

REV	DESCRIPTION	DESIGN	DATE
A	NEW RELEASE	蒋建银	2020/12/16

PIN.	DIM A	DIM B	DIM C
2pin	1.50	4.10	3.30
3pin	3.00	5.60	4.80
4pin	4.50	7.10	6.30
5pin	6.00	8.60	7.80
6pin	7.50	10.10	9.30
7pin	9.00	11.60	10.80
8pin	10.50	13.10	12.30
9pin	12.00	14.60	13.80
10pin	13.50	16.10	15.30
11pin	15.00	17.60	16.80
12pin	16.50	19.10	18.30
13pin	18.00	20.60	19.80
14pin	19.50	22.10	21.30
15pin	21.00	23.60	22.80

SCALE:1/2

Specifications:

- Contact resistance: ≤20mΩ
- Insulation resistance: ≥500MΩ
- Rated voltage: 250V AC DC
- Rated current: 3.0A AC DC
- Withstand Voltage: 1000V AC/minute
- Temperature Range: -25°C ~ +85°C
- Housing: PA66 UL94V-0, White

ORDER INFORMATION:

PART No. A1505Y-**-A7W-P
 No. OF CIRCUITS: _____
 ** _____
 PLASTIC MATERIAL: _____
 A7W=PA66(White)

PACKAGING:
P=PE

广东科斯达电子科技有限公司 GUANG DONG KE SI DA ELECTRONIC TECHNOLOGY CO., LTD.		TITLE: 1.5mm housing	
GENERAL TOLERANCE X. ±0.50 X. ±5° X.X ±0.30 X.X ±2° X.XX ±0.20 X.XX ±1°		PART NO.: A1505Y-**-A7W-P	
UNITS: mm		DWG NO.: GCKH-0624	
USE: CUSTOMER APPD: 王锋 CHKD: 曾令青 DR: 蒋建银		SCALE 1 : 1	
		SHEET 1 / 1	

REV	ECN No.	DESCRIPTION	DESIGN	DATE
A		Release	蒋建银	2017.10.22

产品引出方向

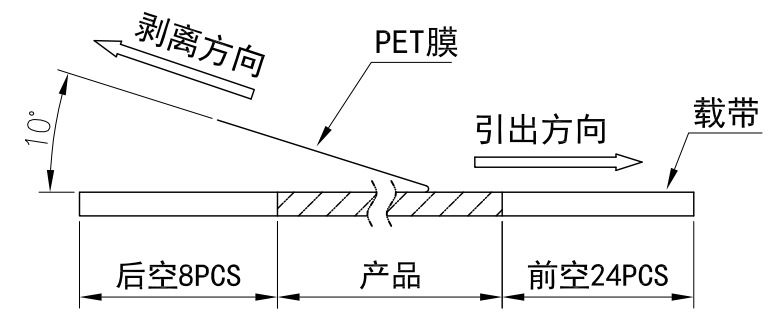
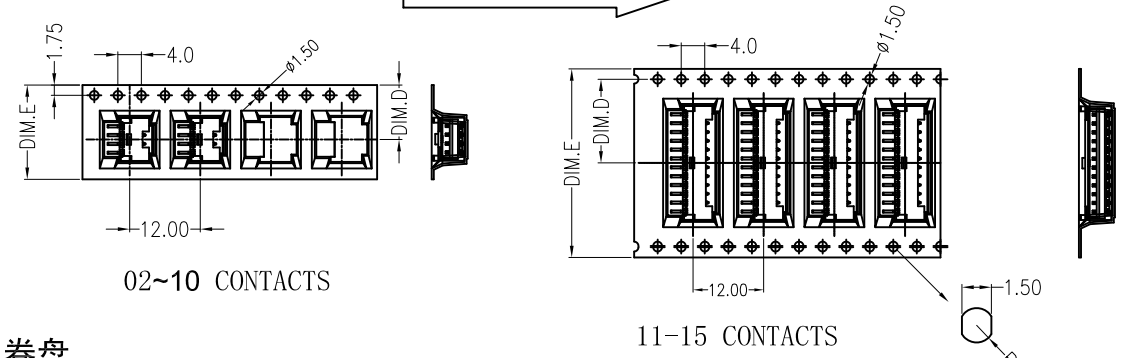

(PET膜剥离示意图)

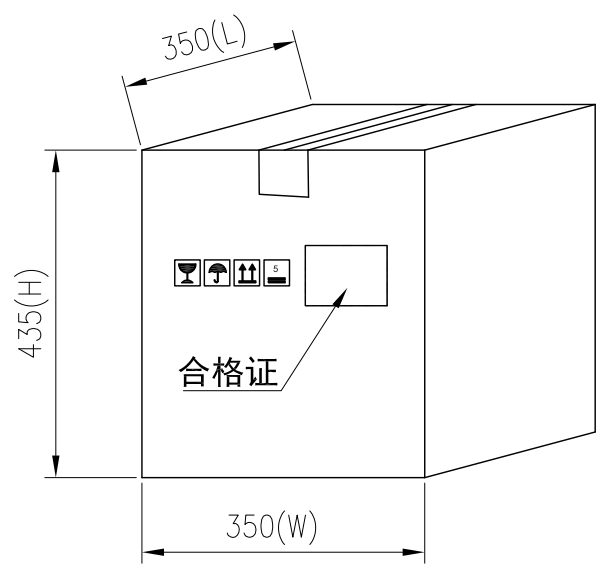
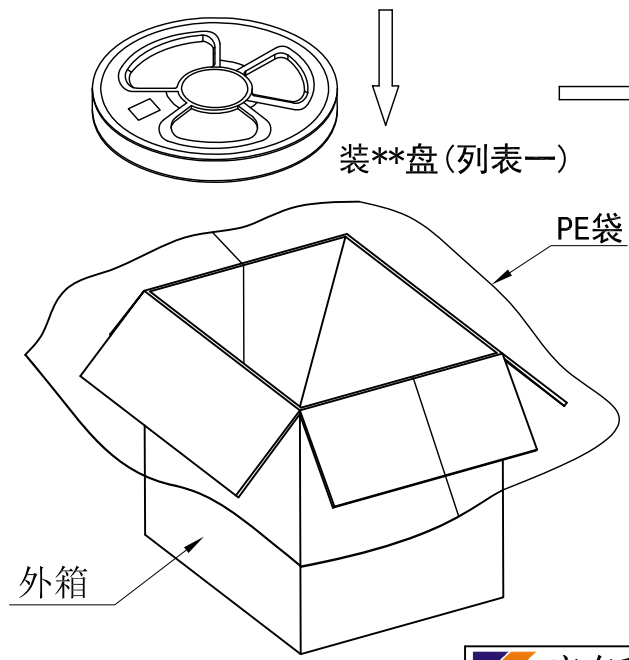
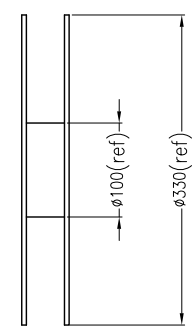
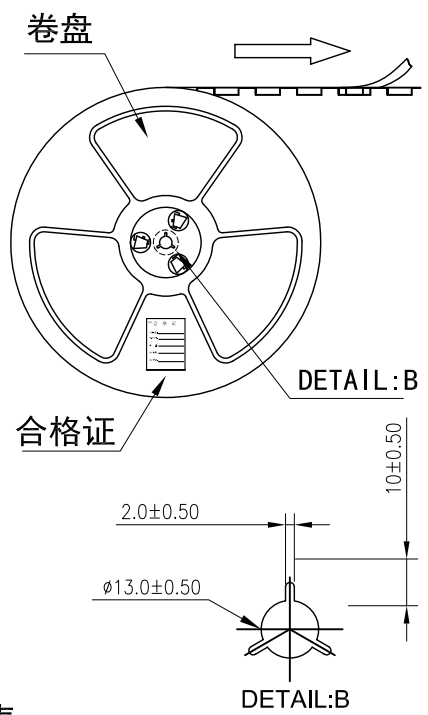

列表一

Circuits	DIM. D	DIM. E	Q'ty/Reel	Packing (Reel/Caton)
02~04PIN	7.5	16	1000PCS	20/Reel
05~10PIN	11.50	24	1000PCS	15/Reel
11~13PIN	14.20	32	1000PCS	11/Reel
14~15PIN	20.20	44	1000PCS	8/Reel

包装说明:
 1. 把成品包入卷盘中, 每盘装1000PCS, 卷盘上贴上合格证, 将装好产品的卷盘放进外箱中, 外箱内先套一个大PE袋, 外箱上贴贴上合格证。
 2. 所有材料有害物控制需符合RoHS标准。

广东科斯达电子科技有限公司 GUANG DONG KE SI DA ELECTRONIC TECHNOLOGY CO., LTD.		TITLE:	
X.± 0.5	X.±*	USE: CUSTOMER	PART NO.: A1505AWR 卷装
.X± 0.3	.X±*	APPD: 邵敬和	DWG NO.: GCBZ-0786
.XX±0.25	.XX±*	CHKD: 田峰	SCALE: 1 : 1
--	--	DR: 蒋建银	SHEET: 1 / 1
UNITS: mm			

REV	ECN No.	DESCRIPTION	DESIGN	DATE
A		Release	蒋建银	2017.10.22

产品引出方向

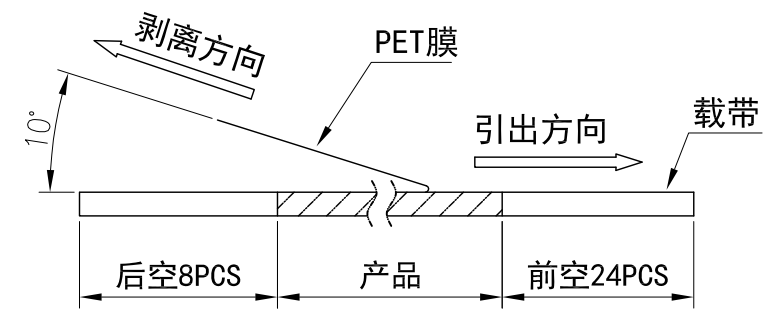
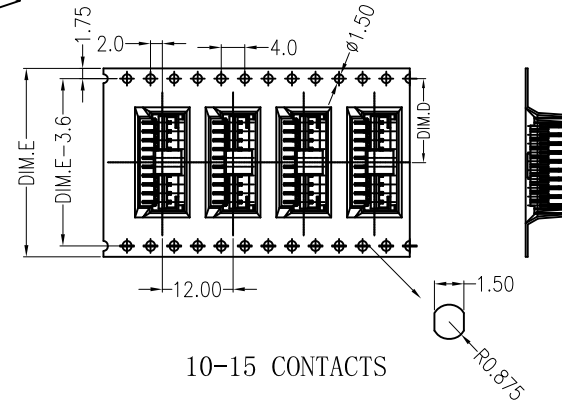
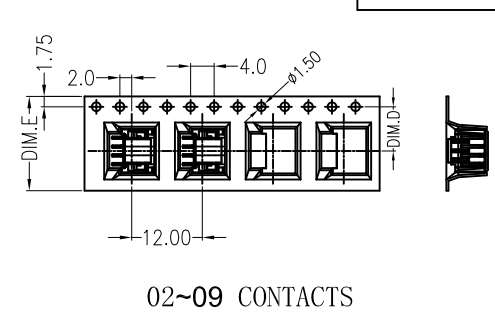

(PET膜剥离示意图)

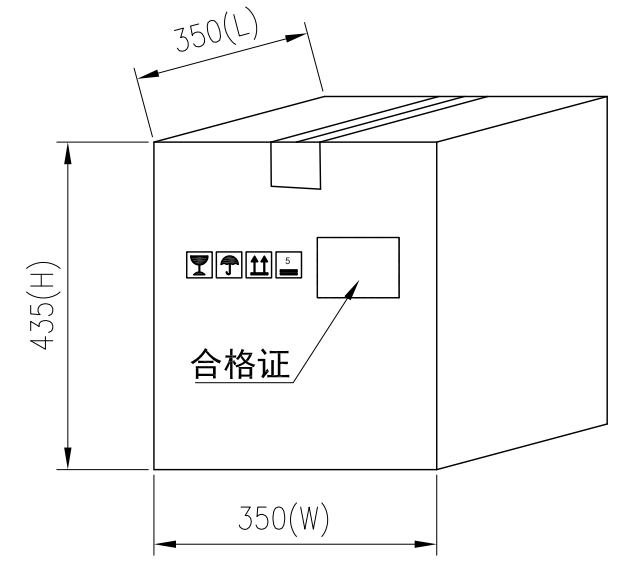
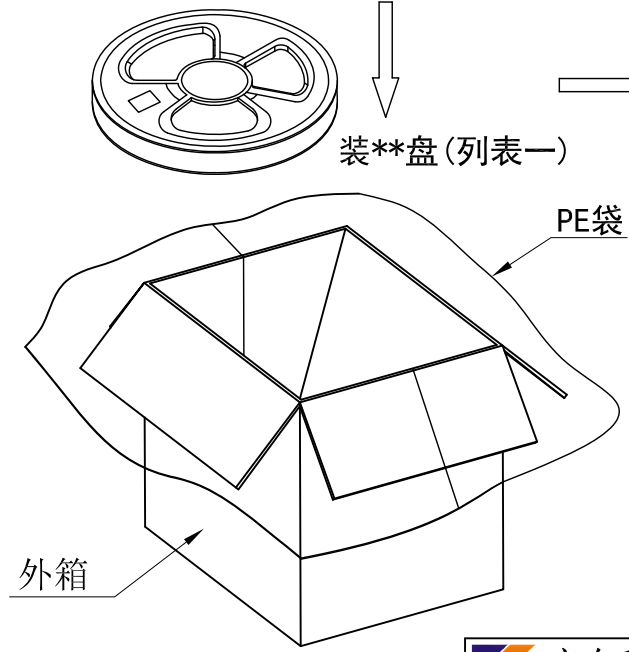
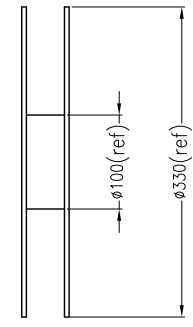
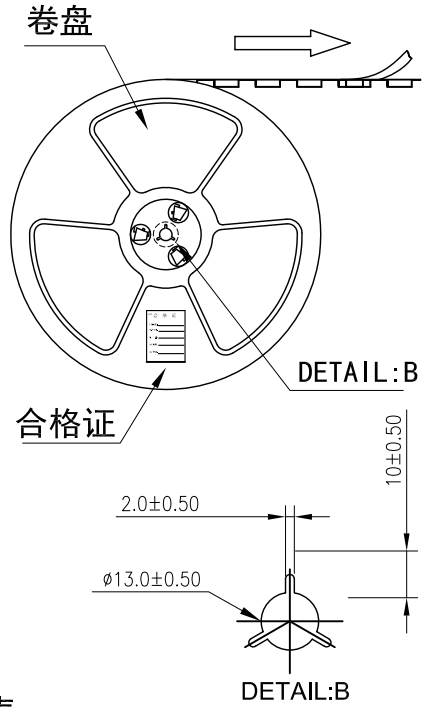

列表一

Circuits	DIM. D	DIM. E	Q'ty/Reel	Packing (Reel/Caton)
02~04PIN	7.5	16	800PCS	20/Reel
05~09PIN	11.50	24	800PCS	15/Reel
10~13PIN	14.20	32	800PCS	11/Reel
14~16PIN	20.20	44	800PCS	8/Reel

包装说明:
 1. 把成品包入卷盘中, 每盘装800PCS, 卷盘上贴上合格证, 将装好产品的卷盘放进外箱中, 外箱内先套一个大PE袋, 外箱上贴贴上合格证。
 2. 所有材料有害物控制需符合RoHS标准。

广东科斯达电子科技有限公司 GUANG DONG KE SI DA ELECTRONIC TECHNOLOGY CO., LTD.		TITLE:	
X.± 0.5	X.±*	USE: CUSTOMER	PART NO.: A1505AWW 卷装
.X± 0.3	.X±*	APPD: 刘振岭	DWG NO.: GCBZ-0787
.XX±0.25	.XX±*	CHKD: 王亮	SCALE: 1 : 1
--	--	DR: 蒋建银	SHEET: 1 / 1
UNITS: mm			

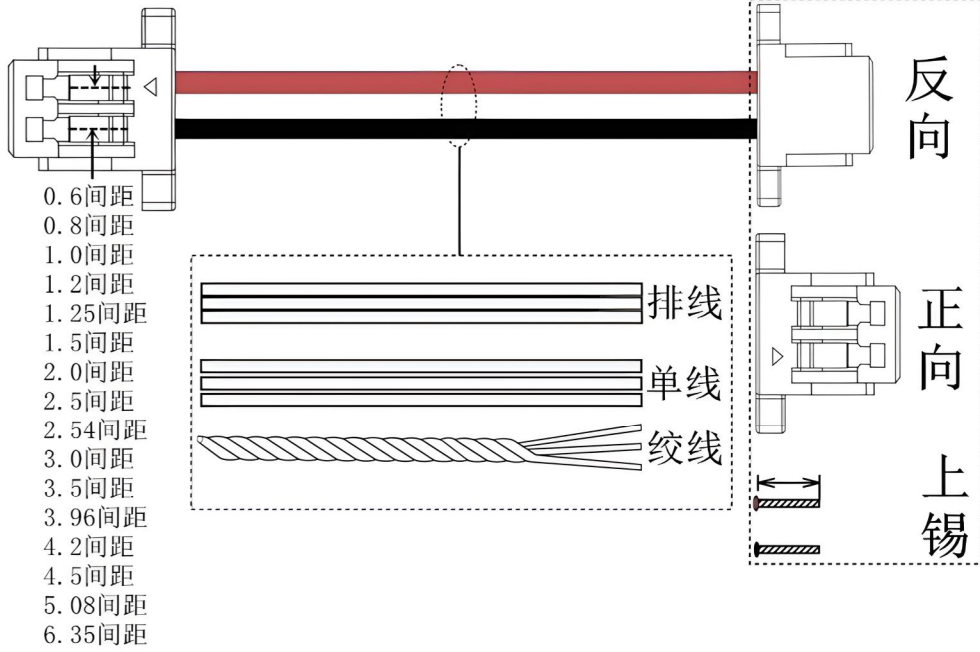

可定制·线色选择

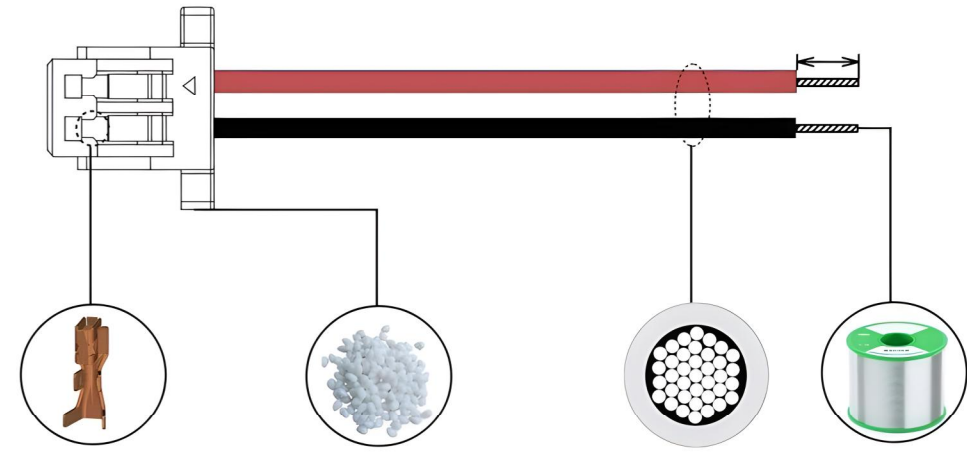

- 黄铜 磷铜
- 先镀 后镀
- PT-PBT 94V-0
- 660-PA66 94V-0
- PGN0-P-640PG3G-NC (15%GF)
- $\times 0.1\text{mm}$ 环保无铅锡线
- $\times 0.12\text{mm}$
- $\times 0.16\text{mm}$

广东科斯达电子科技有限公司 GUANG DONG KE SI DA ELECTRONIC TECHNOLOGY CO., LTD.			TITLE: NH-T 端子 -	
X.±0.1	X.±1'	USE: MANUFACTURE	PART NO.:	
.X±0.05	.X±0.5'		DWG NO.:	
.XX±0.01	.XX±0.1'	APPD: 刘振岭	SCALE	
.XXX±0.005	.XXX±0.05'	CHKD: 王亮	1 : 1	SHEET
		UNITS: mm	DR: 蒋建银	1 / 1

电子线尺寸规格表

PVC绝缘电子线

型号	线规	铜丝材质	外皮材质	额定温度	额定电压
UL1007	30-16AWG	镀锡铜	PVC	80°C	300V
UL1015	26-10AWG	镀锡铜	PVC	105°C	600V
UL1061	32-14AWG	镀锡铜	PVC	80°C	300V
UL1571	32-14AWG	镀锡铜	PVC	80°C	30V
UL1672	26-12AWG	镀锡铜	PVC	105°C	300V
UL1617	24-10AWG	镀锡铜	PVC	105°C	600V
UL1569	30-10AWG	镀锡铜	PVC	105°C	300V
H05V-K VDE认证线	0.2-2.5MM ²	裸铜镀锡铜	PVC	70°C	300V/500V
RV线	0.2-6.0MM ²	裸铜	PVC	70°C	300V/500V
BV线	0.5-2.5MM ²	裸铜	PVC	70°C	450V/750V
BVV线	0.75-16MM ²	裸铜	PVC	70°C	450V/750V
BVR线	0.5-16MM ²	裸铜	PVC	70°C	450V/750V

XL-PE绝缘无卤线

型号	线规	铜丝材质	外皮材质	额定温度	额定电压
UL1430	30-16AWG	镀锡铜	XL-PVC	105°C	300V
UL10368	30-10AWG	镀锡铜	XL-PE	105°C	300V
UL3266	32-8AWG	镀锡铜	XL-PE	105°C	300V
UL3302	32-16AWG	镀锡铜	XL-PE	105°C	30V
UL3385	30-10AWG	镀锡铜	XL-PE	105°C	300V
UL3396	30-14AWG	镀锡铜	XL-PE	105°C	300V

PFA/FEP绝缘铁氟龙线

型号	线规	铜丝材质	外皮材质	额定温度	额定电压
UL1322	30-14AWG	镀锡铜	FEP	200°C	300V
UL1322双层绝缘线	28-10AWG	镀锡铜	FEP	200°C	300V
UL10064	32-10AWG	镀锡铜	FEP	105°C	30V
UL10362	30-06AWG	镀锡铜	PFA	250°C	600V
VDE铁氟龙线	0.25-1.5MM ²	镀锡铜	FEP	180°C	300V

硅橡胶绝缘高温线

型号	线规	铜丝材质	外皮材质	额定温度	额定电压
UL3239硅橡胶线	30-16AWG	镀锡铜	硅橡胶	200°C	3KV/6KV/10KV
UL3239双层绝缘线	24-18AWG	镀锡铜	硅橡胶	200°C	3KV6KV/10KV
UL3122编织线	24-16AWG	镀锡铜	硅橡胶	200°C	300V
UL3135硅橡胶线	32-10AWG	镀锡铜	硅橡胶	200°C	600V
UL3132硅橡胶线	30-24AWG	镀锡铜	硅橡胶	150°C	300V
CCC编织硅橡胶线	0.5-6.0MM ²	镀锡铜	硅橡胶	200°C	300V
平方硅橡胶线	0.2-2.5MM ²	镀锡铜	硅橡胶		
H05S-K VDE平方硅橡胶线	0.5-2.5MM ²	镀锡铜	硅橡胶	180°C	300V/500V

排线2-20P

型号	线规	铜丝材质	外皮材质	额定温度	额定电压
UL2468排线	30-16AWG	镀锡铜	PVC	80°C	300V
UL20080排线	28-24AWG	镀锡铜	PVC	80°C	30V
软白排线	2.0/2.54间距7*0.11	镀锡铜	PVC		
2651灰排线	2.0/2.54间距	镀锡铜	PVC	105°C	300V
2651红边灰排/灰排	间距1.0/1.27	镀锡铜	PVC	105°C	300V
透明排线	2-12P/7*0.14	镀锡铜	PVC		
彩色排线	30-18AWG	镀锡铜	PVC	80/105°C	

排线2-20P

型号	线规	铜丝材质	外皮材质	额定温度	额定电压
UL2468排线	30-16AWG	镀锡铜	PVC	80°C	300V
UL20080排线	28-24AWG	镀锡铜	PVC	80°C	30V
软白排线	2.0/2.54间距7*0.11	镀锡铜	PVC		
2651灰排线	2.0/2.54间距	镀锡铜	PVC	105°C	300V
2651红边灰排/灰排	间距1.0/1.27	镀锡铜	PVC	105°C	300V
透明排线	2-12P/7*0.14	镀锡铜	PVC		
彩色排线	30-18AWG	镀锡铜	PVC	80/105°C	

电子线颜色选型定制



 广东科斯达电子科技有限公司 GUANG DONG KE SI DA ELECTRONIC TECHNOLOGY CO., LTD.			TITLE: NH-T 端子	
X.±0.1	X.±1'	USE: MANUFACTURE	PART NO.:	
.X±0.05	.X±0.5'		A1003T 端子	
.XX±0.01	.XX±0.1'	APPD: 刘振岭	DWG NO.:	
.XXX±0.005	.XXX±0.05'	CHKD: 王亮	SCALE	
 UNITS: mm		DR: 蒋建银	1 : 1	SHEET 1 / 1