

FULL C. C. W POSITION

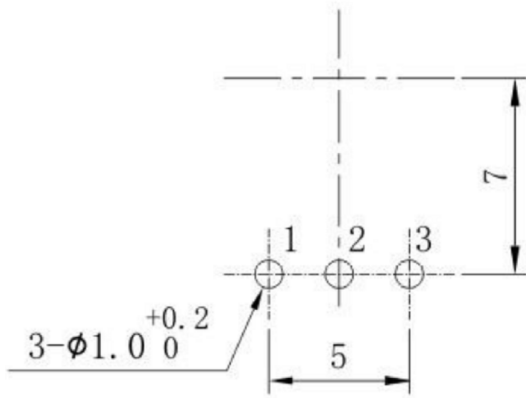

P. C. B MOUNTING HOLE DETAIL

KSD RV093 SERIES ROTARY POTENTIOMETERS
SWITCH CONNECTOR RV093 旋转电位器

Electrical characteristics 电气特性

Total Resistance Range 总阻值	1K _s TR _s 1M _Ω
Resistance Tolerance 总阻值容许公差	±20%
Resistance Taper 阻值线性	A, B, C, taper.
Power Rating 负载功率	B taper : 0.05W ; Other taper : 0.03W
Max. operating Voltage 最大工作电压	50V AC / 20V DC
Slide Noise 杂讯	Less than 100mV
Residual Resistance Value 残留阻值	Less than 20 $Ω$
Dielectric Voltage 耐电压	For 1 minute or more AC 250V
Insulation resistance 绝缘阻抗	More than 100M $Ω$ at DC 250V

Mechanical characteristics 机械特性

Total Rotational Angle 旋转角度	280°±10°
Rotational Torque 旋转力矩	10gf.cm~100 gf.cm
Stop Strength 止挡强度	2kgf.cm
Push & Pull Strength 推拉强度	2kgf

Environmental characteristics

Rotational Life 旋转寿命	10,000 cycles
----------------------	---------------

RV093 轴心规格

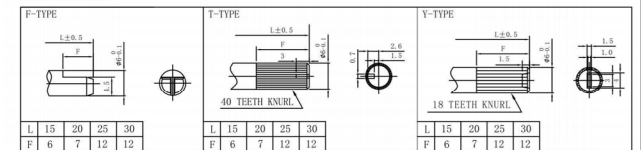

广东科斯达电子科技有限公司
KSDKG Guang dong Keside Electronic Technology Co., Ltd.

TOLERANCE UNLESS OTHERWISE STATED :
Up to 5 ±0.2
Above 5 ~ 15 ±0.3
Above 15 ~ 30 ±0.4
Above 30 ~ 50 ±0.5
Angle ±0.3°

3RD. ANGEL'S



UNITS MM

DRAWN BY: Jack Lu
CHECKED BY: Jacky Chen
APPROVED BY: Tony Kao
DATE: 07/23/13
DATE: 07/23/13
DATE: 07/23/13

MAT'L	TITLE	ROTARY POTENTIOMETER
FINISH	MODLE	旋转电位器系列
SCALE 1 : 1	DWG NO.	KSD-RV-0938N
SHEET NO. 1 of 1	PART NO.	
		SIZE A4
		VER R2

2	公差及料號更新	Jack	072313
1	圖面更新	Frank Wu	021012
ITEM NO.	DESCRIPTION	DRAWN	DATE