

DIMENSIONS

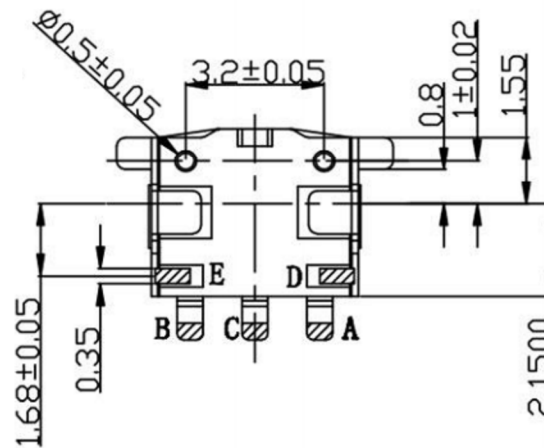

360°
Rotation

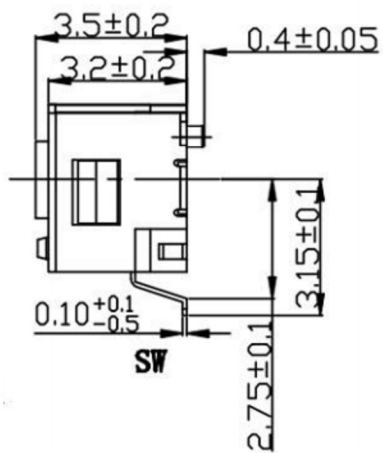
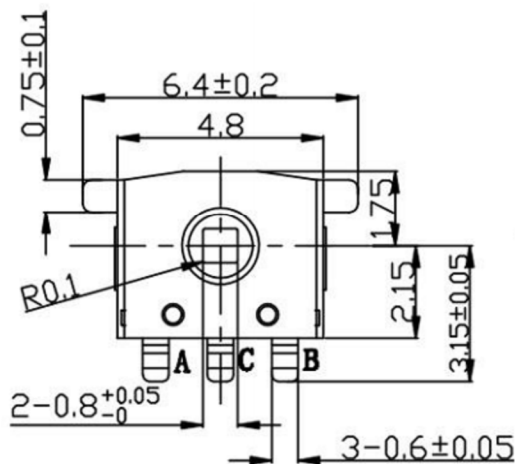
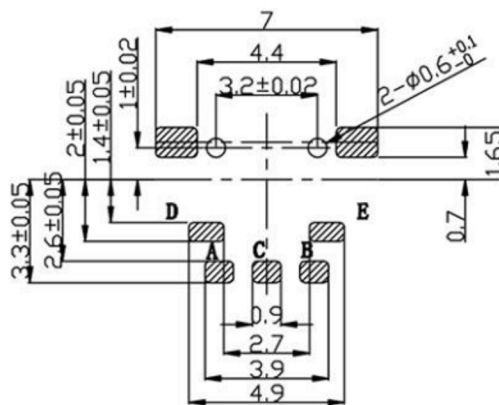
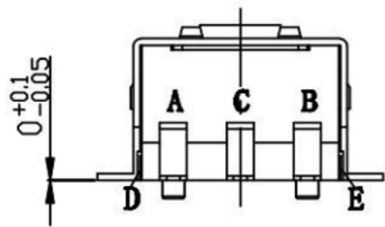
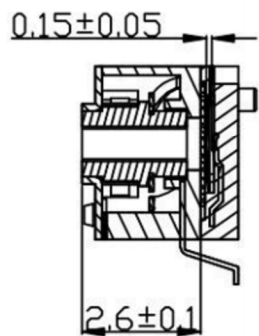

D — E
PUSH ON SW

CIRCUIT DIAGRAM

EC 编码器

| Electrical characteristics 电气特性 | |
|---------------------------------|------------------------------|
| Rating Power 额定功率 | DC5V 10mA |
| Fluttering 颤荡 | T1,T3≤5ms |
| Sliding Noise(Bounce)滑动杂音 | T2≤2ms |
| Dielectric Voltage 耐电压 | For 1 minute or more AC 300V |
| Insulation resistance 绝缘阻抗 | More than 10MQ at DC 250V |
| Phase Difference 相位差 | ΔT=0.15T±0.1T |

Mechanical characteristics 机械特性

| | |
|-----------------------------|--------------------------|
| Total Rotational Angle 旋转角度 | 360° |
| Rotational Torque 旋转力矩 | 10gf.cm~100 gf.cm |
| Number of click 段位数量 | 12 Detents(Angle:30°±3°) |

Environmental characteristics

| | |
|----------------------|---------------|
| Rotational Life 旋转寿命 | 30,000 cycles |
|----------------------|---------------|

P.C.BOARD MOUNTING HOLE DIMENSIONS

广东科斯达电子科技有限公司
KSDKG Guang dong Keside Electronic Technology Co., Ltd.

TOLERANCE UNLESS OTHERWISE STATED:
Up to 5 ±0.2
Above 5 ~ 15 ±0.3
Above 15 ~ 30 ±0.4
Above 30 ~ 50 ±0.5
Angle ±0.3°

3RD.
ANGEL'S



UNITS MM

DRAWN BY: Jack Lu 07/23/13
CHECKED BY: Jacky Chen 07/23/13
APPROVED BY: Tony Kao 07/23/13

| MAT'L | TITLE | SIZE |
|------------------|----------|------|
| FINISH | MODLE | A4 |
| SCALE 1 : 1 | DWG NO. | VER |
| SHEET NO. 1 of 1 | PART NO. | R2 |

| ITEM NO. | DESCRIPTION | DRAWN | DATE |
|----------|-------------|----------|--------|
| 2 | 公差及料號更新 | Jack | 072313 |
| 1 | 圖面更新 | Frank Wu | 021012 |