

SW2 电路图  
CIRCUIT DIAGRAM

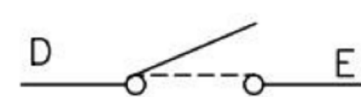

SW1 回路图  
SWITCH CIRCUIT

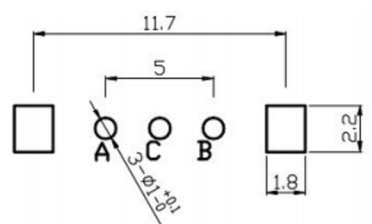

P. C. B MOUNTING HOLE DETAIL

F-TYPE	Y-TYPE																				
<table border="1"> <tr><td>L</td><td>15</td><td>17.5</td><td>20</td><td>25</td></tr> <tr><td>F</td><td>7</td><td>9.5</td><td>12</td><td>12</td></tr> </table>	L	15	17.5	20	25	F	7	9.5	12	12	<table border="1"> <tr><td>L</td><td>15</td><td>17.5</td><td>20</td><td>25</td></tr> <tr><td>F</td><td>7</td><td>9.5</td><td>12</td><td>12</td></tr> </table>	L	15	17.5	20	25	F	7	9.5	12	12
L	15	17.5	20	25																	
F	7	9.5	12	12																	
L	15	17.5	20	25																	
F	7	9.5	12	12																	
<table border="1"> <tr><td>W</td><td>5</td><td>7</td></tr> </table>	W	5	7	<table border="1"> <tr><td>W</td><td>5</td><td>7</td></tr> </table>	W	5	7														
W	5	7																			
W	5	7																			

Electrical characteristics 电气特性

Rating Power 额定功率	DC5V 10mA
Contact Resistance 接触阻抗	Less than 1Ω
Dielectric Voltage 耐电压	For 1 minute or more AC 300V
Insulation Resistance 绝缘阻抗	More than 100MΩ at DC 250V

Mechanical characteristics 机械特性

Total Rotational Angle 旋转角度	90°±10°
Rotational Torque 旋转力矩	30gf.cm~300 gf.cm
Shaft Push & Pull Strength 轴推拉力强度	8kgf.cm
Travel of switch 开关移动量	0.5±0.3 mm
Operating force of switch 开关动作力	500±200gf

Environmental characteristics

Rotational Life 旋转寿命	30,000 cycles
Switch Life 开关寿命	20,000 cycles

**广东科斯达电子科技有限公司**  
KSDKG Guang dong Keside Electronic Technology Co., Ltd.

TOLERANCE UNLESS OTHERWISE STATED:  
 Up to 5 ±0.2  
 Above 5 ~ 15 ±0.3  
 Above 15 ~ 30 ±0.4  
 Above 30 ~ 50 ±0.5  
 Angle ±0.3°

3RD. ANGEL'S



UNITS MM

DRAWN BY: Jack Lu	DATE: 07/23/13	MAT'L	TITLE: KSD-RS ROTARY SWITCH
CHECKED BY: Jacky Chen	DATE: 07/23/13	FINISH	MODLE: KSD-RS旋转开关系列
APPROVED BY: Tony Kao	DATE: 07/23/13	SCALE: 1 : 1	DWG NO.: KSD-RS1107
		SHEET NO.: 1 of 1	PART NO.

ITEM NO.	DESCRIPTION	DRAWN	DATE
2	公差及料號更新	Jack	072313
1	圖面更新	Frank Wu	021012

SIZE A4  
VER R2