

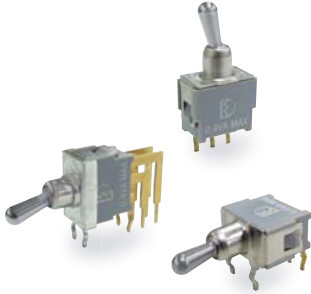

# KSD

SWITCH CONNECTOR



## SPECIFICATIONS

**CONTACT RATING:** Max. 0.4 VA max. @ 48 VAC or DC

**MECHANICAL LIFE:** minimum 40,000 operations.

**CONTACT RESISTANCE:** 50 mΩ max.

**INSULATION RESISTANCE:** 1,000 MΩ min./500VDC

**DIELECTRIC STRENGTH:** 500 Vrms min.@sea level.(initial value)

**OPERATING TEMPERATURE:** -20°C to 85°C.

**INGRESS PROTECTION:** IP67(In house test)

## MATERIALS

**ACTUATOR:** Brass with chrome plated, internal o-ring sealed.

**BUSHING & HOUSING:** SPCC

**CASE:** Glass filled nylon 6/6, flame retardant, heat stabilized (UL94v-0)

**SWITCH SUPPORT:** Brass, tin plated.

**CONTACT:** Phosphor bronze gold plated over nickel barrier.

**TERMINALS:** Brass, gold plated.

**TERMINAL SEAL:** Epoxy

KSD-2TE  
Toggle Switches

## HOW TO ORDER

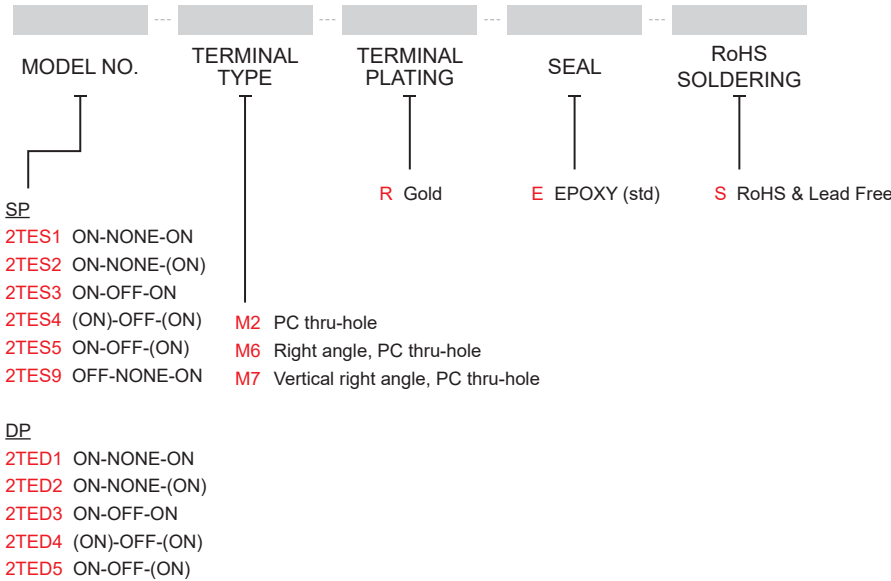

EXAMPLE: KSD-2TES1M2RES



KSD-2TE  
Toggle Switches

## ▼ SWITCH FUNCTION

NO. POLES	MODEL NO.	SWITCH FUNCTION			CONNECTED TERMINALS / SCHEMATIC		
		POS.1	POS.2	POS.3	POS.1	POS.2	POS.3
SP	2TES1	ON	NONE	ON		N/A	
	2TES2	ON	NONE	(ON)			
	2TES3	ON	OFF	ON			
	2TES4	(ON)	OFF	(ON)		OPEN	
	2TES5	ON	OFF	(ON)			
	2TES9*	OFF	NONE	ON	OPEN	N/A	2-1
DP	2TED1	ON	NONE	ON		N/A	
	2TED2	ON	NONE	(ON)			
	2TED3	ON	OFF	ON			
	2TED4	(ON)	OFF	(ON)		OPEN	
	2TED5	ON	OFF	(ON)			

( )=MOMENTARY

\* Omit terminal 3

## ▼ POLE OPTIONS

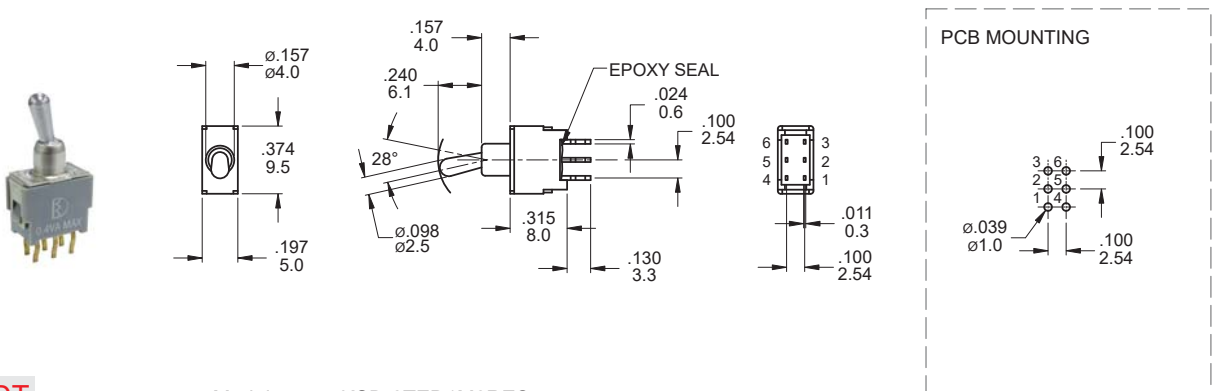
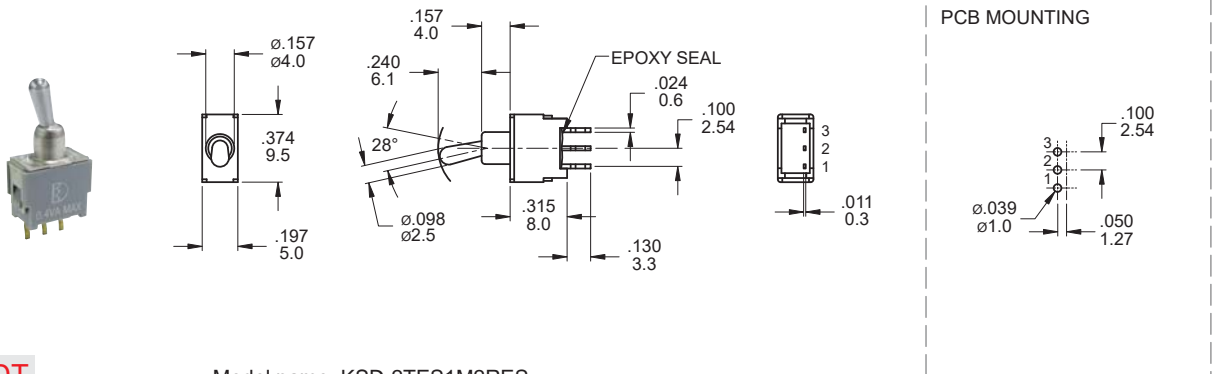



## ▼ TERMINAL OPTIONS

### M6

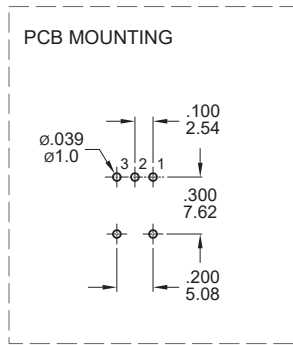
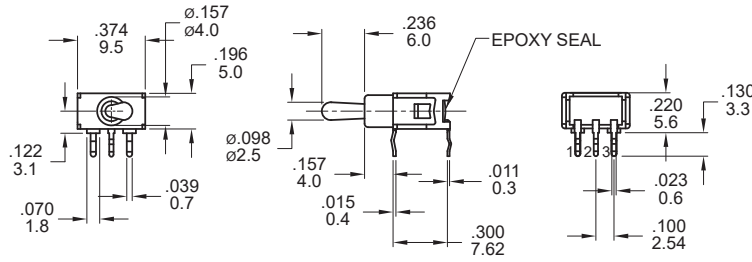

### SPDT

Model name. KSD-2TES1M6RES

### M6

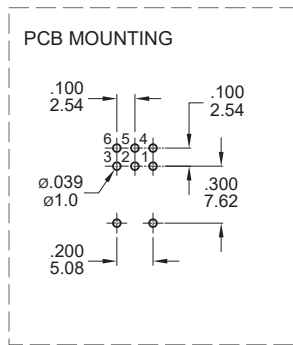
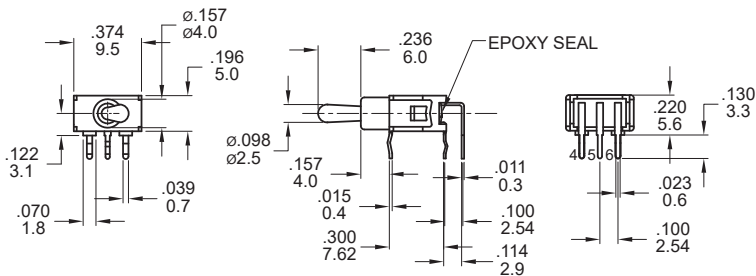

### DPDT

Model name. KSD-2TED1M6RES

### M7

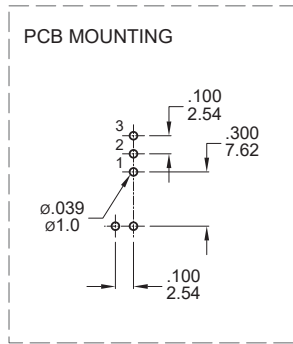
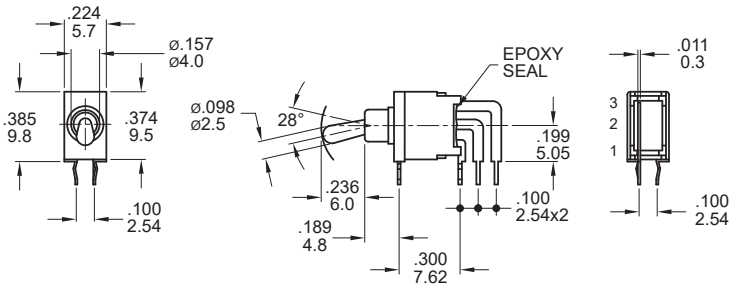

### SPDT

Model name. KSD-2TES1M7RES

### M7

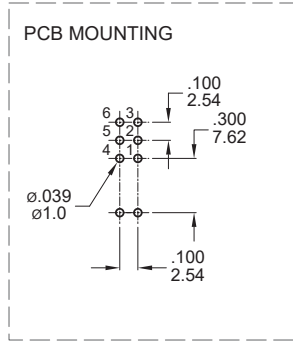
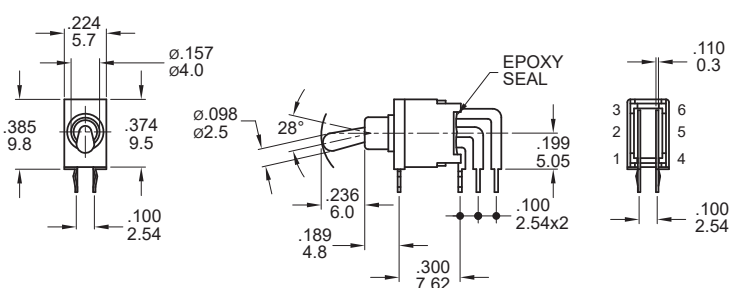

### DPDT

Model name. KSD-2TED1M7RES

## ▼ SOLDERING PROCESS

WAVE SOLDERING: Recommend soldering temperature: 260 ± 5°C

Duration of solder immersion: Max 5 sec. (PCB thickness is 1.6mm)