



KSD

SWITCH CONNECTOR



SPECIFICATIONS

CONTACT RATING: AC 125V 6A, AC 250V 3A ,DC 28V 3A

MECHANICAL LIFE: 100,000 make-and-break cycles
DC 10V & 0.1mA.

CONTACT RESISTANCE: 10 mΩ max.

INSULATION RESISTANCE: 500MΩ min/500VDC

DIELECTRIC STRENGTH: 1,000 Vrms min. @sea level. (initial value)

OPERATING TEMPERATURE: -40°C to 85°C.

MATERIALS

CASE: Diallyl phthalate (DAP) (UL94v-0).

ACTUATOR: Brass, chrome plated.

BUSHING: Brass, nickel plated.

HOUSING: Stainless Steel.

SWITCH SUPPORT: Brass, tin plated.

TERMINAL/CONTACT: Brass with silver or gold plated.

(See page 23)

HOW TO ORDER

MODEL NO.	ACTUATOR	BUSHING	TERMINAL TYPE	TERMINAL PLATING	SEAL	RoHS SOLDERING
<u>SP</u> 1FS1 ON-NONE-ON 1FS2 ON-NONE-(ON) 1FS3 ON-OFF-ON 1FS4 (ON)-OFF-(ON) 1FS5 ON-OFF-(ON)	T1 10.5 high T2 5.4 high T3 14.2 high T4 16.4 high T5 21.4 high T6 11.5 high T61 21.5 high T12 11.2 high *	B6 8.00 high Splash proof B9 7.48 high BA1 9.00 high *	M1 Solder Lug M2 PC thru-hole	Q Silver R Gold C Gold over silver	E EPOXY (std) N NO EPOXY	S RoHS & Lead Free
<u>DP</u> 1FD1 ON-NONE-ON 1FD2 ON-NONE-(ON) 1FD3 ON-OFF-ON 1FD4 (ON)-OFF-(ON) 1FD5 ON-OFF-(ON)						

* T12 actuator are only available with BA1 bushing

EXAMPLE: 1FS1T1B6M1QES



▼ SWITCH FUNCTION

NO. POLES	MODEL NO.	SWITCH FUNCTION			CONNECTED TERMINALS / SCHEMATIC		
		POS.1	POS.2	POS.3	POS.1	POS.2	POS.3
SP	1FS1	ON	NONE	ON		N/A	
	1FS2	ON	NONE	(ON)			
	1FS3	ON	OFF	ON			
	1FS4	(ON)	OFF	(ON)			
	1FS5	ON	OFF	(ON)			
DP	1FD1	ON	NONE	ON		N/A	
	1FD2	ON	NONE	(ON)			
	1FD3	ON	OFF	ON			
	1FD4	(ON)	OFF	(ON)			
	1FD5	ON	OFF	(ON)			

()=MOMENTARY

▼ ACTUATOR OPTIONS

T1 STD

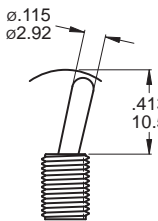

T2

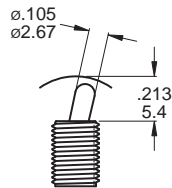

T3

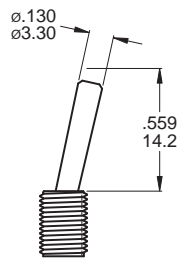

T4

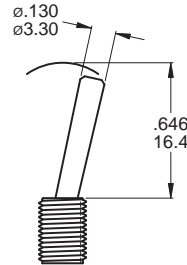

T5

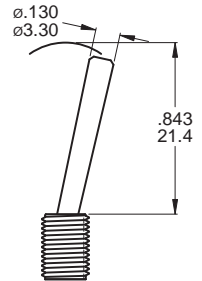

T6 * FLATTED WITH ANTIROTATION

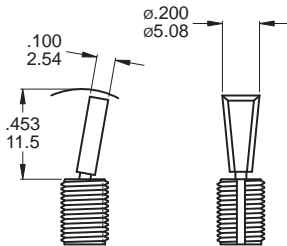

T61 *

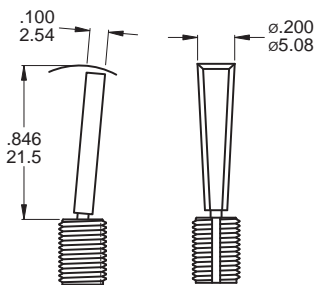

T12

T12 use with BA1 bushing only

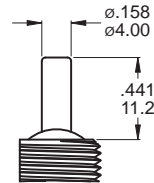

Note: The mechanical life of the T12 actuator is 200,000 cycles

* T6, T61 can only be use with B6 bushing.

▼ TERMINAL OPTIONS

M1 Solder lug

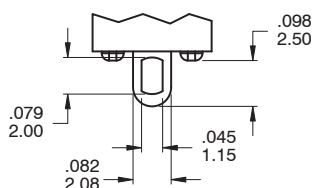

M2 PC Thru - hole

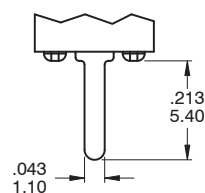

▼ BUSHING OPTIONS

B6 HIGH TORQUE

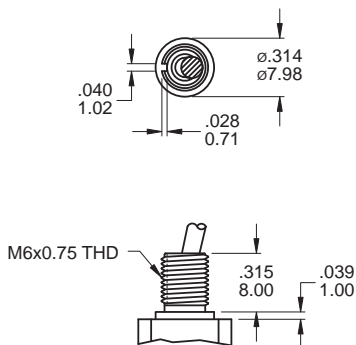

B9 SPLASH PROOF

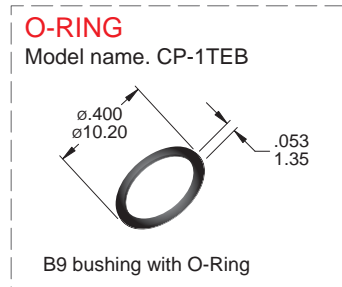
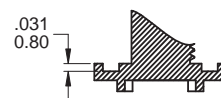
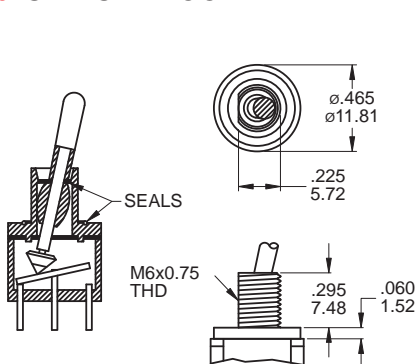

BA1 SPLASH PROOF

Only available for actuator T12.

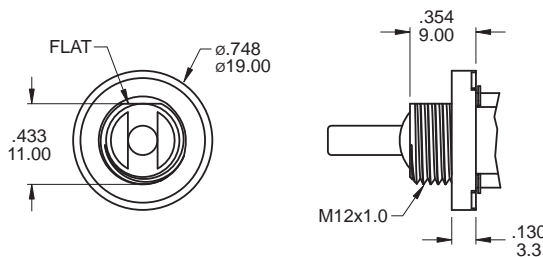

Note: BA1 Bear strength from top of actuator up to 10kg, aside up to 15kg

▼ POLE OPTIONS

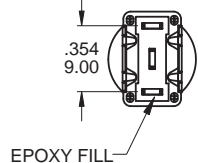
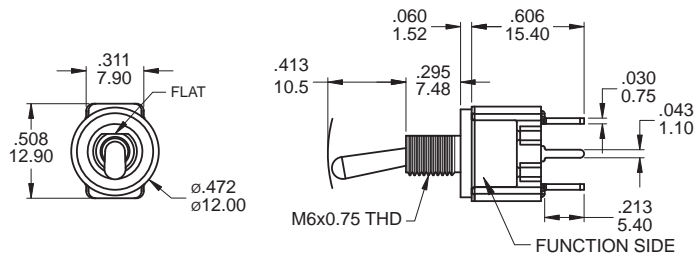

SPDT

Model name. KSD-1FS1T1B9M2RES

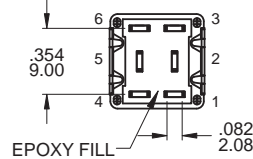
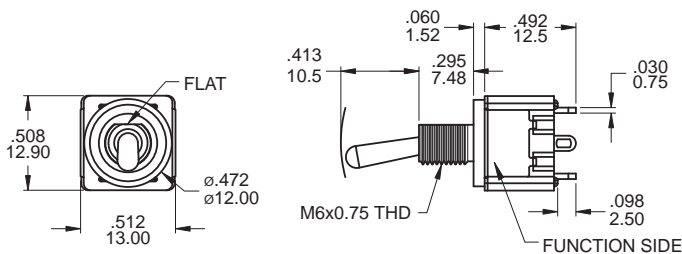

DPDT

Model name. KSD-1FD1T1B9M1QES



POLE OPTIONS

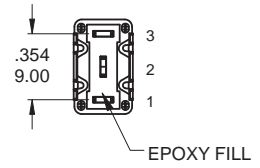
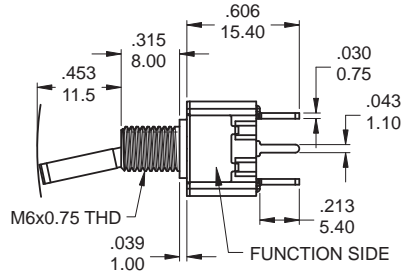
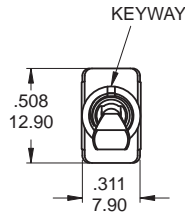

SPDT

Model name. KSD-1FS1T6B6M2QES

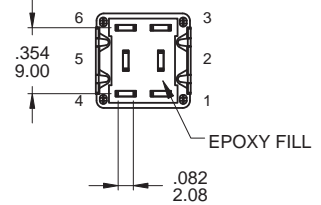
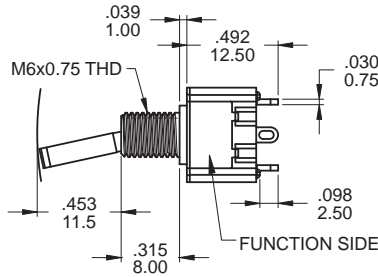
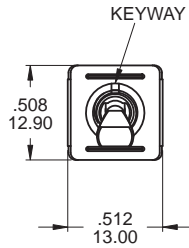

DPDT

Model name. KSD-1FD1T6B6M1QES

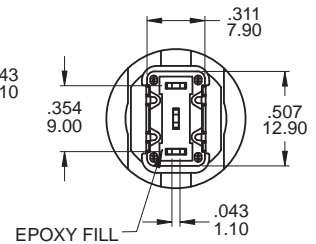
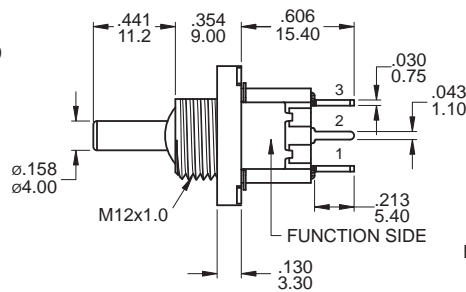
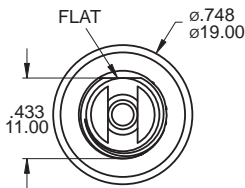

SPDT

Model name. KSD-1FS3T12BA1M2QES

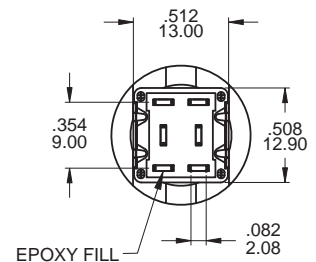
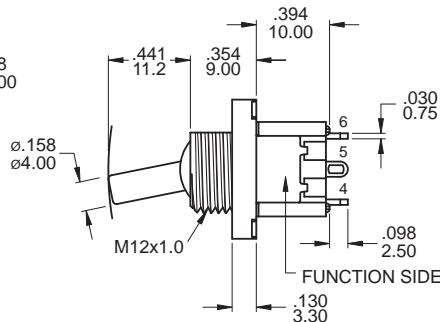
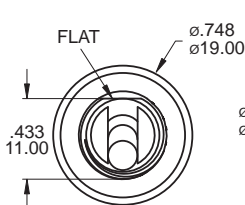

DPDT

Model name. KSD-1FD1T12BA1M1QES

▼ **HARDWARE**

EXAMPLE: -
Model name. 5 Standard hardware

* Standard for B6 bushing : 2 nut, 1 locking ring, 1 lockwasher
* For further information please consult sales representativity.

M6x0.75 NUT (Std.)
Model name. MNU-1M04

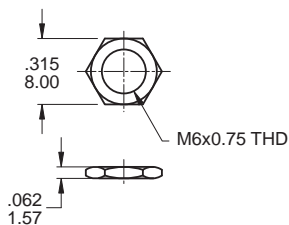

LOCKWASHER (Std.)
Model name. MNU-1M03

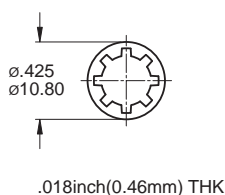

LOCKING RING (Std.)
Model name. MNU-1M05

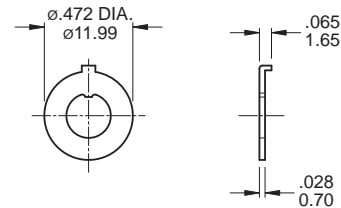

Available with bushing B6 only.

M12x1 NUT (Std.)
Model name. MNU-1M42

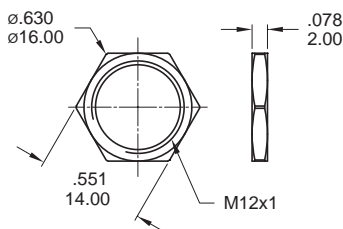

Available with bushing BA1 only.

LOCKWASHER (Std.)
Model name. MNU-1M09

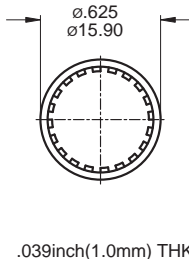

Available with bushing BA1 only.

O-RING (Std.)
Model name. FCP-1F04

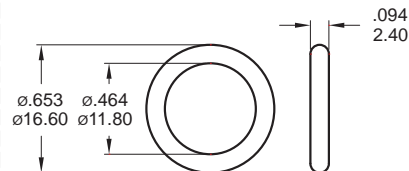

Available with bushing BA1 only.

▼ **CONTACT & TERMINAL PLATING OPTIONS**

	CONTACT PLATING	TERMINAL PLATING	RATINGS
Q	Silver	Silver	6 Amps with resistant load @ 125VAC
C	Gold over Silver	Gold over silver	3 Amps with resistant load @ 250VAC or 28VDC
R	Gold	Gold	0.4 Volt - Amps (VA) max. @ 20V max. (AC or DC)

▼ **SOLDERING PROCESS**

MANUAL SOLDERING: Use 30 watts soldering iron and controlled the temperature at 350°.

Duration of solder immersion: Max. 5 sec.

WAVE SOLDERING: Recommend soldering temperature: 260 ± 5°C

Duration of solder immersion: Max. 5 sec. (PCB thickness is 1.6mm)