



KSD

SWITCH CONNECTOR



SPECIFICATION:

MAX. CURRENT/VOLTAGE RATING WITH RESISTIVE LOAD:

400mA 32VAC-100mA 50VDC-125mA 125VAC

Metal bushing type: 500mA 48VAC - 200 mA 50VDC - 200mA 250VAC

INITIAL CONTACT RESISTANCE: 50mΩ max. (without wire leads)

INSULATION RESISTANCE: 1GΩ min.at 500VDC.

DIELECTRIC STRENGTH: 1,000 VAC rms.(initial value)

Metal bushing type: 1,500 VAC rms.(initial value)

ELECTRICAL LIFE AT FULL LOAD: 500,000 cycles.

OPERATING TEMPERATURE: -30°C to 85°C.

TOTAL TRAVEL: 1.5 mm(.059)

OPERATING FORCE: 2N-5N

CONTACT BOUNCE: 10 ms.

MECHANICAL LIFE: 1,000,000 cycles.

TORQUE: 0.5 Nm max.

Metal bushing type: 1.5 Nm max.

SOLDERING: 350°C max.for 5 seconds.

MATERIALS

CASE: Diallyl phthalate (DAP)(UL94v-0).

CAP: Polyamide 6/6.

BUSHING: Polyamide 6/6.

HOW TO ORDER

MODEL NO. BUSHING TERMINAL TYPE CONTACT PLATING SEAL RoHS SOLDERING CAP COLOR ADDITIONAL HARDWARE LED COLOR

SP
PAS6 OFF-(ON)
PAS7 ON-(OFF) *
* Not available with LED

M1 Solder Lug (std)
M4 PC thru-hole **
M3 8.20 Solder Lug **

E EPOXY (std)
S RoHS & Lead Free

5 Standard hardware

C Gold over silver

WIRE TYPE
B1 Round, snap-in
B2 Round threaded
B3 Round, snap-in
B6 Square threaded
L2 90mm wire leads 20 AWG
L3 100mm wire leads 20 AWG
D1 Molding, 500mm wire leads 20 AWG

Die-casting
D1 Square threaded
D2 Round threaded

Die-casting with plating

EXAMPLE:
PAS6□□M1CES□-5

Cap Color
A Chromium
C Stain-chromium
D Stain-nickel plating
D1 Square threaded
D2 Round threaded

Note: Die-casting with plating is only available for bushing D1 and D2.

Note: Our standard is with flat cap.
1.LED is only available with flat cap.
2.Bushing B6 and D1 is only available with flat cap.

CAP COLOR	ITEM NO.		
	Flat (std.)	Round	High
White	1	A1	G1
Black (Std)	2	A2	G2
Red (Std)	3	A3	G3
Orange	4	A4	G4
Yellow	5	A5	G5
Green	6	A6	G6
Blue	7	A7	G7

ITEM NO	COLOR
Single Color LED	
L1	White
L3	Red
L5	Yellow
L6	Green
L7	Blue
Dual Color LED	
L36	Red+Green
L37	Red+Blue

** Terminal M3 and M4 are only available with PAS6 without LED.
*** Except standard color, for other colors information please consult sales representativity.

EXAMPLE:
PAS6B2M1CES□-5 (STD)
Cap color
PAS6B2M1CES□-5□ (STD)
LED color
Flat cap color



▼ SWITCH FUNCTION

NO. POLES	MODEL NO.	SWITCH FUNCTION		CONNECTED TERMINALS		
		POS.1	POS.2	POS.1	POS.2	SCHEMATIC
SP	PAS6	OFF	(ON)	OPEN	1-3	
SP	PAS7	ON	(OFF)	1-3	OPEN	

()=MOMENTARY

▼ BUSHING OPTIONS

B1 Round, Snap-in

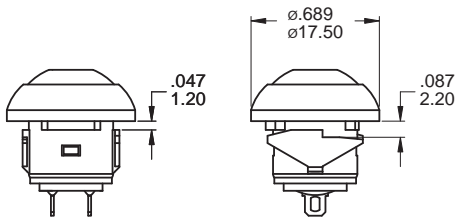

B2 Round threaded

D2 Round threaded, die-casting

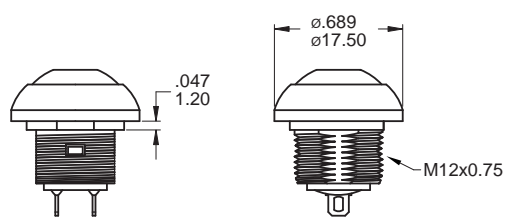

B3 Round, Snap-in

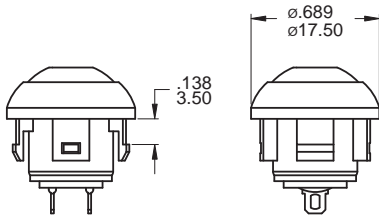

D1 Square threaded, die-casting

B6 Square threaded

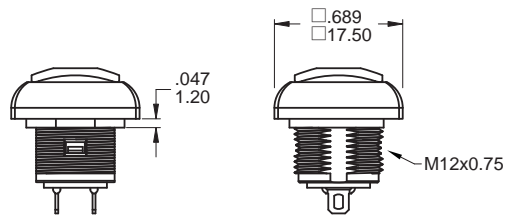

A Chromium

C Stain-chromium

D Stain-nickel

Note: Die-casting with plating is only available for bushing D1 and D2.



▼ TERMINAL OPTIONS

M1 Solder lug, STD

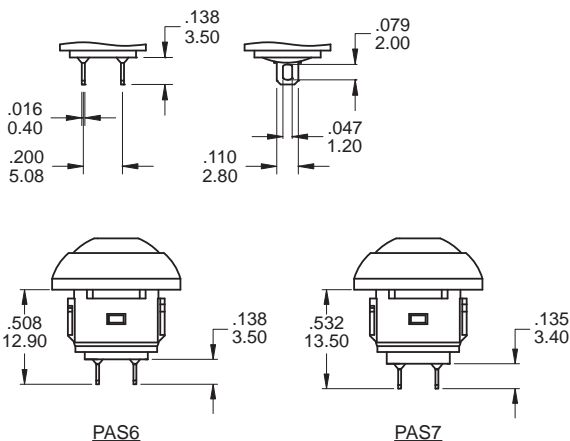

M3 Solder lug

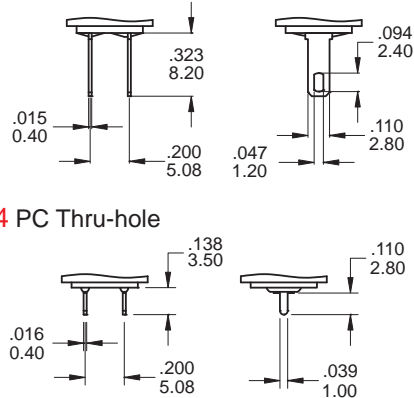

M4 PC Thru-hole

Note: Terminal M3 and M4 are only available with PAS6 without LED.

Note: Not available with LED



▼ CAP OPTIONS

FLAT STD

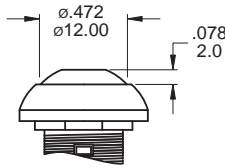

ROUND No LED *

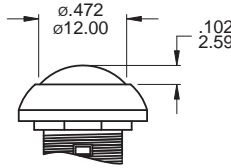

HIGH No LED *

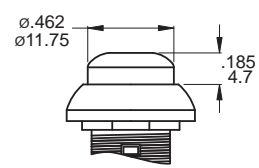

* Note: Round and high caps are not available for Square threaded bushing.

▼ PANEL MOUNTING

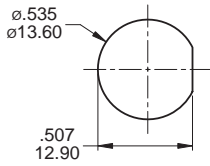

Panel thickness:
B1 bushing:
0.8 mm (.031inch) min. -1.8 mm (.071inch) max.
B2, B6, D1, D2 Bushing:
1.5 mm (.059inch) min. -4 mm (.157inch) max.

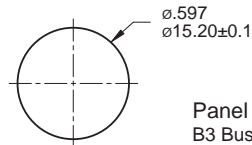

Panel thickness:
B3 Bushing:
2.85 +0.05/-0.10 mm (.112inch)

▼ DIMENSION

B1 Snap-in

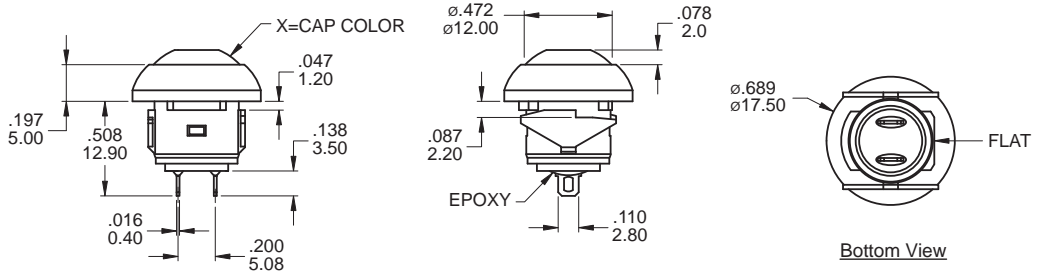

SPST

Model name. KSD-PAS6B1M1CESX-5

B2 Threaded

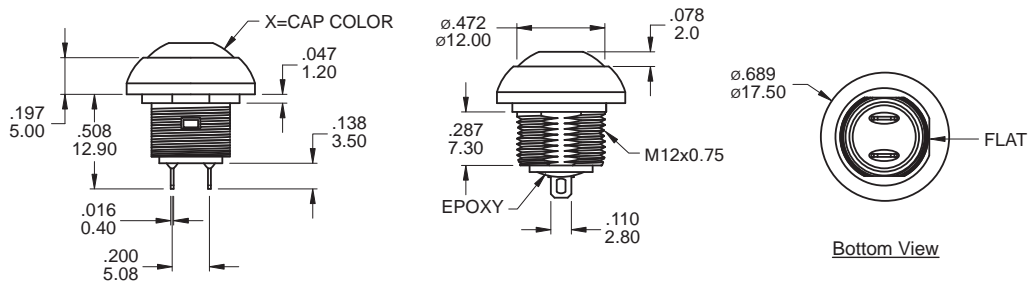

SPST

Model name. KSD-PAS6B2M1CESX-5

B3 Snap-in

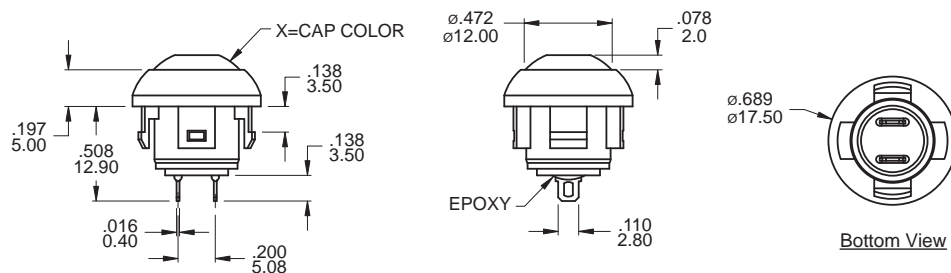

SPST

Model name. KSD-PAS6B3M1CESX-5



B6 Square threaded

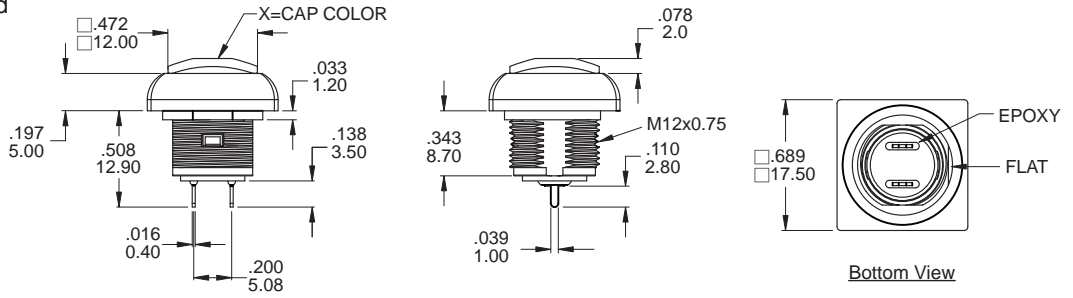

SPST

Model name. KSD-PAS6B6M1CESX-5

B2 Threaded

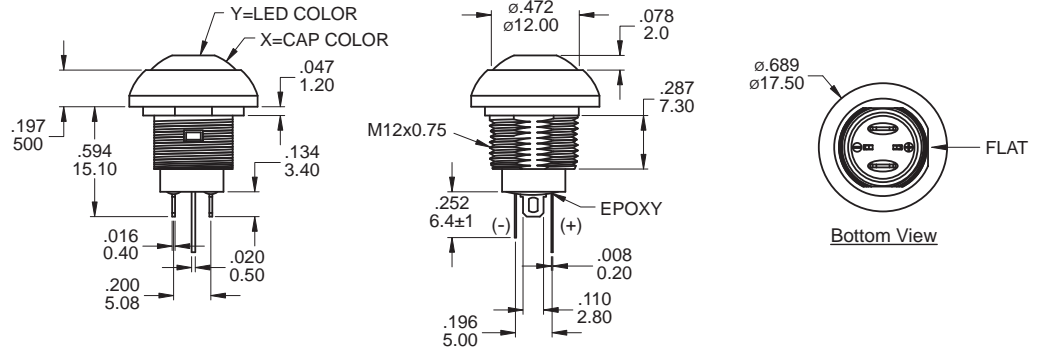

SPST

Model name. KSD-PAS6B2M1CESX-5LY

D1 Die-casting

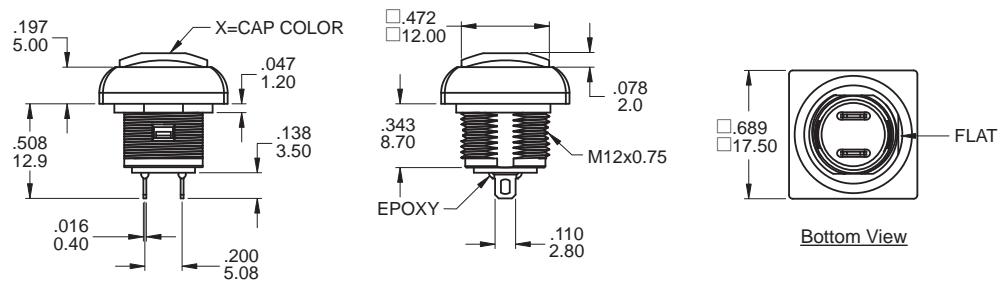

SPST

Model name. KSD-PAS6D1M1CESX-5

D2 Die-casting

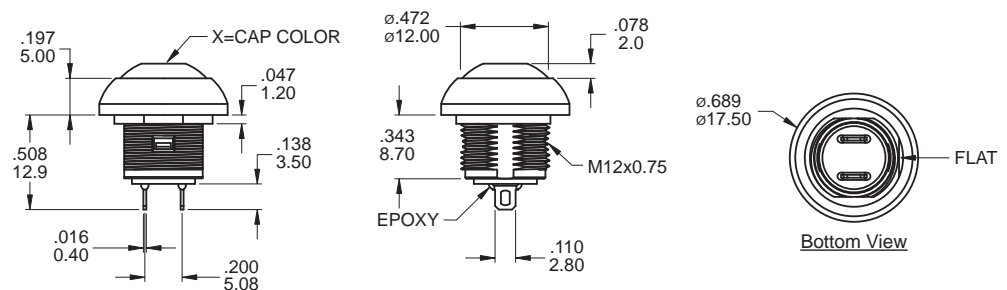

SPST

Model name. KSD-PAS6D2M1CESX-5



▼ WIRE OPTIONS

※ Please consult sales for additional wire options.

L2 90mm wire leads 20 AWG

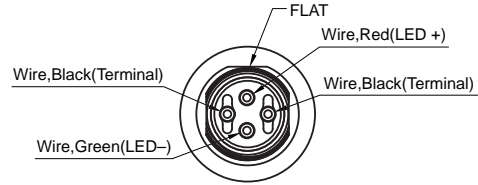
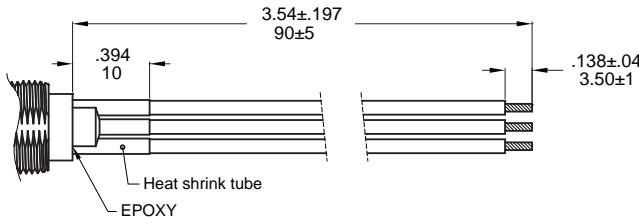

Note: No Illumination: Black Wire - Terminal

L3 100mm wire leads 20 AWG

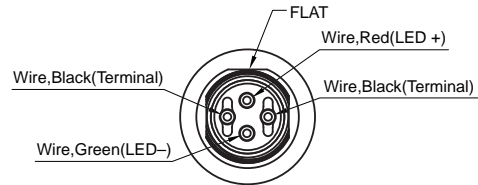
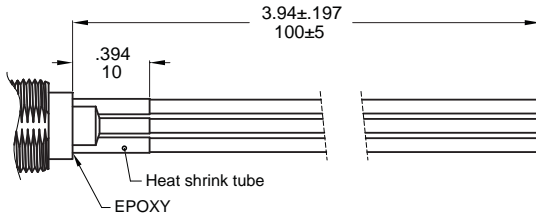

Note: No Illumination: Black Wire - Terminal

D1 Molding, 500mm wire leads 20 AWG

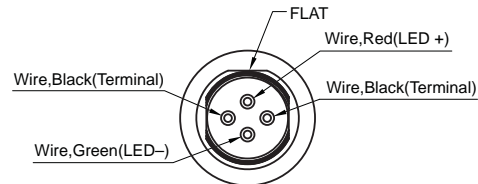
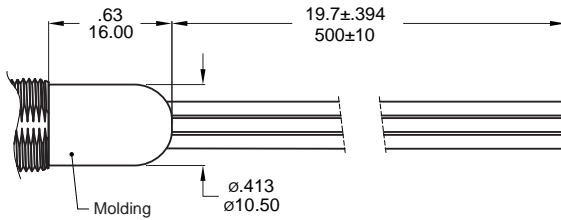

Note: No Illumination: Black Wire - Terminal

▼ HARDWARE

EXAMPLE: - Model name. 5 Standard Hardware

* Standard for threaded bushing : 1 nut, 1 EVA washer or o-ring, 1 lockwasher
* For further information please consult sales representativity.

NUT (Std.)

Model name. MNU-PA03

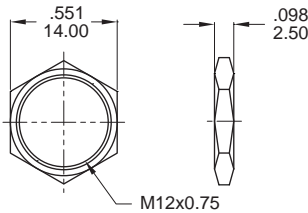

LOCK WASHER (Std.)

Model name. MNU-1M09

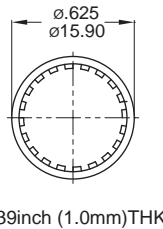

For Threaded bushing

EVA WASHER (Std.)

Model name. FSU-PA01

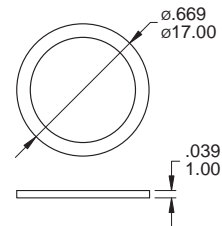

Available with bushing B1 and B2 only

O-RING (Std.)

Model name. FCP-A253

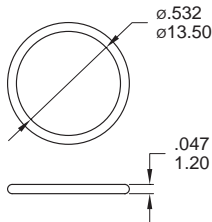

Available with bushing D1, D2 and B6 only

O-RING (Std.)

Model name. FCP-P004

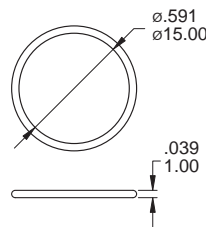

Available with bushing B3 only

NUT

Model name. MNU-PA04

MOQ: 10K

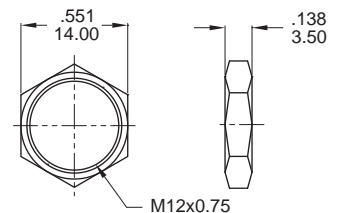



KSD

SWITCH CONNECTOR



SPECIFICATION:

MAX. CURRENT/VOLTAGE RATING WITH RESISTIVE LOAD:

100mA 24VDC-life expectancy 200,000 cycles

2A 125VAC-life expectancy 10,000 cycles

INITIAL CONTACT RESISTANCE: 50mΩ max. (without wire leads)

INSULATION RESISTANCE: 1GΩ min.at 500VDC.

DIELECTRIC STRENGTH: 1,000 VAC rms.(initial value)

ELECTRICAL LIFE AT FULL LOAD: 200,000 cycles.

OPERATING TEMPERATURE: -30°C to 85°C.

TOTAL TRAVEL: 2.5 mm(.098)

OPERATING FORCE: 2N~5N

CONTACT BOUNCE: 10 ms.

MECHANICAL LIFE: 1,000,000 cycles.

TORQUE: 0.5 Nm max.

SOLDERING: 350°C max.for 5 seconds.

MATERIALS

CASE: Polyamide 6/6.

CAP: Polyamide 6/6.

BUSHING: Polyamide 6/6.

HOW TO ORDER

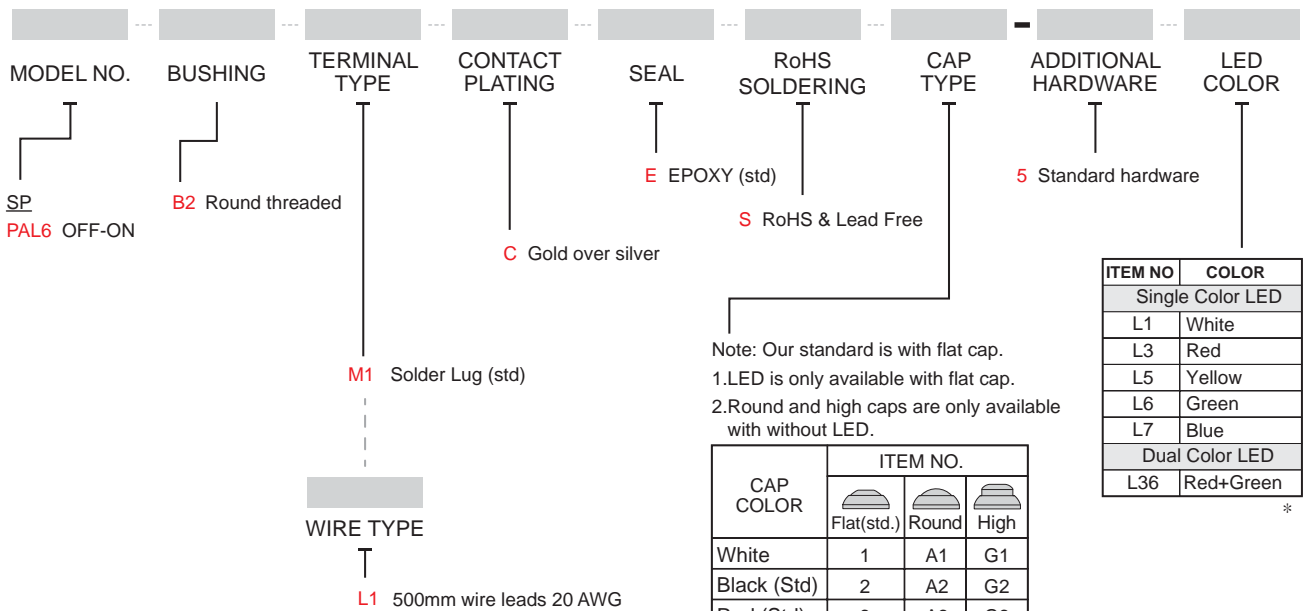

* Except standard color, for other colors information please consult sales representativity.

EXAMPLE:

PAL6B2M1CES□-5 (STD)

□ Cap type

PAL6B2M1CES□-5□ (STD)

□ LED color

□ Flat cap color



SWITCH FUNCTION

NO. POLES	MODEL NO.	SWITCH FUNCTION		CONNECTED TERMINALS		SCHEMATIC
		POS.1	POS.2	POS.1	POS.2	
SP	PAL6	OFF	ON	OPEN	1-3	

CAP OPTIONS

FLAT STD

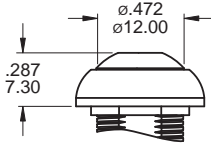

Without LED

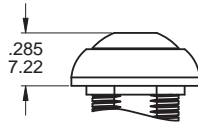

With LED

ROUND No LED *

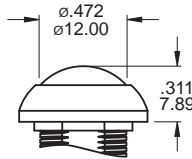

HIGH No LED *

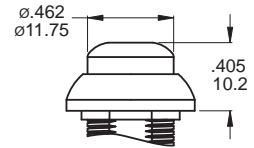

* Note: Round and high caps are not available for Square threaded bushing.

DIMENSION

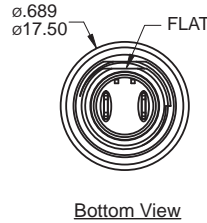
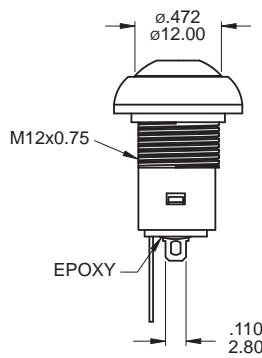
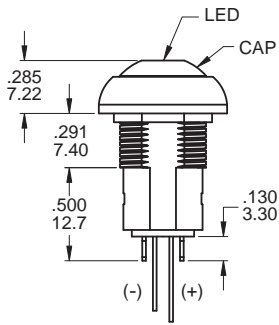

Bottom View

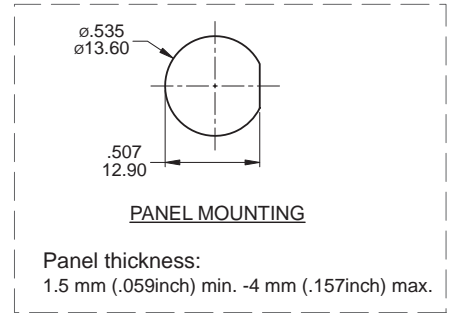

WIRE OPTIONS

Wire leads 20 AWG

* Please consult sales for additional wire options.

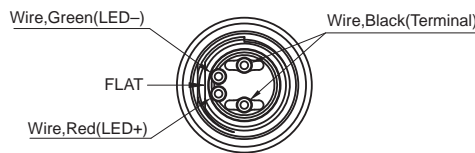
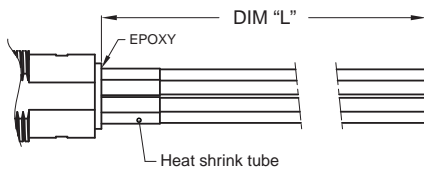

Note: No Illumination: Black Wire - Terminal

WIRE LENGTH

CODE	DIM "L"
L1	500±10(19.7±.394)
L2 *	90±5(3.54±.197)
L3	100±5(3.94±.197)



* Stripping wire for code L2

HARDWARE

EXAMPLE: Model name. 5 Standard hardware

* Standard hardware : 1 nut, 1 O-ring, 1 lockwasher

* For further information please consult sales representativity.

NUT (Std.)

Model name. MNU-PA03

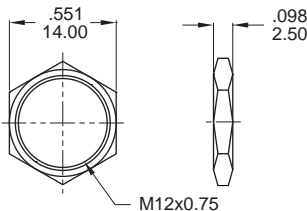

LOCKWASHER (Std.)

Model name. MNU-1M09

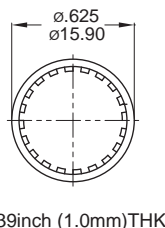

O-RING (Std.)

Model name. FCP-A253

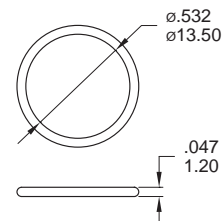



▼ RUBBER HOOD

Transparent rubber hood (Std.)

Model name. KSD-FCP-P003



Black rubber hood

Model name. KSD-FCP-P003-2

MOQ: 10K

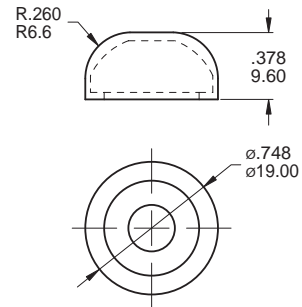

EXAMPLE: - □
Model name.

4 Standard hardware+Transparen rubber hood

* Standard hardware : 1 nut, 1 EVA washer or o-ring, 1 lockwasher, 1 rubber hood

* For further information please consult sales representativity.

▼ SOLDERING PROCESS

MANUAL SOLDERING: Use 30 watts soldering iron and controlled the temperature at 350°.

Duration of solder immersion: Max. 5 sec.

WAVE SOLDERING: Recommend soldering temperature: 260 ± 5°C

Duration of solder immersion: Max. 5 sec. (PCB thickness is 1.6mm)

IP67 for the whole series:
Protected against the effects of
immersion up to 1 m water (30 min)

