



KSD

SWITCH CONNECTOR



SPECIFICATIONS

- CONTACT RATING:** Dependent upon contact material, see page 119.
- MECHANICAL LIFE:** 50,000 make-and-break cycles.
- CONTACT RESISTANCE:** 20 mΩ max. (initial value) @ 2-4VDC
100mA for both silver and gold plated contacts.
- INSULATION RESISTANCE:** 1,000 MΩ min./1000VDC
- DIELECTRIC STRENGTH:** 1,000 Vrms min. @sea level. (initial value)
- OPERATING TEMPERATURE:** -40°C to 85°C.

MATERIALS

- CASE:** Diallyl phthalate(DAP) (UL94V-0).
 - PLUNGER:** Nylon 6/6, black.
 - BUSHING:** Brass or zinc, nickel plated.
 - HOUSING:** Stainless Steel.
 - SWITCH SUPPORT:** Brass, tin plated.
 - CONTACT/TERMINAL:** Copper or brass with silver or gold plated.
- (See page 119)

HOW TO ORDER

MODEL NO.	PLUNGER	BUSHING	TERMINAL TYPE	TERMINAL PLATING	SEAL	RoHS SOLDERING
SP 8MS8 ON-(ON) 8MS9 OFF-(ON)	P1 3.94 high(std)	B05 5.59 high,flat (thd) B06 5.59 high,flat (non-thd) B07 5.59 high (non-thd) B08 7.87 high (non-thd) B09 7.87 high (thd) B10 0.51 high	M1 Solder Lug M2 PC thru-hole M5 Wire wrap M6 Right angle, PC thru-hole M6N Right angle, snap-in, PC thru-hole M7 Vertical right angle, PC thru-hole M7N Vertical right angle, snap-in, PC thru-hole <u>V-bracket</u> VS2 8.94 high V2N 8.94 high, snap-in	Q Silver R Gold C Gold over silver	E EPOXY (std) N NO EPOXY	S RoHS & Lead Free

Note: Plunger cap options see page 118.
 EXAMPLE: KSD-8MS8P1B05M1QES



▼ SWITCH FUNCTION

NO. POLES	UL/CSA MODEL NO.	MODEL NO.	SWITCH FUNCTION		CONNECTED TERMINALS / SCHEMATIC	
			POS.1	POS.2	POS.1	POS.2
SP	Q2818	8MS8	ON	(ON)	2-1 NC 1 • 2 (COMM) • 3 NO	2-3 NC 1 • 2 (COMM) • 3 NO
	Q2819	8MS9*	OFF	(ON)	OPEN	1-3 1 1 3

()=MOMENTARY

* Omit terminal 2

▼ POLE OPTIONS

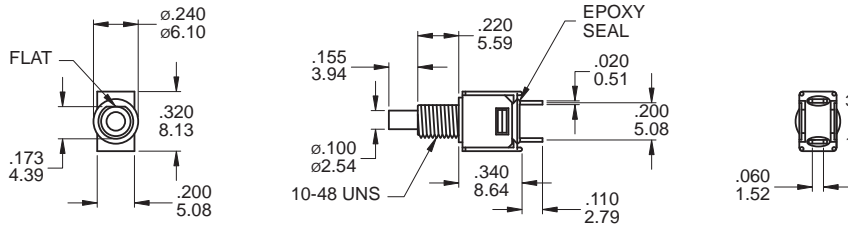

SPST

Model name. KSD-8MS9P1B05M1QES

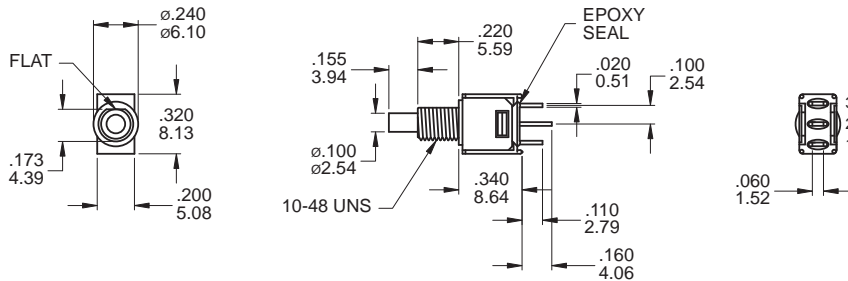

SPDT

Model name. KSD-8MS8P1B05M1QES

▼ PLUNGER & BUSHING OPTIONS

B05 THD *
B06 NON-THD *

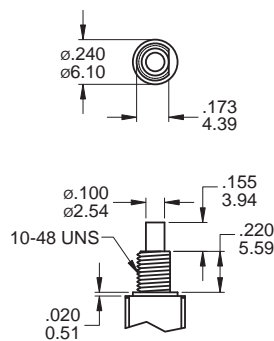

B07 NON-THD *

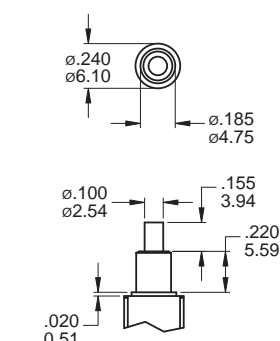

B08 NON-THD **
B09 THD **

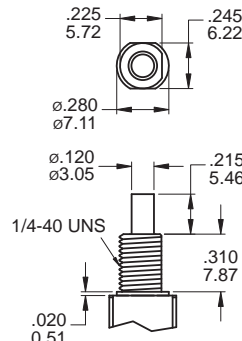

B10

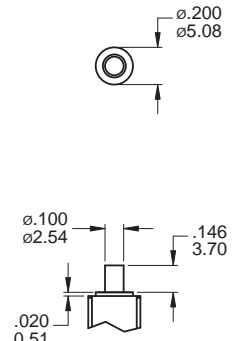

Note: Standard hardware see page 119.

* B05, B06, B07 Bushing with terminal M6, M6N, M7, VS2 plunger -.016inch(0.41mm)

** Plunger are shown with 8MS9 (standard) and available with terminal M1, M2, M5

1.For 8MS8: -.012inch(0.31mm)

2.For plunger with terminal M6, M6N, M7, VS2:

SPST: -.028inch(0.71mm)

SPDT: -.016inch(0.41mm)

Note:

For plunger with terminal M6, M6N, M7, VS2: -.016inch(0.40mm)



▼ PANEL MOUNTING

10-48 BUSHING

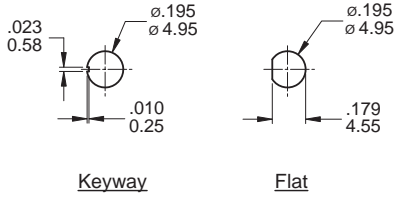

Without locking ring

1/4 IN BUSHING

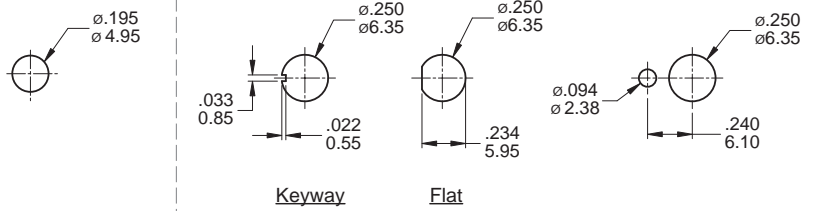

Without locking ring

With standard locking ring

▼ TERMINAL OPTIONS

M1 Solder lug

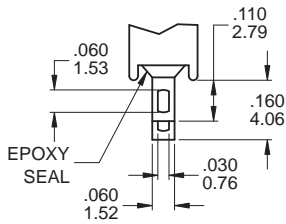

.020inch(0.51mm) THK.

M2 PC Thru-hole

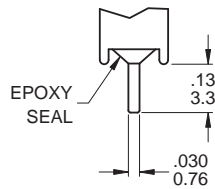

.020inch(0.51mm) THK.

M5 Wire Wrap

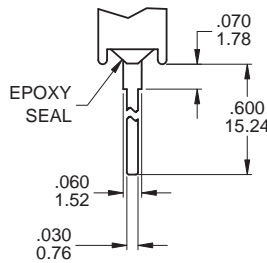

.020inch(0.51mm) THK.

OTHER TERMINAL OPTIONS

- M6** Right angle P.C. Mount
- M6N** Right angle P.C. Mount Snap-in bracket
- M7** Vertical right angle P.C. Mount
- M7N** Vertical right angle P.C. Mount Snap-in bracket
- VS2** Vertical bracket P.C. Mount
- V2N** Vertical bracket P.C. Mount Snap-in bracket

M6 (M6N - Snap-in)

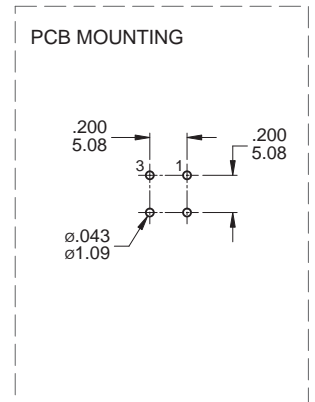
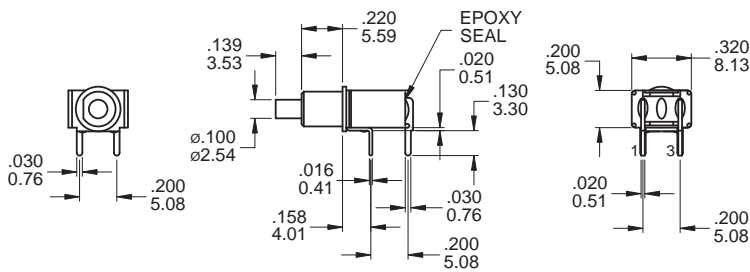

SPST

Model name. KSD-8MS9P1B06M6RES

M6 (M6N - Snap-in)

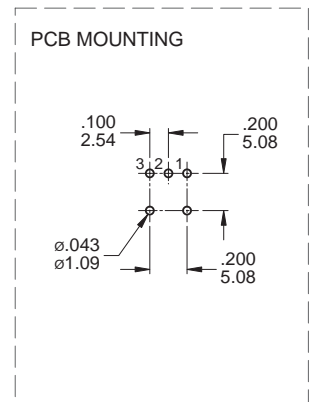
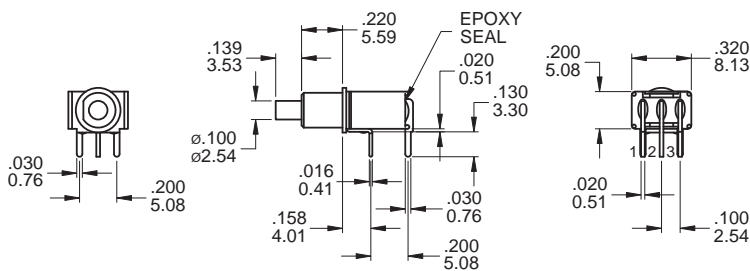

SPDT

Model name. KSD-8MS8P1B06M6QES

M7
(M7N - Snap-in)

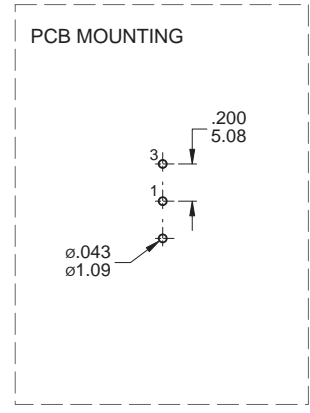
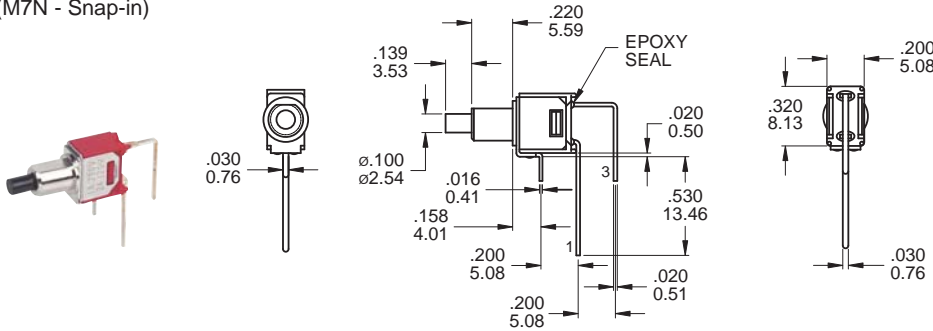

SPST

Model name. KSD-8MS9P1B06M7QES

M7
(M7N - Snap-in)

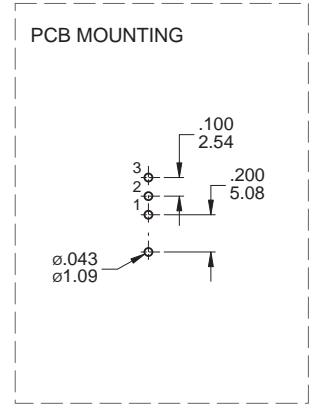
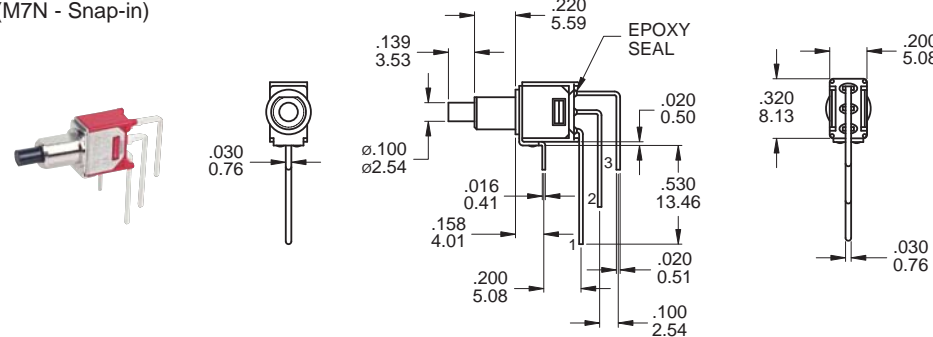

SPDT

Model name. KSD-8MS8P1B06M7QES

VS2
(V2N - Snap-in)

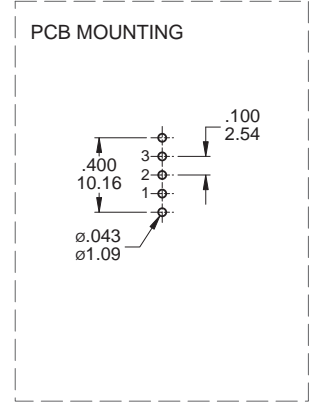
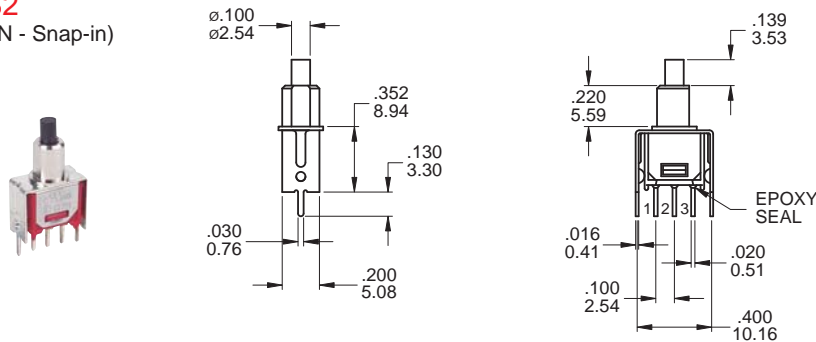

SPDT

Model name. KSD-8MS8P1B06VS2QES

▼ SNAP-IN TERMINAL OPTIONS

M6N

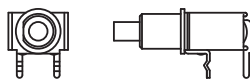

M7N

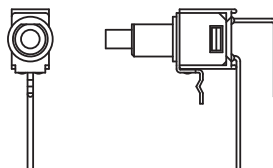

V2N

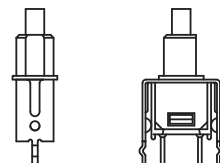



KSD

SWITCH CONNECTOR

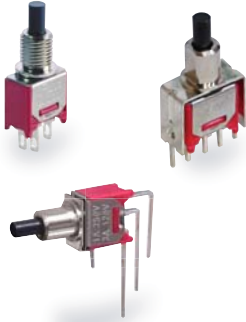

SPECIFICATIONS

- RATING:** 1A 250VAC, 3A 120VAC or 28VDC
- ELECTRICAL LIFE:** 6,000 cycles.
- CONTACT RESISTANCE:** R=20 mΩ max. ,Q=50 mΩ max.
- INSULATION RESISTANCE:** 1,000 MΩ min.,1000VDC
- DIELECTRIC STRENGTH:** 1,000 VAC for 1 Minute. (initial value)
- OPERATING TEMPERATURE:** -40°C to 85°C.
- FULL TRAVEL:** 1.88±0.30mm
- OPERATING TRAVEL:** 1.34±0.25mm
- OPERATING FORCE:** 350±100g

MATERIALS

- CASE:** Diallyl phthalate(DAP) (UL94V-0).
- PLUNGER:** Nylon glass fiber.
- BUSHING:** Brass, nickel plated.
- HOUSING:** Stainless.
- SWITCH SUPPORT:** Brass, tin plated.
- CONTACT/TERMINAL:** Brass with silver or gold plated. (See page 119)

HOW TO ORDER

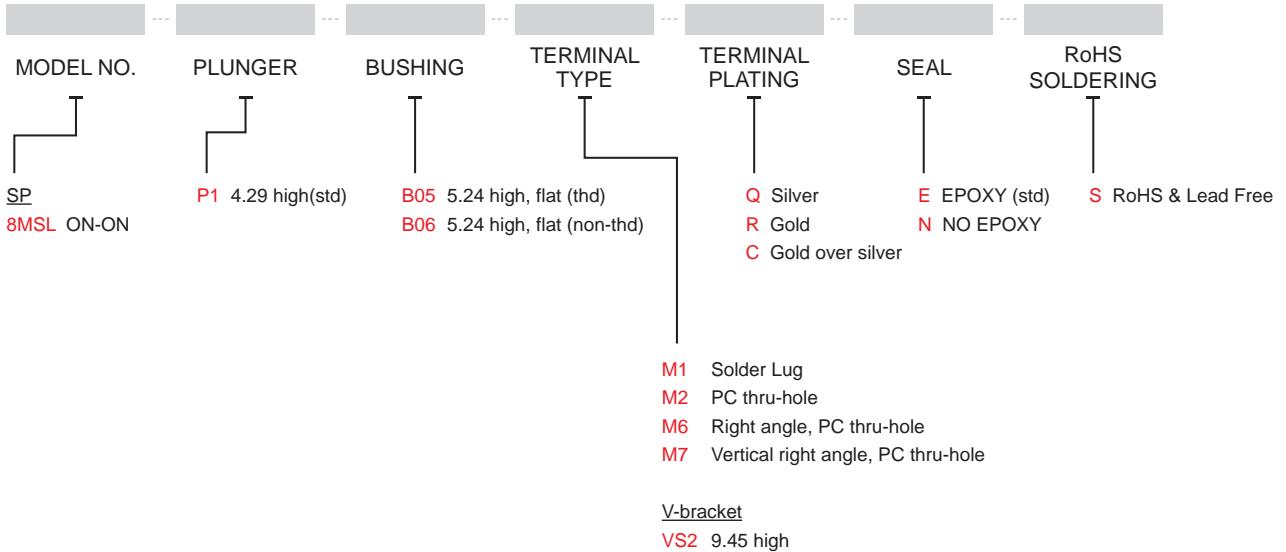

Note: Plunger cap options see page 118.

EXAMPLE: 8MSLP1B05M1QES



▼ SWITCH FUNCTION

NO. POLES	UL/CSA MODEL NO.	MODEL NO.	SWITCH FUNCTION		CONNECTED TERMINALS / SCHEMATIC	
			POS.1	POS.2	POS.1	POS.2
SP	Q28	8MSL	ON	ON	2-1 NC 1	2-3 NC 1

▼ POLE OPTIONS

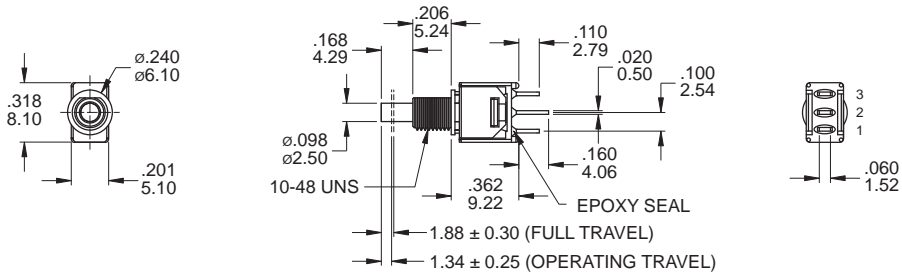

SPDT

Model name. KSD-8MSLP1B05M1QES

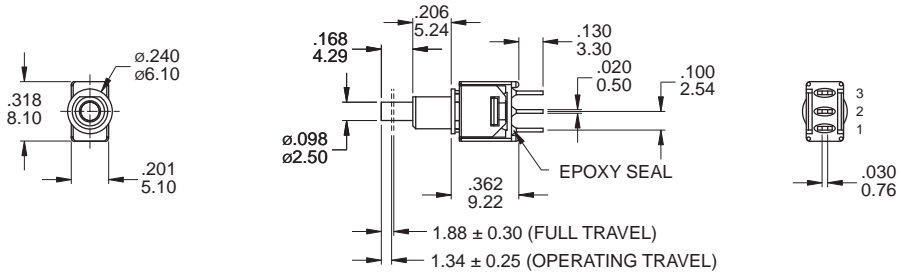

SPDT

Model name. KSD-8MSLP1B06M2QES

▼ PLUNGER & BUSHING OPTIONS

B05 THD

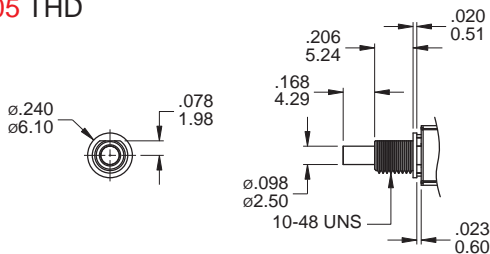

B06 NON-THD

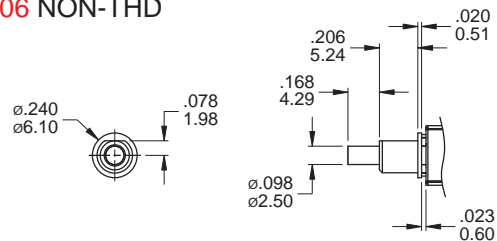

Note: Panel mounting see page 114.

▼ TERMINAL OPTIONS

M1 Solder lug

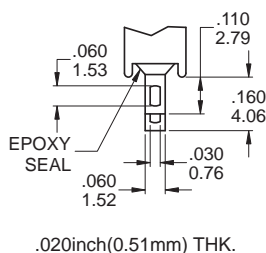

M2 PC Thru-hole

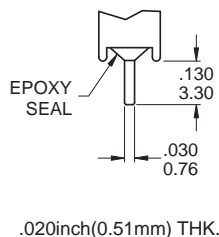

OTHER TERMINAL OPTIONS

- M6** Right angle P.C. Mount
- M7** Vertical right angle P.C. Mount
- VS2** Vertical bracket P.C. Mount



KSD-8M(LOCK) Series

Sub-Miniature Pushbutton Switches



KSD-8M(LOCK)
Pushbutton Switches

M6

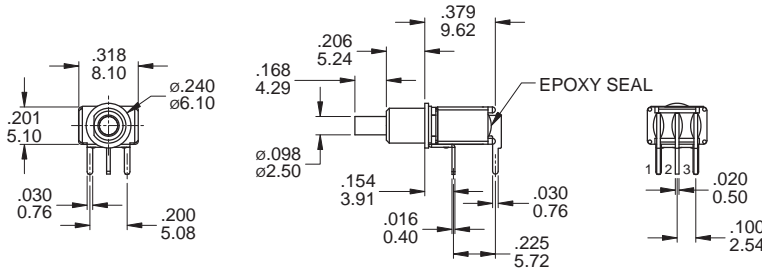

PCB MOUNTING

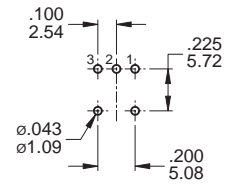

SPDT

Model name. KSD-8MSLP1B06M6QES

M7

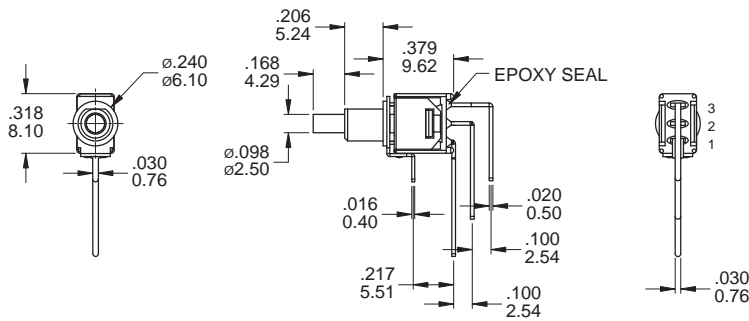

PCB MOUNTING

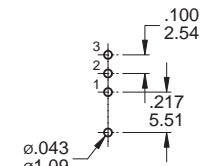

SPDT

Model name. KSD-8MSLP1B06M7QES

VS2

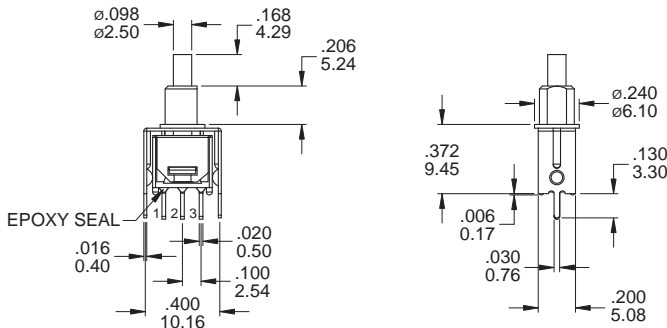

PCB MOUNTING

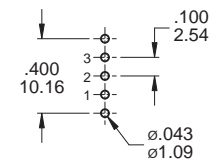

SPDT

Model name. KSD-8MSLP1B06VS2QES

▼ PLUNGER CAP OPTIONS

Note: C1, C3 and C4 cap can only be use with 8M series.

C1

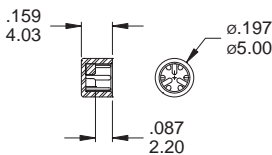

C3

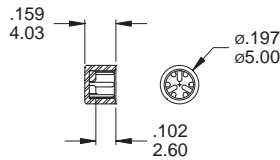

Available with bushing B8, B9 only

C4

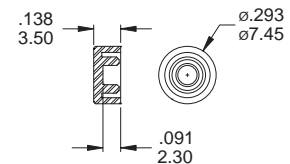

Note: C2, C5 cap can only be use with 8A, B8 series.

C2

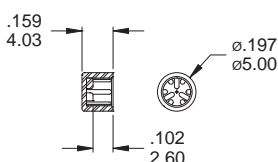

C5

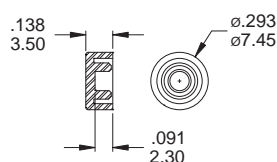

CAP Color :

ITEM NO	COLOR
1	White (Std)
2	Black (Std)
3	Red (Std)
5	Yellow
6	Green (Std)
7	Blue
9	Gray

Note: Only available for 8M, 8A series.

* Except standard color, for other colors information please consult sales representativity.

EXAMPLE:

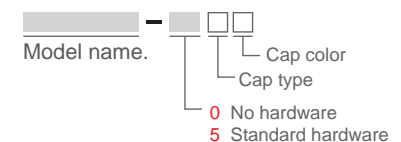



▼ **HARDWARE**

EXAMPLE: - □
Model name. 5 Standard hardware

* Standard for B05 bushing: 2 nut, 1 lockwasher
* Standard for B09 bushing: 2 nut, 1 locking ring, 1 lockwasher

10-48 NUT (Std.)

Model name. MNU-2M01

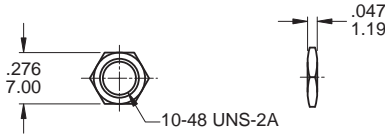

LOCKWASHER (Std.)

Model name. MNU-2M03

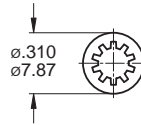

.018inch(0.46mm)THK

Available with bushing B05 only.

1/4 NUT (Std.)

Model name. MNU--1M01A

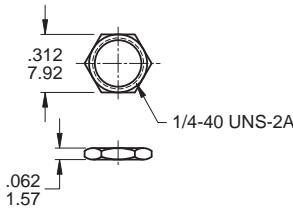

LOCKWASHER (Std.)

Model name. MNU-1M03

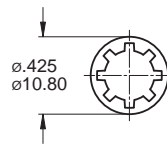

.018inch(0.46mm)THK

Available with bushing B09 only.

LOCKING RING (Std.)

Model name. MNU-1M11

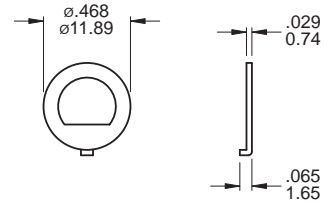

Available with bushing B09 only.

▼ **CONTACT & TERMINAL PLATING OPTIONS**

	CONTACT PLATING	TERMINAL PLATING	RATINGS
Q	Silver	Silver	3 Amps with resistant load @ 120VAC or 28VDC 1 Amps with resistant load @ 250VAC
C	Gold over Silver	Gold over silver	
R	Gold	Gold	0.4 Volt - Amps (VA) max. @ 20V max. (AC or DC)

▼ **SOLDERING PROCESS**

MANUAL SOLDERING: Use 30 watts soldering iron and controlled the temperature at 350°.

Duration of solder immersion: Max. 5 sec.

WAVE SOLDERING: Recommend soldering temperature: 260 ± 5°C

Duration of solder immersion: Max. 5 sec. (PCB thickness is 1.6mm)