



# KSD

## SWITCH CONNECTOR



### SPECIFICATIONS

- CONTACT RATING:** Dependent upon contact material, see page 76.
- MECHANICAL LIFE:** 50,000 make-and-break cycles.
- CONTACT RESISTANCE:** 20 mΩ max. (initial value) @ 2-4VDC  
100mA for both silver and gold plated contacts.
- INSULATION RESISTANCE:** 1,000 MΩ min./1000VDC
- DIELECTRIC STRENGTH:** 1,000 Vrms min. @sea level.(initial value)
- OPERATING TEMPERATURE:** -30°C to 85°C.

### MATERIALS

- CASE & BUSHING:** Glass filled nylon 6/6, flame retardant, heat stabilized (UL94v-0).
- ACTUATOR:** Black nylon, internal o-ring sealed.
- SWITCH SUPPORT:** Brass, tin plated.
- CONTACT / TERMINALS:** Copper with silver or gold plated.  
(See page 76)

## HOW TO ORDER

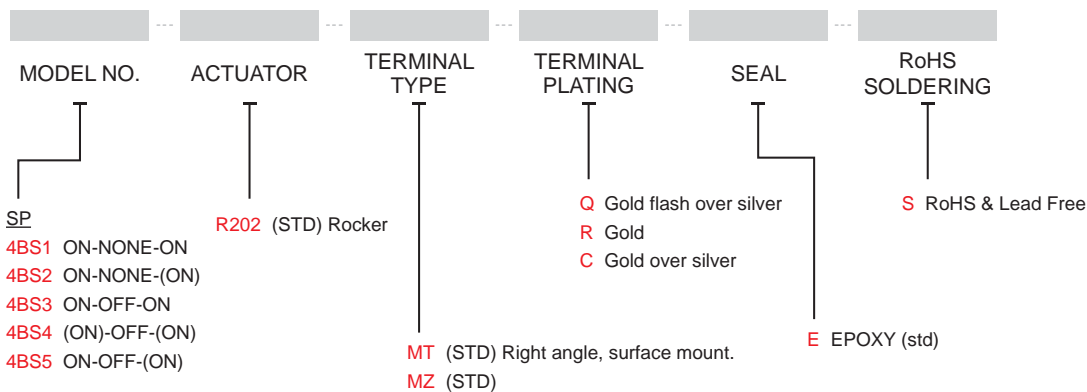

EXAMPLE: 4BS1R202MTQES



## ▼ SWITCH FUNCTION

NO. POLES	UL/CSA MODEL NO.	MODEL NO.	SWITCH FUNCTION			CONNECTED TERMINALS / SCHEMATIC		
			POS.1	POS.2	POS.3	POS.1	POS.2	POS.3
SP	Q24B11	4BS1	ON	NONE	ON	2-3	N/A	2-1
	Q24B12	4BS2	ON	NONE	(ON)			
	Q24B13	4BS3	ON	OFF	ON			
	Q24B14	4BS4	(ON)	OFF	(ON)			
	Q24B15	4BS5	ON	OFF	(ON)			OPEN

( )=MOMENTARY

## ▼ POLE OPTIONS

### MT

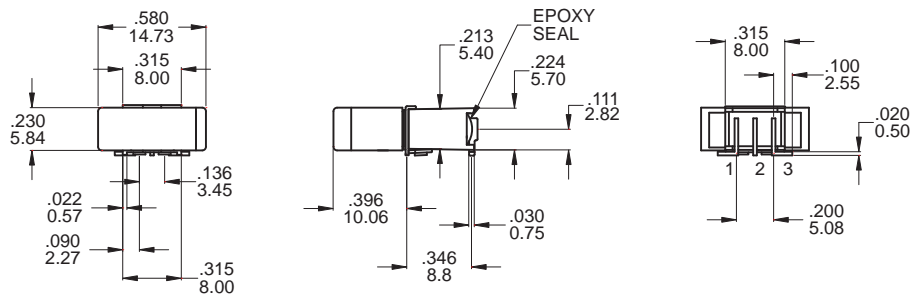

### SPDT

Model name. KSD-4BS1R202MTRES

### MZ

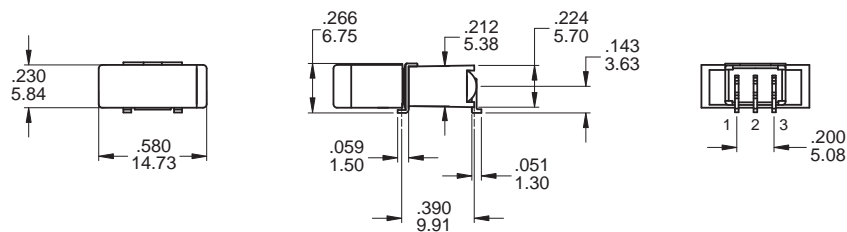

### SPDT

Model name. KSD-4BS1R202MZRES

## ▼ PCB MOUNTING

### MT

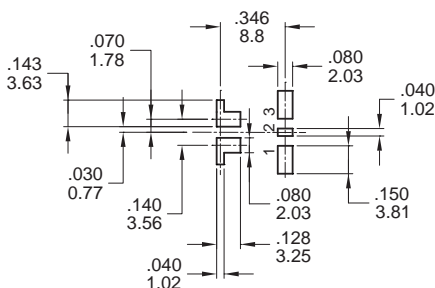

### MZ

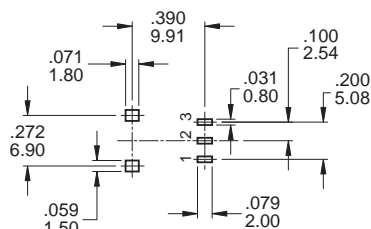



# KSD-4B Series

Sealed Sub-Miniature Rocker Switches(SMT)



KSD-4B  
Rocker Switches

## ▼ PACKAGING

Switches available on embossed antistatic tape and reels.

Tape and cover strip are conductive for use near statically sensitive components.

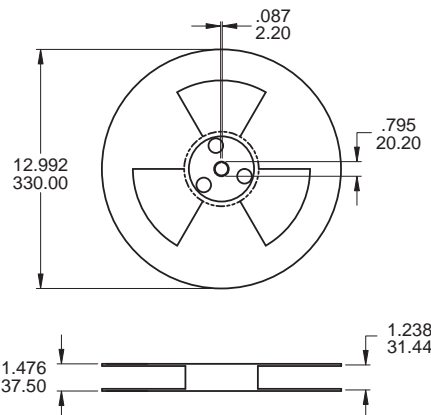
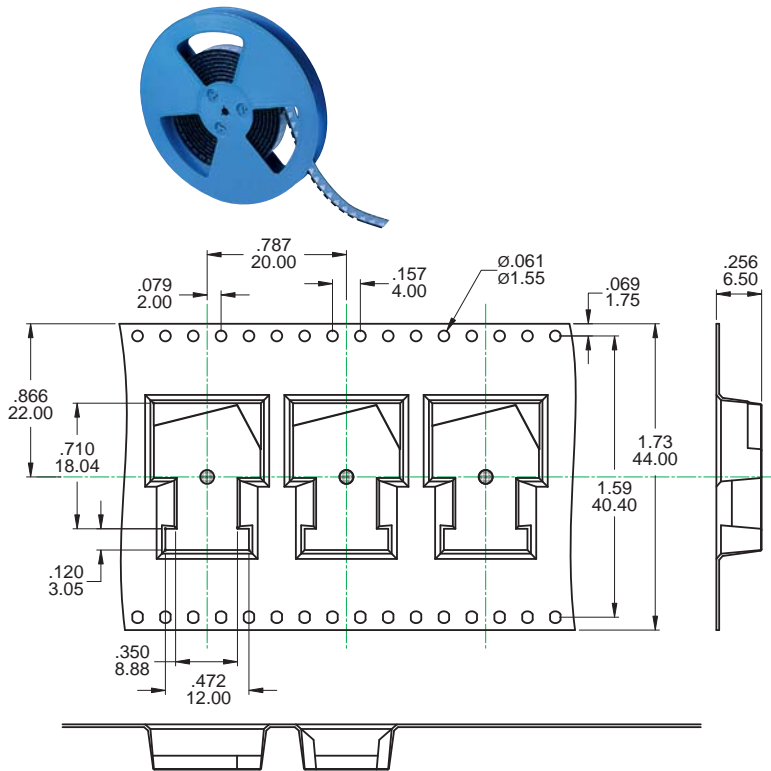

SCALE: 10 : 1

REEL INFORMATION	
QUANTITY PER REEL	450 / pcs

SCALE: 1 : 1

## ▼ CONTACT & TERMINAL PLATING OPTIONS

	CONTACT PLATING	TERMINAL PLATING	RATINGS
Q	Silver	Gold flash over silver	3 Amps with resistant load @ 120VAC or 28VDC 1 Amps with resistant load @ 250VAC
C	Gold over Silver	Gold over silver	
R	Gold	Gold	0.4 Volt - Amps ( VA ) max. @ 20V max. ( AC or DC )

## ▼ SOLDERING PROCESS

### REFLOW SOLDERING:

Recommend soldering temperature:  $260 \pm 5^{\circ}\text{C}$

Duration of solder immersion: Max. 5 sec.

(PCB thickness is 1.6mm)

**SOLDERING:** Vapor phase & IR-reflow soldering can be applied.

### Temperature Profile

Zone	Room Temperature	Time (Sec)
Pre-heat (A)	150°C	Min 120s
Soak (B)	150°C ~ 200°C	Min 150s
Peak (C)	200°C ~ 235°C	Min 30s
Peak (D)	235°C ~ 260°C	Min 40s
Peak (E)	260°C	Max 5s

