

KSD-ZMT Series Mini Size Sealed Snap-acting Switches



Electrical

Mechanical

Features/Benefits

- IP67 rating / Dust tight protection
- From 0.1A to 5A max. (ultra-low current available)
- UL / ENEC

Typical Applications

- Automotive: door latch, seat position detection, EV charging
- Handheld devices (medical)
- Industrial equipment
- Consumer electronics

Specifications

CONTACT RATING: 0.1A 125/250VAC 3A 24VDC
 3A 125/250VAC 3A 24VDC
 5A 125/250 VAC 3A 24VDC

ELECTRICAL LIFE: 10,000 cycles

ELECTRICAL OPERATING FREQUENCY: 10-30 operations per minute

MECHANICAL LIFE: 1,000,000 operations

MECHANICAL OPERATING FREQUENCY: 120 operations per minute

INSULATION RESISTANCE: Min. 100 MΩ (500 VDC/minute) between Live-parts and dead metal parts

DIELECTRIC STRENGTH: 500VAC (50-60HZ)/minute between contacts
 1500VAC (50-60HZ)/minute between Live-parts and dead metal parts

OPERATING TEMPERATURE: -40°C to 85°C (with no icing)

OPERATING FORCE: 200 grams

Materials

CASE: PBT
 COVER: PBT
 BUTTON: PBT
 MOVABLE CONTACTS: AG alloy
 TERMINALS: AG alloy
 LEVER: Stainless steel
 WIRE: PVC+CU
 LOWE CASE: Nylon
 RUBBER SEAL: Silicon

NEW

Build-A-Switch

Our easy build-a-switch concept allows you to mix and match options to create the switch you need. To order, select desired option from each category and place it in the appropriate box.



Electrical Rating

- 01A** 0.1A 125/250VAC (Contact silver plated)
- 03A** 3A 125/250VAC (Contact silver plated)
- 05A** 5A 125/250VAC (Contact silver plated)
- G03** 3A 125/250VAC (Contact gold plated)

Operating Force

- CF** Refer to force table (P00 = 100 gf)
- CJ** Refer to force table (P00 = 170 gf)

Actuator Type

- P00** Pin plunger
- L03** Leaf lever 3.2 mm
- F01** Leaf lever (fold) 1.1 mm
- S02** Simulated leaf roller 1.9 mm
- S05** Simulated leaf roller 5.0 mm
- S06** Simulated leaf roller 5.8 mm
- A01** Roller 0.2 mm
- H03** Hinged lever 3.2 mm
- R05** Hinged simulated leaf roller 5.0 mm

Terminations

- P** PC thru-hole
- S** Solder
- L** Left-footed, PC thru-hole
- R** Right-footed, PC thru-hole
- J** Wire leads out bottom
- K** Wire leads out right side
- W** Wire leads out left side

Wire Type for J, K, W Terminations

- NONE** AVSS 0.3 mm² (No UL, No ENEC)
- 20** UL1007 20 AWG
- 22** UL1007 22 AWG
- 24** UL1007 24 AWG

Cover & Case Type

- E** E type

Circuitry

- C** SPDT
- W** SPST N.C.
- Y** SPST N.O.

Dimensions are shown: mm
 Specifications and dimensions subject to change

SERIES

ZMT MINI SIZE SEALED SNAP-ACTING SWITCHES - SP MOMENTARY

NEW

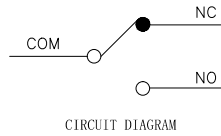
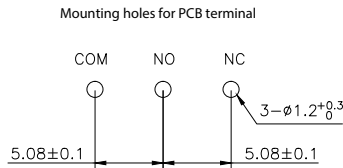
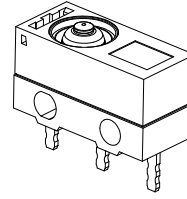
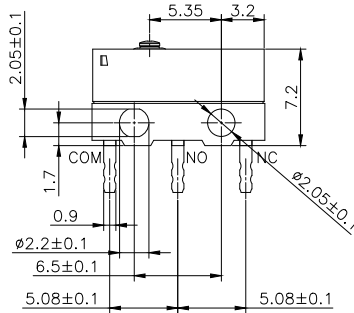
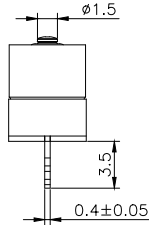
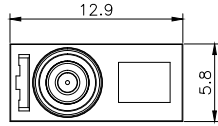

ELECTRICAL RATING

Silver Contacts

ZMT	UL1054/UL1058
01A	0.1A 125/250VAC 3A 24VDC
03A	3A 125/250VAC 3A 24VDC
05A	5A 125/250VAC 3A 24VDC

Gold Contacts

ZMT	UL1054/UL1058
G03	3A 125/250VAC 3A 24VDC

- Note: See Technical Data in section N of this catalog for RoHS compliant and compatible definition and specifications.
- All models  with all options.
- Consult Customer Service center for availability and delivery of nonstandard ratings.

OPERATING FORCE

OPERATING CODE	OPERATING FORCE AT THE BOTTON (OZ / GRAMS)
CF	3.52 / 100
CJ	5.99 / 170

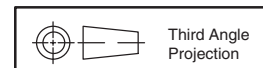

Dimensions are shown: mm
Specifications and dimensions subject to change



Snap-acting

KSD-ZMT Series Mini Size Sealed Snap-acting Switches

NEW

KSD
SWITCH CONNECTOR

ACTUATORS

P00 PIN PLUNGER

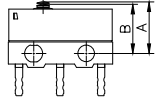

S02 SIMULATED ROLLER 1.9 MM

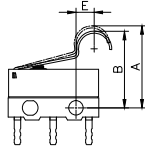

F01 LEAF LEVER (FOLD) 1.1 MM

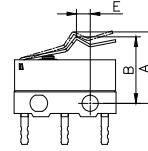

L03 LEAF LEVER 3.2 MM

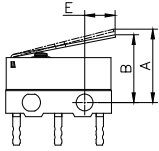

S06 SIMULATED LEAF ROLLER 5.8 MM

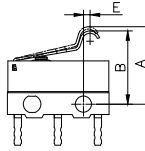

R05 HINGED SIMULATED LEAF ROLLER 5.0 MM

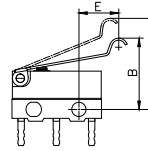

S05 SIMULATED LEAF ROLLER 5.0 MM

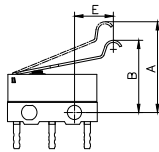

H03 HINGED LEVER 3.2 MM

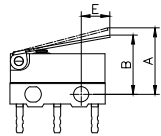

A01 ROLLER 0.2 MM

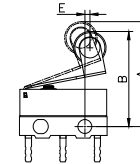

CODE	OPER. FORCE MAX.(gf)		REL. FORCE MIN.(gf)		A FP MAX. (mm)	B OP MAX. (mm)	C PT MAX. (mm)	D OT MIN. (mm)	E MIN. (mm)
P00	100	170	21	35	6.4	5.9±0.2	0.5	0.2	-
L03	32	56	5	8	9.0	7.1±0.8	3.4	0.6	3.2
S05	28	48	5	7	13.1	9.1±0.8	3.5	0.7	5
F01	58	83	7	11	9.05	8.1±0.6	1.64	0.49	1.1
A01	45	55	4	8	15.45	13.0±1.1	3.5	0.1	0.2
S02	40	50	5	8	11.7	10.1±1.0	3.0	0.6	1.9
S06	45	65	5	12	9.85	8.5±0.8	1.8	0.25	0.1
H03	32	56	5	8	9.0	7.1±0.8	3.4	0.6	3.2
R05	28	48	5	7	13.1	9.1±0.8	3.5	0.7	5

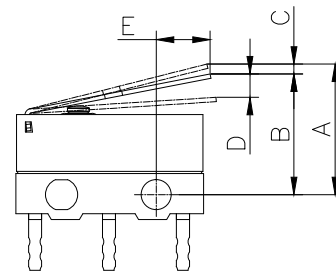

Snap-acting



Third Angle
Projection

Dimensions are shown: Inch (mm)

Specifications and dimensions subject to change

www.bodongkaiguan.net

TERMINATIONS

P PC THRU-HOLE

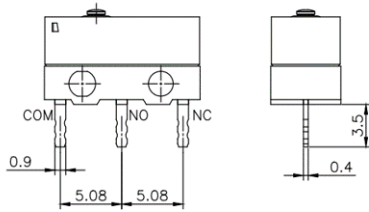

S SOLDER

NEW

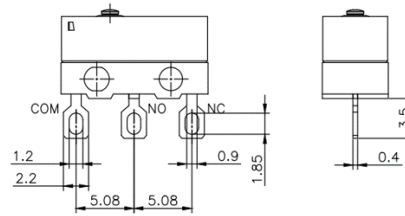

L LEFT-FOOTED, PC THRU-HOLE

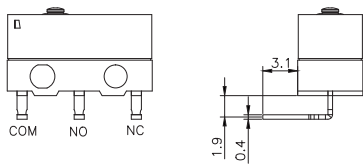

R RIGHT-FOOTED, PC THRU-HOLE

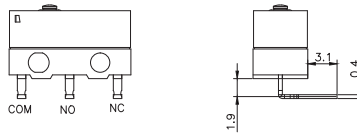

J WIRE LEADS OUT BOTTOM

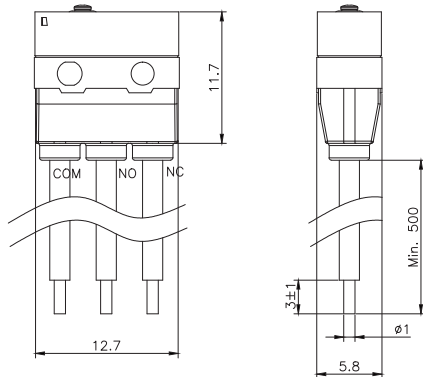

COM: UL1007 20AWG/22AWG/24AWG OR EQUIVALENT(BLACK)
NO: UL1007 20AWG/22AWG/24AWG OR EQUIVALENT(BLUE)
NC: UL1007 20AWG/22AWG/24AWG OR EQUIVALENT(GRAY)

K WIRE LEADS OUT RIGHT SIDE

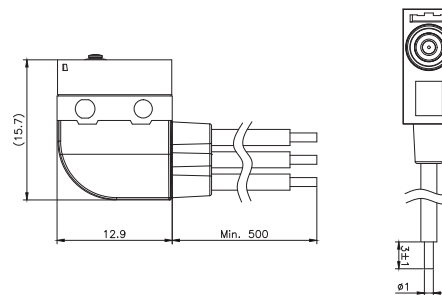

COM: UL1007 20AWG/22AWG/24AWG OR EQUIVALENT(BLACK)
NO: UL1007 20AWG/22AWG/24AWG OR EQUIVALENT(BLUE)
NC: UL1007 20AWG/22AWG/24AWG OR EQUIVALENT(GRAY)

W WIRE LEADS OUT LEFT SIDE

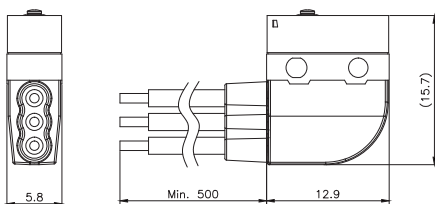

COM: UL1007 20AWG/22AWG/24AWG OR EQUIVALENT(BLACK)
NO: UL1007 20AWG/22AWG/24AWG OR EQUIVALENT(BLUE)
NC: UL1007 20AWG/22AWG/24AWG OR EQUIVALENT(GRAY)

Dimensions are shown: Inches (mm)
Specifications and dimensions subject to change



Snap-acting

KSD-ZMT Series Mini Size Sealed Snap-acting Switches

NEW

KSD
SWITCH CONNECTOR

CIRCUITRY

C SPDT

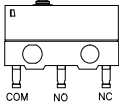

Y SPST NO

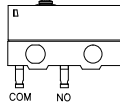

W SPST NC

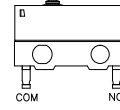

Snap-acting



Third Angle
Projection

Dimensions are shown: Inch (mm)
Specifications and dimensions subject to change

www.bodongkaiguan.net