

Features/Benefits

- Overtravel up to 1.4 mm
- Permanent actuation possible
- Designed for low-level switching

Typical Applications

- Off-road transportation
- Industrial electronics
- Joysticks
- Medical equipment



Construction

FUNCTION: momentary
 DISTANCE BETWEEN BUTTON CENTERS:
 min. 11 (0.433)
 TERMINALS: PC pins, tinned
 MOUNTING: Locating pins; K12P additionally with
 snap-in housing

Mechanical

TOTAL TRAVEL: 1.5 mm, 2 mm
 SWITCHING TRAVEL: 0,6 mm *
 OPERATING FORCE: 1.5 N OD without snap-point as detector
 switch

* Additional switching travel (with pre-travel) available by request

Packaging

Bulk in boxes of 300 pieces

Electrical

SWITCHING POWER MIN./MAX.: 0.02mW/3 W
 SWITCHING VOLTAGE MIN./MAX.: 2 V DC / 30 V DC
 SWITCHING CURRENT MIN./MAX.: 10 mA /100 mA
 DIELECTRIC STRENGTH (50 Hz, 1 min): ≥ 500 V
 OPERATING LIFE with max. switching power: ≥ 10⁶ operations
 CONTACT RESISTANCE: Initial ≤ 50 mΩ
 INSULATION RESISTANCE: ≥ 10¹⁰ Ω
 BOUNCE TIME: ≤ 1 ms
 Operating speed 100 mm/s (3.94/s)

Environmental

OPERATING TEMPERATURE: -40°C to 85°C.
 STORAGE TEMPERATURE: -40°C to 95°C.

Process

SOLDERABILITY:
 Wave soldering, compatible with lead free soldering profile
 Hand soldering, 350°C

Build-A-Switch

To order, simply select desired option from each category and place in the appropriate box. Available options are shown and described on the next page. For additional options not shown in catalog, consult Customer Service Center.

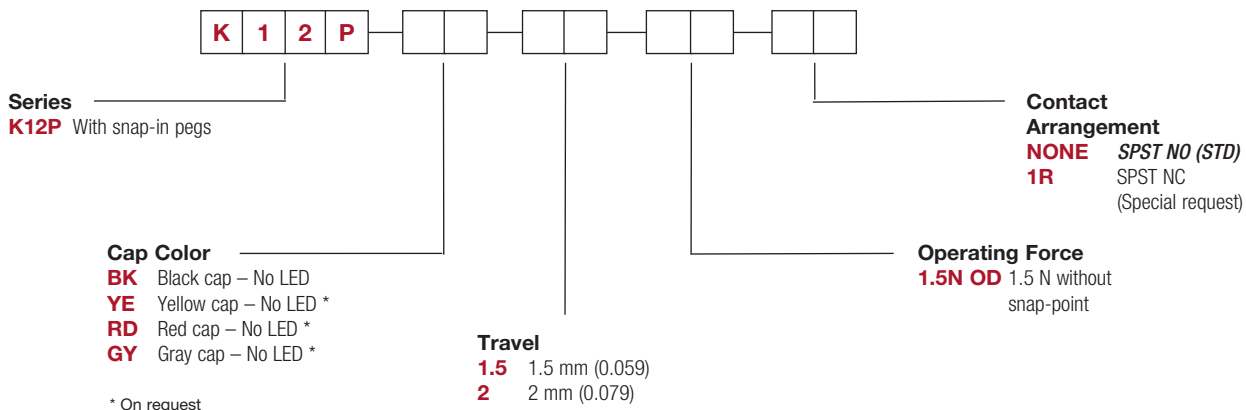

SERIES

K12P with snap in

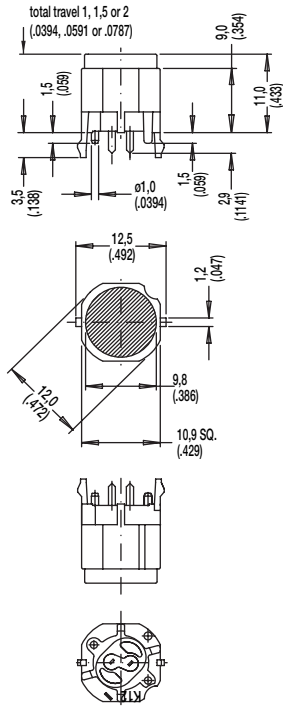

PCB LAYOUT, MOUNTING SIDE

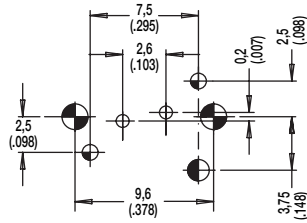

center of actuation area (notice LED)



Hole	Ø	Without LED	Description	Terminal Section	Surface
	1,7 (.069)	2x	snap-in		
	1,6 (.062)	1x	coding hole (L,M,N)		
	1,1 (.043)	2x	center hole		Sn
	0,9 (.035)	2x	switch	0.7 x 0.2 (.028 x .081)	Sn



Detect

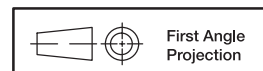

First Angle Projection

Dimensions are shown: mm
Specifications and dimensions subject to change