

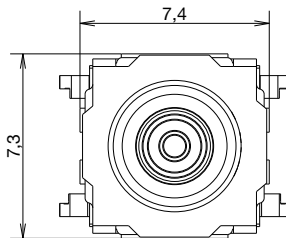

### ACTUATOR TYPE

#### KSA & KSL

Tactile Switches

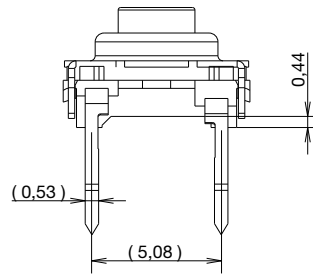
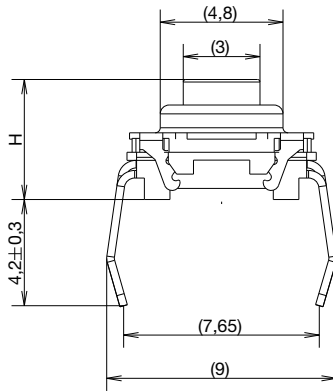
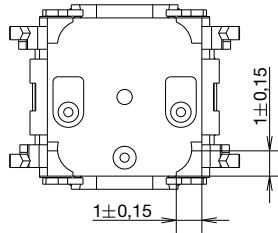

Type	H mm	inch
KSA	4,7±0,2	(.185)
KSL	9,9±0,2	(.390)

### GROUND TERMINAL

0 WITHOUT

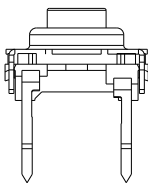

1\* WITH

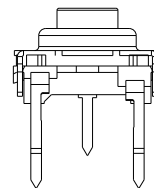

\*Not compatible with "V" insertion

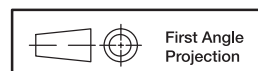

First Angle  
Projection

Dimensions are shown: mm  
Specifications and dimensions subject to change

# KSA & KSL Series Sealed Tact Switch



## INSERTION

### M MANUAL (BULK PACKAGING)

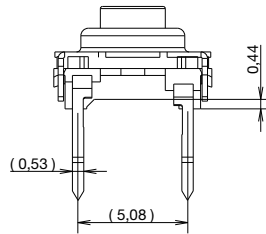
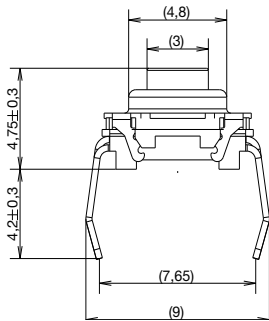

### PCB LAYOUT

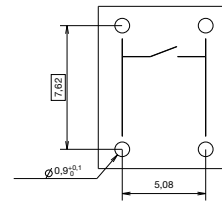

### A AUTOMATIC (TUBE PACKAGING, 65 PIECES PER TUBE)

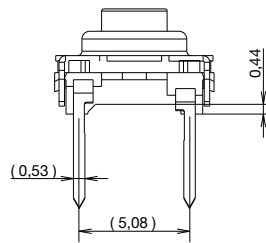
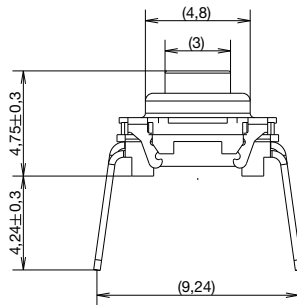

### PCB LAYOUT

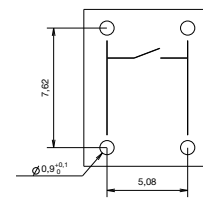

### V VERTICAL

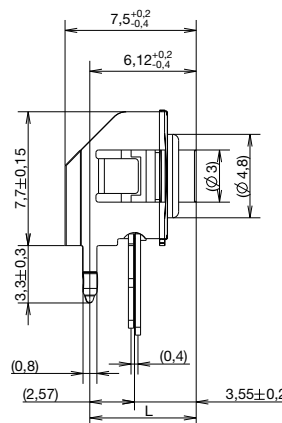
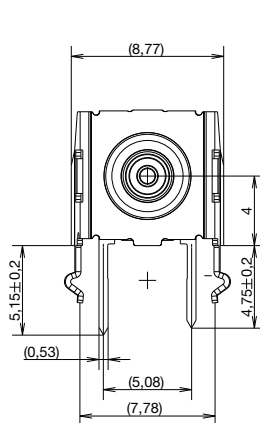

### PCB LAYOUT

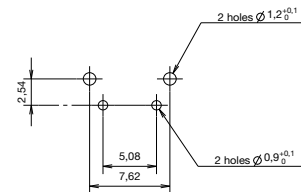

### DIMENSION L

Type	L mm	inch
KSA0V	5,8	.228
KSL0V	11,1	.437

## OPERATING FORCE

OPTION CODE	OPERATING FORCE
<b>2</b>	1.3 N (130 grams) 100,000 operations
<b>3</b>	1.3 N (130 grams) 1,000,000 operations
<b>4</b>	3.0 N (300 grams) 100,000 operations
<b>5</b>	5.0 N (500 grams) 100,000 operations
<b>9</b>	3.0 N (300 grams) 500,000 operations

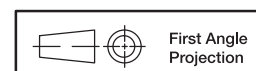

Dimensions are shown: mm  
Specifications and dimensions subject to change

### CONTACT MATERIAL



OPTION CODE	CONTACT MATERIAL
<b>1</b>	Silver contacts
<b>3</b>	Gold contacts



**B**

Tactile Switches

### SEALING



OPTION CODE	SEALING
<b>1</b>	Sealing level IP60

### BUTTONS

Buttons must be ordered separately and will be supplied in bulk.

BUTTON TYPE	KSA	KSL	KSAV	KSLV
<b>K01</b>	X			
<b>K02</b>	X			
<b>K03</b>	X	X	X	X

**K01**

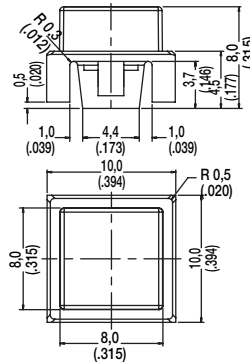
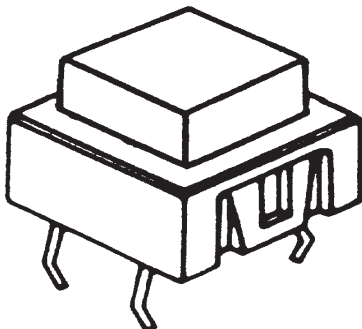

Dimensions are shown: mm  
Specifications and dimensions subject to change

**K02**

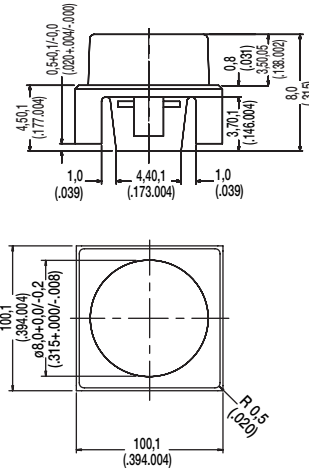
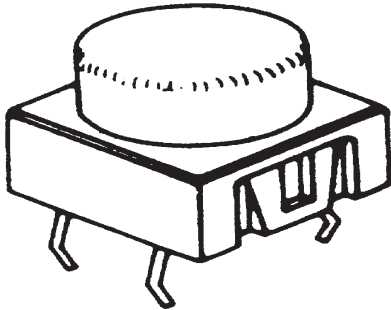

**K03**

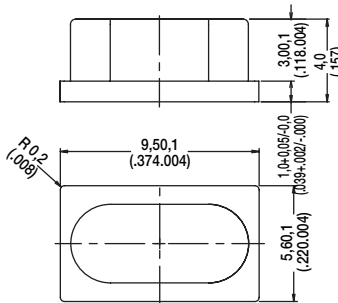
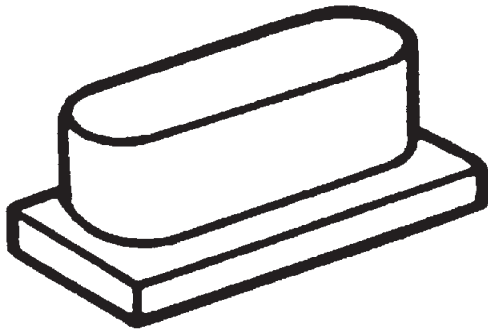

First Angle  
Projection

Dimensions are shown: mm  
Specifications and dimensions subject to change