

# KSD

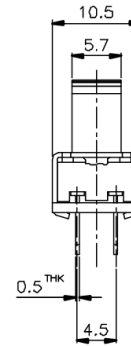
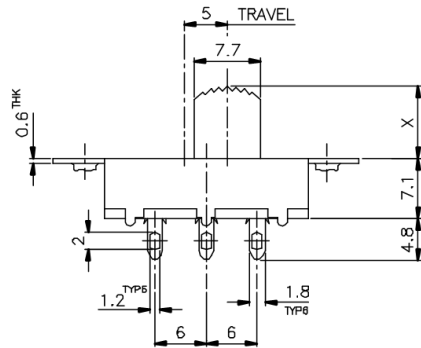
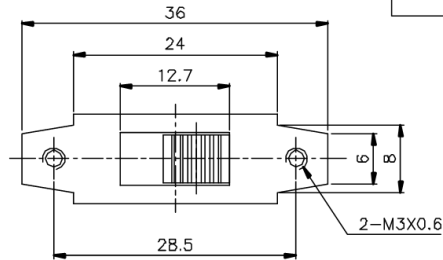
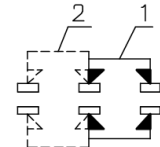

X=

|        |   |                          |
|--------|---|--------------------------|
| ISSUED | SPECIFICATION (INITIAL)   | TITLE: SLIDE SWITCH 2P2T |
|        | RATING: AC 125V 2A  | MODEL NO: WS-22J07-G     |
|        | CONTACT RESISTANCE: Not more than 30mΩ                                      | UNIT: mm DWN             |
|        | INSULATION RESISTANCE: 500MΩ at 500V DC                                     | SCALE: 2 : 1 CHK'D       |
|        | WITHSTAND VOLTAGE: AC 1000V for 1 min                                       | TOLERANCE: ±0.2 APPD.    |
|        | OPERATION FORCE: 400 ± 200g   |                          |
|        | SWITCHING LIFE: 10000 Cycles (6-10c/m loading)                              |                          |
| BY:    | <b>广东科斯达电子科技有限公司</b><br>GUANG DONG KE SI DA ELECTRONIC TECHNOLOGY CO., LTD. | DRWG NO:                 |
| DATE:  |   | 920033-00                |