

NON-SHORTING  
SCHEMATIC

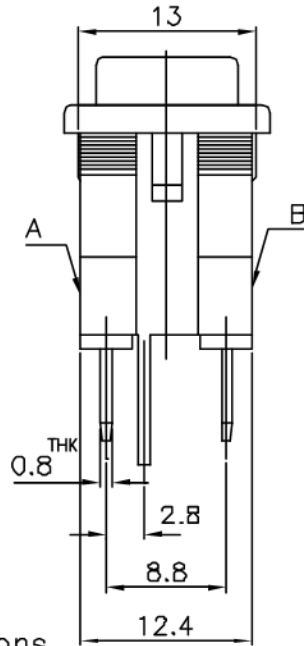
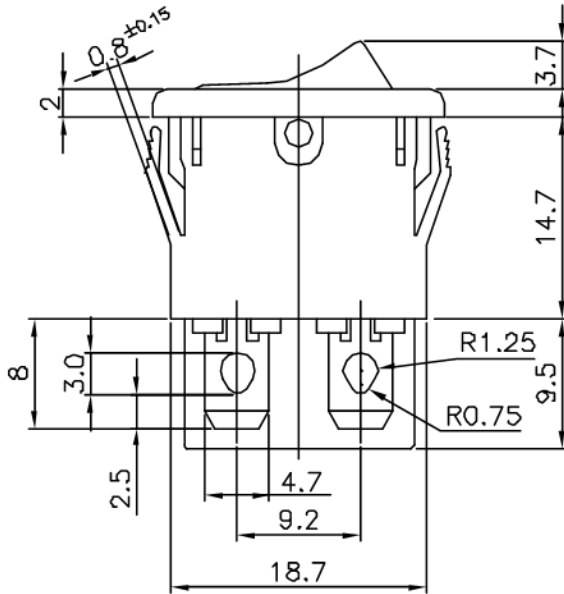

Rating : Panel Cut-Out Dimensions

SIDE A :

LAMB RA  
AC125V 16A (RES)  
12A (IND)  
T85  
A2 A1

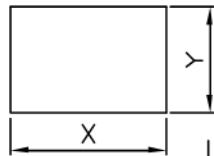

SIDE B :

6(4)A 5E4  
10(6)A  
250V~  
B1 B2

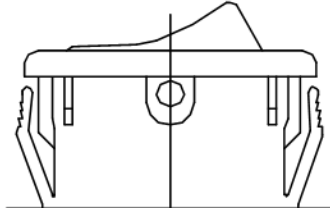

??????????

Panel thickness (mm/inch)	DIM X <sup>+0.1</sup> <sub>-0</sub> (mm/inch)	DIM Y ±0.1 (mm/inch)
1.2~1.6 (.047~.063)	19.0 (0.748)	13.1 (.516)
1.6~2.0 (.063~.079)	19.4 (0.764)	
2.0~2.4 (.079~.095)	19.8 (0.779)	

ISSUED	SPECIFICATION (INITIAL)	TITLE: ROCKER SWITCH 2P2T			
	RATING: AC 125V 16A	MODEL NO: U16WR-22Q07-R1(1W)-00-#480			
	CONTACT RESISTANCE: Not more than 30mΩ	UNIT: mm	DWN	liu	16/8-06
	INSULATION RESISTANCE: 500MΩ at 500V DC	SCALE: 2 : 1	CHK'D		
	WITHSTAND VOLTAGE: AC 1000V for 1 min	TOLERANCE: ±0.2	APPD.		
	OPERATION FORCE: 900±200g				
	SWITCHING LIFE: 10000 Cycles(6-10c/m loading)				
BY:	<b>广东科斯达电子科技有限公司</b> GUANG DONG KE SI DA ELECTRONIC TECHNOLOGY CO., LTD.	DRWG NO:			
DATE:		A60570-00			