

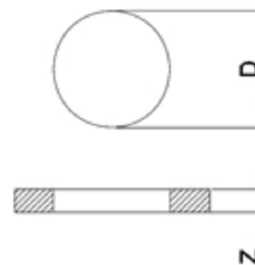

Rating: 0.3A 30VDC  
 Contact Resistance: 40mΩ Max.  
 Insulation Resistance: DC 500V 100MΩ Min.  
 Dielectric Strength: AC 500V 1 minute  
 Total travel: 1.0± 0.15mm  
 Operating Force: 250± 100gf  
 Operating Life: 1,000,000 cycles  
 Operating Temperature: -20° C~70° C

Function: OFF - (ON)

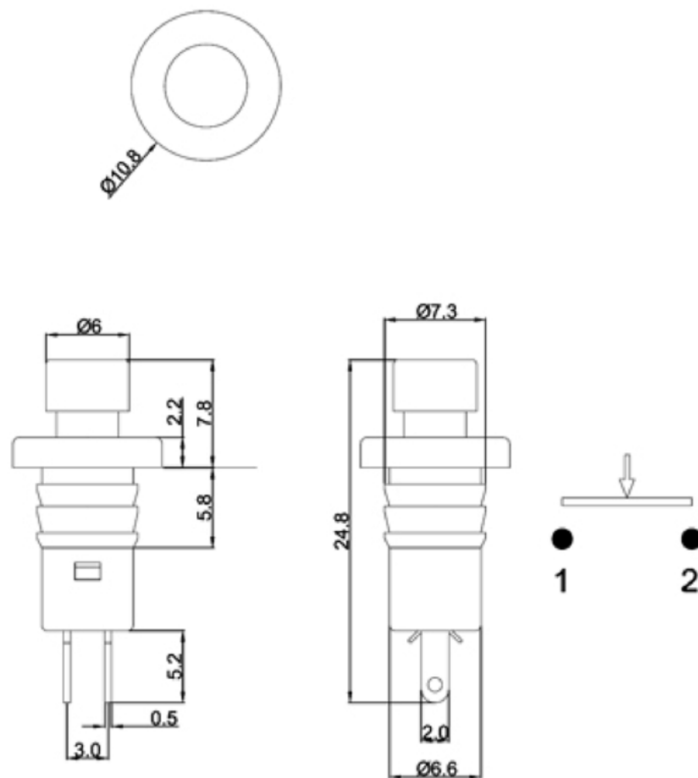

Z	D
1.0~2.0	6.6~6.8
2.0~2.5	6.8~7.0
2.5~3.0	7.0~7.2

**CUT-OUT**

**广东科斯达电子科技有限公司**  
 GUANG DONG KE SI DA ELECTRONIC TECHNOLOGY CO., LTD.

TOLERANCE UNLESS OTHERWISE STATED:  
 Up to 5 ±0.2  
 Above 5 ~ 15 ±0.3  
 Above 15 ~ 30 ±0.4  
 Above 30 ~ 50 ±0.5  
 Angle ±0.3

3RD. ANGEL'S



UNITS

MM

DRAWN BY:	DATE	MAT'L	TITLE	SWITCH
Jack Lu	12/27/22			
CHECKED BY:	DATE	FINISH	MODLE	TACT SWITCH WITH LED
Jacky Chen	12/27/22			
APPROVED BY:	DATE	SCALE	DWG NO.	SIZE
Tony Kao	12/27/22	1 : 1		A4
		SHEET NO.	PART NO.	VER
		1 of 1		R

ITEM NO.	DESCRIPTION	DRAWN	DATE