

Specifications

Circuit :SPST

Current rating :30mA

Voltage rating :30VDC

Dielectric withstanding voltage :500VAC for 1 minute

Contact resistance :30m Ω Max. (Initial)

Insulation resistance :100M Ω Min

Operating force :300±50gf

Total travel :0.7mm±0.2mm

Operating life :100,000 cycles Min.

Solder specifications :260±5° C for 5 seconds

Operating temperature :-20° C ~ +60° C

Welding method :Manual Soldering (350° C±5° C,3s±0.5s)

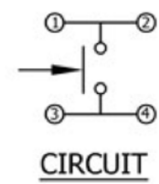
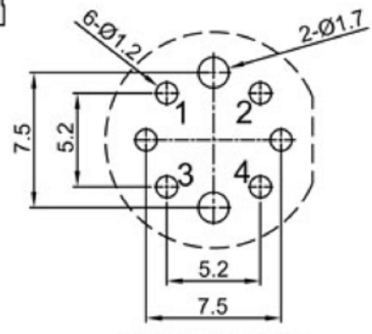
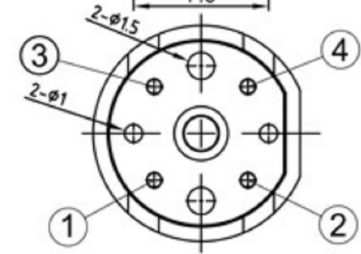
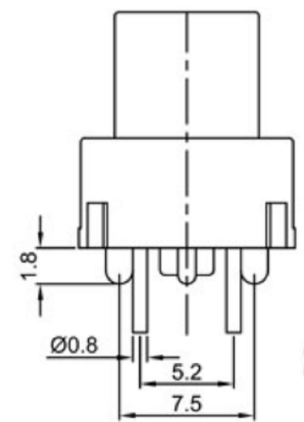
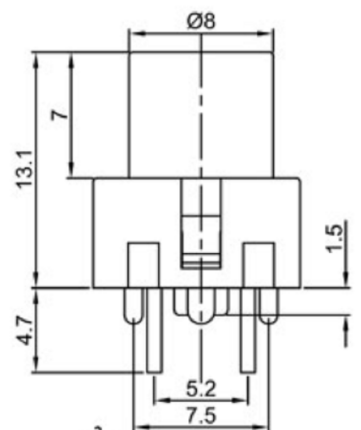

Y	Yellow	黄色
W	White	白色
U	Blue	蓝色
R	Red	红色
O	Orange	橙色
G	Green	绿色
B	Black	黑色
A	Gray	灰色
CAP COLOR (X)		

广东科斯达电子科技有限公司
GUANG DONG KE SI DA ELECTRONIC TECHNOLOGY CO., LTD.

TOLERANCE UNLESS OTHERWISE STATED:

Up to 5	±0.2	3RD. ANGEL'S	UNITS	MM
Above 5 ~ 15	±0.3			
Above 15 ~ 30	±0.4			
Above 30 ~ 50	±0.5			
Angle	±0.3			

DRAWN BY:	DATE	MATL	TITLE	SWITCH
Jack Lu	12/27/22			
CHECKED BY:	DATE	FINISH	MODLE	TACT SWITCH WITH LED
Jacky Chen	12/27/22			
APPROVED BY:	DATE	SCALE	DWG NO.	SIZE
Tony Kao	12/27/22	1 : 1		A4
		SHEET NO.	PART NO.	VER
		1 of 1		R

ITEM NO.	DESCRIPTION	DRAWN	DATE