

Rating: 0.2A 36VDC  
 Contact Resistance: 50mΩ Max.  
 Insulation Resistance: 100MΩ Min.  
 Dielectric Strength: AC 500V 1 minute  
 Total travel: 1.8±0.3mm  
 Operating Force: 200±100gf  
 Mechanical Life: Over 30,000 cycles  
 Electrical Life: Over 10,000 cycles  
 Operating Temperature: -20°C~+85°C  
 Manual Welding: 350°C for 3 Seconds  
 Function: OFF - (ON)

**MATERIAL:**

Base: PA66, UL rated: 94 V-2 Min;  
 Cap: PC ;  
 Terminal: Copper, Golden plated ;

**CIRCUIT**

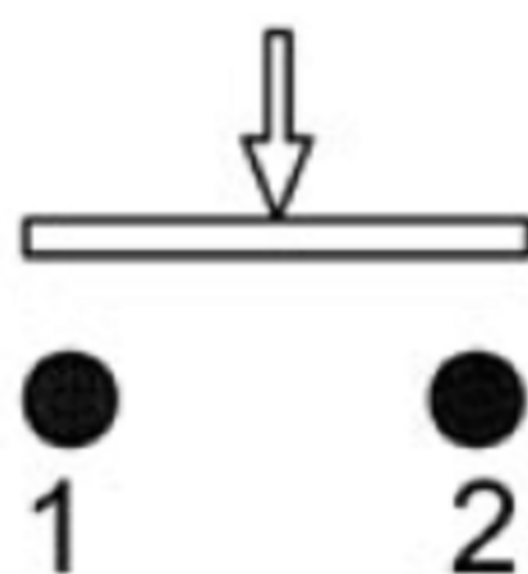

**CUT-OUT**

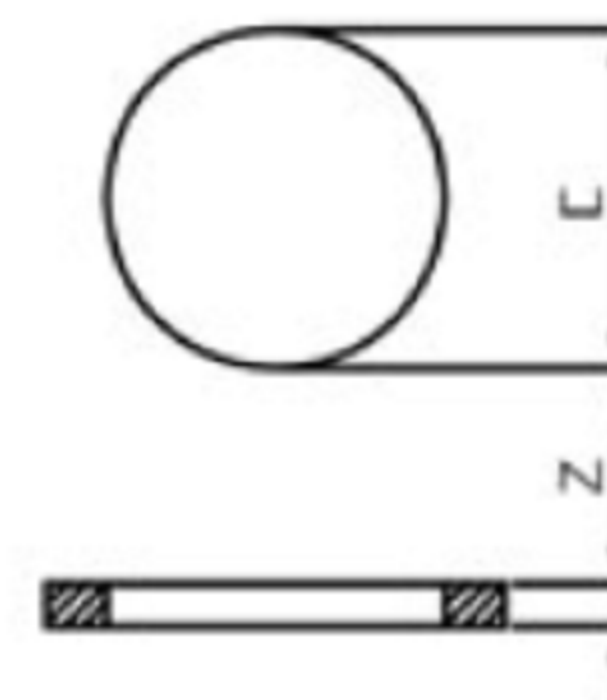

Z	D
0.8~1.0	8.0-8.1
1.0~1.7	8.1~8.25

**广东科斯达电子科技有限公司**  
 GUANG DONG KE SI DA ELECTRONIC TECHNOLOGY CO., LTD.

TOLERANCE UNLESS OTHERWISE STATED: Up to 5 ±0.2, Above 5 ~ 15 ±0.3, Above 15 ~ 30 ±0.4, Above 30 ~ 50 ±0.5, Angle ±0.3  
 3RD. ANGEL'S  
 UNITS MM

DRAWN BY:	DATE	MAT'L	TITLE	SWITCH
Jack Lu	12/27/22		MODLE	TACT SWITCH WITH LED
CHECKED BY:	DATE	FINISH	DWG NO.	SIZE
Jacky Chen	12/27/22		PART NO.	A4
APPROVED BY:	DATE	SCALE	1 : 1	VER
Tony Kao	12/27/22	SHEET NO.	1 of 1	R