

**Rating: 0.2A 36VDC**  
**Contact Resistance: 50m $\Omega$  Max.**  
**Insulation Resistance: 100M $\Omega$  Min.**  
**Dielectric Strength: AC 500V 1 minute**  
**Total travel: 1.8 $\pm$ 0.3mm**  
**Operating Force: 200 $\pm$ 100gf**  
**Mechanical Life: Over 30,000 cycles**  
**Electrical Life: Over 10,000 cycles**  
**Operating Temperature: -20 $^{\circ}$ C~+85 $^{\circ}$ C**  
**Manual Welding: 350 $^{\circ}$ C for 3 Seconds**  
**Function: OFF - (ON)**

**MATERIAL:**  
 Base: PA66, UL rated: 94 V-2 Min;  
 Cap: PC ;  
 Terminal: Copper, Golden plated ;

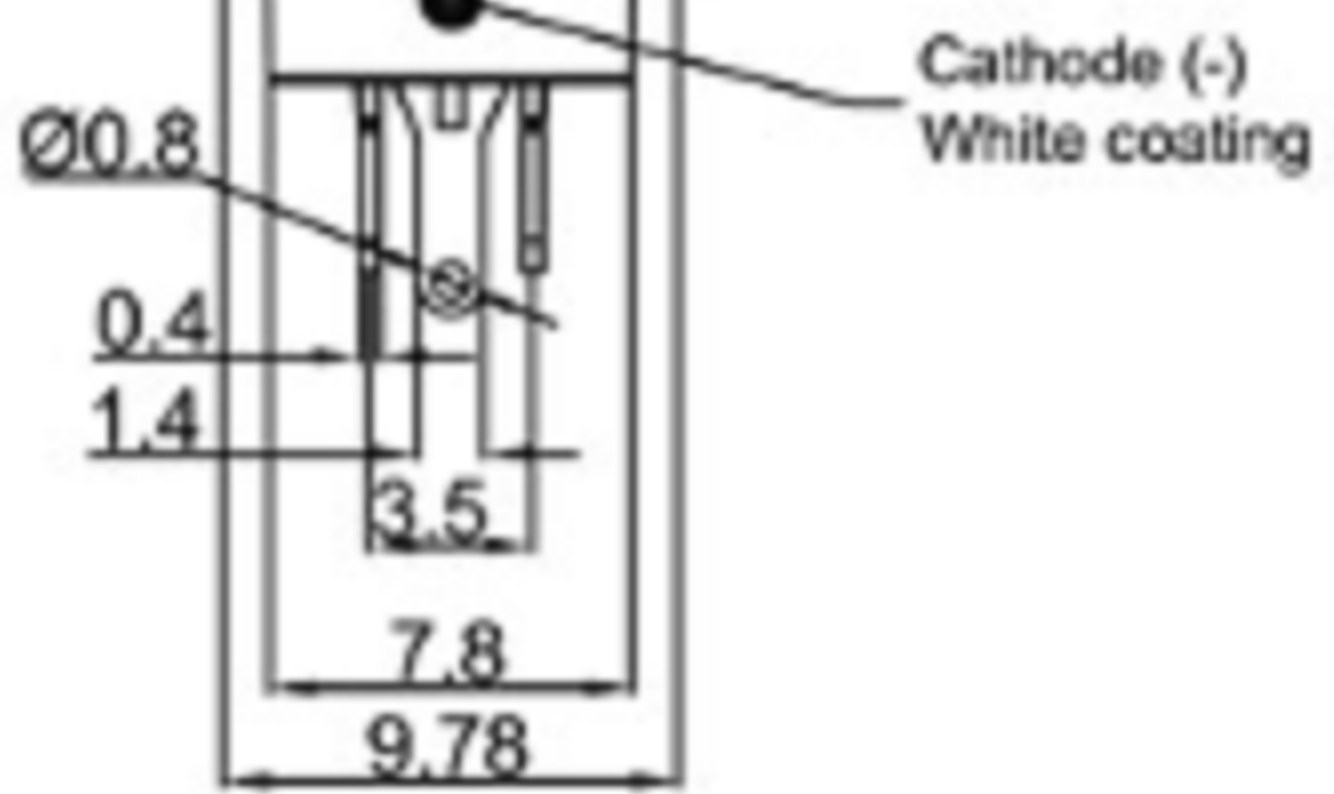

**CIRCUIT**

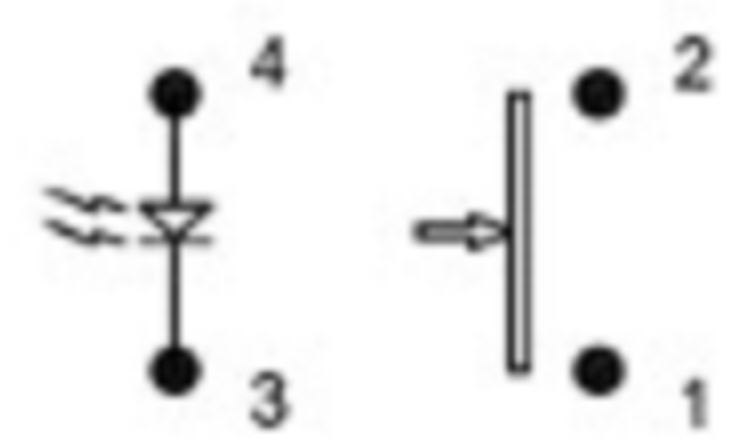

**CUT-OUT**

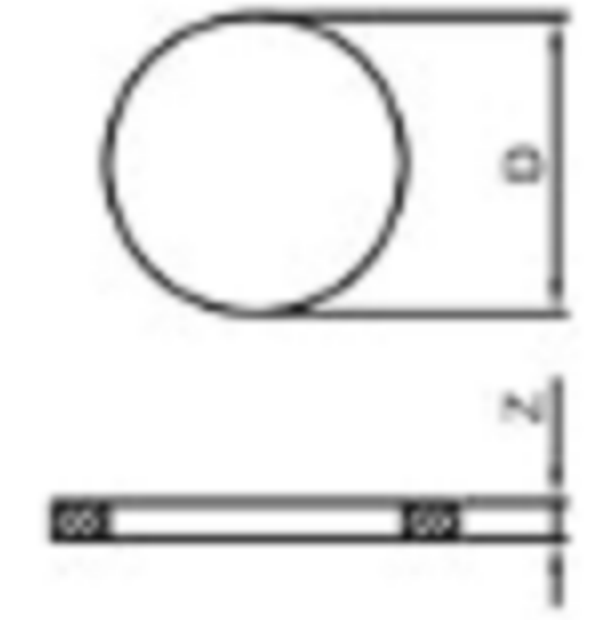

Z	D
0.8~1.0	8.0-8.1
1.0~1.7	8.1~8.25

**广东科斯达电子科技有限公司**  
**GUANG DONG KE SI DA ELECTRONIC TECHNOLOGY CO., LTD.**

TOLERANCE UNLESS OTHERWISE STATED :  
 Up to 5  $\pm 0.2$   
 Above 5 ~ 15  $\pm 0.3$   
 Above 15 ~ 30  $\pm 0.4$   
 Above 30 ~ 50  $\pm 0.5$   
 Angle  $\pm 0.3$

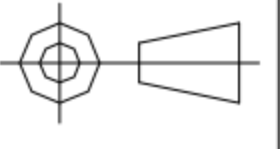
3RD. ANGEL'S  

 UNITS MM

DRAWN BY:	DATE	MAT'L	TITLE	SWITCH
Jack Lu	12/27/22	FINISH	MODLE	TACT SWITCH WITH LED
CHECKED BY:	DATE	SCALE	DWG NO.	SIZE
Jacky Chen	12/27/22	1 : 1	PART NO.	A4
APPROVED BY:	DATE	SHEET NO.		VER
Tony Kao	12/27/22	1 of 1		R

ITEM NO.	DESCRIPTION	DRAWN	DATE