

SPECIFICATIONS

Circuit	:SPST
Current rating	:0.5A
Voltage rating	:250VAC
Dielectric withstanding voltage	:1000VAC for 1 minute
Contact resistance	:50mΩ Max
Insulation resistance	:100MΩ Min
Travel	:2.0mm±0.5mm
Operating Force	:600±200gf
Mechanical Life	:Over 100,000 cycles
Electrical Life	:Over 50,000 cycles
Manual Welding	:350°C for 3 seconds
Function	:OFF-(ON)
Operating temperature	:-20°C ~ +85°C
Level of Protection	: IP65

MATERIAL:

Base: SUS;
 Cap: SUS;
 Terminal: Copper, Golden plated ;
 Nut: Brass, NI Plated .

FUNCTION

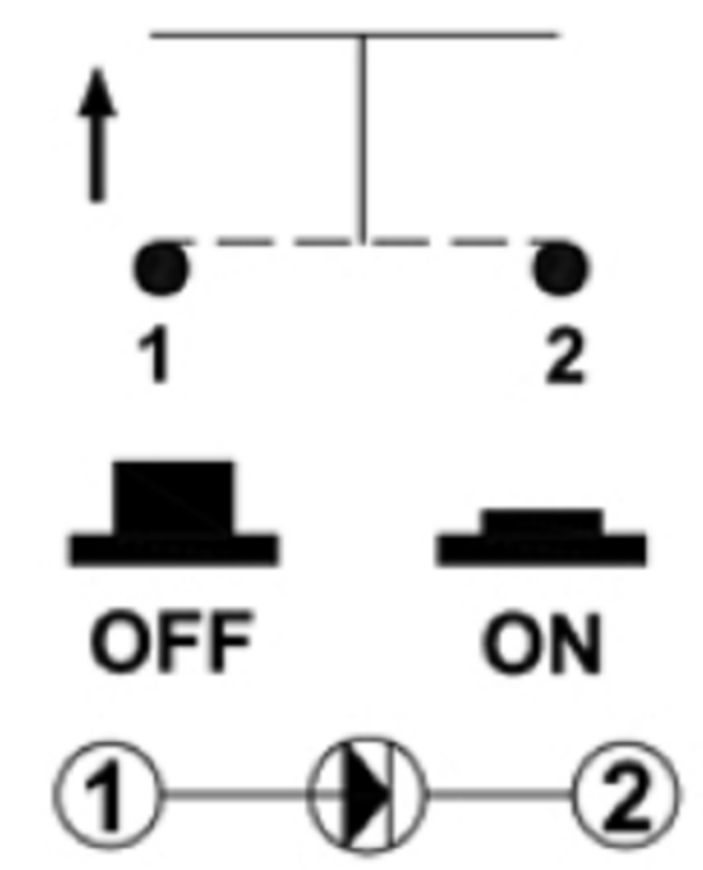

PANEL MOUNTING

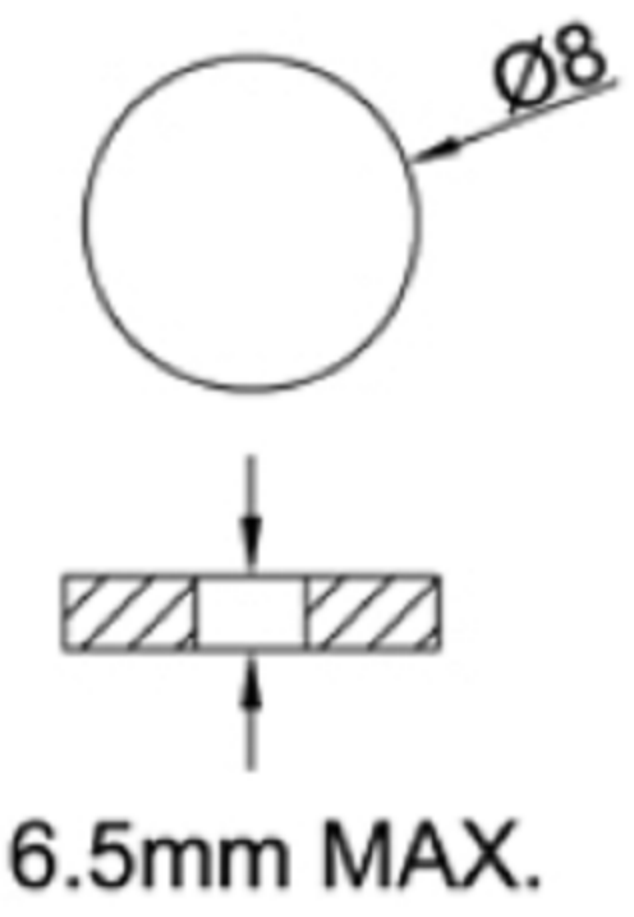

LED SPECIFICATIONS						
U(5V)	Blue 蓝色	5.0	6.0	7.0	25	100
G2(5V)	Bright Green 翠绿色	5.0	6.0	7.0	25	100
R(5V)	Red 红色	5.0	6.0	7.0	25	100
G2	Bright Green 翠绿色	3.0	3.2	3.4	30	80
O	Orange 橙色	1.9	2.2	2.4	20	100
W	White 白色	2.9	3.2	3.5	30	100
U	Blue 蓝色	3.0	3.2	3.4	30	80
Y	Yellow 黄色	1.9	2.2	2.4	20	100
G	Green 黄绿色	1.9	2.2	2.4	20	100
R	Red 红色	1.9	--	2.4	20	60
灯发光颜色(X) Emitted Color (X)		最小 顺向电压(V)	一般	最大	最大操作 电流(mA)	最大脉 冲电流 (mA)

广东科斯达电子科技有限公司
 GUANG DONG KE SI DA ELECTRONIC TECHNOLOGY CO., LTD.

TOLERANCE UNLESS OTHERWISE STATED:
 Up to 5 ±0.2
 Above 5 ~ 15 ±0.3
 Above 15 ~ 30 ±0.4
 Above 30 ~ 50 ±0.5
 Angle ±0.3

3RD. ANGEL'S

UNITS MM

DRAWN BY:	DATE	MAT'L	TITLE	SWITCH
Jack Lu	12/27/22	FINISH	MODLE	TACT SWITCH WITH LED
CHECKED BY:	DATE	SCALE	DWG NO.	SIZE
Jacky Chen	12/27/22	1 : 1	PART NO.	A4
APPROVED BY:	DATE	SHEET NO.		VER
Tony Kao	12/27/22	1 of 1		R

ITEM NO.	DESCRIPTION	DRAWN	DATE