

### Switch Specifications

Rating: 5A 3-250VAC ;  
 Contact Resistance: 50mΩ Max. ;  
 Dielectric Strength: 1000VAC For 1 minute ;  
 Total Travel: 1.2±0.4mm ;  
 Operating Force: 200±50gf ;  
 Load Life: 50,000 cycles ;  
 Operating Temperature: -20°C~70°C ;  
 Function: OFF-ON

| 型号   | MZ016N-F2JZ-E |         |
|------|---------------|---------|
| PIN# | 标注            | 说明      |
| 1    | LED+          | LED输入正极 |
| 2    | LED-          | 蓝色      |
| 3    | SW-           | SW-     |
| 4    | LED-          | 绿色      |
| 5    | LED-          | 红色      |
| 6    | SW+           | SW+     |

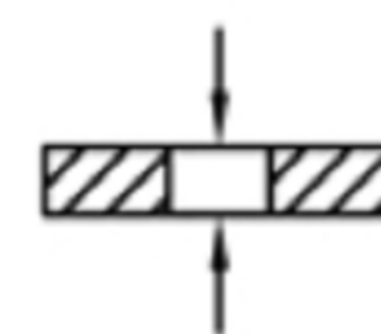
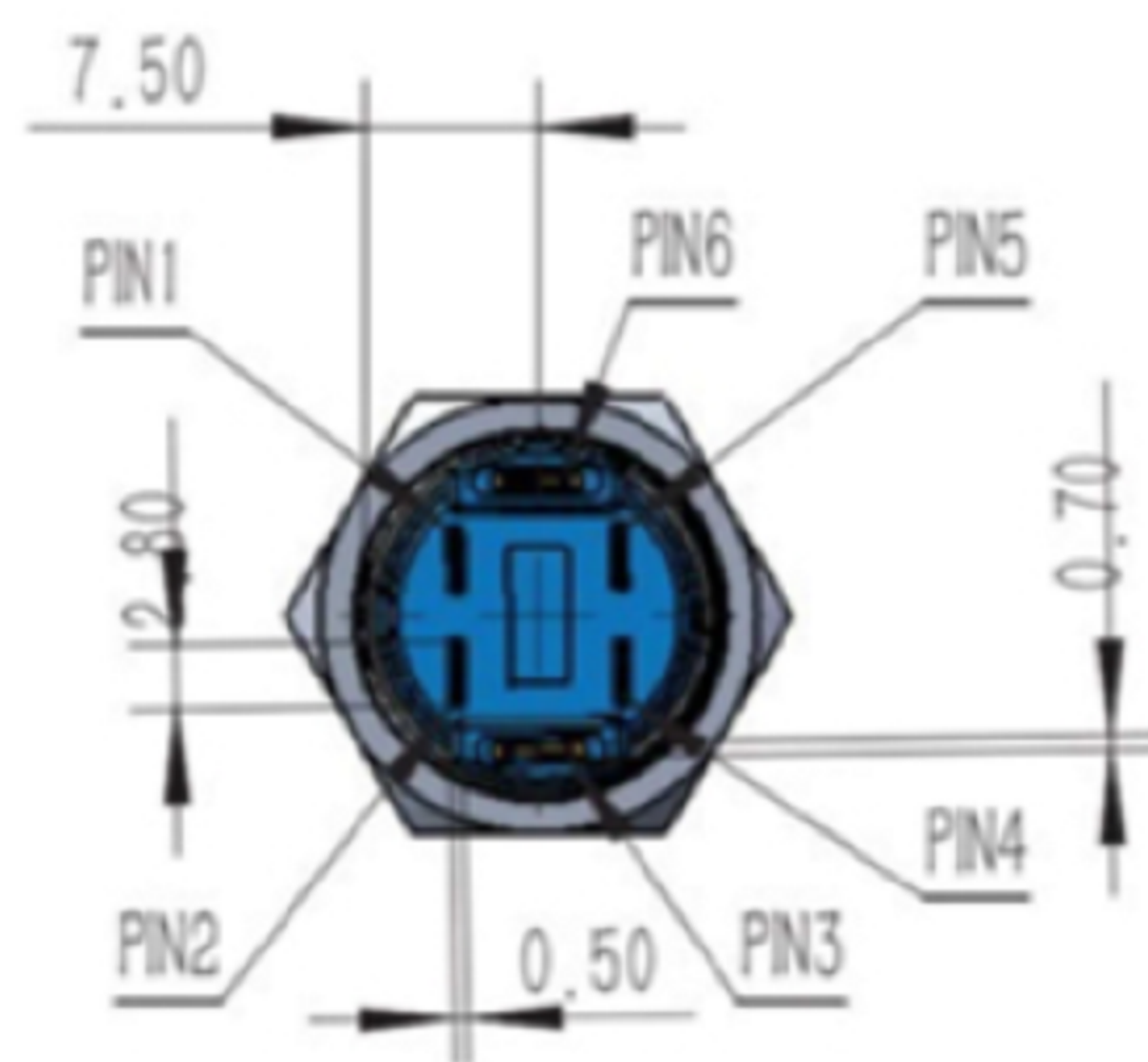

Panel Thickness: 6mm MAX.

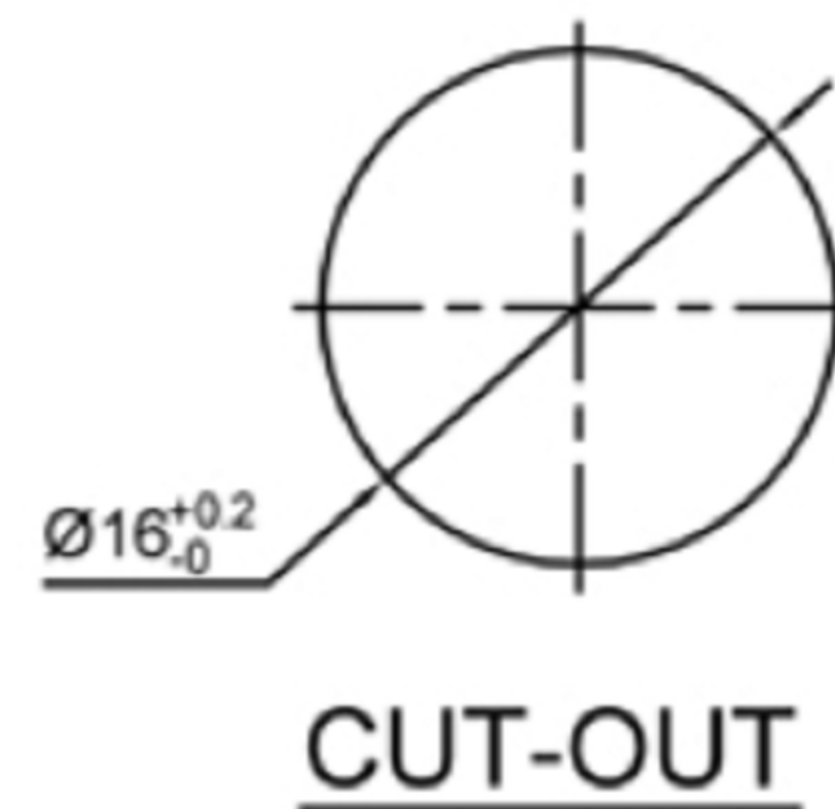
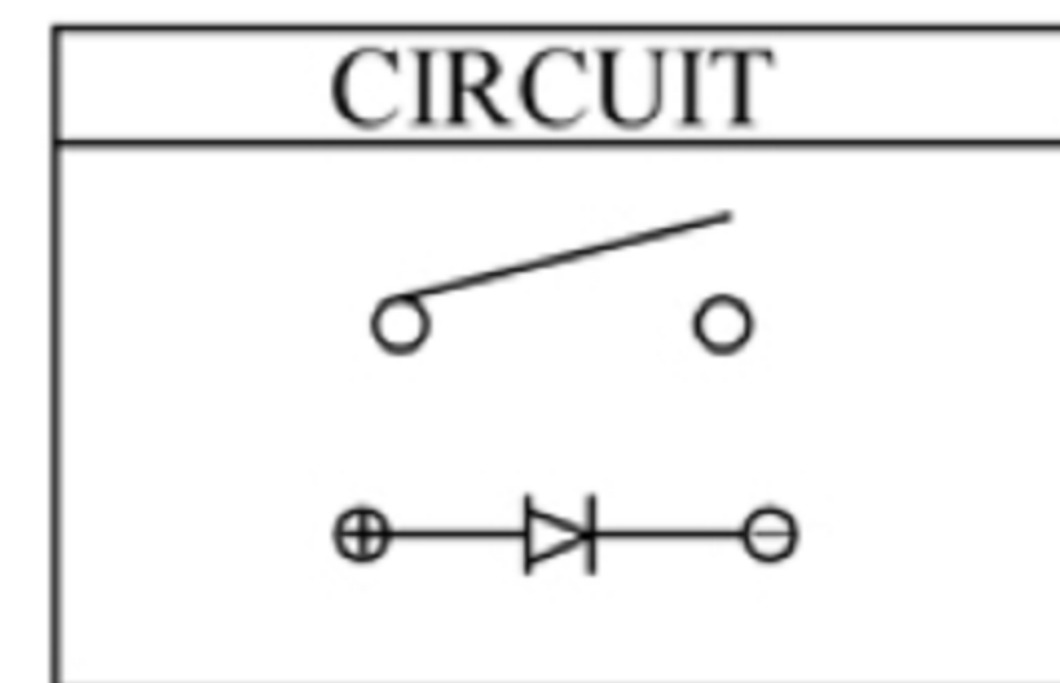

### LED Specifications

| R/U                        | 红色      | 1.8 | 2.0 | 2.4       | 15 |
|----------------------------|---------|-----|-----|-----------|----|
|                            | 蓝色      | 2.8 | 3.0 | 3.6       | 15 |
| 灯发光颜色 X<br>Emitted color X | 最小      | 一般  | 最大  | 额定电流 (mA) |    |
|                            | 顺向电压(V) |     |     |           |    |

### MATERIAL:

Actuator: SUS ;  
 Top Base: SUS;  
 Bottom Base: PBT, UL rated: 94V-0 Min. ;  
 Terminal: Brass, Silver or Gold plated ;  
 Nut: Brass, Ni plated .

**广东科斯达电子科技有限公司**  
 GUANG DONG KE SI DA ELECTRONIC TECHNOLOGY CO., LTD.

TOLERANCE UNLESS OTHERWISE STATED: Up to 5 ±0.2, Above 5 ~ 15 ±0.3, Above 15 ~ 30 ±0.4, Above 30 ~ 50 ±0.5, Angle ±0.3  
 3RD. ANGEL'S  
 UNITS MM

|              |          |           |          |                      |
|--------------|----------|-----------|----------|----------------------|
| DRAWN BY:    | DATE     | MAT'L     | TITLE    | SWITCH               |
| Jack Lu      | 12/27/22 |           |          |                      |
| CHECKED BY:  | DATE     | FINISH    | MODLE    | TACT SWITCH WITH LED |
| Jacky Chen   | 12/27/22 |           |          |                      |
| APPROVED BY: | DATE     | SCALE     | DWG NO.  | SIZE                 |
| Tony Kao     | 12/27/22 | 1:1       |          | A4                   |
|              |          | SHEET NO. | PART NO. | VER                  |
|              |          | 1 of 1    |          | R                    |