

RoHS Compliant

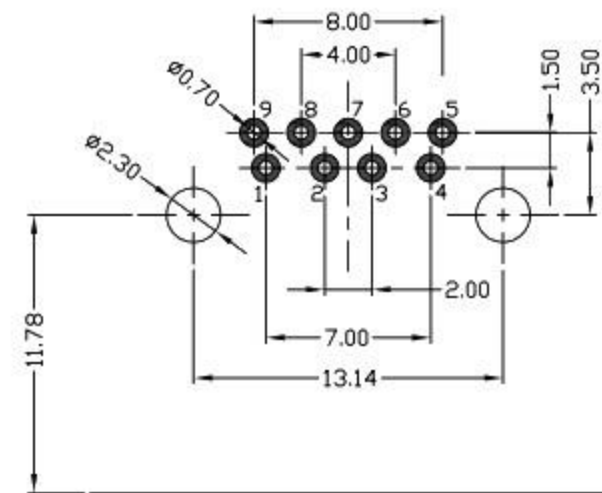
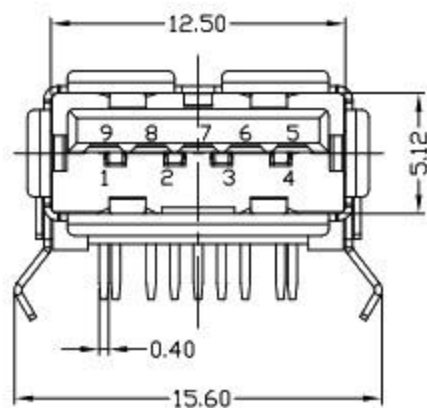
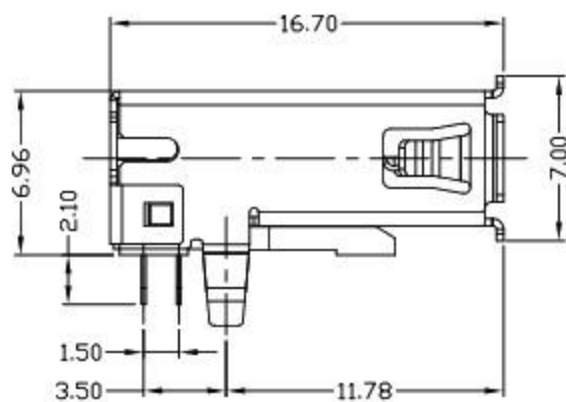
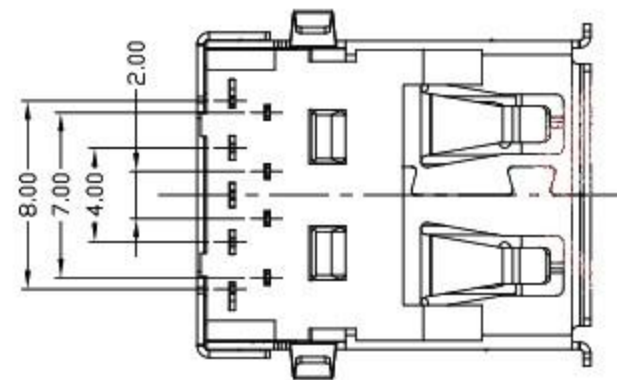
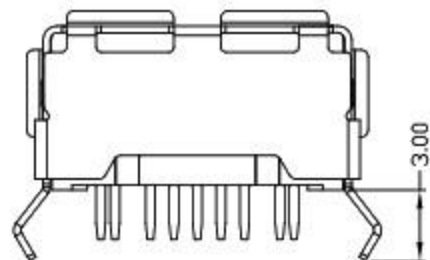
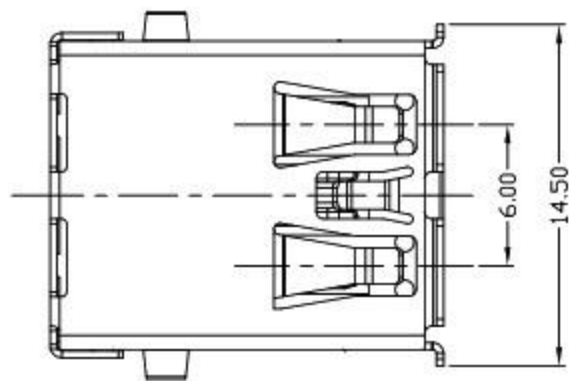

RECOMMENDED PCB LAYOUT

| PIN NUMBER | SIGNAL NAME |
|------------|-------------|
| 1 | VBUS |
| 2 | D- |
| 3 | D+ |
| 4 | GND |
| 5 | STDA_SSRX- |
| 6 | STDA_SSRX+ |
| 7 | GND_DRAIN |
| 8 | STDA_SSTX- |
| 9 | STDA_SSTX+ |
| Shell | Shield |

NOTES:

- ELECTRICAL:
 - CURRENT RATING: 1.5AMP;
 - INSULATION RESISTANCE: 100MΩ MIN;
 - CONTACT RESISTANCE: 30mΩ MAX;
 - WITHSTANDING VOLTAGE: 100V AC;
 - OPERATING TEMPERATURE: -40°C ~ +85°C.
- Mechanical:
 - Mating Force: 35N MAX
 - Unmating Force: 10N MIN.
- DIMENSIONS MARKED "▼" TO BE CHECKED BY Q.C & IPQC.

4. PART NO.

1Au 1U*
5Au 15U*
6Au 30U*

1PBT
2PA6T
3PA9T
4LCP

| NO. | PART NAME | QTY | MATERIAL | DESCRIPTION | REMARK |
|-----|------------|-----|-----------------|---------------|----------|
| ⑤ | MID PLATE | 1 | STAINLESS STEEL | Au . PLATING. | T=0.15mm |
| ④ | SHELL | 1 | STAINLESS STEEL | Au . PLATING. | T=0.30mm |
| ③ | TERMINAL-B | 1 | TABLE 2: | TABLE 2: | T=0.12mm |
| ② | TERMINAL-A | 1 | TABLE 2: | TABLE 2: | T=0.12mm |
| ① | INSULATOR | 1 | HIGH TEMP | Black | |

UNLESS OTHERWISE,
GENERAL TOLERANCE:
X.xxx ±0.10
X.xx ±0.20
X.x ±0.30
X. ±0.38
ANGULAR:
X.xx ±1°
X.x ±3°
X. ±5°

廣東科斯達電子科技有限公司

| | |
|-------------------------|-------------------------------|
| TITLE: USB connector | P/N: Detail See PART NO. LIST |
| MODEL: | DRAW NO.: |
| THIRD ANGLE PROJECTION | UNIT: mm |
| SCALE: 1:1 | SIZE: A4 |
| SHEET: 1/1 | |

| JH2016-080 | X2 | 隨工程图上升版本次 | 2016.06.15 | 陈少兵 | DESIGN | 陈少兵 | 2016.06.15 |
|-------------|------|-------------|------------|--------|----------|-----|------------|
| JH2016-071 | X1 | 新增规格 | 2016.06.10 | 陈少兵 | CHECK | 郑小伟 | 2016.06.15 |
| 20151224001 | X | NEW DRAWING | 2016.05.05 | 陈少兵 | APPROVAL | 吕海涛 | 2016.06.15 |
| ECN NO. | REV. | DESCRIPTION | DATE | CHANGE | APPROVAL | 吕海涛 | 2016.06.15 |