

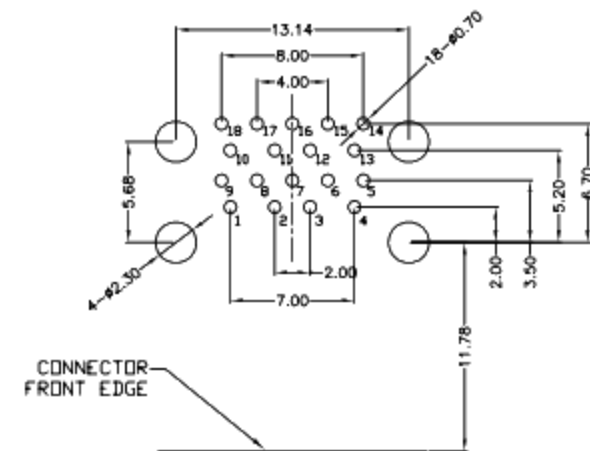

RoHS
Compliant
2002/95/EC

REV.	ECN.	NO.	APPD.

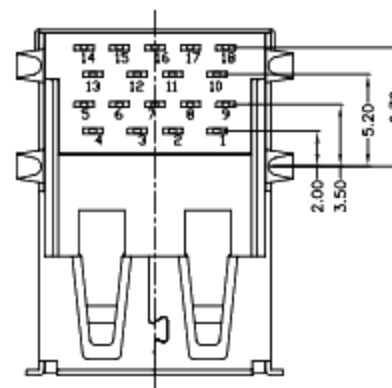
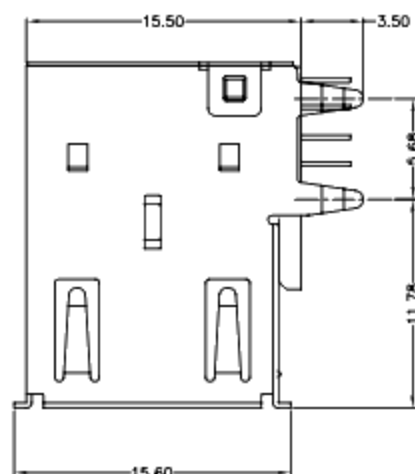
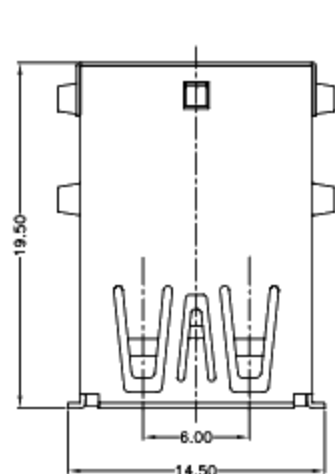

RECOMMENDED PCB LAYOUT

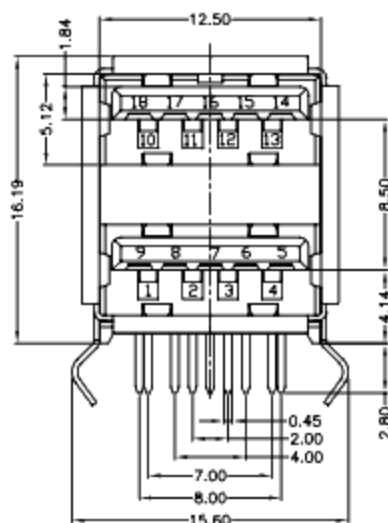

Pin Number	Signal Name	Pin Number	Signal Name
1/10	VBUS	5/14	SSRX-
2/11	D-	6/15	SSRX+
3/12	D+	7/16	GND
4/13	GND	8/17	SSTX-
Shell	Shield	9/18	SSRT+

NOTES:

- ELECTRICAL:
 - VOLTAGE CURRENT RATING: 1.8AMP, 30V AC;
 - INSULATION RESISTANCE: 100MΩ MIN;
 - CONTACT RESISTANCE: 30mΩ MAX;
 - WITHSTANDING VOLTAGE: 500V AC;
 - OPERATING TEMPERATURE: -55°C TO +85°C.
- Mechanical:
 - Mating Force: 35N MAX
 - Unmating Force: 10N MIN.
- NOTE: 1. DIMENSIONS MARKED "▼" TO BE CHECKED BY Q.C & IPQC.

4.PART NO.

1Au 1U*
5Au 15u*
6Au 30U*

W: WHITE
B: BLACK
BL: BLUE
1: PBT
2: PA6T
3: PA9T
4: LCP
5: PA46

Bill of materials:

NO	PARTS	MATERIAL	QTY	FINISHING	UNITS	mm
6	BACK CDK	PBT+30%GF	1	UL94V-0	X. ±0.35	X.* ±2'
5	CLIP	STAINLESS STEEL	1	PLATED NICKEL	.X ±0.3	.X* ±1'
4	BACK COVER	STAINLESS STEEL	1	PLATED NICKEL	.XX ±0.25	.XX*
3	HOUSING	PBT+30%GF	1	UL94V-0	.XXX ±0.15	.XXX*
2	SHELL	COPPER ALLOY	1	PLATED NICKEL	THESE DRAWINGS AND SPECIFICATIONS ARE THE PROPERTY OF ACCURATE INNOTECH INC AND SHALL NOT BE REPRODUCED, COPIED OR USED IN ANY MANNER WITHOUT THE PRIOR WRITTEN CONSENT OF ACCURATE INNOTECH INC	
1	TERMINAL	COPPER ALLOY	18	PLATED GOLD/TIN		
QTY						

UNITS	mm
MAT'L	SEE NOTE
FINISH	SEE NOTE
Q'TY	

廣東科斯達電子科技有限公司

TITLE:	PART NO.:
USB AF3.0 90° 板層插板式 (2.8)	
DR: gan 2014/07/08	DWG NO.:
CHKD: gan 2014/07/08	
APPD:	SCALE SHEET REV. CUSTOMER DRAWING
	1:1 1/1 B