

ELECTRICAL
 RATING:DC12V 3A;
 CONTACT RESISTANCE:30mΩ MAX(IN1
 100mΩ MAX(FIP)
 INSULATION RESISTANCE: 100 MΩ MIN.
 DIELECTRIC WITHSTAND VOLTAGE: 500V
 DURABILITY TEST: 5,000 CYC
 TEMPERATRUE RANGE: -25°C TO +75°C
 MATERIALS & PLATING: SEE THE TABLE
 PACKAGING: TAPE&REEL

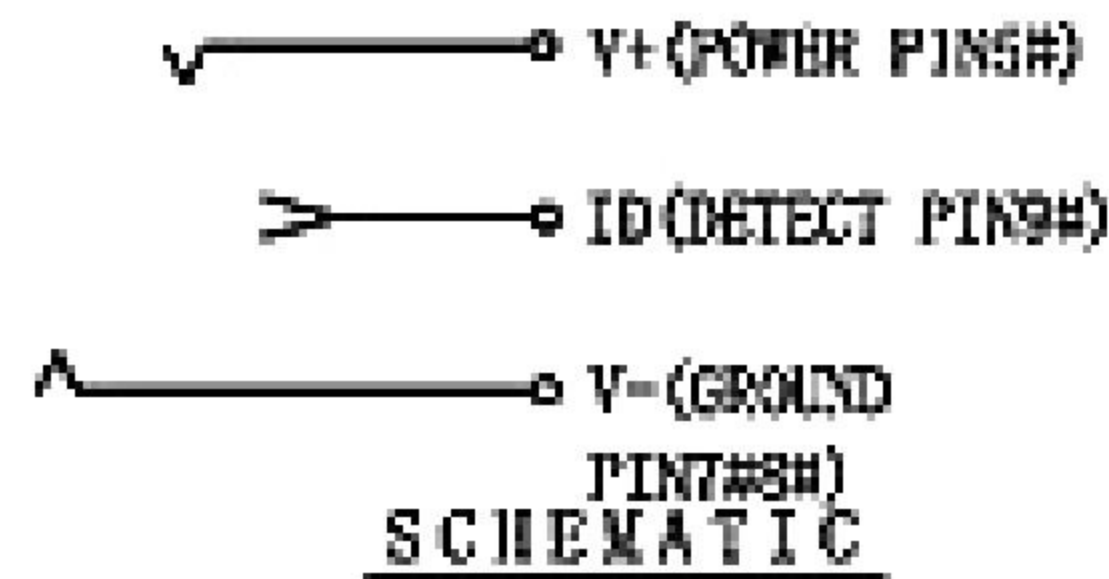
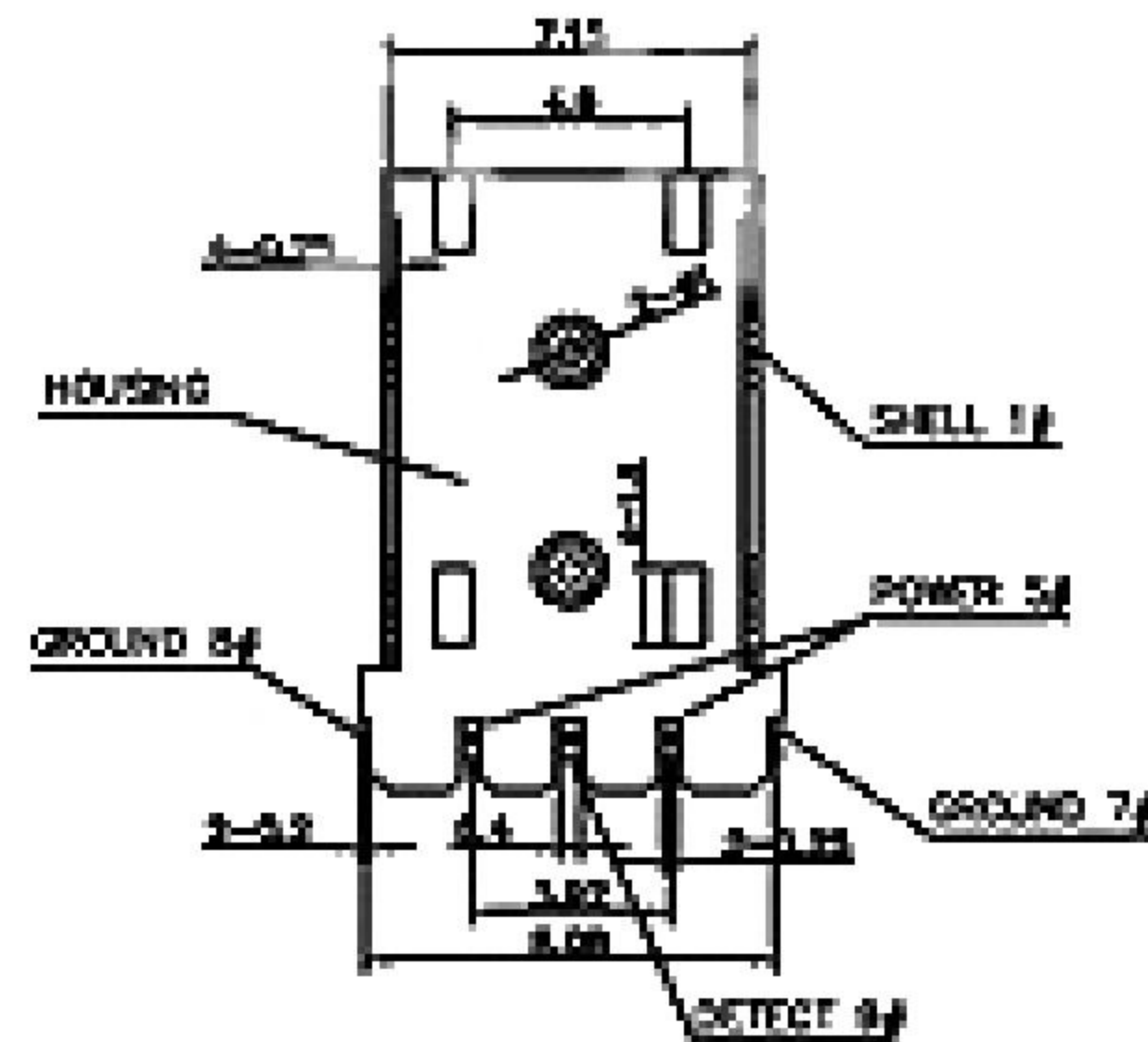
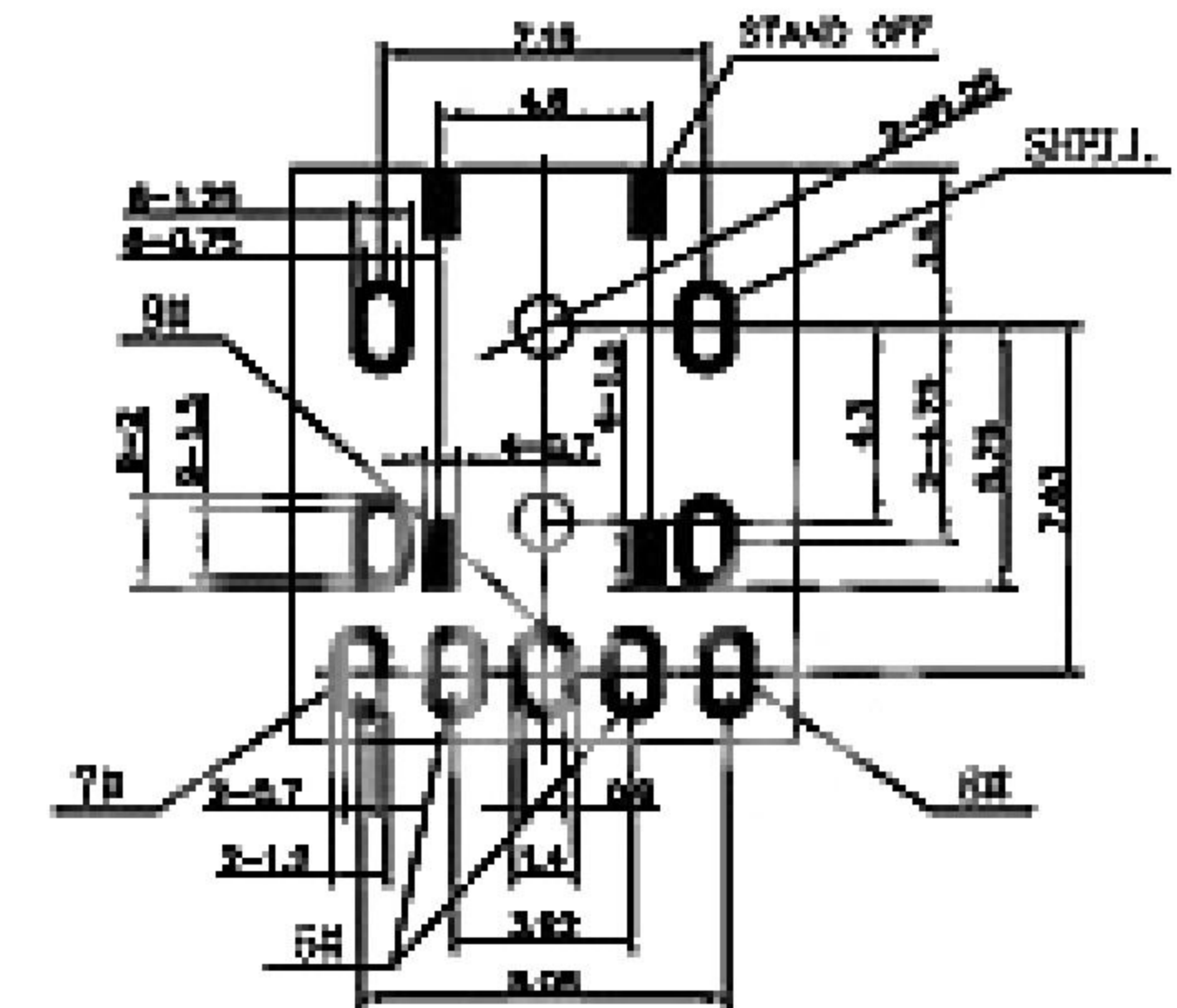
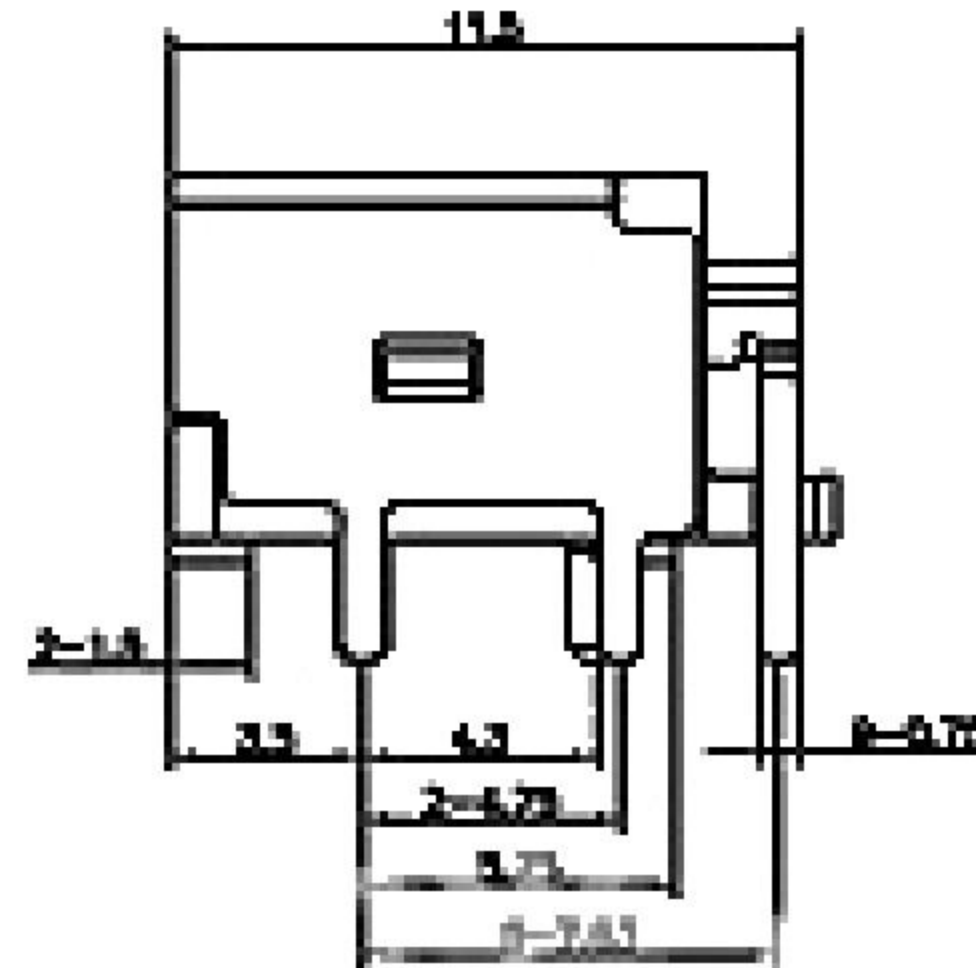
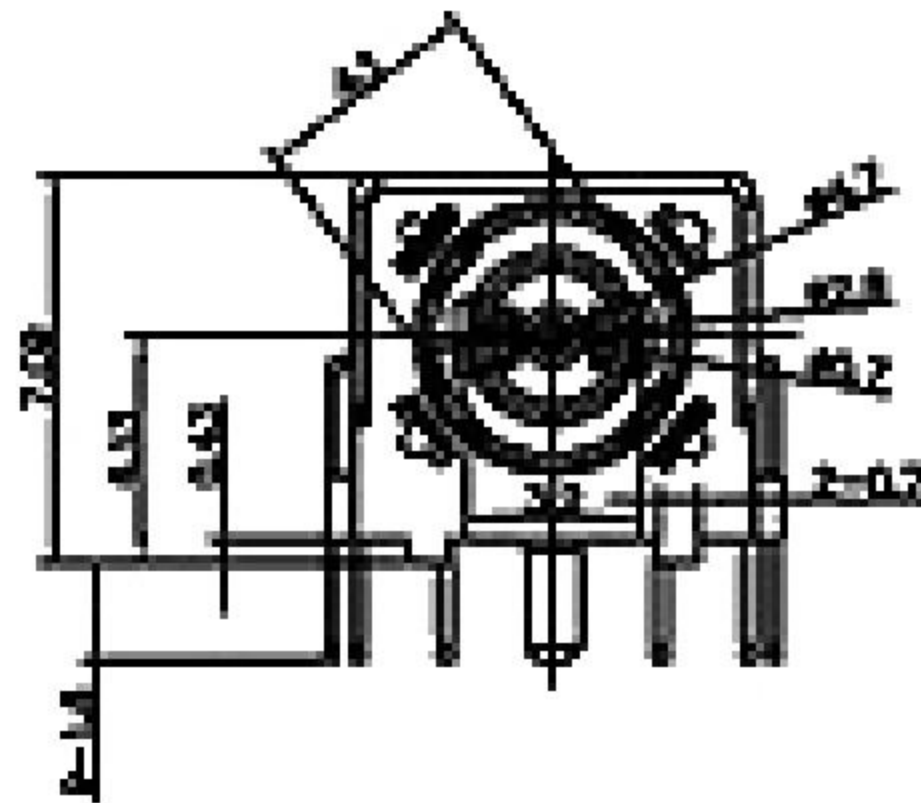

PCB LAYOUT
 TOP VIEW (Tolerance:±0.05)

MARK	DESCRIPTION	DATE	REVISED	APPROVED	UNSPECIFIED TOLERANCES
ΔX					ANGLAR ±5°
ΔX					X.X ±0.2mm
ΔX					X.XX ±0.1mm
MARK					X.XXX ±0.05mm
REVISIONS					

DSND	DATE	SCALE: N/A	MODEL TYPE: DC POWER JACK
DWN	DATE	VIEW:	PART NO.:
CHKD	DATE	UNIT: mm	DWG NO.:
APPD	DATE	SIZE: A4	
廣東科斯達電子科技有限公司			WEIGHT 1.0g
			SHEET 1/1
			REVISION A0