

ITEM	PART NAME	MATERIAL	QTY	FINISHING
10	COM TERMINAL	H65(C2680)	1	Ag PLATED
09	RIVET	Al	1	
08	NO TERMINAL	C1100	1	Ag PLATED
07	NC TERMINAL	C1100	1	Ag PLATED
06	MOVABLE CONTACT	SILVER ALLOY	1	
05	CONTACT PLATE	C5210	1	Ag PLATED
04	SPRING	SUS304	1	
03	HOUSING	PA	1	BLACK
02	KONB	POM	1	BLACK
01	COVER	PA	1	BLACK

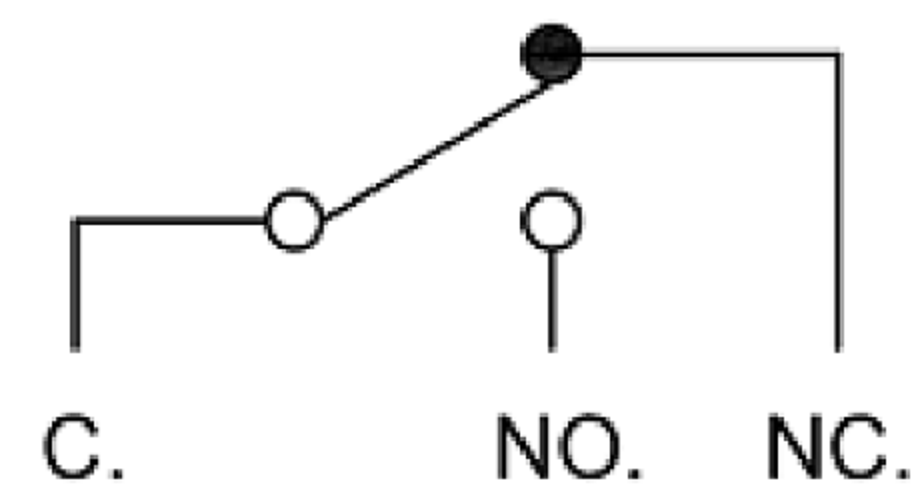

CIRCUIT DIAGRAM

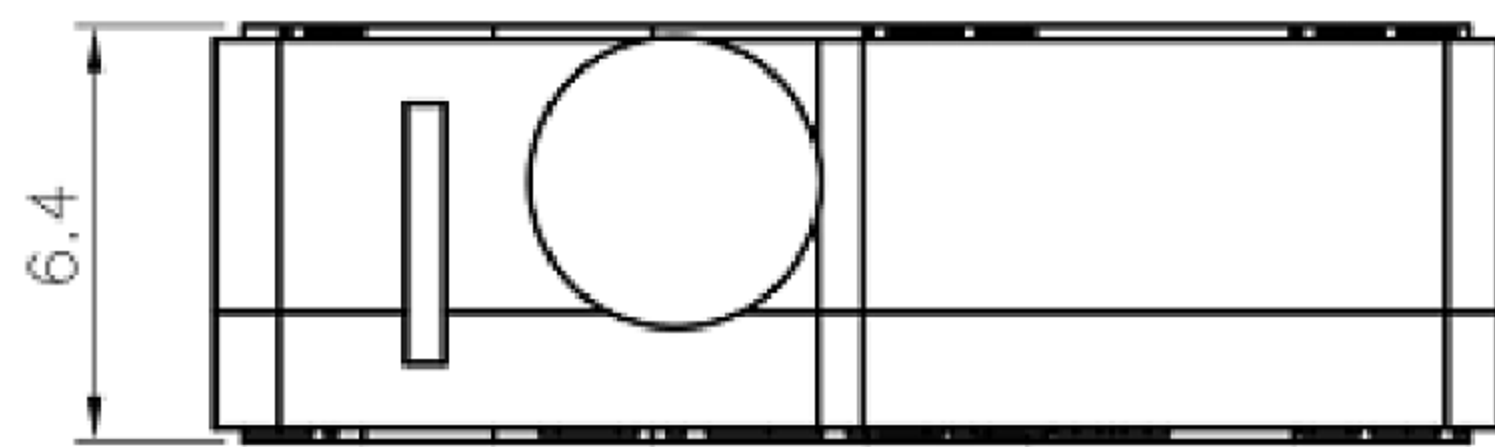
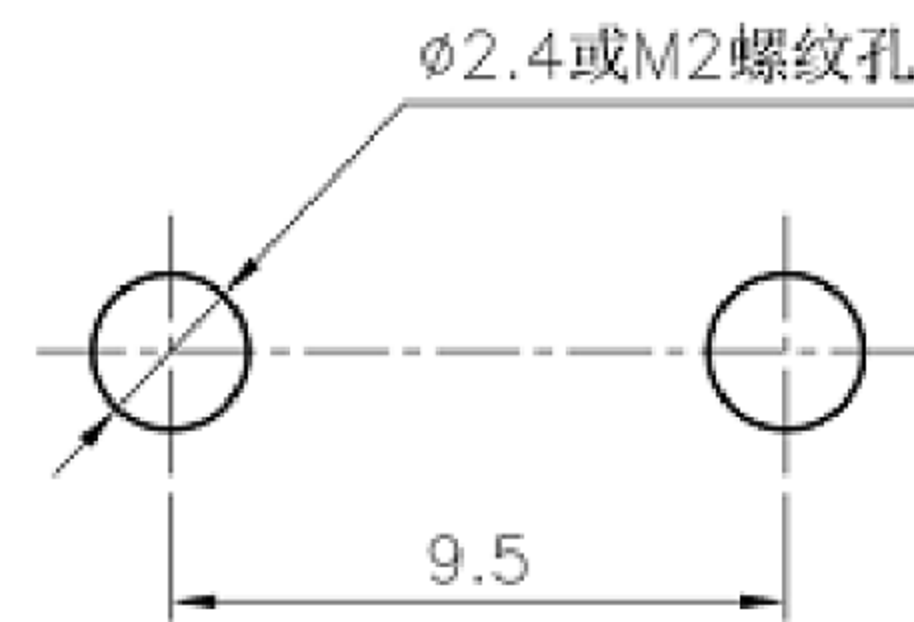

P.C.B LAYOUT MOUNTING

**Note:**

**Electrical Characteristics:**

Rating : 5A 125VAC , 3A 250VAC

Contact Resistance : 50mΩ max. (Initial)

Insulation Resistance : 100MΩ min. (at 500 VDC)

Dielectric Strength : AC 1500V (50/60Hz for 1 minute).

Electrically Life : 100,000 cycles min.

**Mechanical Characteristics:**

Operating Force (OF) : 250±100gf .

Pre-travel (PT) : 0.9 mm max.

Operating Position (OP) : 10.1±0.8 mm

Operating temperature : -25°C ~ 85°C.



广东科斯达电子科技有限公司  
GUANG DONG KE SI DA ELECTRONIC TECHNOLOGY CO., LTD.

TOLERANCE UNLESS OTHERWISE STATED :  
Up to 5 ±0.2  
Above 5 ~ 15 ±0.3  
Above 15 ~ 30 ±0.4  
Above 30 ~ 50 ±0.5  
Angle ±0.3°

3RD. ANGEL'S

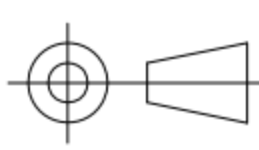

UNITS

MM

DRAWN BY: Jack Lu  
DATE: 12/10/15  
CHECKED BY: Jacky Chen  
DATE: 12/10/15  
APPROVED BY: Tony Kao  
DATE: 12/10/15

MAT'L	TITLE	SWITCH
FINISH	MODLE	MICRO SWITCH
SCALE	DWG NO.	
SHEET NO.	PART NO.	

ITEM NO.	DESCRIPTION	DRAWN	DATE
1	更新Electrical Life	Jack	121015

SIZE  
A4  
VER  
R1