

ACTUATOR IN POS. 1

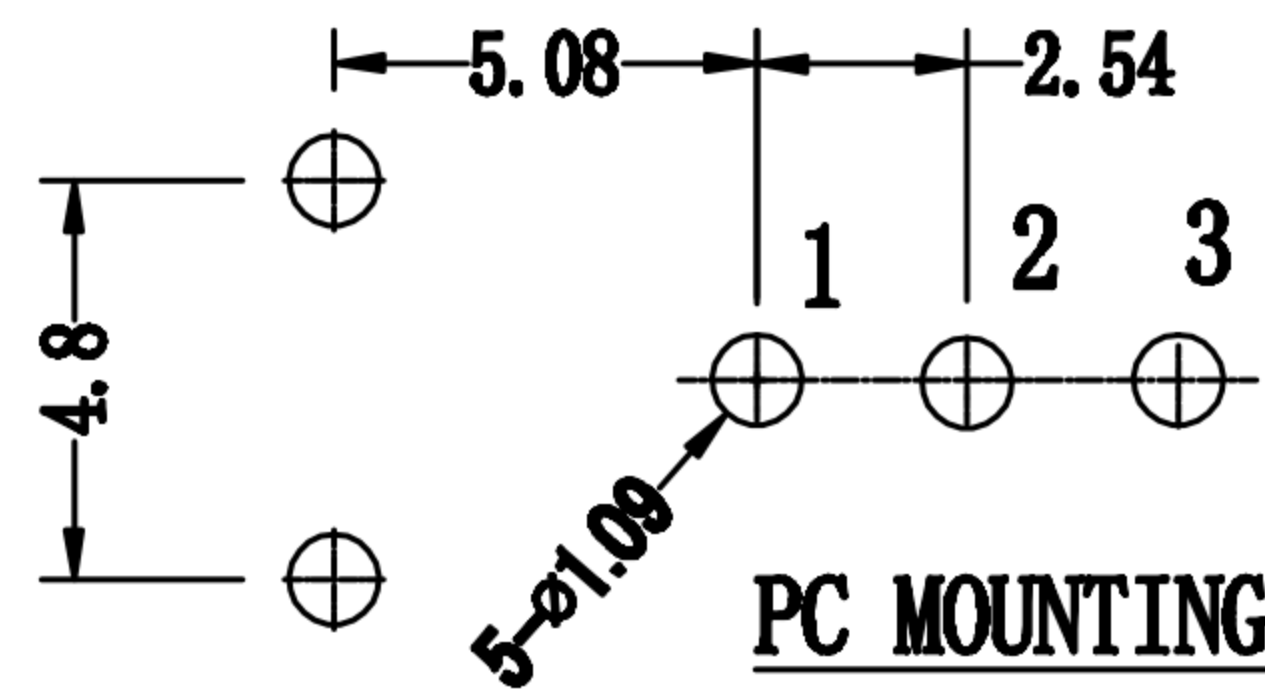

PC MOUNTING

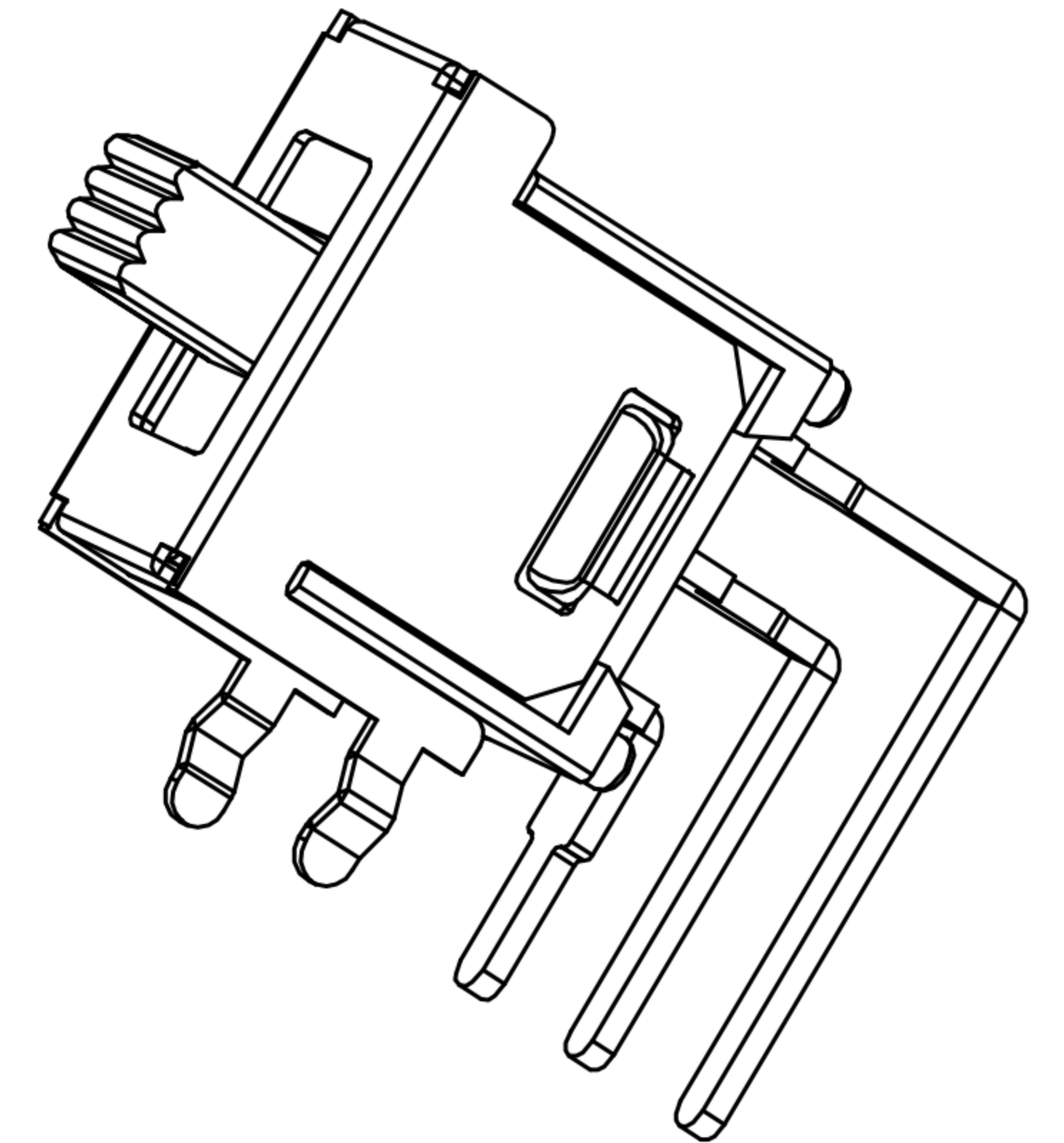
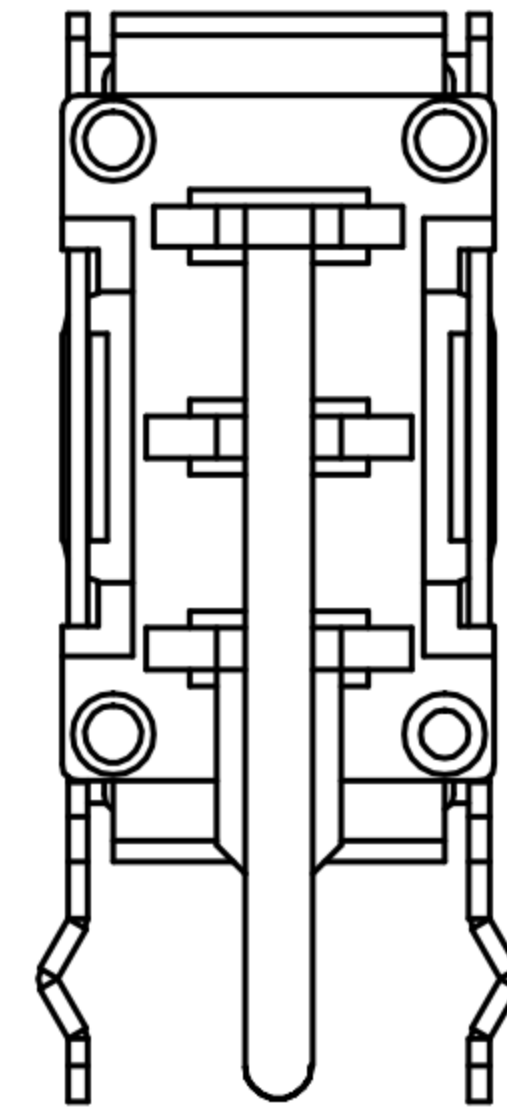
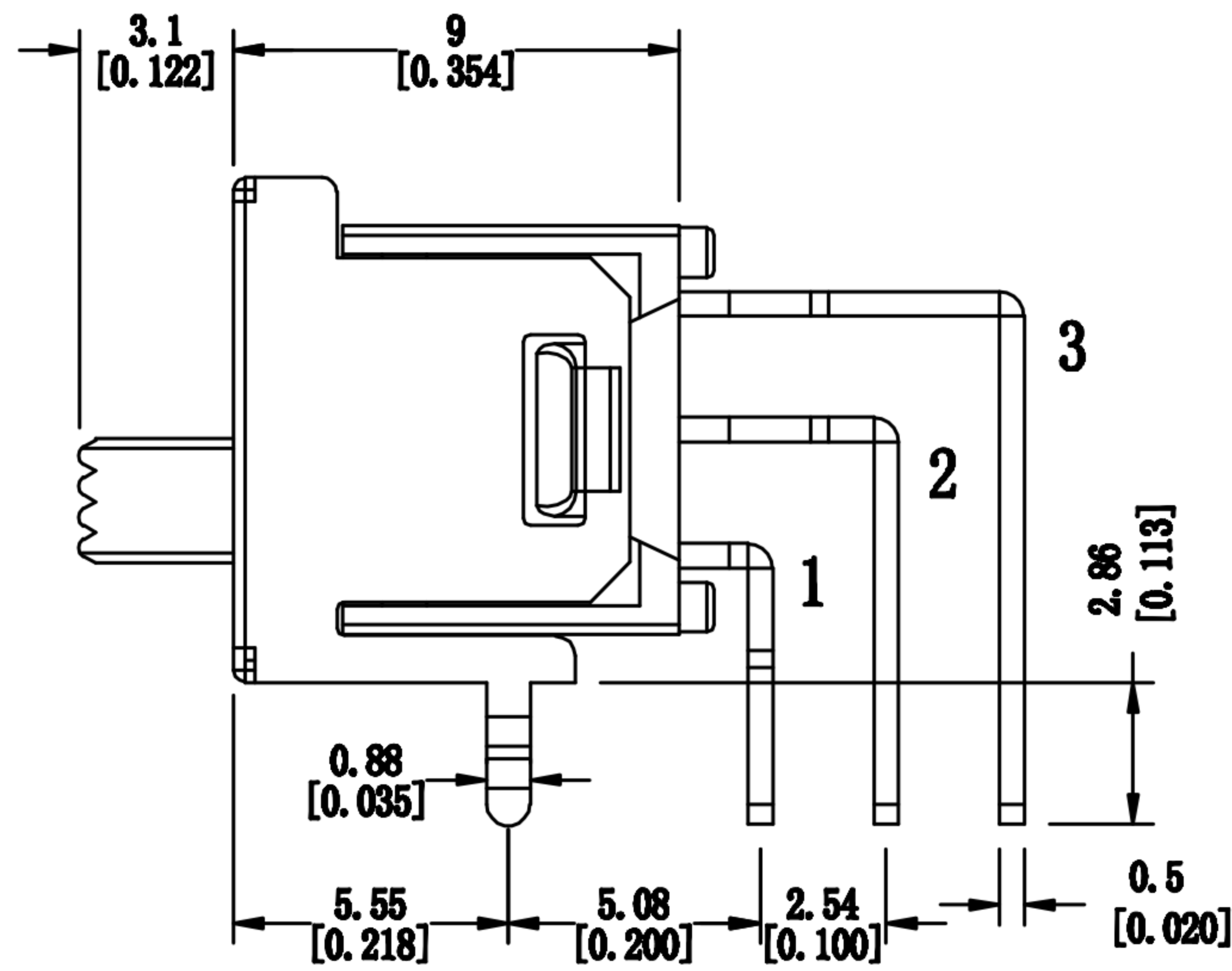
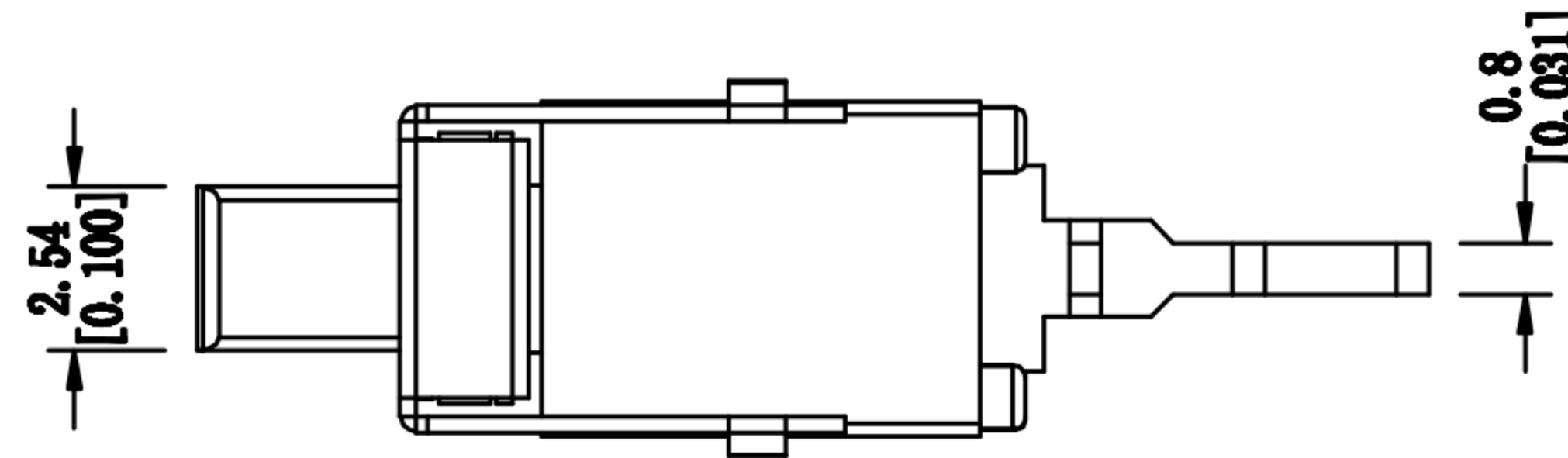

Specifications

CONTACT RATING: 0.4 VA max. @ 20 V AC or DC max.
 MECHANICAL & ELECTRICAL LIFE: 30,000 make-and-break cycles at full load.
 CONTACT RESISTANCE: 20 m Ω max. initial @ 2-4 V DC, 100 mA.
 INSULATION RESISTANCE: 1000 MΩ min.
 DIELECTRIC STRENGTH: 500 Vrms min.
 OPERATING TEMPERATURE: -30°C to 85°C.

Model NO.	SWITCH FUNCTION		
	POS. 1	POS. 2	POS. 3
SS1-102	ON	NONE	ON
CONN. TERMINALS	2-1	N/A	2-3
SCHEMATIC SPDT			

Materials

BASE: PPA (UL 94V-0).
 HOUSING: Stainless steel with tin plate.
 CONTACT/TERMINALS: Copper alloy silver plated.
 TERMINAL SEAL: Epoxy.



TOLERANCE UNLESS OTHERWISE STATED: Up to 5 ±0.2, Above 5 ~ 15 ±0.3, Above 15 ~ 30 ±0.4, Above 30 ~ 50 ±0.5, Angle ±0.3°

3RD. ANGEL'S

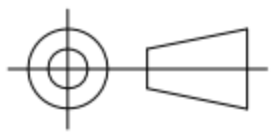

UNITS MM

DRAWN BY:	DATE	MAT'L	TITLE	SWITCH
Jack Lu	04/13/16			
CHECKED BY:	DATE	FINISH	MODLE	SLIDE SWITCH
Jacky Chen	04/13/16			
APPROVED BY:	DATE	SCALE	DWG NO.	SIZE
Tony Kao	04/13/16	1 : 1		A4
		SHEET NO.	PART NO.	VER
		1 of 1		R2