

Specifications

1. Current Rating : 2.0A AC,DC
2. Voltage rating : 250V AC,DC
3. Temperature range : $-25^{\circ}\text{C} \sim +85^{\circ}\text{C}$
4. Contact resistance : $10\text{m}\Omega$ Max
5. Insulation resistance : $1000\text{M}\Omega$ Min
6. Withstanding voltage : 800 V AC/minute

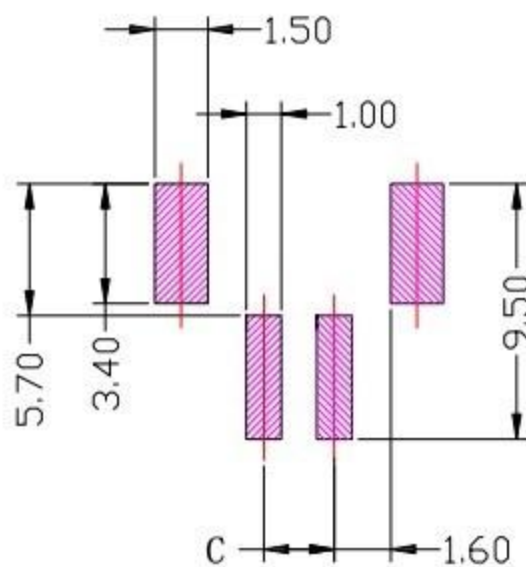
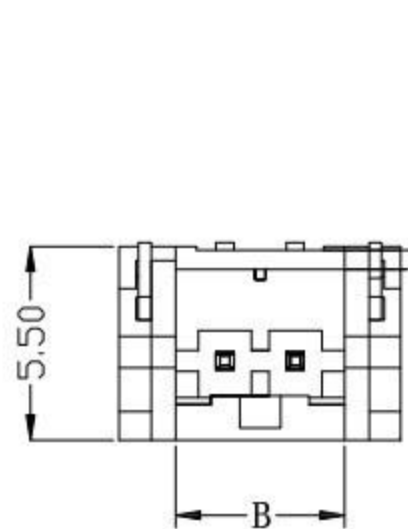

P.C.B Hole Layout

	A	B	C
2P	8.0	4.8	2.0
3P	10.0	6.8	4.0
4P	12.0	8.8	6.0
5P	14.0	10.8	8.0
6P	16.0	12.8	10.0
7P	18.0	14.8	12.0
8P	20.0	16.8	14.0
9P	22.0	18.8	16.0
10P	24.0	20.8	18.0
11P	26.0	22.8	20.0
12P	28.0	24.8	22.0
13P	30.0	26.8	24.0
14P	32.0	28.8	26.0
15P	34.0	30.8	28.0
16P	36.0	32.8	30.0

廣東科斯達電子科技有限公司

TOLERANCE UNLESS OTHERWISE STATED :

Up to 5 ± 0.2
 Above 5 ~ 15 ± 0.3
 Above 15 ~ 30 ± 0.4
 Above 30 ~ 50 ± 0.5
 Angle $\pm 0.3^{\circ}$

3RD. ANGEL'S



UNITS MM

DRAWN BY:	DATE	MAT'L	TITLE	CONNECTOR
Jack Lu	11/20/15	FINISH	MODLE	WAFER 2.0 SMT 90度
CHECKED BY:	DATE	SCALE	DWG NO.	SIZE
Jacky Chen	11/20/15	1 : 1		A4
APPROVED BY:	DATE	SHEET NO.	PART NO.	VER
Tony Kao	11/20/15	1 of 1		R