

安装孔尺寸

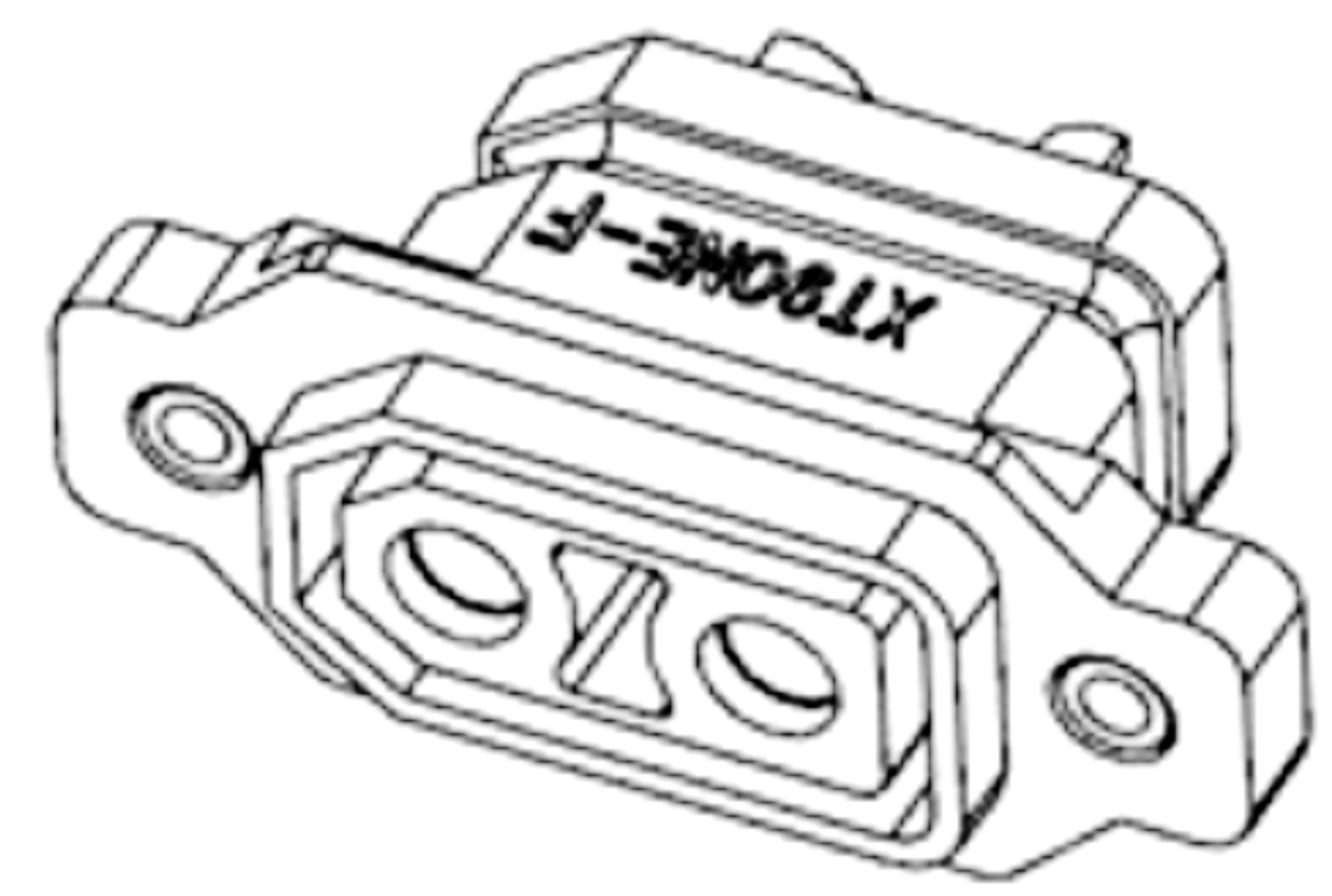
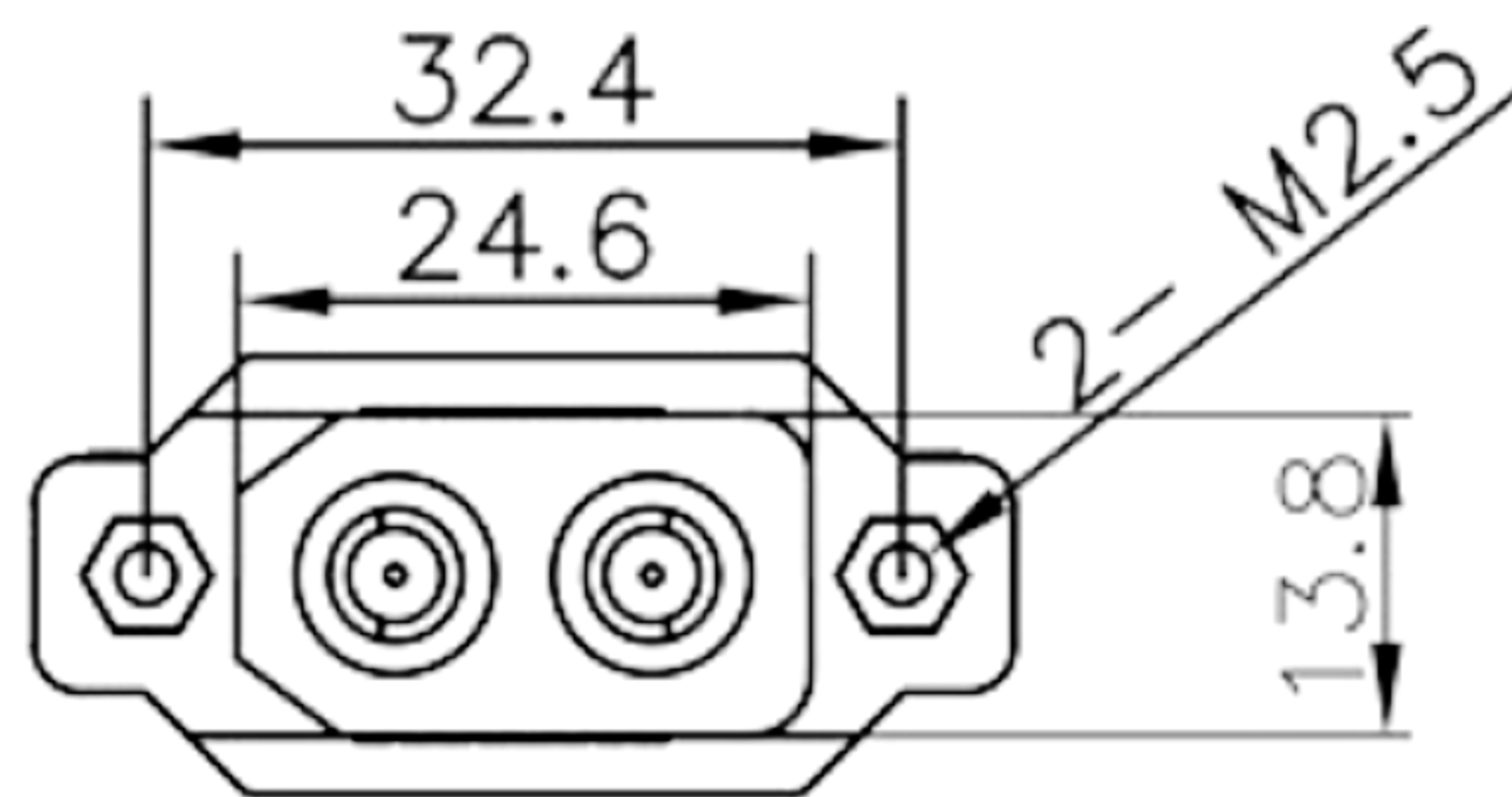

产品型号:

推荐应用: 锂电池/控制器

产品颜色:

金属材质: 镀金

瞬时电流: 60A/12#

推荐线规: 8#/10#/12#

额定电流: 30A/12#

绝缘材质: PA6

接触电阻: 0.40mΩ

工作温度: -20°C to 120°C

耐电压: DC 500V

推荐使用次数: 100times

阻燃等级: UL94-V0

TITLE	ZS-TX connector			DRAWN	Juan. Li		TOLERANCE OTHERWISE UNLESS SPECIFIED		9				
PART NO.	ZS-TX-90E-G			CHECKED	Han. Jiang		UP TO 5	±0.2	8				
DRAW NO.				APPROVED	Ping. Wei. Dong		ABOVE 5 ~ 30	±0.3	7				
SCALE	3:1	UNIT	mm	DATE	02-11-2004		ABOVE 30 ~ 50	±0.4	6				
							ABOVE 50	±0.5	5	FRAME	SPCC	1	Ni PLATED
							ANGLE	±3'	4	TERMINAL	BRASS STRIP	8	Ag PLATED
									3	BASE	PHENOLIC RESIN	1	NATURAL
									2	CONTACT PLATE	PBS	2	Ag PLATED
									1	KNOB	POM	1	BLACK
									NO.	PARTS	MATERIAL	QTY.	FINISHING

