

Rating: 12A 125VAC(UL / CUL)
10A 250VAC(CQC / ENEC/CB)

Contact Resistance: 50mΩ max
Insulation Resistance: DC 500V 100MΩ min.

Dielectric Strength: AC 1500V 1 minute

Operating Force: 350±100gf

Mechanical Life: Over 30,000 cycles

Electrical Life: Over 10,000 cycles

Operating Temperature: 0°C ~ 85°C

Safety Approval:

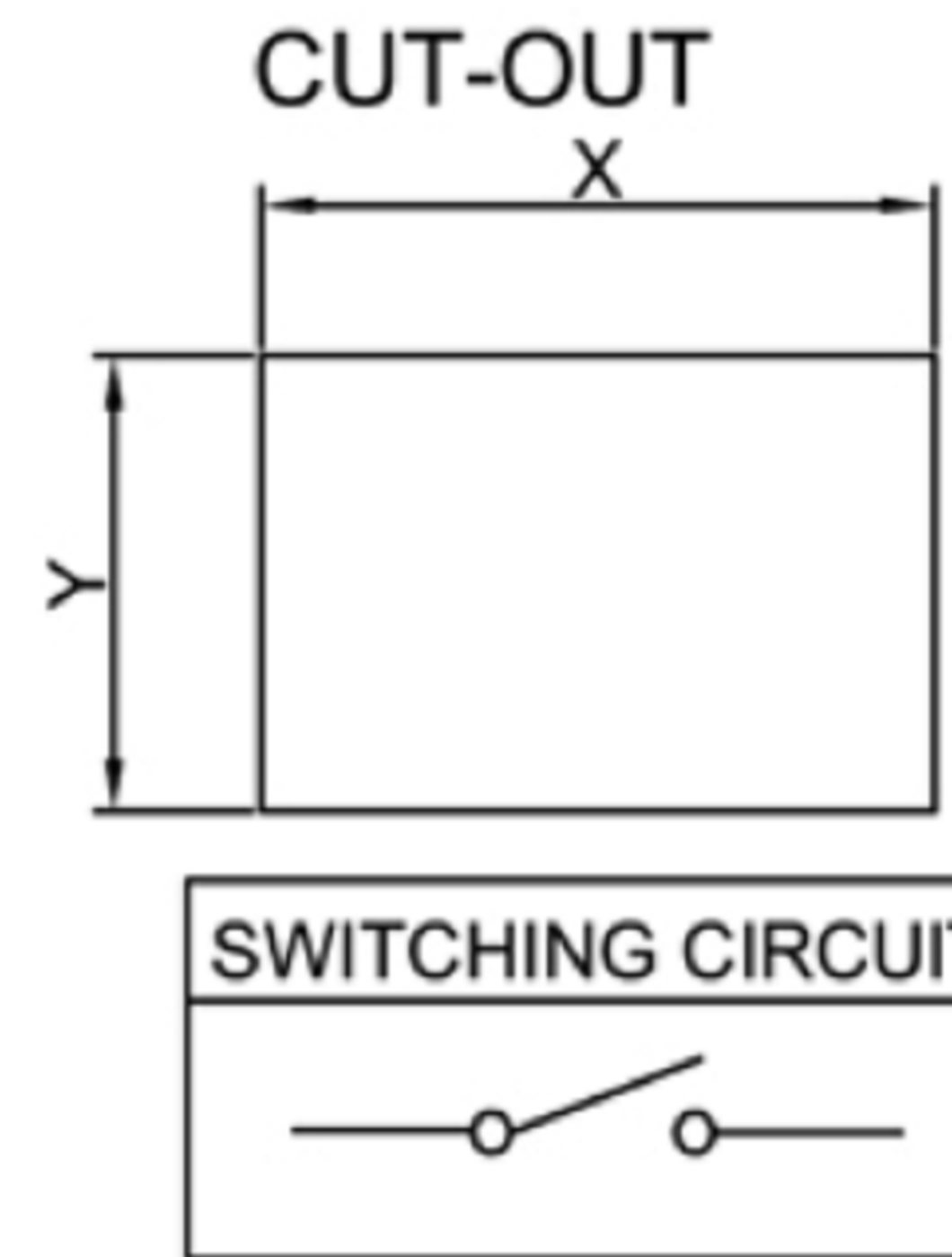
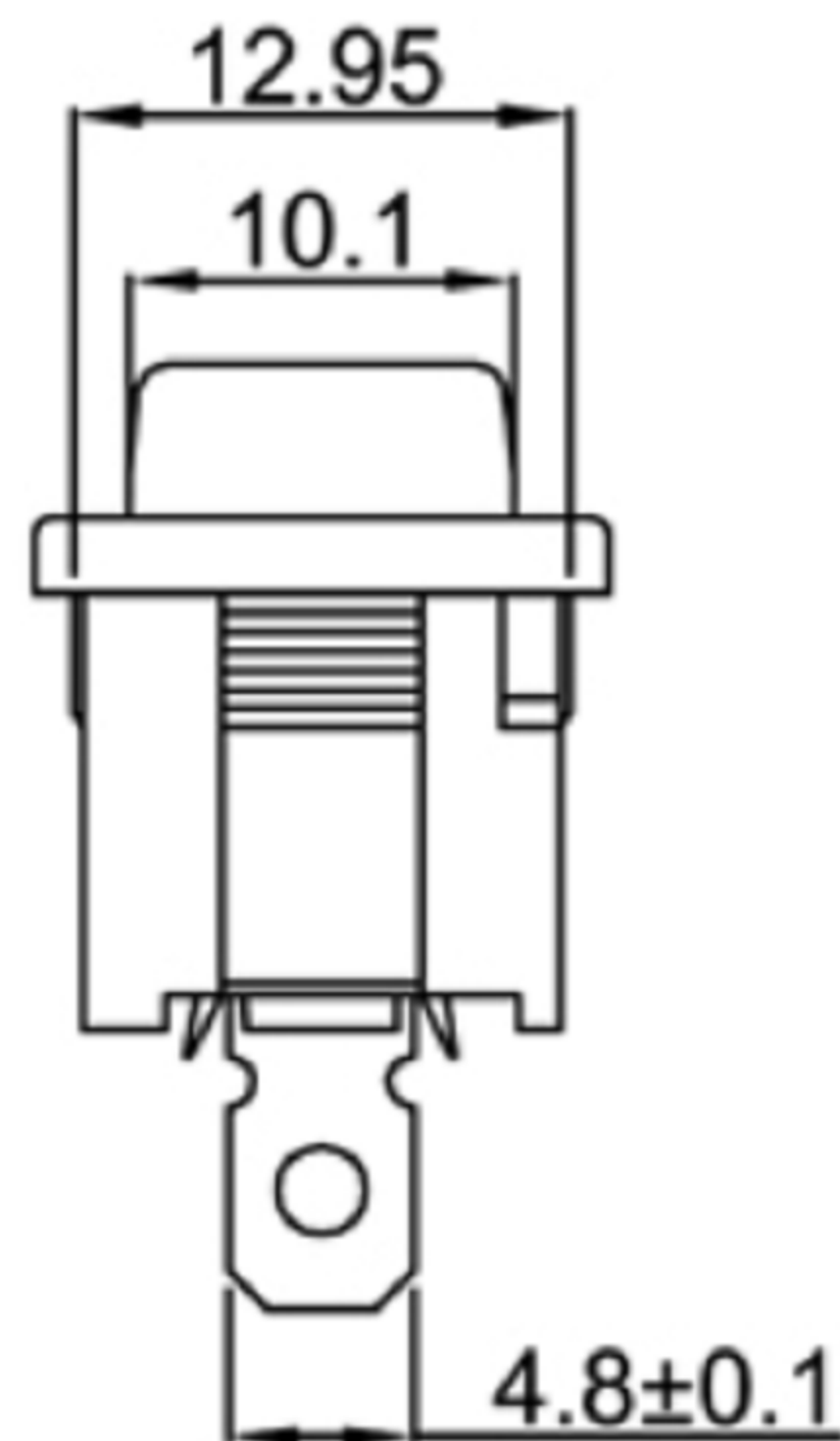
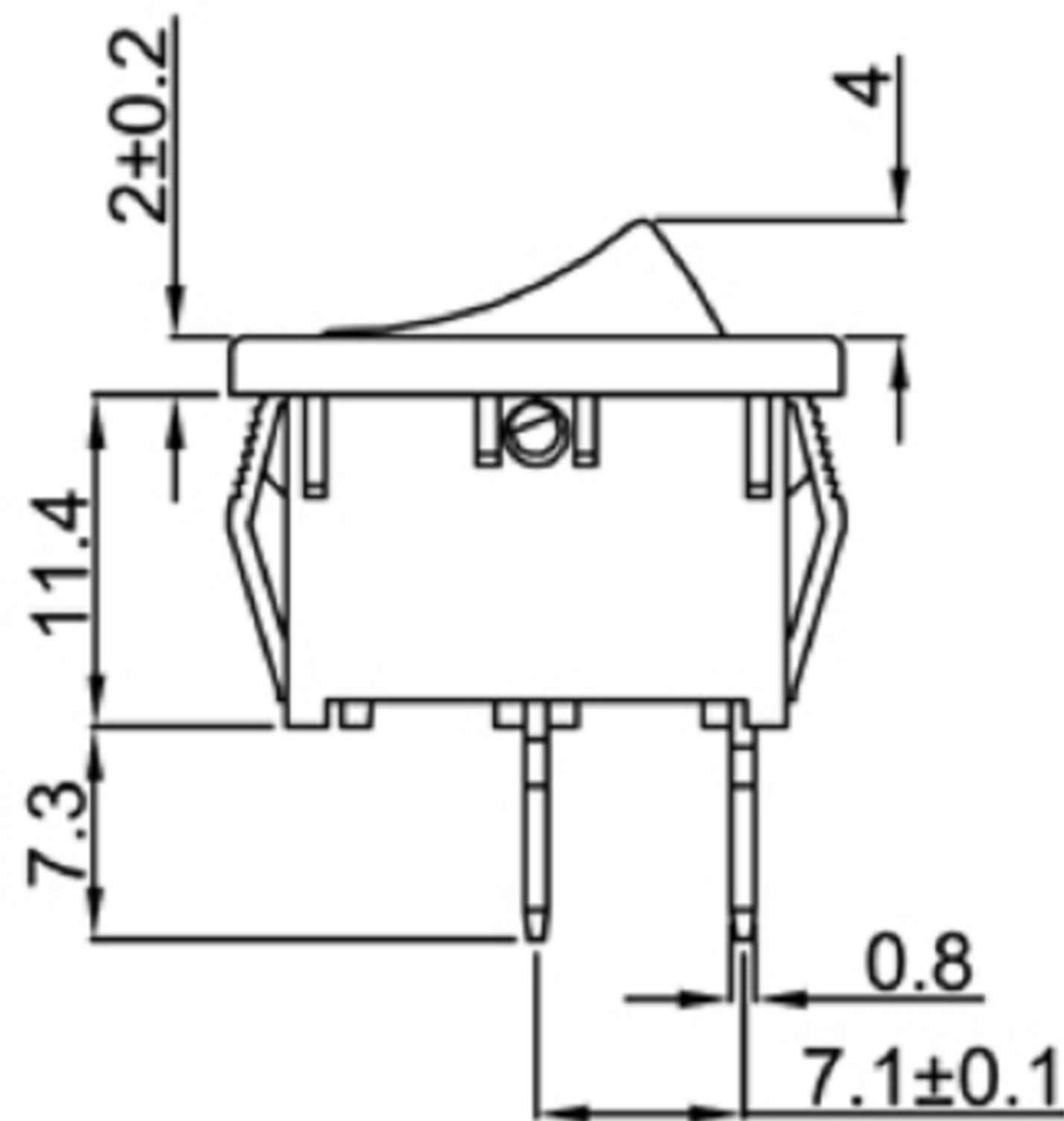

	X	Y
0.75~1.25	19.2-0.1	13.0+0.1
1.25~2.00	19.4-0.1	13.0+0.1
2.00~3.00	19.8-0.1	13.0+0.1

广东科斯达电子科技有限公司
GUANG DONG KE SI DA ELECTRONIC TECHNOLOGY CO., LTD.

TOLERANCE UNLESS OTHERWISE STATED:
Up to 5 ±0.2
Above 5 ~ 15 ±0.3
Above 15 ~ 30 ±0.4
Above 30 ~ 50 ±0.5
Angle ±0.3

3RD. ANGEL'S

UNITS MM

DRAWN BY:	DATE	MAT'L	TITLE	SWITCH
Jack Lu	12/27/22		MODLE	TACT SWITCH WITH LED
CHECKED BY:	DATE	FINISH	DWG NO.	SIZE
Jacky Chen	12/27/22			A4
APPROVED BY:	DATE	SCALE	PART NO.	VER
Tony Kao	12/27/22	1:1		R
		SHEET NO.		
		1 of 1		