

Rating: 20A 125V AC (UL CUL )  
22A 250V AC (ENEC CB CQC)

Contact Resistance: 50m Ω Max  
Insulation Resistance: DC 500V 100M Ω Min.  
Dielectric Strength: AC1500V 1 minute  
Operating Force: 350±150gf  
Mechanical Life: Over 30,000 cycles  
Electrical Life: Over 10,000 cycles  
Operating Temperature: 0°C~85°C  
Safety Approval:

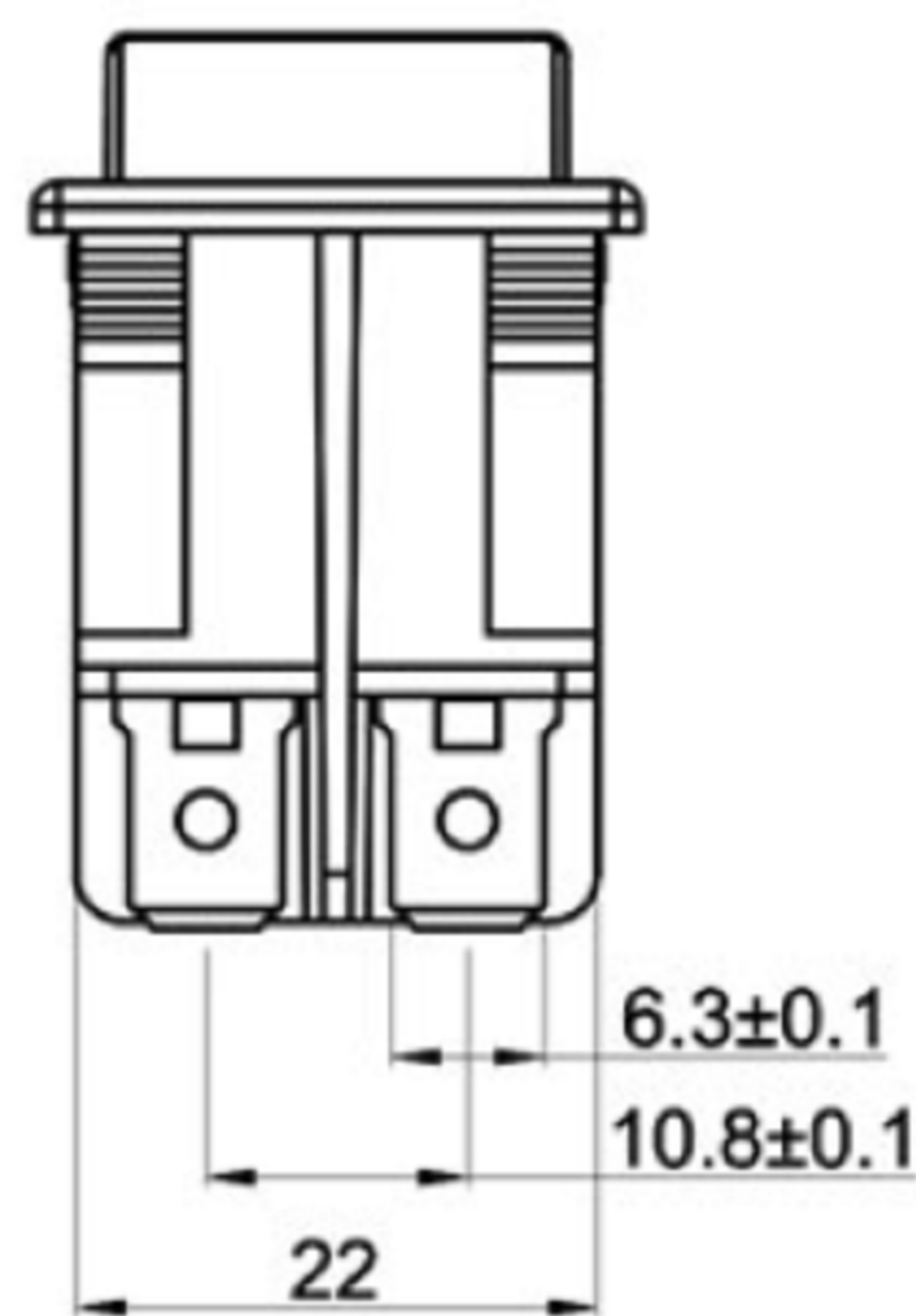

### CUT-OUT

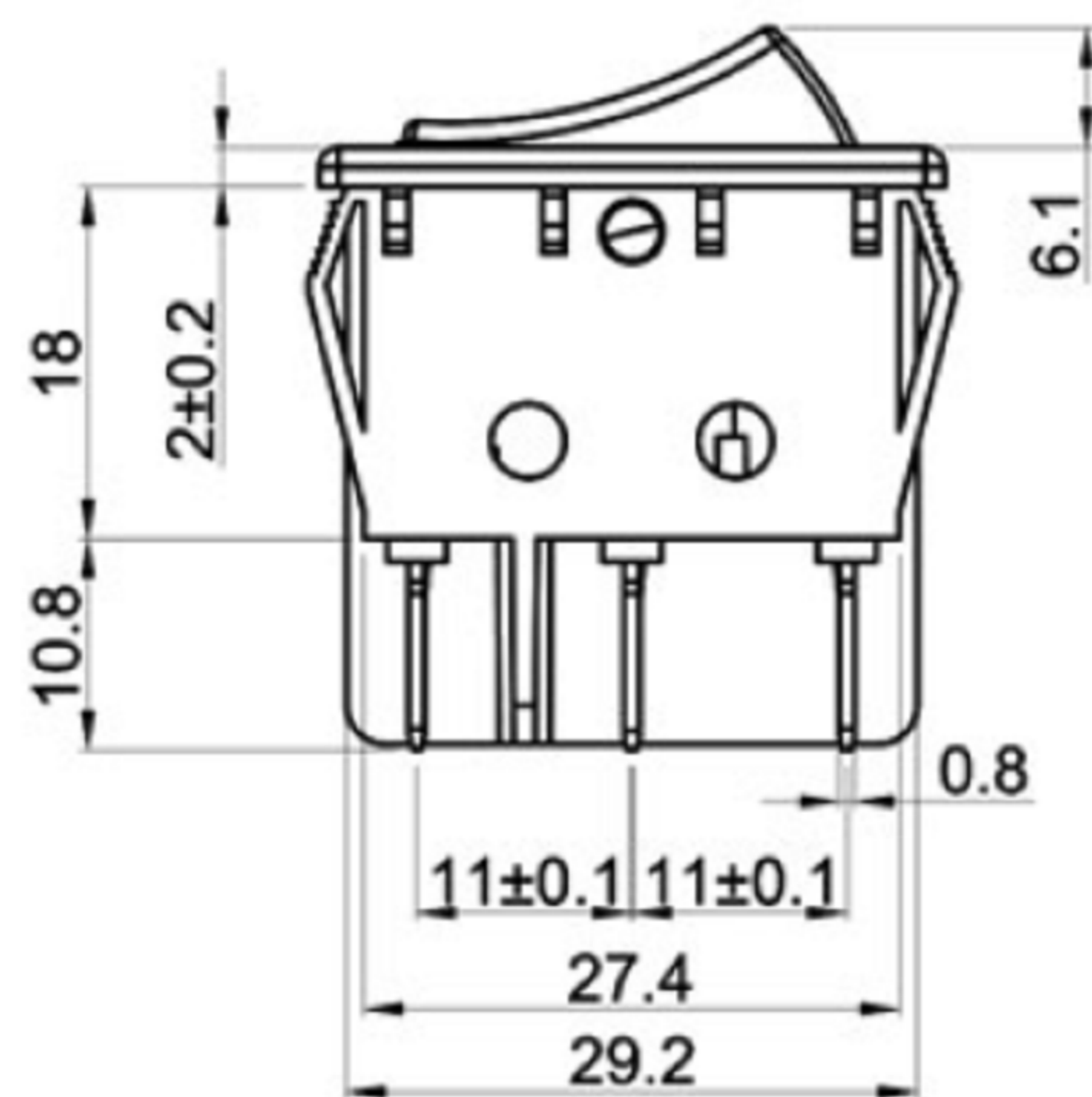
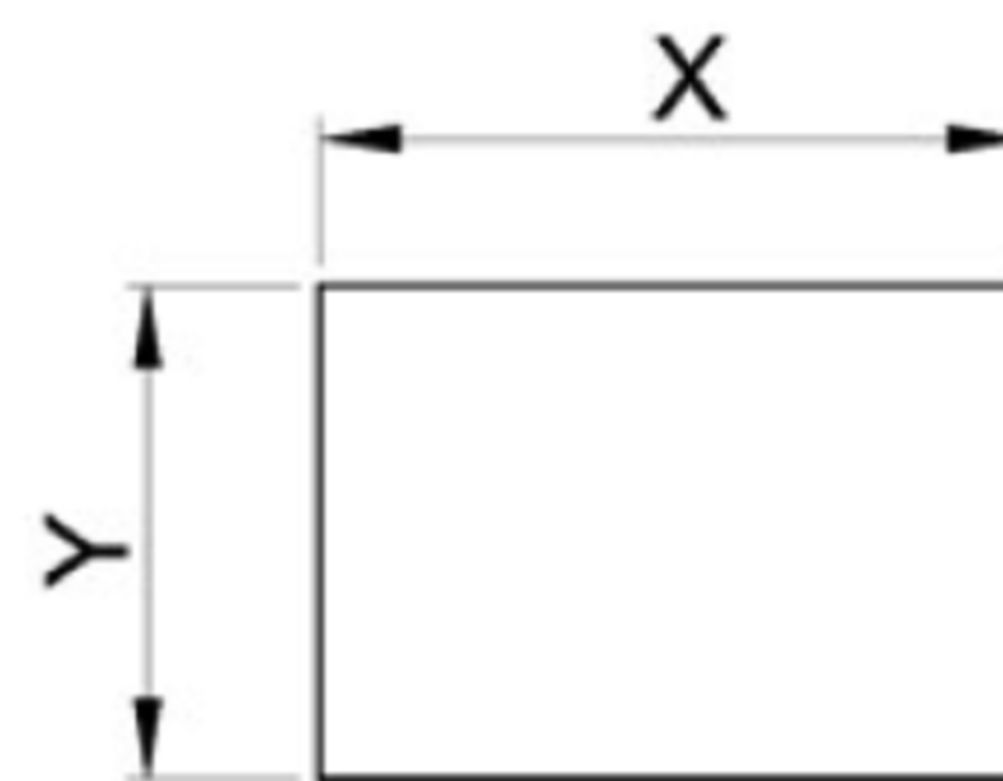

	X	Y
0.75~1.25	30.0+0.1	122.0+0.1
1.25~2.00	30.2+0.1	122.0+0.1
2.00~3.00	30.4+0.1	122.0+0.1

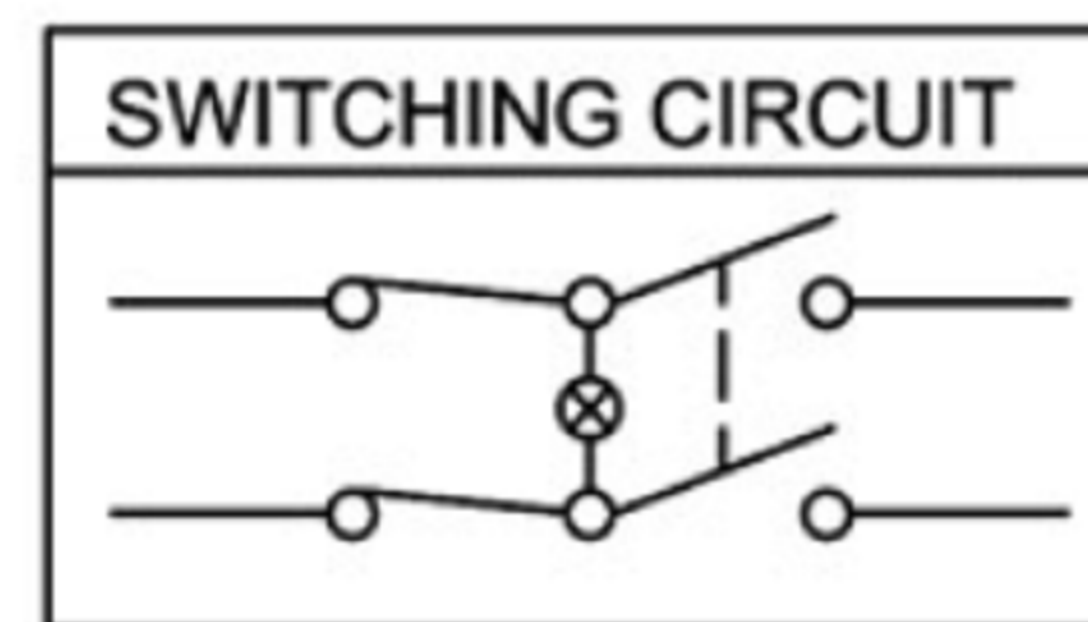

**广东科斯达电子科技有限公司**  
GUANG DONG KE SI DA ELECTRONIC TECHNOLOGY CO., LTD.

TOLERANCE UNLESS OTHERWISE STATED:  
Up to 5 ±0.2  
Above 5 ~ 15 ±0.3  
Above 15 ~ 30 ±0.4  
Above 30 ~ 50 ±0.5  
Angle ±0.3

3RD. ANGEL'S

UNITS MM

DRAWN BY:	DATE	MAT'L	TITLE	SWITCH
Jack Lu	12/27/22			
CHECKED BY:	DATE	FINISH	MODLE	TACT SWITCH WITH LED
Jacky Chen	12/27/22			
APPROVED BY:	DATE	SCALE	DWG NO.	
Tony Kao	12/27/22	1 : 1		
		SHEET NO.	PART NO.	
		1 of 1		

ITEM NO.	DESCRIPTION	DRAWN	DATE