

A B C D

E F

REV	ECN No.	DESCRIPTION	DESIGN	DATE
A	-	Release	李润	2016.05.23

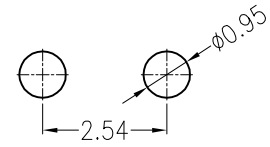
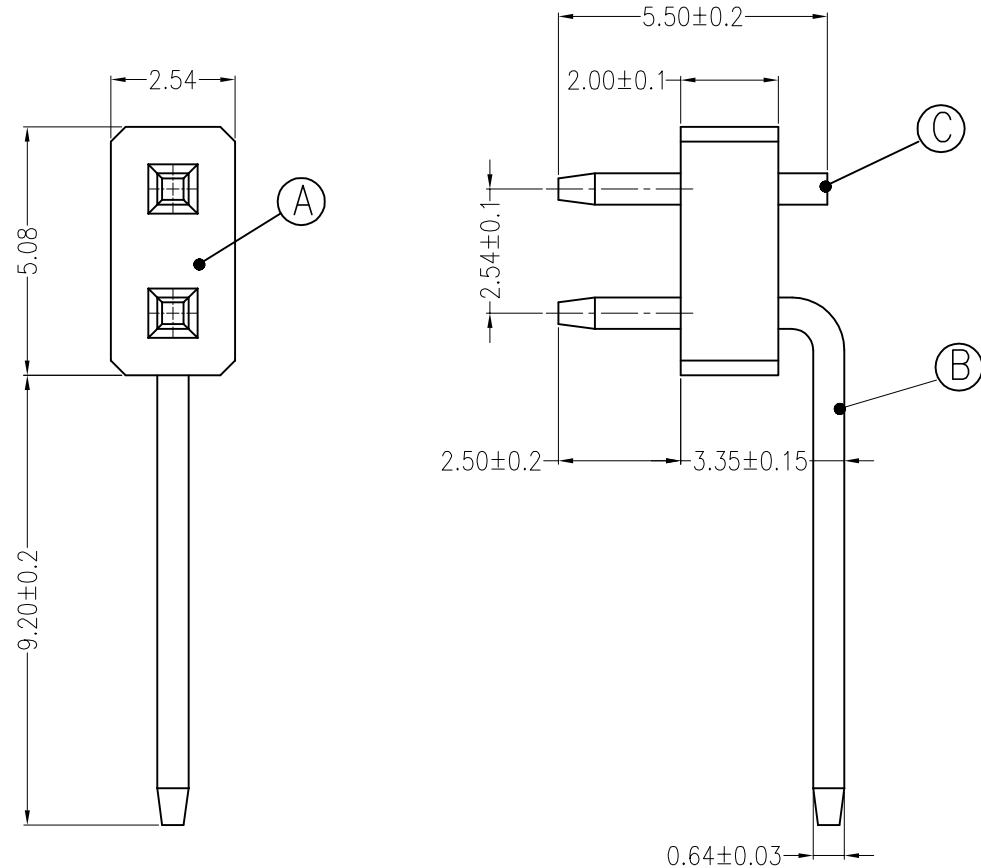

Board Layout
General Tolerance: ±0.05

主要技术参数 Main Specifications

- 接触电阻 (Contact resistance): $\leq 20m\Omega$
- 绝缘电阻 (Insulation resistance): $\geq 1000M\Omega$
- 额定电压 (Rated voltage): 250V AC DC
- 额定电流 (Rated current): 1.0A AC DC
- 耐电压 (Withstand Voltage): 1000V AC/minute
- 温度范围 (Temperature Range): $-40^{\circ}C \sim +110^{\circ}C$

ORDER INFORMATION:

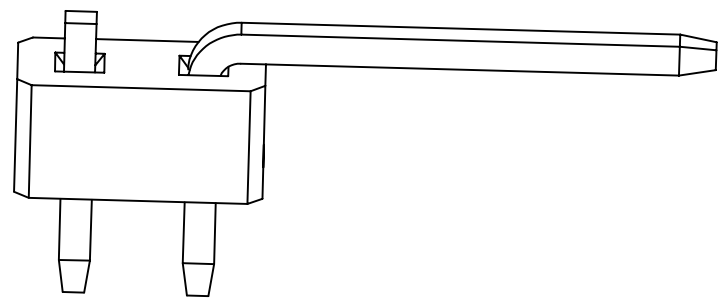
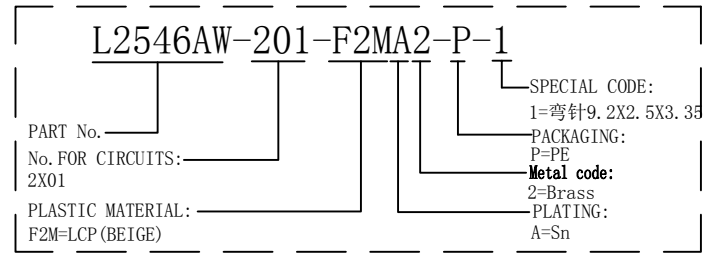

ITEM	COMPONENT	Q'TY	MATERIAL	FINISH
C	CONTACT	1 PCS	Brass	Sn-plated
B	CONTACT	1 PCS	Brass	Sn-plated
A	HOUSING	1 PCS	LCP	UL 94V-0, COLOR:BEIGE

广东科斯达电子科技有限公司
GUANG DONG KE SI DA ELECTRONIC TECHNOLOGY CO., LTD.

TITLE: L2546AW
2.54Pitch 90°wafer dip type

.X±0.35	X.±	USE:	CUSTOMER
.XX±0.25	.X±	APPD:	邵敬和
.XXX±0.15	.XX±	CHKD:	田峰
--	--	DR:	吴丹平

PART NO.: L2546AW-201-F2MA2-P-1
DWG NO.: GCCP-0297
SCALE: 1 : 1
SHEET: 1 / 1

A B C D

E F

1
2
3
4
5

1
2
3
4
5