

# CUSTOMER DRAWING

REV.	DESCRIPTION	APPROVED BY	DATE	ECN NO.
△C	RELEASE	Fido Weng	22/12/08'	
△D	MODIFY MYLAR	Fido Weng	12/11/09'	ECN09161
△E	MODIFY MYLAR(增加)	Emily Suen	01/03/11'	ECN11019

### 步驟一:

1. 將成品一一放入包裝盤內,依同一方向置入.
2. 包裝方式,如圖所示.
3. 一個包裝盤內放750pcs.

### 步驟二:

1. 一個紙箱可以裝10個包裝盤.
2. 每盤750pcs,每箱7500pcs.
3. 將包裝盤放入防水袋中,包裝完後再封箱.

### 步驟三:

1. 用膠帶將紙箱封實.
2. 將標籤貼於紙箱上.

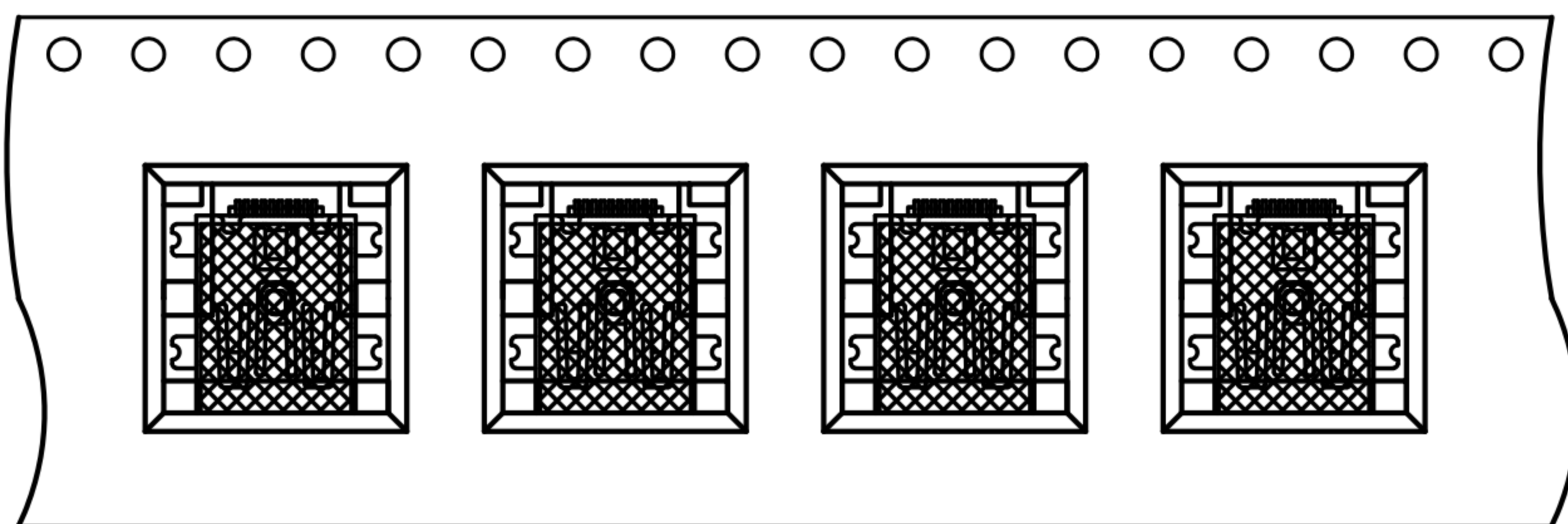
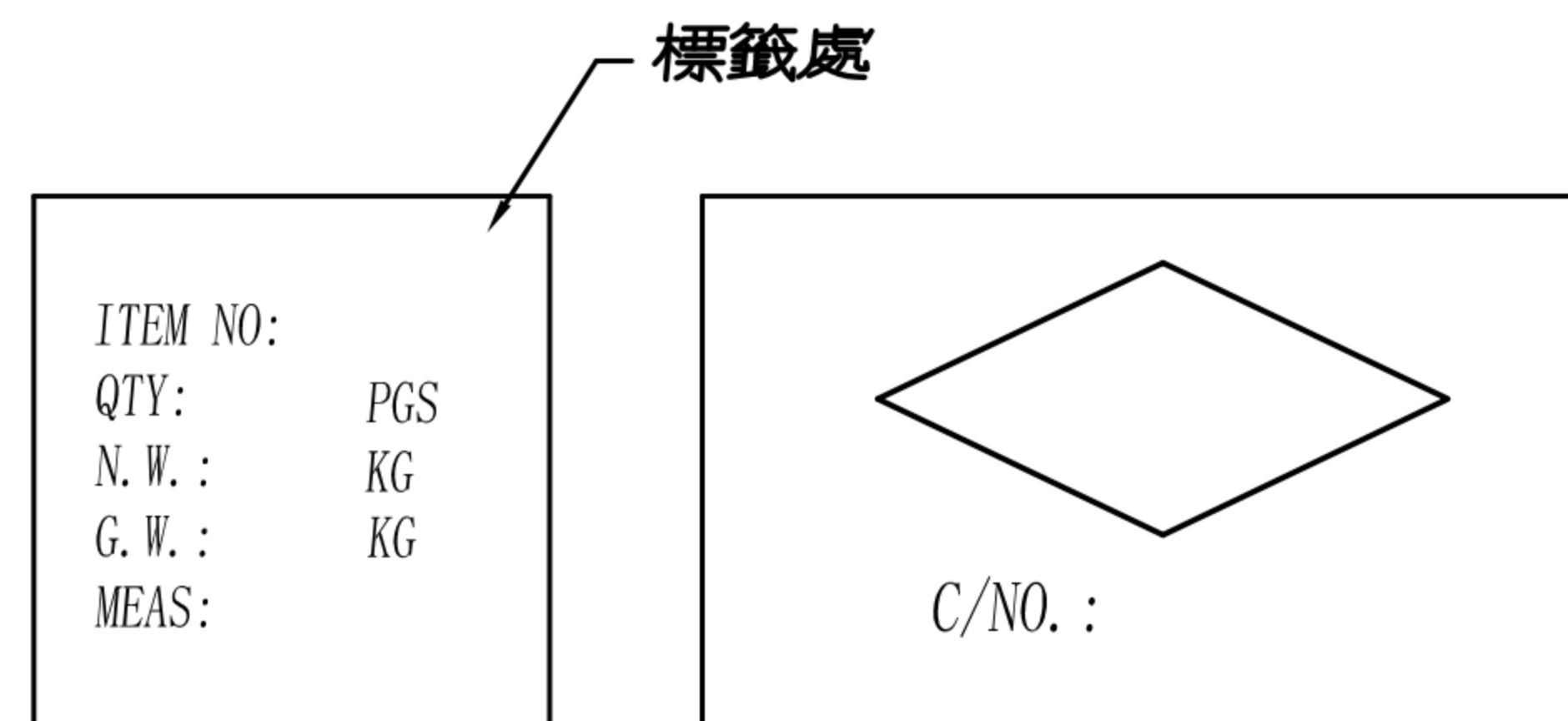
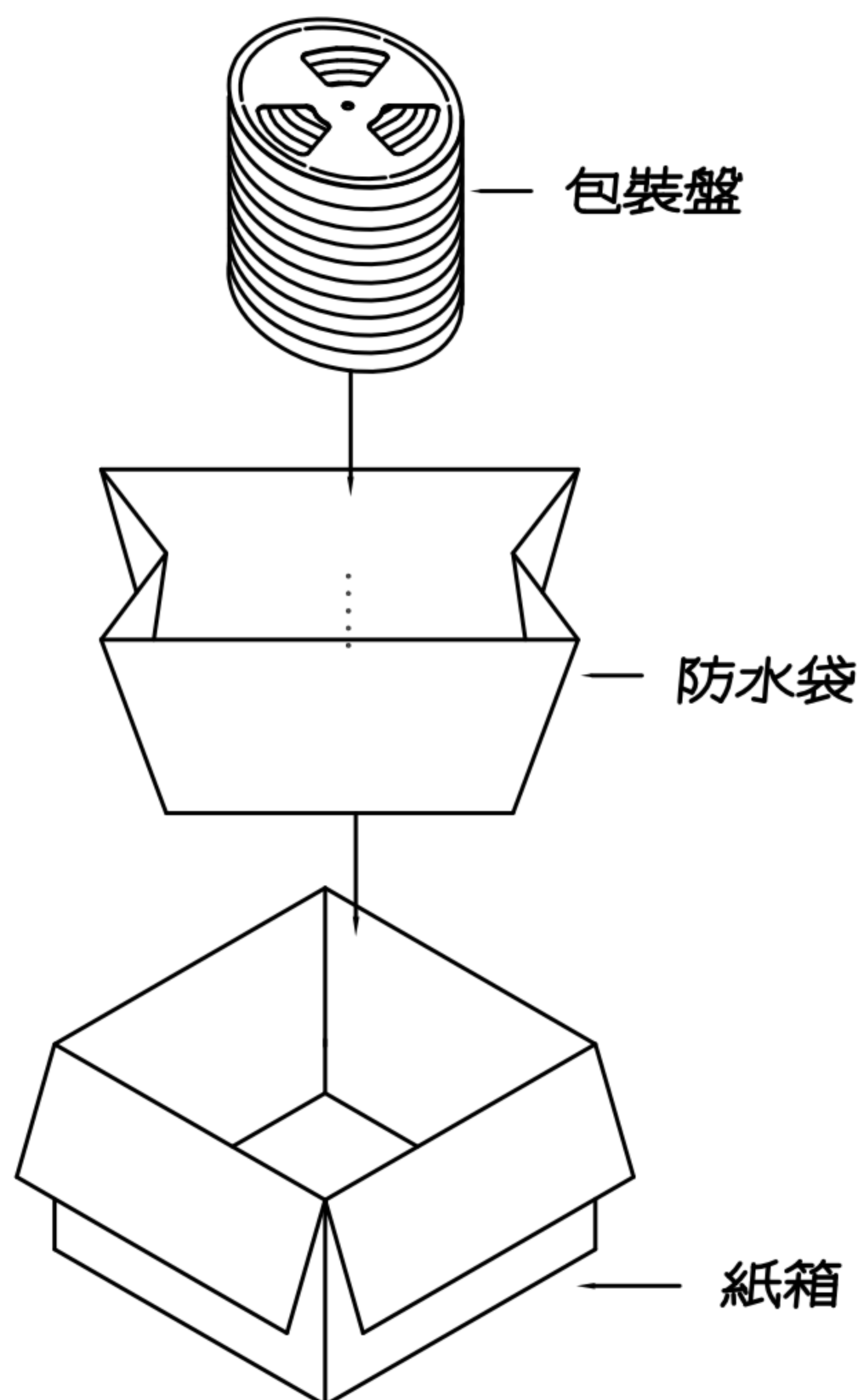
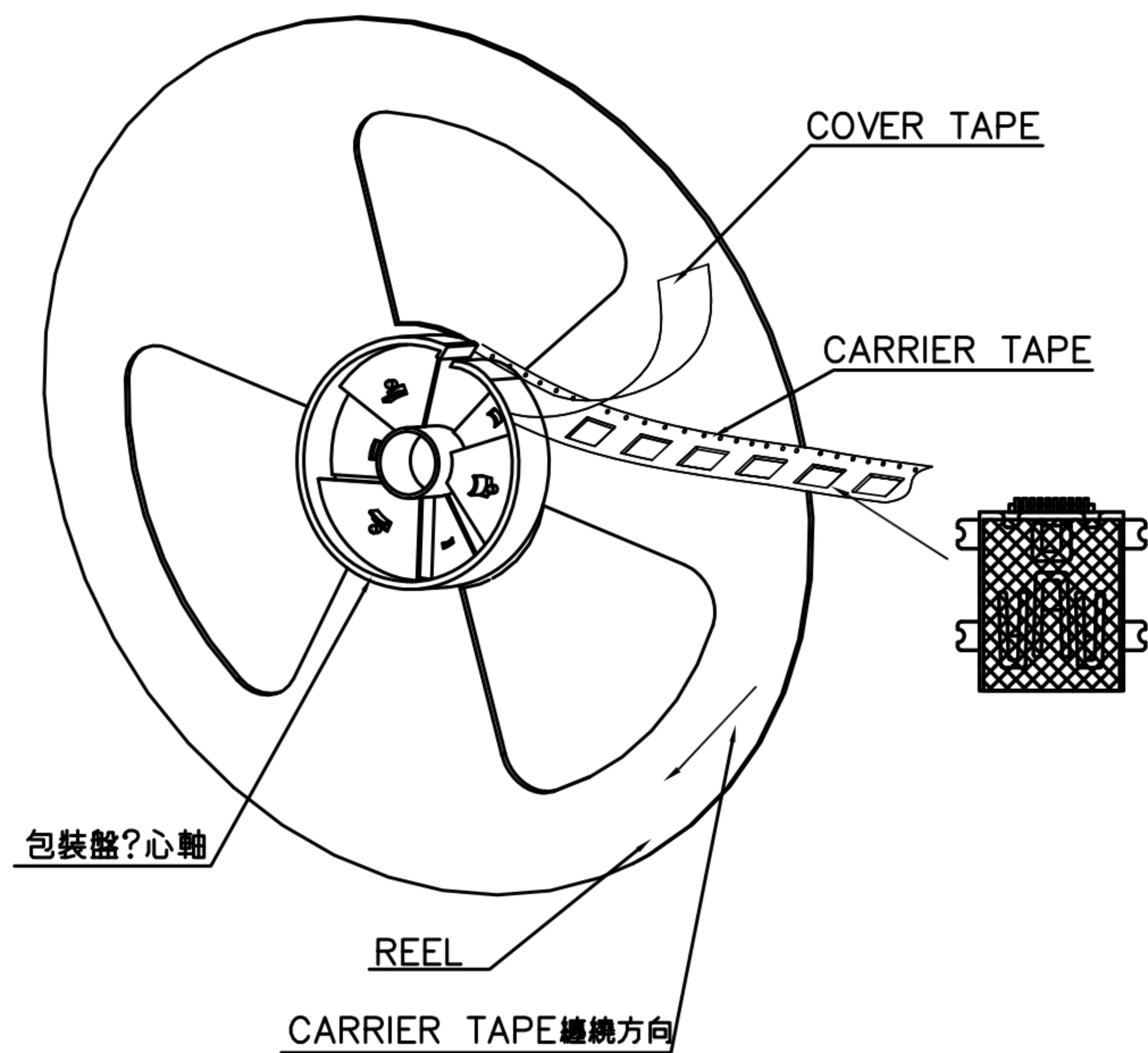

### NOTE:

1. 若有未裝滿之零數箱,必須以緩衝材塞滿.
2. 在搬運過程中要輕拿輕放.
3. 載運輸中不可堆放過多,不可有重壓現象.
4. 在裝滿產品後,必須空留帶前和帶後15格以上,然後用紙膠布貼上.
5. 上帶在貼下帶時必須平整,且黏貼處不要出現氣泡.

DRAWN	Jen Xie	APP'D	Emily Suen	UNIT	mm	TOLERANCE			TITLE	MINI USB 雙排10PIN(F)AB TYPE(前後SMT)			SHEET	2
CHK'D	Emily Suen			SCALE	1:1	.x ±0.20 .xx ±0.10 .xxx ±0.05 .xxxx ±0.03 ANGULA ±1°			PART NO.	SEE TABLE A	DWG NO.	QC3176	VERSION	E



# CUSTOMER DRAWING

REV.	DESCRIPTION	APPROVED BY	DATE	ECN NO.
C	RELEASE	Fido Weng	22/12/08'	
D	MODIFY MYLAR	Fido Weng	12/11/09'	ECN09161
E	MODIFY MYLAR(增加)	Emily Suen	01/03/11'	ECN11019

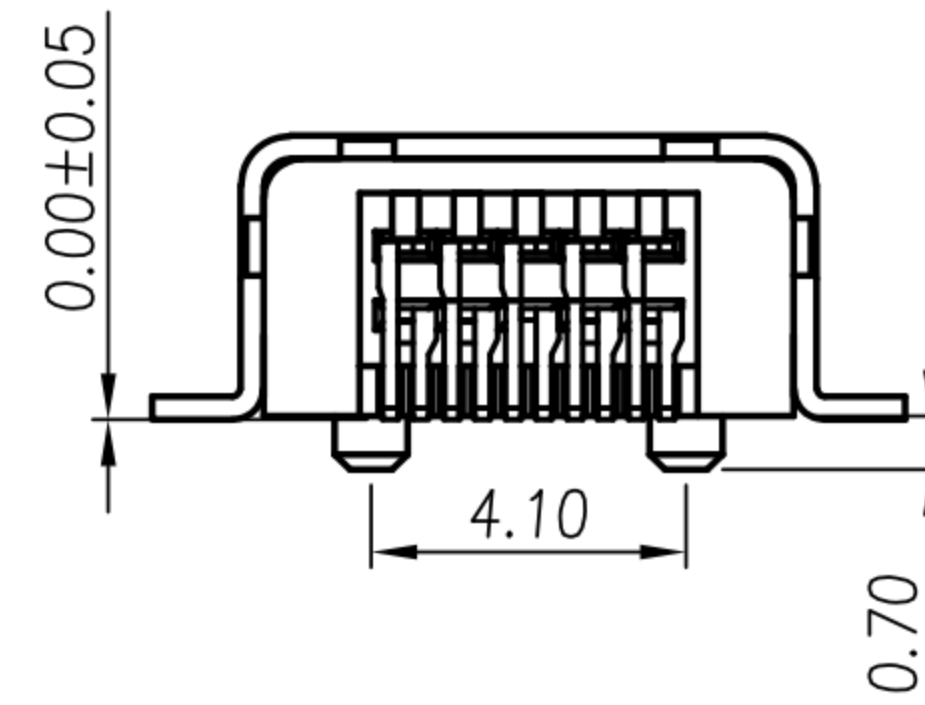
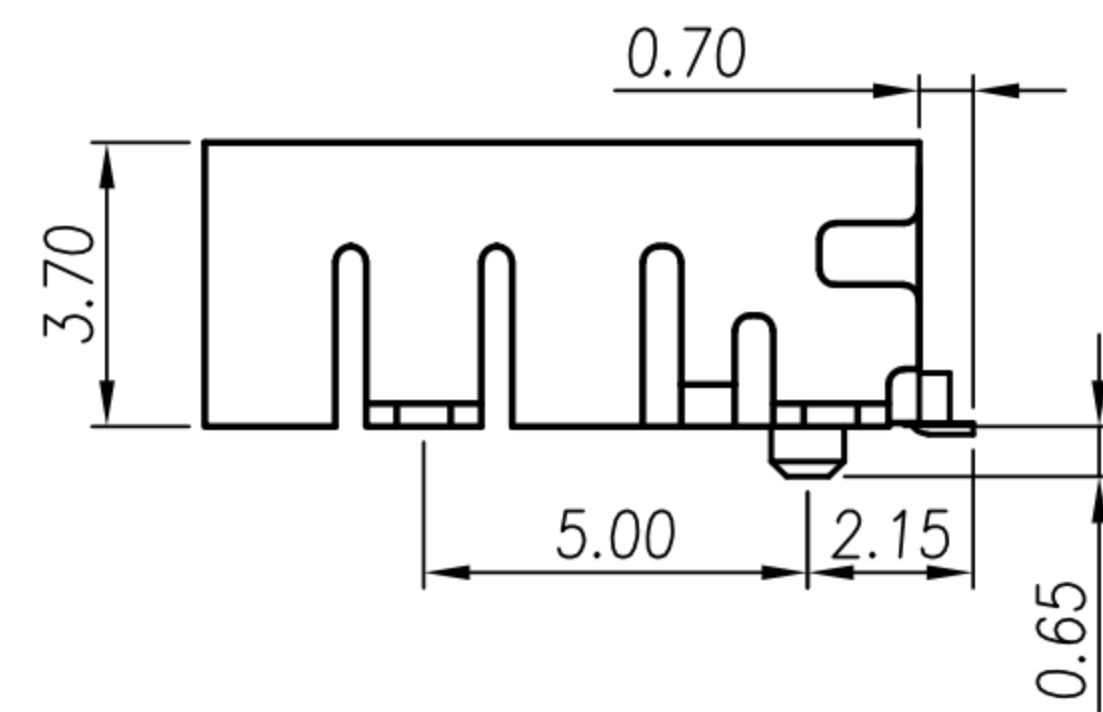
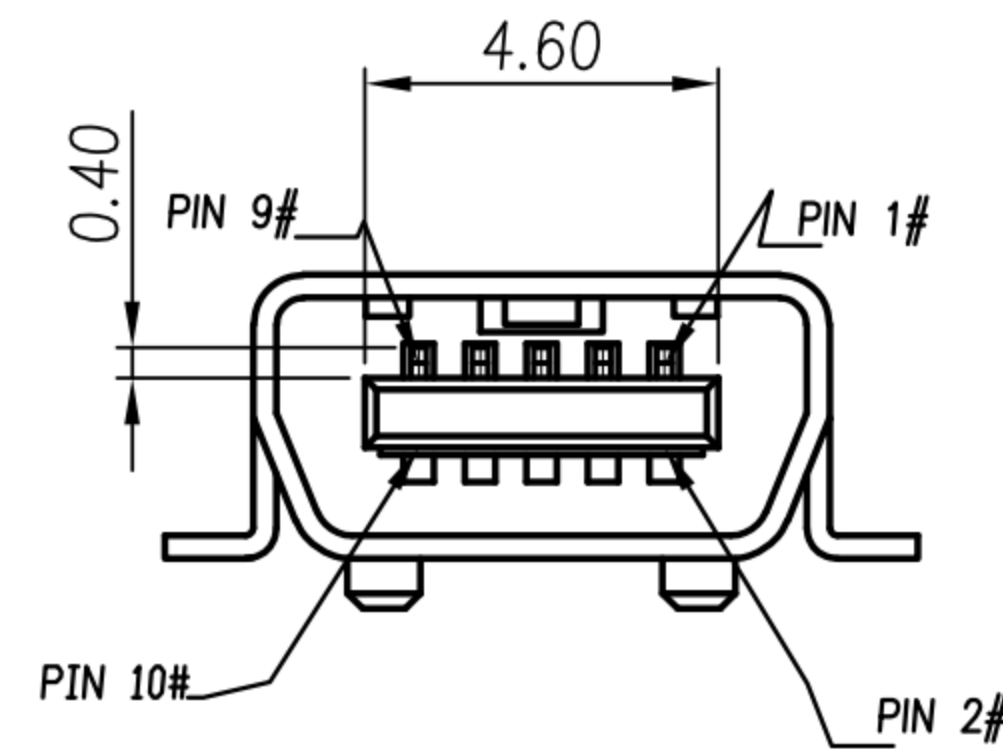
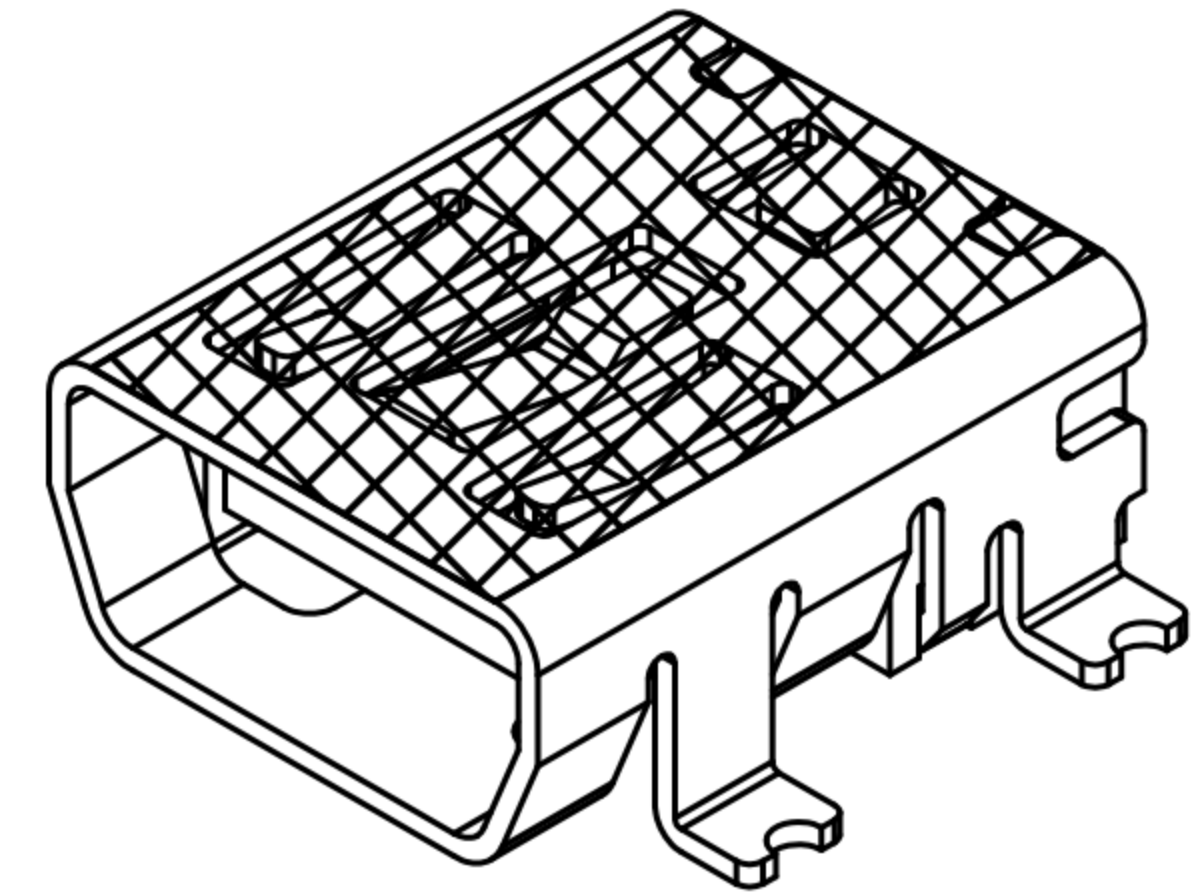
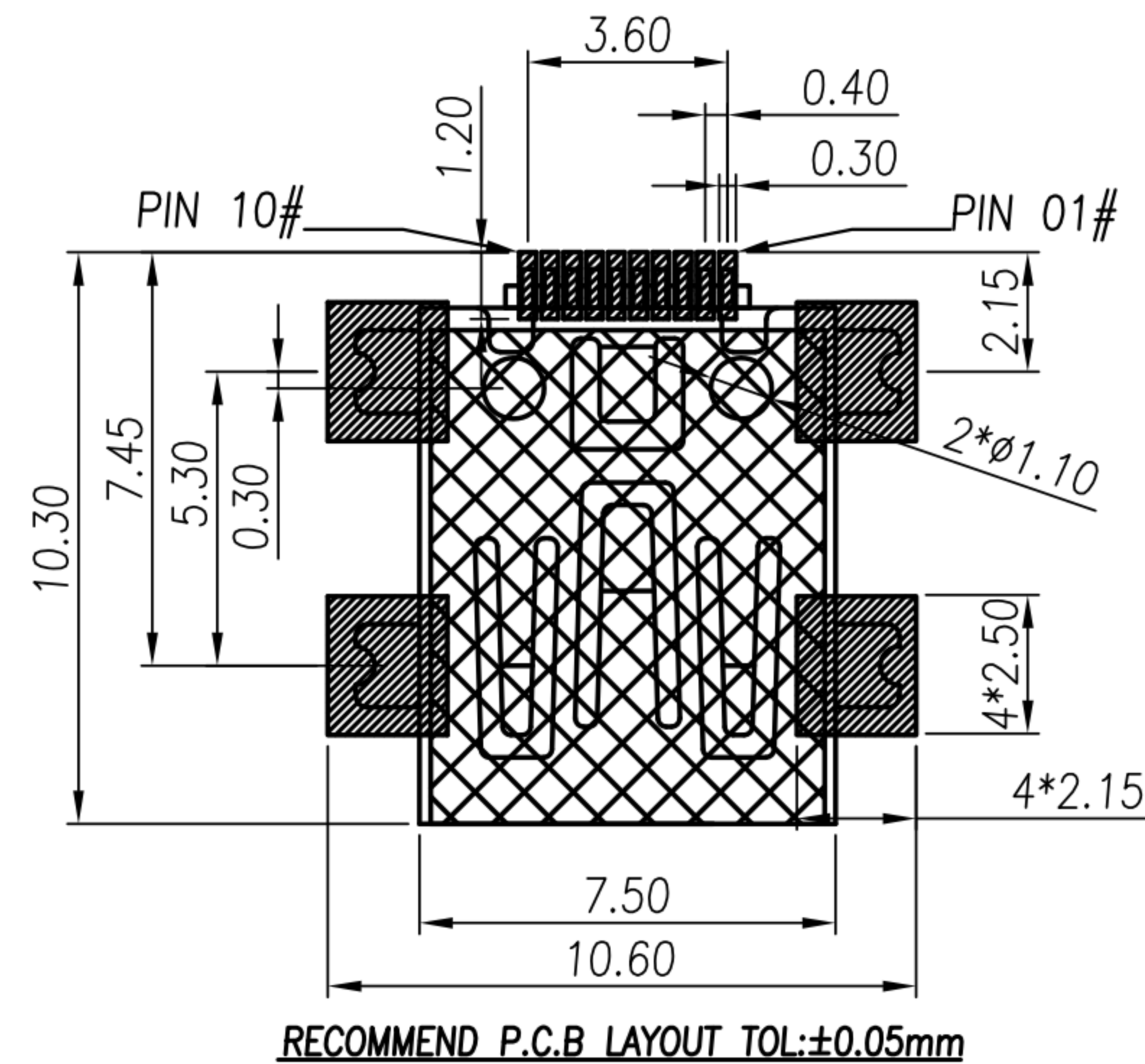
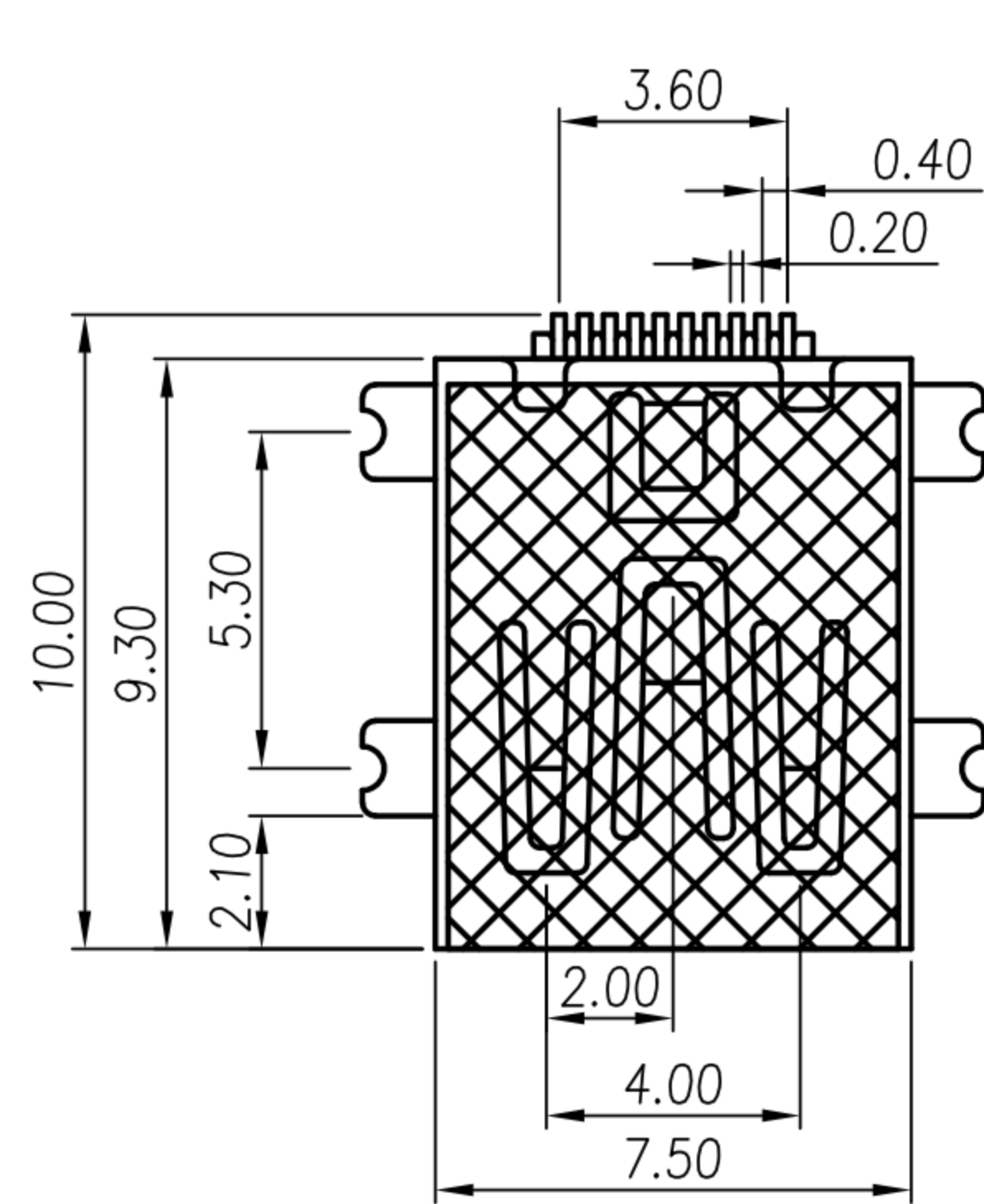

- MATERIAL :
  - 1-1. HOUSING : LCP UL94V-0 ; COLOR : BLACK ; 無鹵
  - 1-2. CONTACT : PHOSPHOR BRONZE
  - 1-3. SHELL : PHOSPHOR BRONZE
- FINISH :
  - 2-1. CONTACT : SEE TABLE A
  - 2-2. SHELL : SMT AREA GOLD FLASH  
NICKEL PLATED 60u" OVER ALL

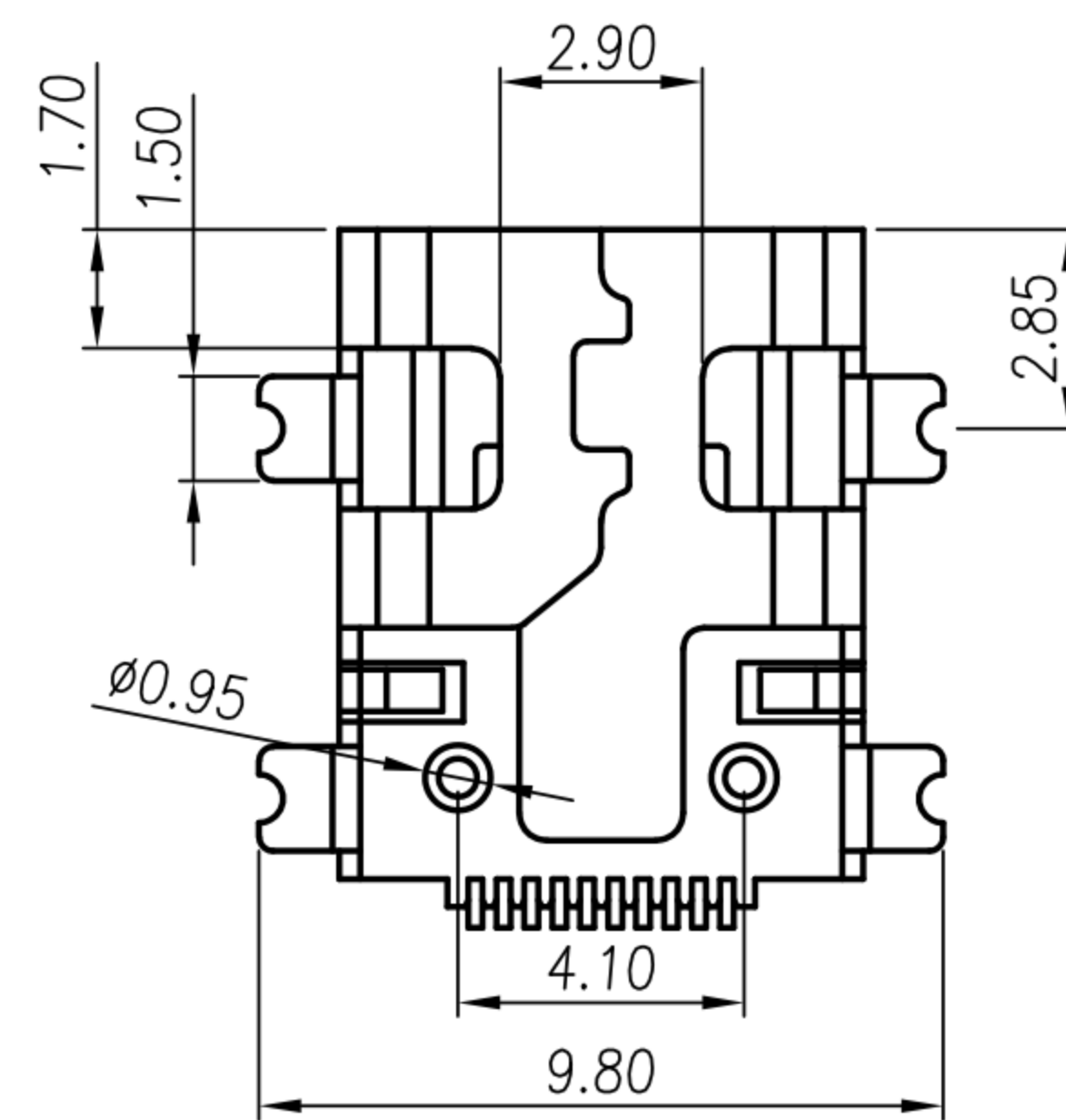

TABLE A

MU-10F4-11	GOLD 10u" MIN ON CONTACT AREA MATTLE TIN 80u" MIN ON SOLDER TAILS, UNDERPLATED NICKEL OVER ALL 50u" MIN.
MU-10F4-08	GOLD 10u" MIN ON CONTACT AREA GOLD FLISH MIN ON SOLDER TAILS, UNDERPLATED NICKEL OVER ALL 50u" MIN.
P/N	PLATING

DRAWN	Jen Xie	APP'D	Emily Suen	UNIT	mm	TOLERANCE			TITLE	MINI USB 雙排10PIN(F)AB TYPE(前後SMT)			SHEET	1/2
CHK'D	Emily Suen			SCALE	1:1				PART NO.	SEE TABLE A	DWG NO.	QC3176	VERSION	E