

CUSTOMER DRAWING

REV.	DESCRIPTION	APPL. BY	DATE	ECN NO.
A				
B				
C				

步驟一:

- 將成品一一放入包裝盤內,依同一方向置入.
- 包裝方式,如圖所示.
- 一個包裝盤內放200pcs.

步驟二:

- 一個紙箱可以裝10個包裝盤.
- 每盤200pcs,每箱2000pcs.
- 將包裝盤放入防水袋中,包裝完後再封箱.

步驟三:

- 用膠帶將紙箱封實.
- 將標籤貼於紙箱上.

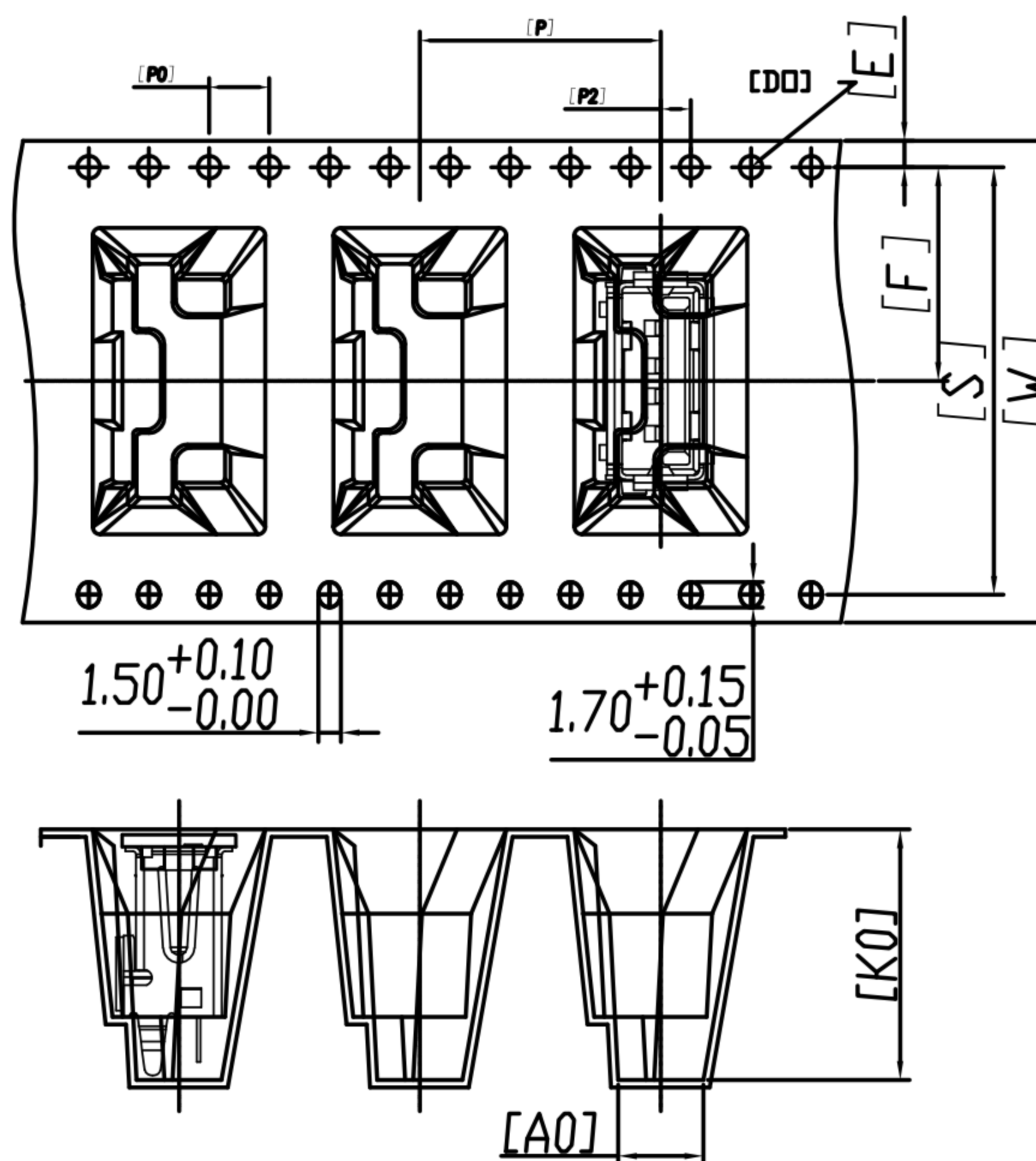
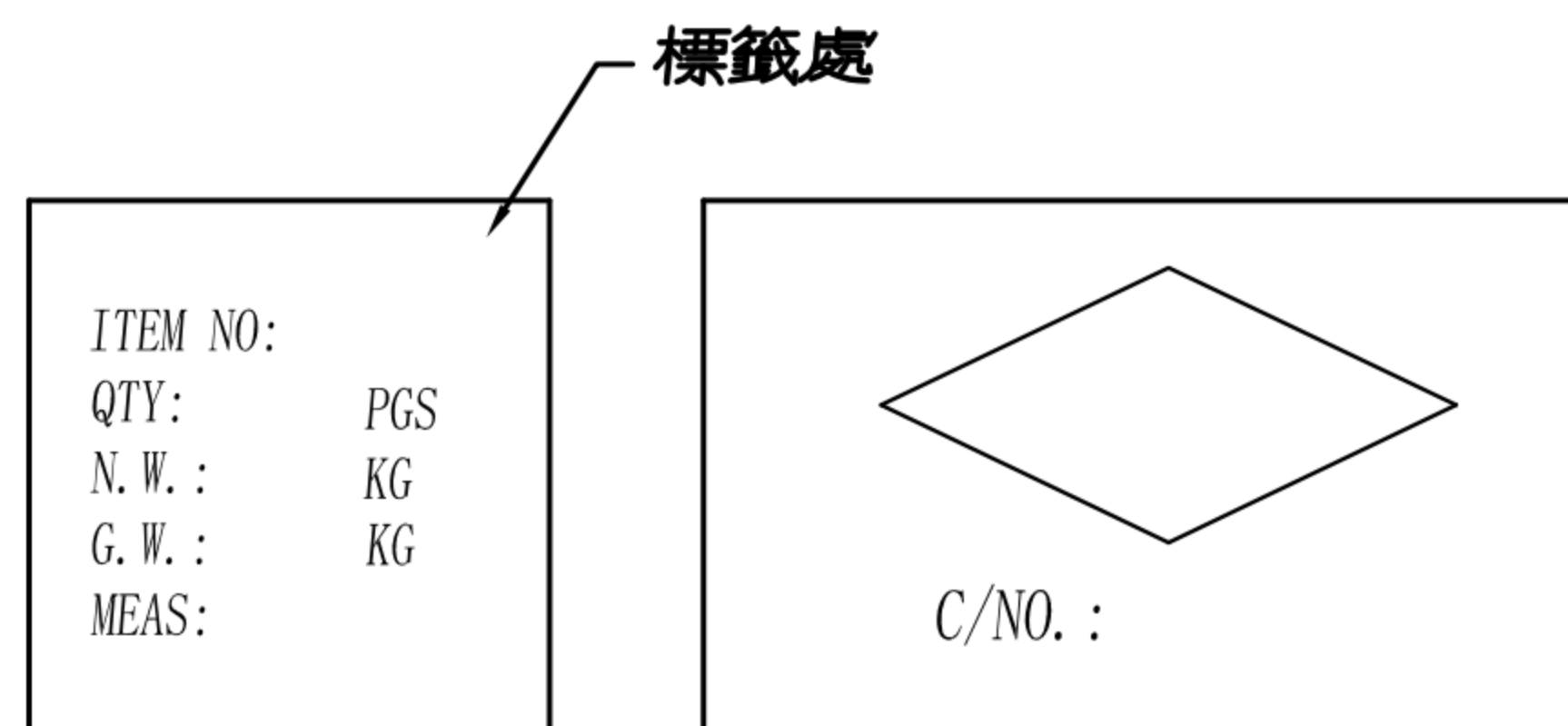
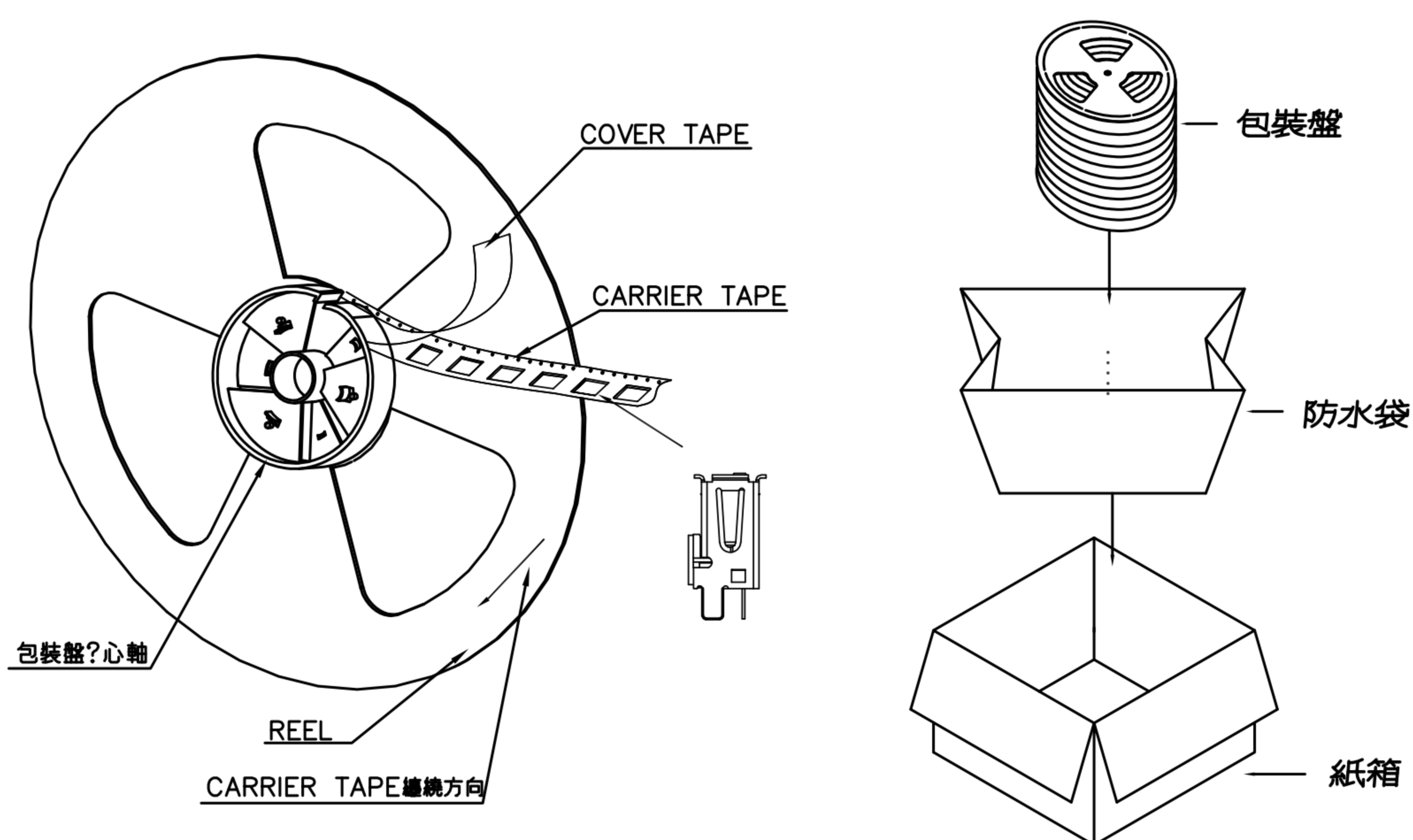

ITEM	SPEC
W	32.00 ^{+0.30} / _{-0.30}
Ao	5.66 ^{+0.10} / _{-0.10}
Bo	15.56 ^{+0.10} / _{-0.10}
Ko	16.65 ^{+0.10} / _{-0.10}
P	16.00 ^{+0.10} / _{-0.10}
F	14.20 ^{+0.10} / _{-0.10}
E	1.75 ^{+0.10} / _{-0.10}
D0	1.50 ^{+0.10} / _{-0.00}
Po	4.00 ^{+0.10} / _{-0.10}
P2	2.00 ^{+0.10} / _{-0.10}
t	0.50 ^{+0.05} / _{-0.05}

NOTE:

- 若有未裝滿之零數箱,必須以緩衝材塞滿.
- 在搬運過程中要輕拿輕放.
- 載運輸中不可堆放過多,不可有重壓現象.
- 在裝滿產品後,必須空留帶前和帶後15格以上,然後用紙膠布貼上.
- 上帶在貼下帶時必須平整,且黏貼處不要出現氣泡.

DRAWN	Mark Kao	APP'D	Ku Chou	UNIT	mm	TOLERANCE		广东科斯达电子科技有限公司 GUANG DONG KE SI DA ELECTRONIC TECHNOLOGY CO., LTD.	TITLE	USB 4P A (F)180度 DIP直腳			SHEET	2
CHK'D	Emily Suen			SCALE	1:1	.x ±0.20 .xx ±0.10 .xxx ±0.05 .xxxx ±0.03 ANGULA ±1°			PART NO.	US-04F3-29-11	DWG NO.	QC7673	VERSION	A

CUSTOMER DRAWING

REV.	DESCRIPTION	APPVL. BY	DATE	ECN NO.
A	RELEASE	Fido Weng	25/12/13'	
B				
C				

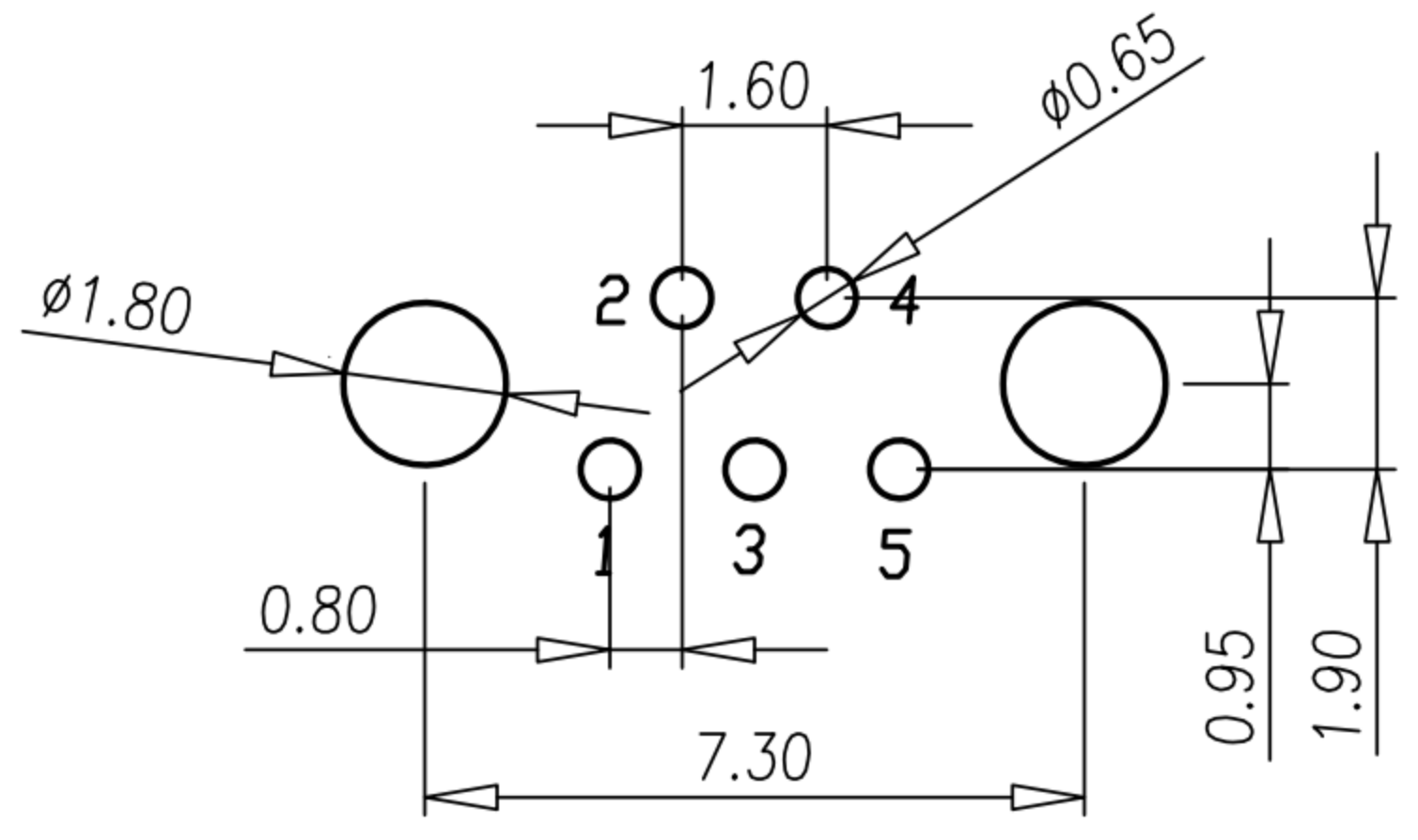
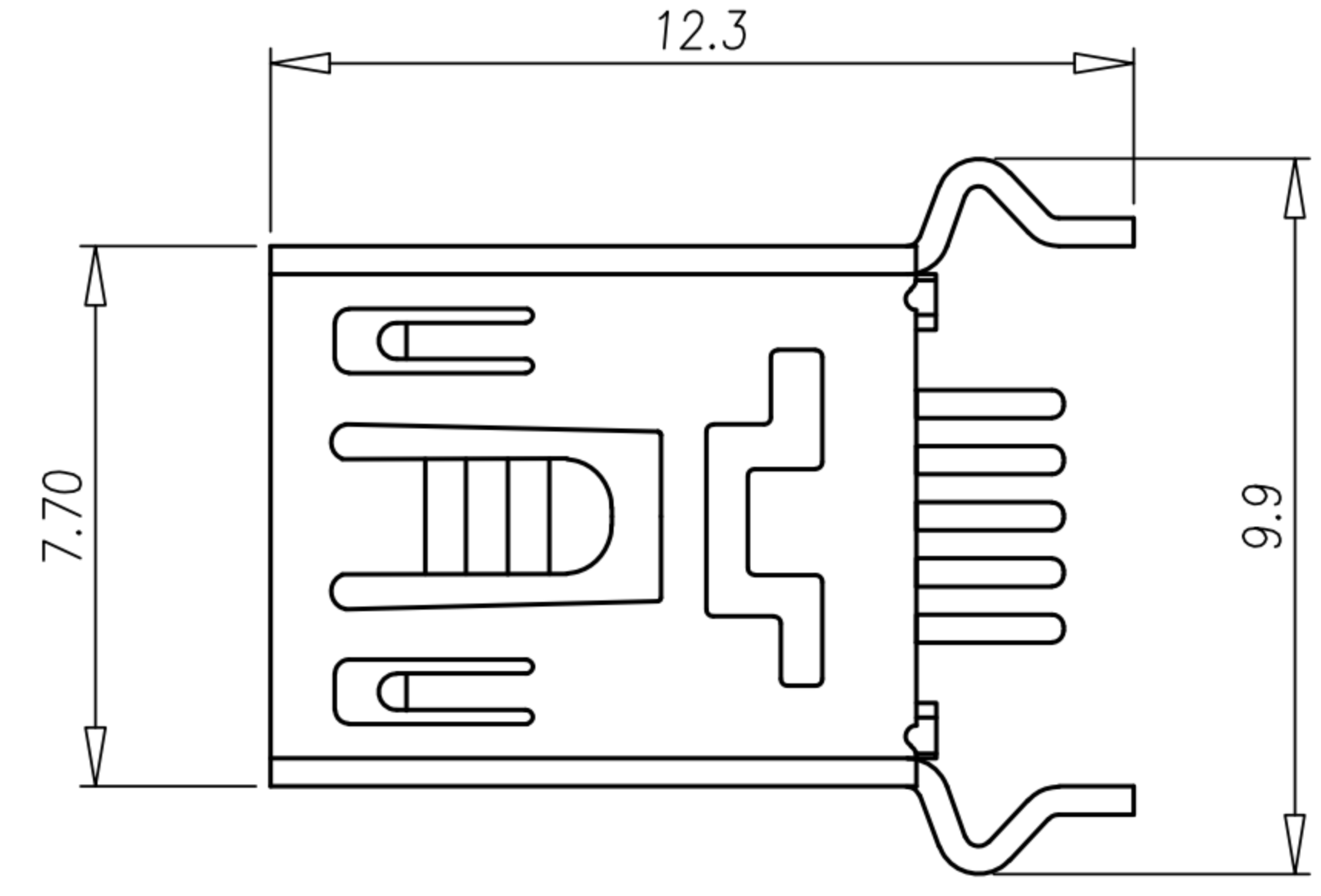

RECOMMENDED P.C.B. PATTERN LAYOUT

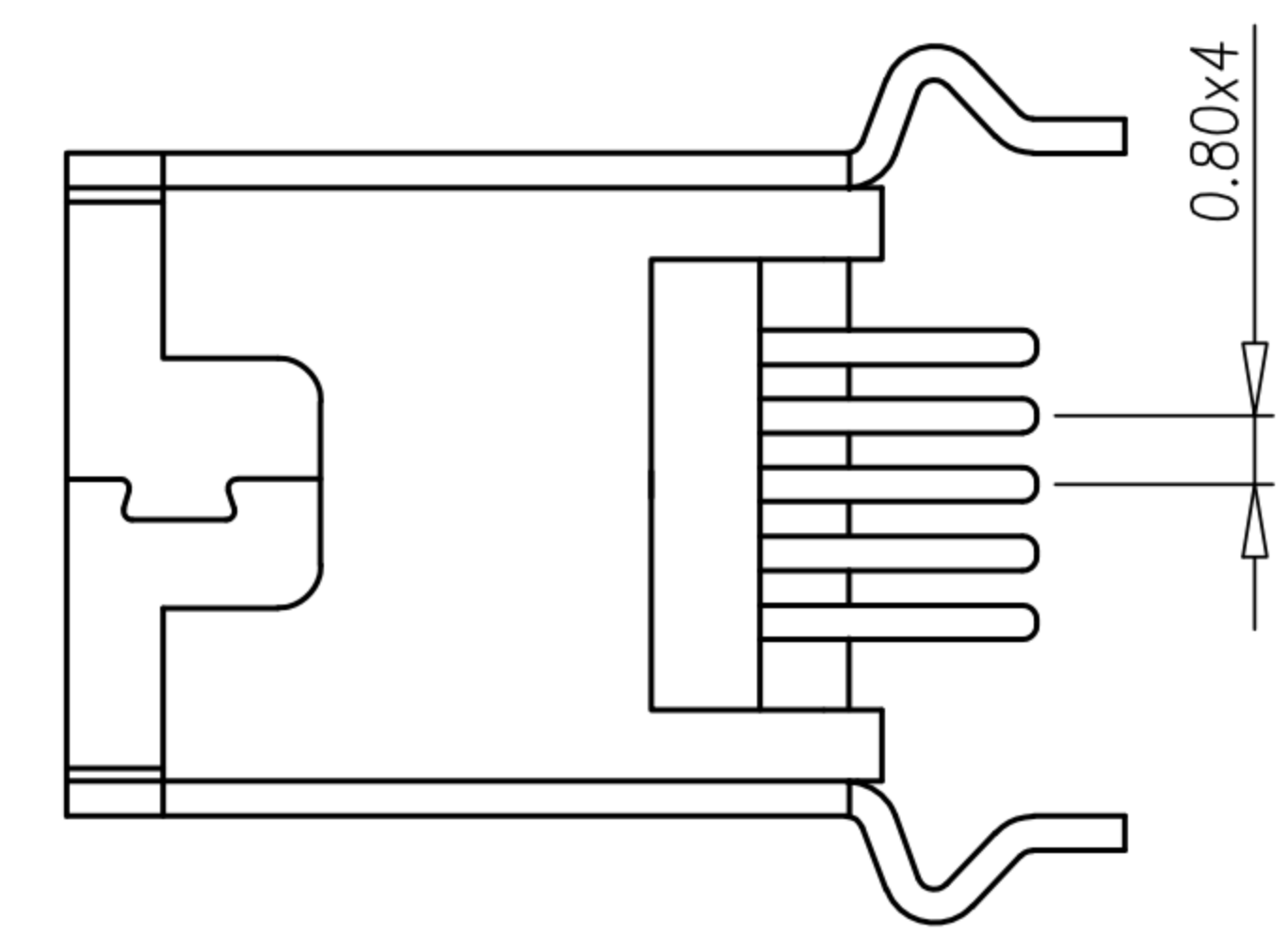
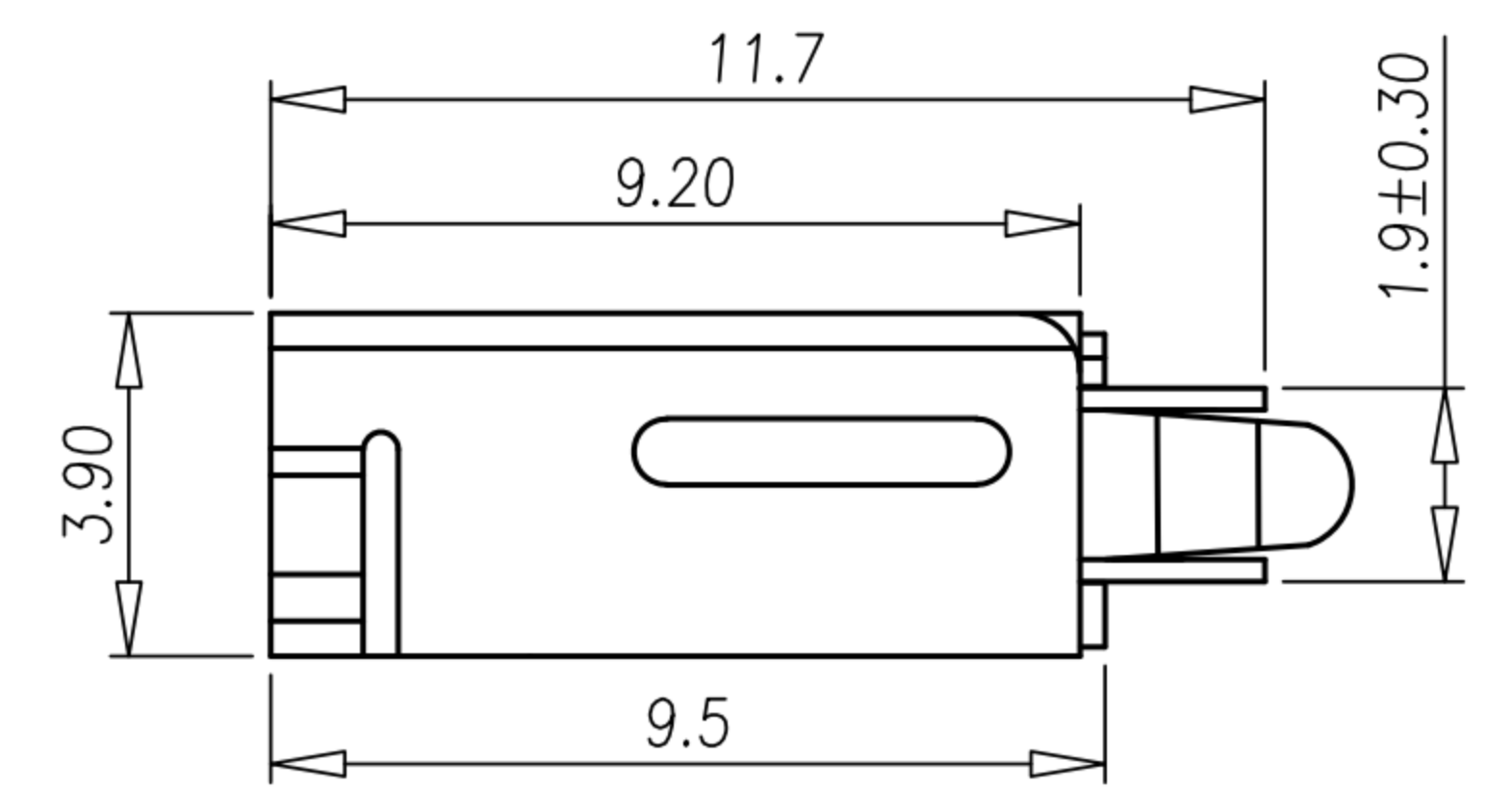
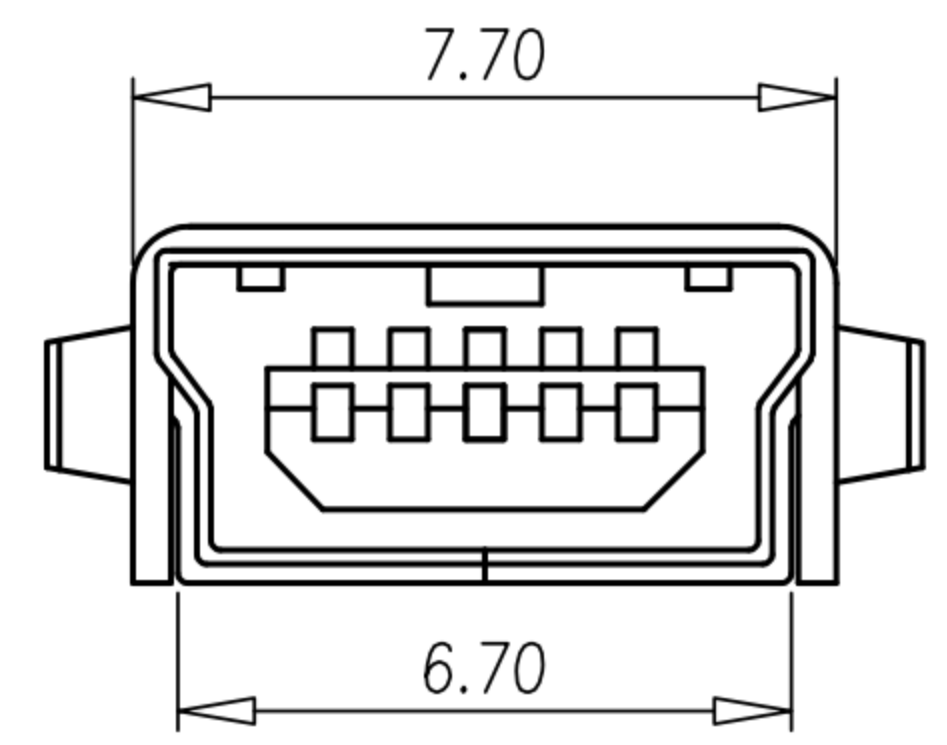

- NOTE.
- MATERIAL :
 - 1-1. HOUSING : LCP GLASS FIBRE UL94 V-0
 - 1-2. CONTACT : Phosphor Bronze.
 - 1-3. SHELL : Brass.
 - FINISH :
 - 2-1. CONTACT :
 - CONTACT AREA :GOLD FLASH PLATED
 - SOLDER AREA : BRIGHT TIN
 - UNDER PLATE : NICKEL
 - 2-2. SHELL : NICKEL PLATED

DRAWN	Jen Xie	APP'D	Fido Weng	UNIT	mm	TOLERANCE		广东科斯达电子科技有限公司 GUANG DONG KE SI DA ELECTRONIC TECHNOLOGY CO., LTD.	TITLE	MINI USB 5P(F) B TYPE DIP 180°			SHEET	1/2
CHK'D	Emily Suen			SCALE	1:1	x. ±0.45 .x ±0.35 .xx ±0.25 ANGULA ±1°			PART NO.	MU-05F1-02	DWG NO.	QC3152	VERSION	A