

CUSTOMER DRAWING

REV.	DESCRIPTION	APPROVED BY	DATE	ECN NO.
△A	RELEASE	Ku Chou	28/08/19'	
△B				
△C				

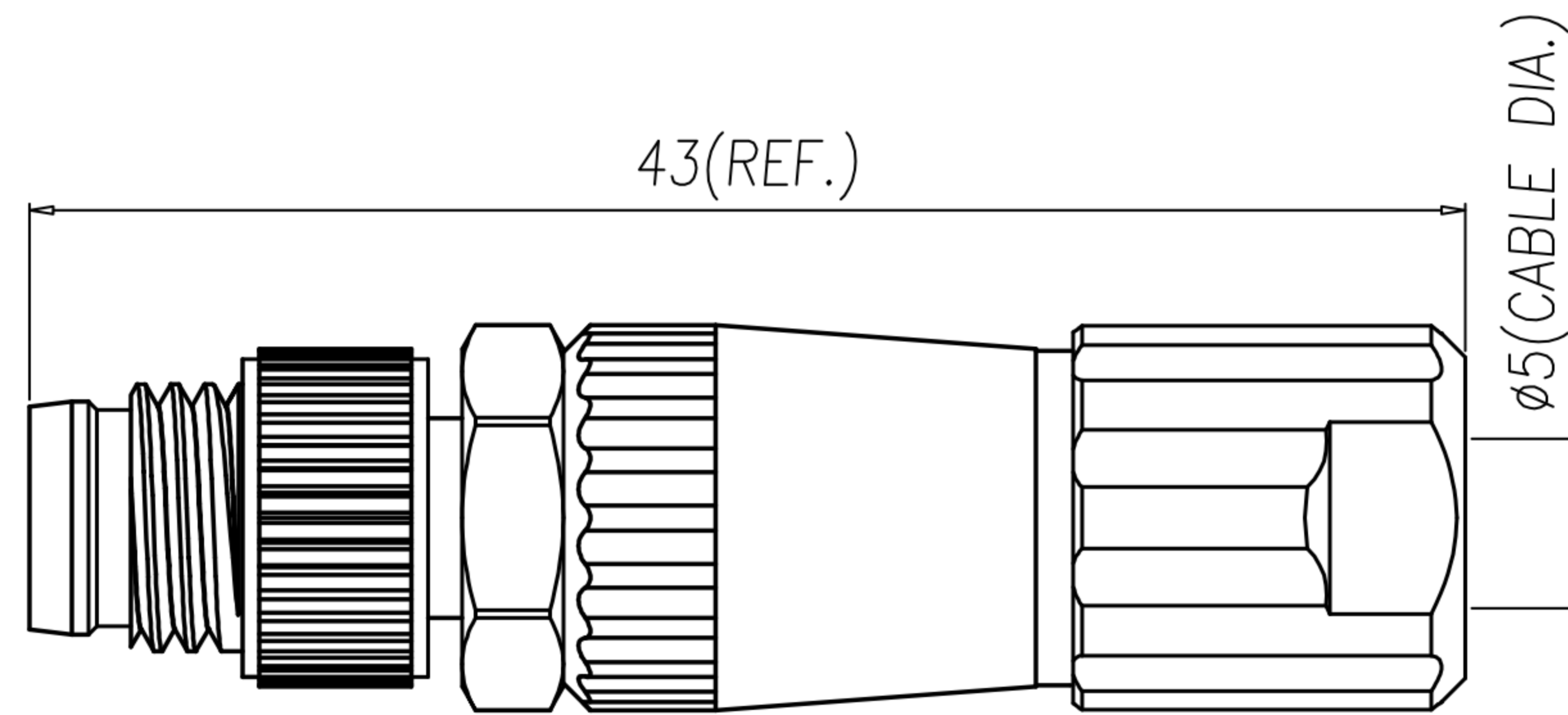
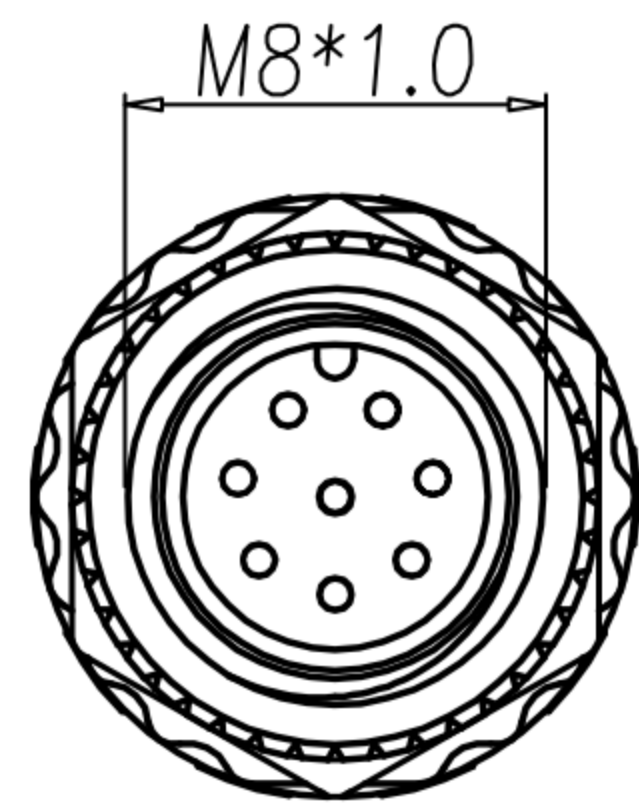
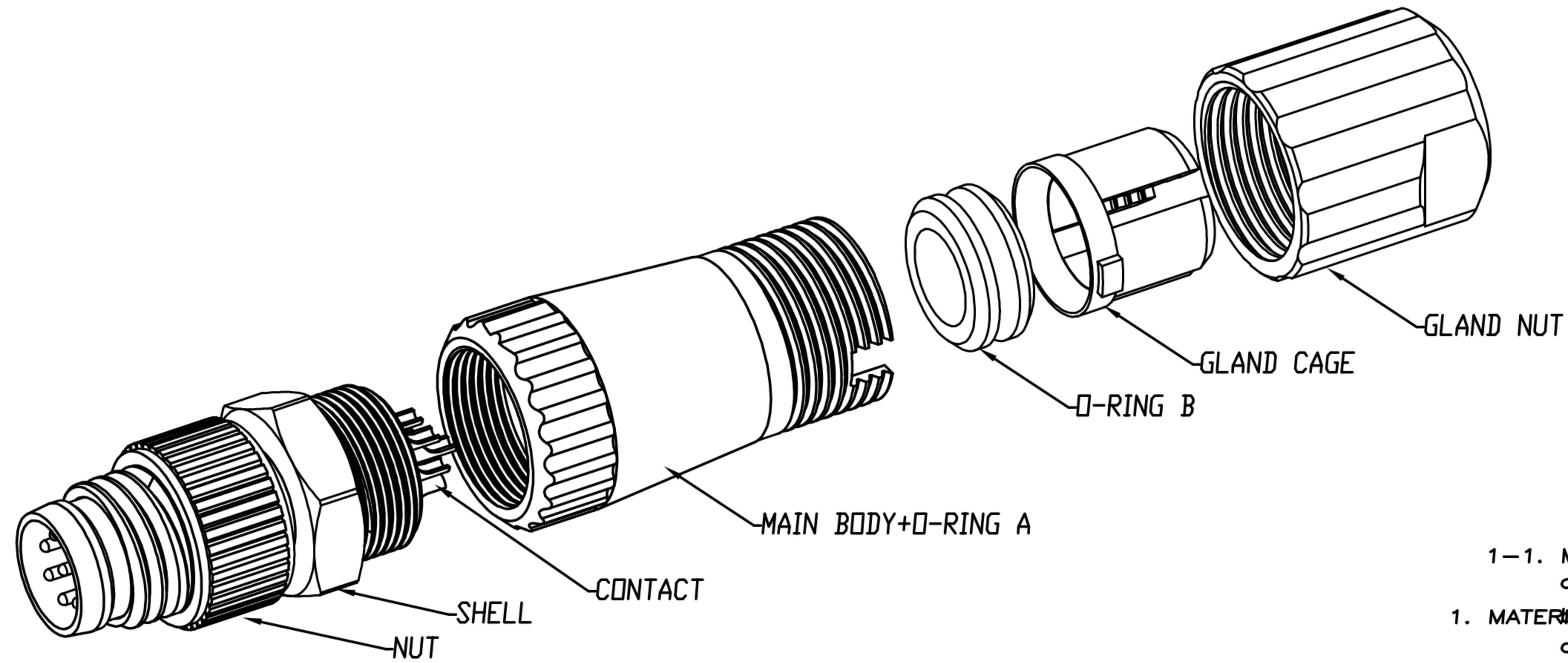

- 1-1. MATERIAL A
  - a. HOUSING : PA66 UL94V-0 ; COLOR : BLACK.
- 1. MATERIAL CONTACT : BRASS
  - c. NUT : BRASS
  - d. SHELL : BRASS
- 1-2. MATERIAL B
  - a. MAIN BODY : PA66 ; COLOR : BLACK
  - b. O-RING A : SILICONE ; COLOR : BLACK
- 1-3. O-RING B : NBR COLOR : BLACK.
- 1-4. GLAND CAGE : PA66 ; COLOR : WHITE.
- 1-5. GLAND NUT : PA66 ; COLOR : BLACK
- 2. FINISH :
  - 2-1. MATERIAL A
    - a. CONTACT : GOLD FLASH PLATED.
    - UNDER PLATE : NICKEL.
    - b. NUT : NICKEL PLATED.
    - c. SHELL : NICKEL PLATED.
- 3. ELECTRICAL SPECIFICATION :
  - 3-1. Rated current : 1.5A
  - 3-2. Rated voltage : 30V
  - 3-3. Water proof : IPX7
- 4. Environmental :
  - 4-1. Operation Temperature : -20℃~85℃

DRAWN	Emily Suen	APP'D	Ku Chou	UNIT	mm	TOLERANCE			TITLE	M8 8PIN (M) Assembly type			SHEET
CHK'D	Ku Chou			SCALE	1:1	.x ±0.20 .xx ±0.10 .xxx ±0.05 .xxxx ±0.03 ANGULA ±1°			PART NO.	WP-08M2-105-11	DWG NO.	QC9748	VERSION