

# CUSTOMER DRAWING

| REV. | DESCRIPTION     | APPVL. BY | DATE      | ECN NO. |
|------|-----------------|-----------|-----------|---------|
| △A   | RELEASE         | Fido Weng | 03/07/12" |         |
| △B   | CHANGE MATERIAL | Fido Weng | 19/09/22" |         |
| △C   |                 |           |           |         |

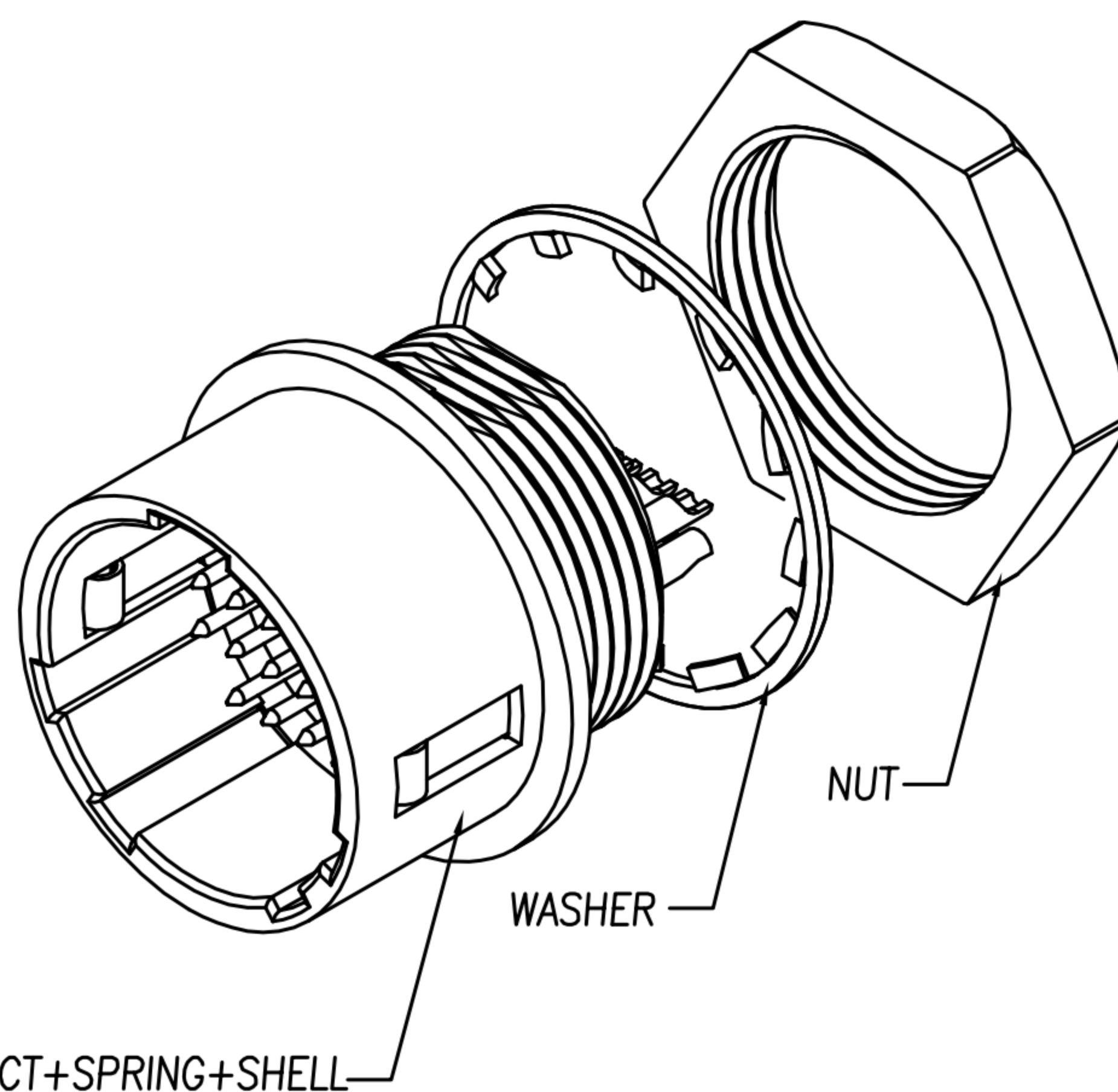
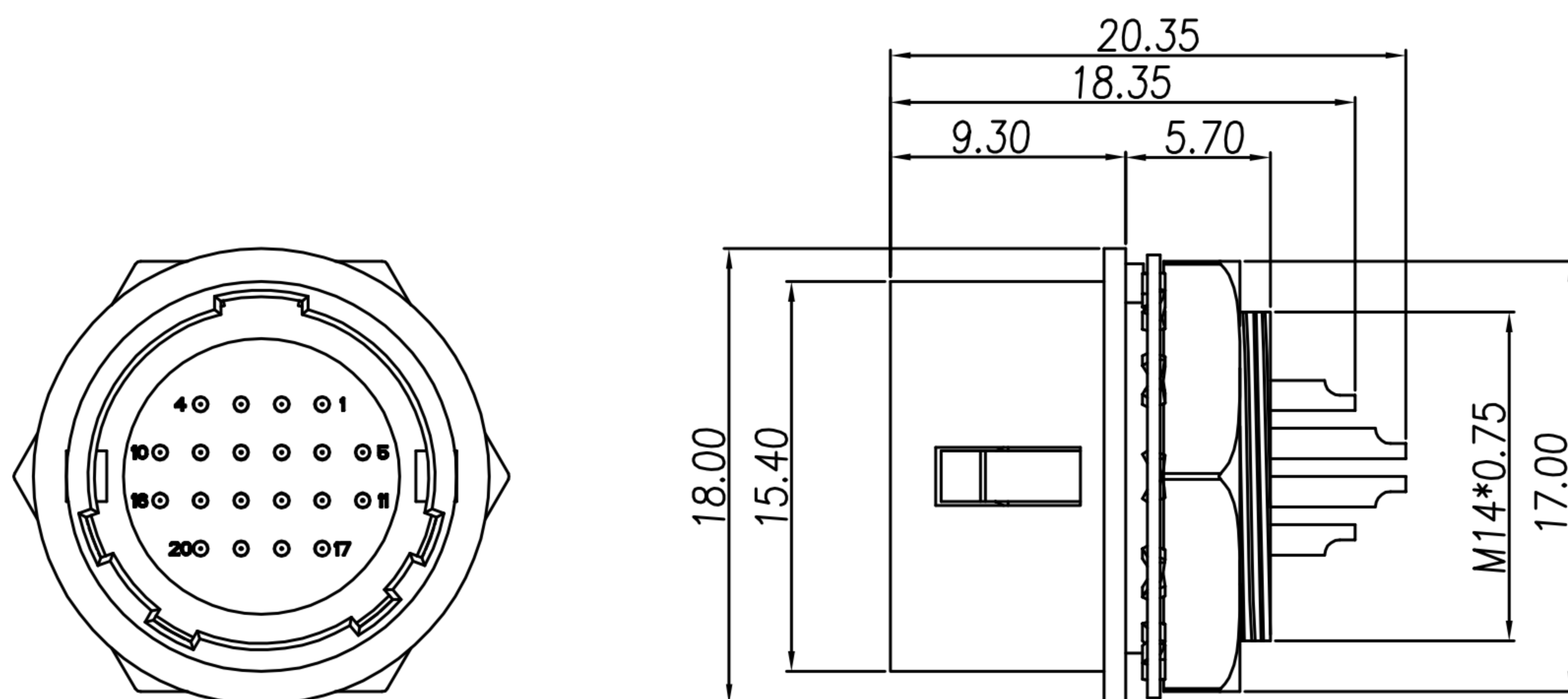

## 1. MATERIAL :

- △B 1-1. HOUSING : NYLON66 UL94V-0; COLOR : BLACK
- 1-2. CONTACT : BRASS
- 1-3. SHELL : ZINC ALLOY
- 1-4. SPRING : STAINLESS STEEL
- 1-5. WASHER : PHOSPHOR BRONZE
- 1-6. NUT : BRASS

## 2. FINISH :

- 2-1. CONTACT : GOLD FLASH
- 2-2. SHELL : NICKEL
- 2-3. WASHER : NICKEL
- 2-4. NUT : NICKEL

## 3. ELECTRICAL SPECIFICATION :

- 3-1. Rated current : 2A
- 3-2. Rated voltage : 100V AC / 140V DC

## 4. Environmental :

- 4-1. Operation Temperature : -25℃~85℃

|       |            |       |            |       |     |  |  |  |          |   |         |        |         |   |
|-------|------------|-------|------------|-------|-----|--|--|--|----------|---|---------|--------|---------|---|
| DRAW  | Lai Angus  | APPVL | Emily Suen | UNIT  | mm  | TOLERANCE  |  |  | TITLE    | DIN 20PIN(M) RECEPTACLE 插板/插座式(SHELL SIZE 13mm) |         |        | SHEET   | 1 |
| CHECK | Emily Suen |       |            | SCALE | 1:1 | .x ±0.20<br>.xx ±0.10<br>.xxx ±0.05<br>.xxxx ±0.03<br>ANGULA ±1° |  |  | PART NO. | DI-20M2-02                                      | DWG NO. | QC5835 | VERSION | B |

广东科斯达电子科技有限公司  
GUANG DONG KE SI DA ELECTRONIC TECHNOLOGY CO., LTD.