

CUSTOMER DRAWING

REV.	DESCRIPTION	APPROVED BY	DATE	ECN NO.
A	RELEASE	Fido Weng	15/02/22'	
B				
C				

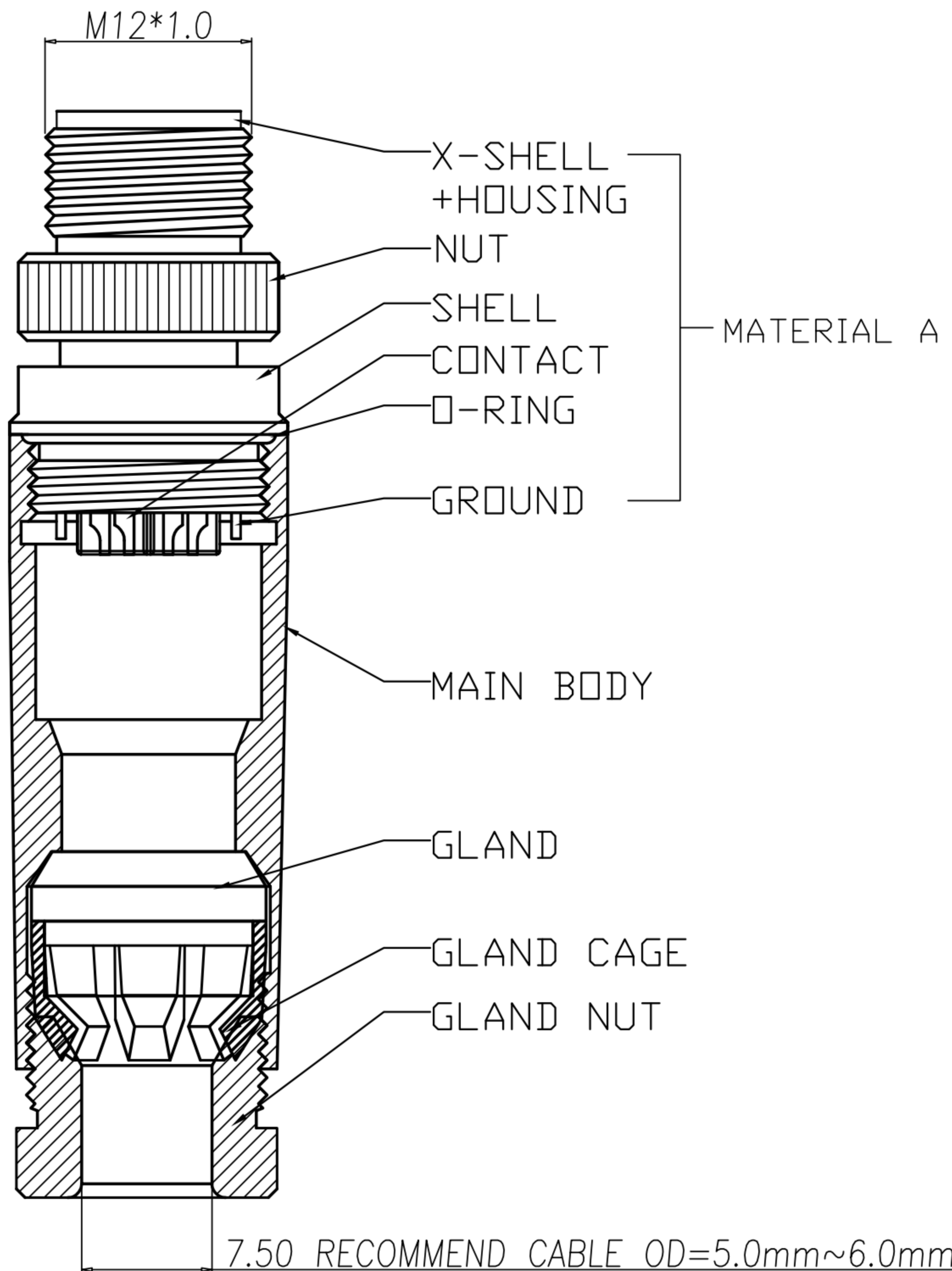
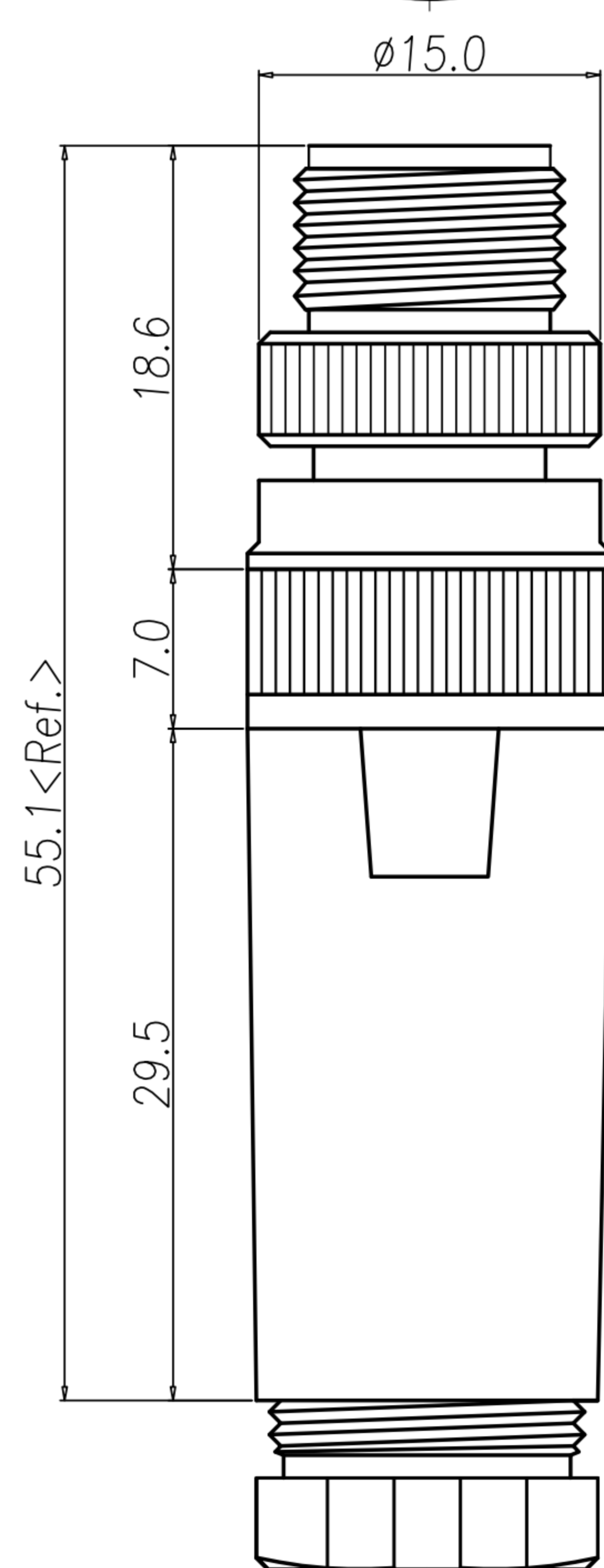
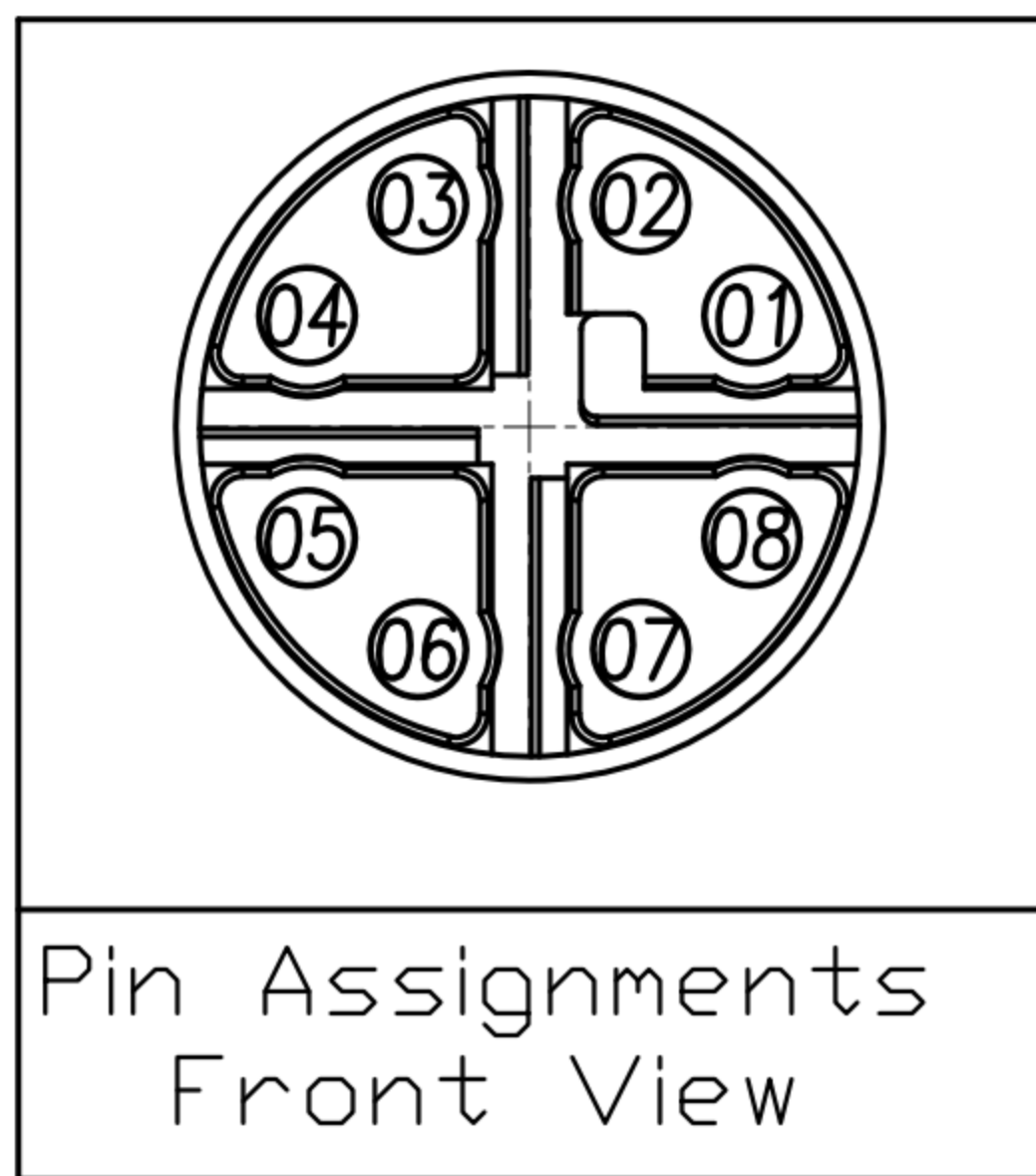
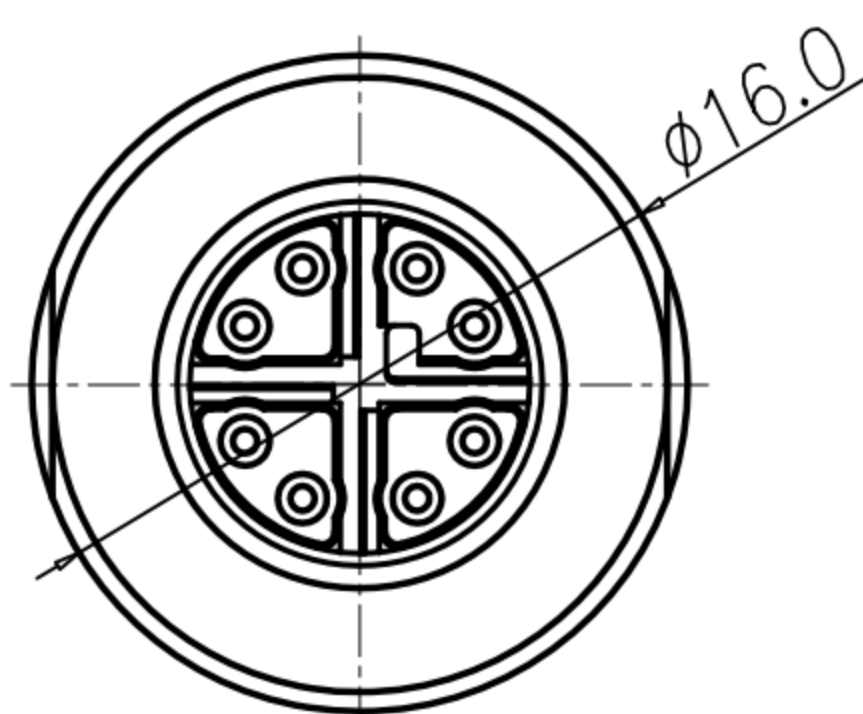

- MATERIAL :
 - MATERIAL A :
 - HOUSING : PBT UL94V-0 ; COLOR : BLACK.
 - CONTACT : BRASS
 - NUT : ALUMINIUM ALLOY
 - SHELL : BRASS
 - O-RING : EPDM ; COLOR : BLACK
 - GROUND : SEE TABLE A
 - X-SHELL : Zn ALLOY
 - MAIN BODY : ALUMINIUM ALLOY
 - GLAND : SILICONE ; COLOR : BLACK.
 - GLAND CAGE : POM ; COLOR : WHITE.
 - GLAND NUT : ALUMINIUM ALLOY
- FINISH :
 - MATERIAL A :
 - CONTACT : 10u" GOLD PLATED
 - NUT : SATIN NICKEL PLATED.
 - SHELL : NICKEL PLATED.
 - GROUND : SEE TABLE A.
 - X-SHELL : NICKEL PLATED.
 - MAIN BODY : SATIN NICKEL PLATED.
 - GLAND NUT : SATIN NICKEL PLATED.
- ELECTRICAL SPECIFICATION :
 - Rated current : 0.5A
 - Rated voltage : 48V
 - Water proof : IP67
- Environmental :
 - Operation Temperature : -40°C~85°C

TABLE A/表A

WP-08M2-148-11	-	-	無接地
WP-08M2-149-11	BRASS	NICKEL PLATED	有接地
PART No.	MATERIAL(GROUND)	FINISH(GROUND)	NOTE

DRAWN	Mark Kao	APP'D	Emily Suen	UNIT	mm	TOLERANCE			TITLE	M12 8PIN(M) X-coded Assembly type			SHEET	
CHK'D	Emily Suen			SCALE	1:1	.x ±0.20 .xx ±0.10 .xxx ±0.05 .xxxx ±0.03 ANGULA ±1°			PART NO.	SEE TABLE A	DWG NO.	QC10992	VERSION	