

CUSTOMER DRAWING

REV.	DESCRIPTION	APPROVED BY	DATE	ECN NO.
△A	RELEASE	Fido Weng	10/01/11'	
△B	CHANGE DIM.	KU Chou	26/02/19'	
△C	ADD PART NO.	KU Chou	23/04/19'	

TABLE A △

WP-12F2-29-11	GOLD FLASH
WP-12F2-04	GOLD 10u"
PART NO	FINISH

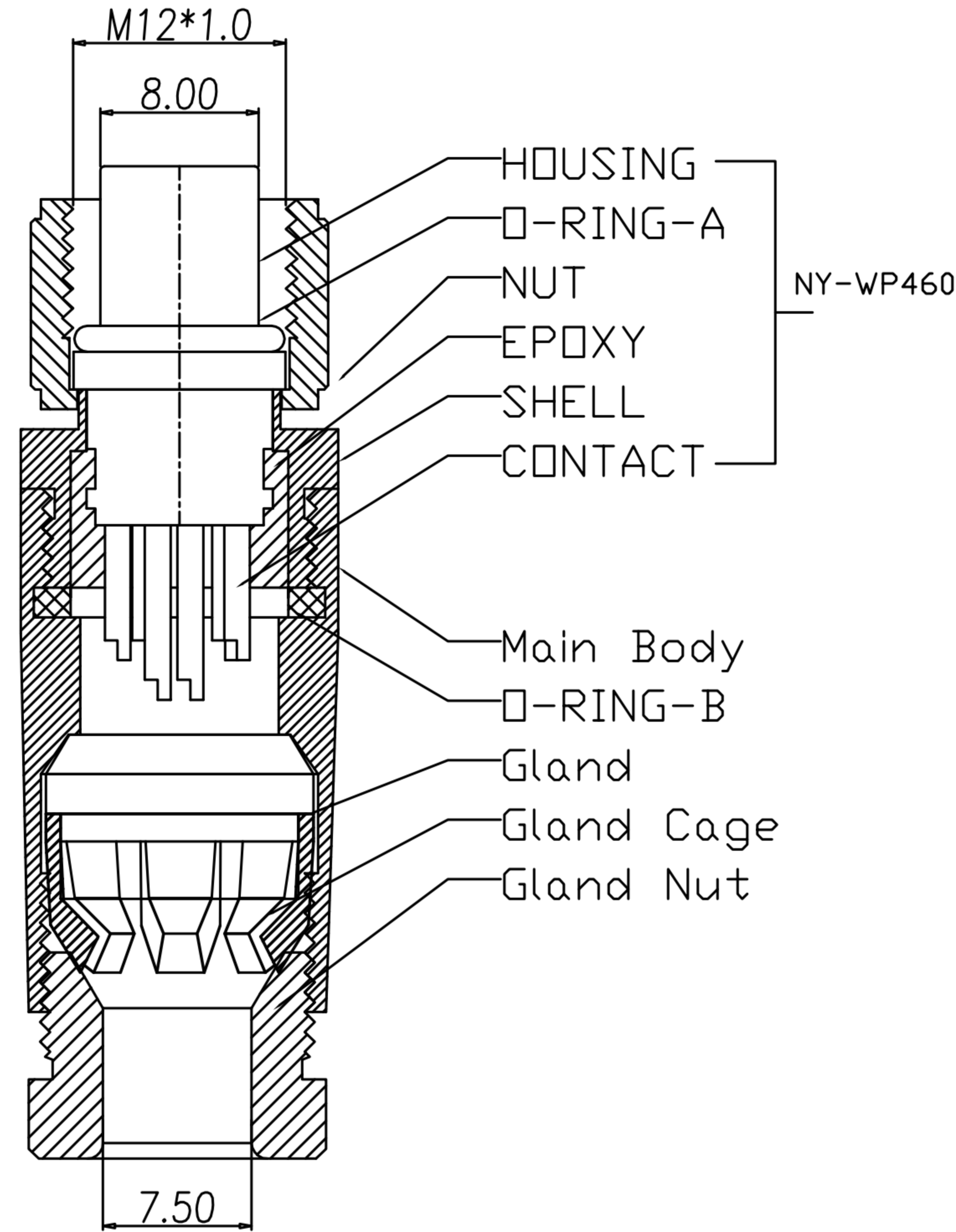
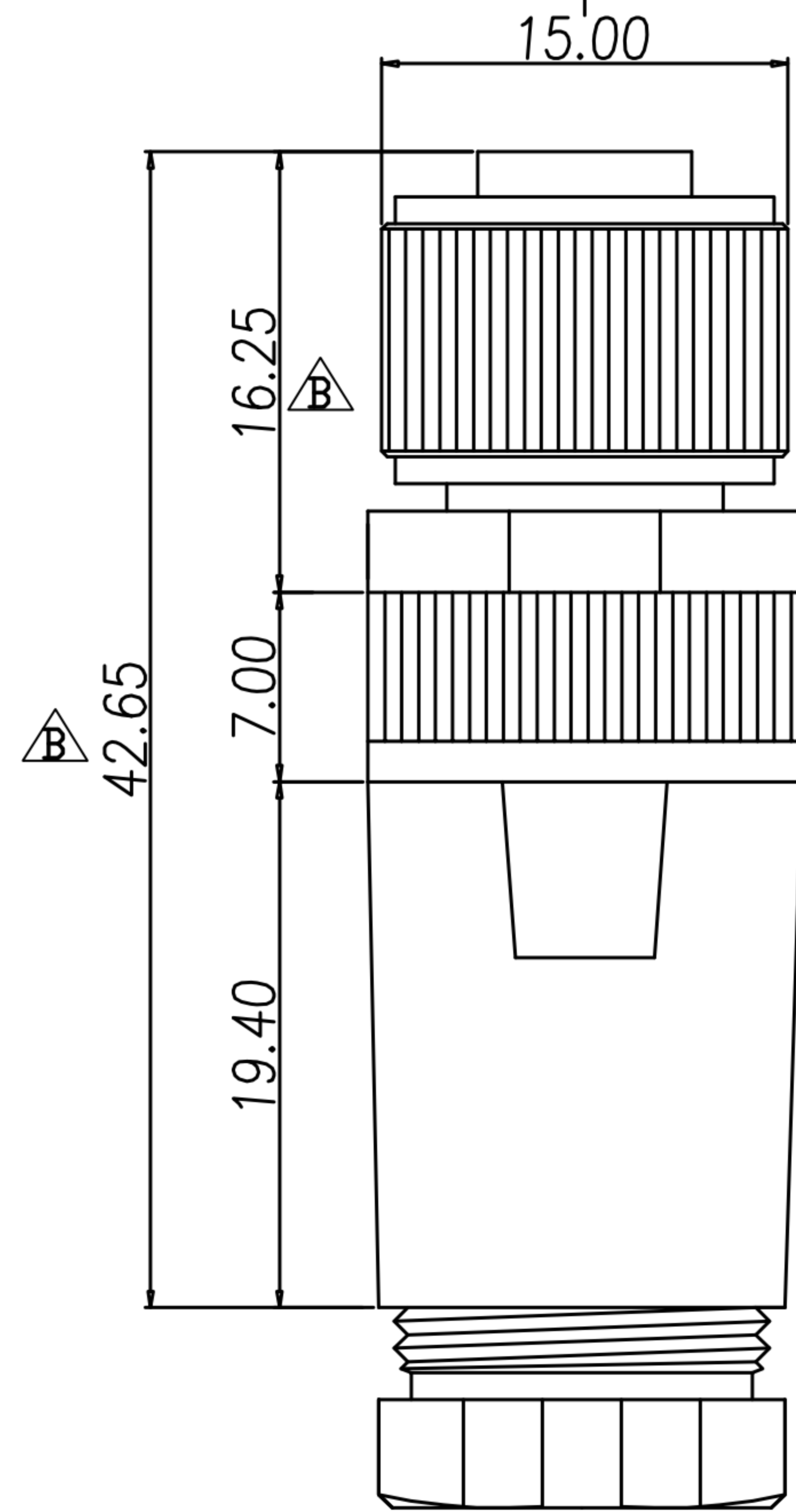
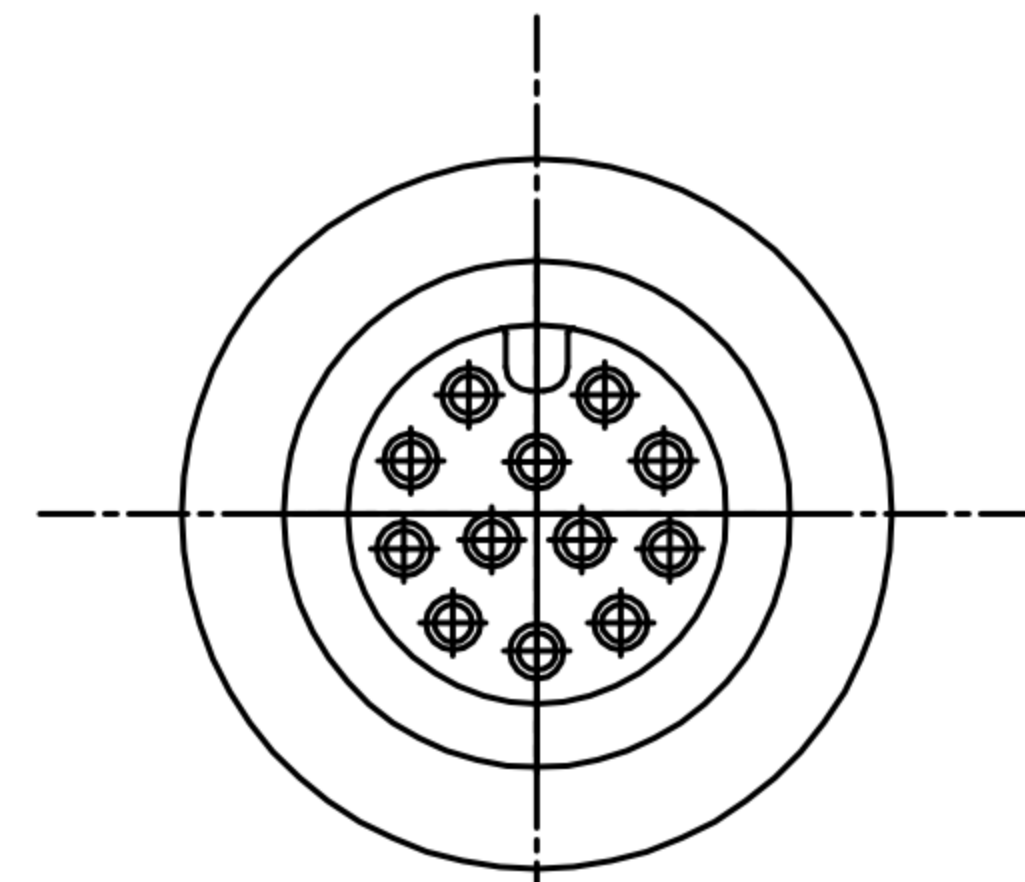

1. MATERIAL :

1-1. NY-WP460 :

- a. HOUSING : PBT UL94V-0 ; COLOR : BLACK.
- b. CONTACT : BRASS
- c. NUT : ALUMINUM ALLOY
- d. SHELL : ALUMINUM ALLOY
- e. O-RING : EPDM ; COLOR : BLACK

1-2. Main Body : ALUMINUM ALLOY

1-3. Gland : SILICONE COLOR : BLACK.

1-4. Gland Cage : POM ; COLOR : BLACK.

1-5. Gland Nut : ALUMINUM ALLOY

2. FINISH :

2-1. NY-WP460 :

- a. CONTACT : SEE TABLE A  
UNDER PLATE : NICKEL.
- b. NUT : SATING Ni PLATED.
- c. SHELL : SATING Ni PLATED.

2-2. Main Body : SATING Ni PLATED.

2-3. Gland Nut : SATING Ni PLATED.

3. ELECTRICAL SPECIFICATION :

3-1. Rated current : 1.5A

3-2. Rated Voltage : 30V

3-3. Water proof : IPX7

4. Environmental :

4-1. Operation Temperature : -20 °C~85°C

DRAWN	Mark Kao	APP'D	KU Chou	UNIT	mm	TOLERANCE			TITLE	M12 12PINK(F) A-coded Assembly type			SHEET	
CHK'D	Emily Suen			SCALE	1:1				PART NO.	SEE TABLE A	DWG NO.	QC5793	VERSION	

广东科斯达电子科技有限公司  
GUANG DONG KE SI DA ELECTRONIC TECHNOLOGY CO., LTD.