

# CUSTOMER DRAWING

REV.	DESCRIPTION	APPROVED BY	DATE	ECN NO.
A				
B				
C				

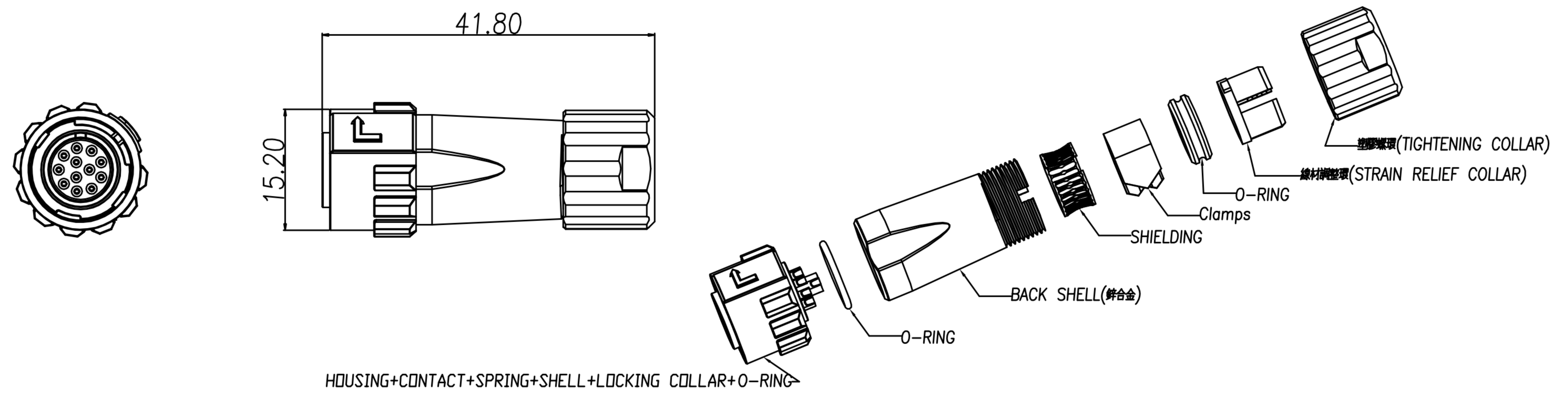

### Contact position arrangement and specifications

Contact configuration		Withstanding voltage	300V AC	Operating temperature range	-25°C to +85°C
		Voltage rating	30V AC, 42V DC	Insulation resistance	1000MΩ
		Current rating	2A	Water proof	IP67
		Contact resistance	15MΩ		

### MATERIAL

HOUSING	PPS UL94V-0/BLACK	PLUG SHELL	ZINC ALLOY	LOCKING COLLAR	ZINC ALLOY
CONTACT	PHOSPHOR BRONZE	SPRING 0.5*10.7	STAINLESS STEEL	O-RING $\phi$ 9.9 L0.9	EPDM/BLACK
O-RING $\phi$ 11.5 L1.0	EPDM/BLACK	O-RING $\phi$ 10.75 L3.4	NBR/BLACK	鎖緊環(TIGHTENING COLLAR)	PPS/棕色
Clamps	BRASS	STRAIN RELIEF COLLAR	NYLON66/WHITE	SHIELDING $\phi$ 10.4 L5.2 T0.15	PHOSPHOR BRONZE
BACK SHELL	ZINC ALLOY				

### FINISH

CONTACT	GOLD FLASH	PLUG SHELL	NICKEL	SHIELDING $\phi$ 10.4 L5.2 T0.15	NICKEL
BACK SHELL	NICKEL	LOCKING COLLAR	NICKEL		

DRAWN	Leo	APP'D	Ku Chou	UNIT	mm	TOLERANCE			TITLE	DIN 12PIN(F) LF 線端			SHEET
CHK'D	Emily Suen			SCALE	1:1	.x $\pm$ 0.20 .xx $\pm$ 0.10 .xxx $\pm$ 0.05 .xxxx $\pm$ 0.03 ANGULA $\pm$ 1°			PART NO.	DI-12F2-08-11	DWG NO.	QC6504	VERSION A